

3G LIGHTING

3G-38RMSL

3.8" MICRO MADISON SLOT

3.8" recessed slot designed for continuous runs in various configurations
Suitable for drywall, wood, and other architectural ceiling applications
Machined aluminum double gimbals. Adjustable and lockable
Individual fixture heads can slide within the channel
Easily adjustable in the field for maximum flexibility
Lumen range up to 1000lm (80+, 90+, and 97+ CRI options)
1% dimming standard with several integral driver options

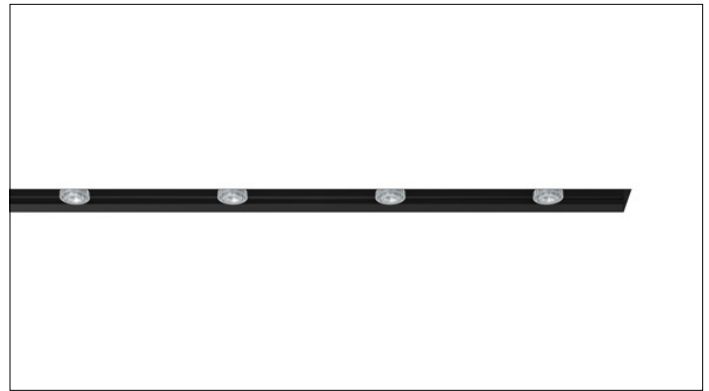

PROJECT:		TYPE:	
CATALOG#:		DATE:	QTY:

CAT. NO	LUMEN OUTPUT	CRI	COLOR TEMP	BEAM ANGLE	VOLTAGE
3G-38RMSL	07 - 700 LUMENS 10 - 1000 LUMENS	S80 - 80+ CRI ¹ H90 - 90+ CRI H97 - 97+ CRI ¹	27K - 2700K 30K - 3000K 35K - 3500K 40K - 4000K	30D - 30° 45D - 45° 65D - 65°	UNV - 120/277V 120 - 120V

DRIVER	FLANGE TYPE	GIMBAL FINISH	HOUSING INTERIOR
DIM - 0-10V (100-1%) LE - PHASE DIM ² (TRIAC/ELV, 100-1%) D01 - 0-10V (100-0.1%) DALI - DALI (100-1%) ³	WT - WHITE TRIM FLANGE XTR - TRIMLESS (MUD-IN DRYWALL) FX - FLANGELESS GCX - GRID CEILING (UNIVERSAL MOUNT) *	NG - NATURAL ALUMINUM BG - BLACK GIMBAL WG - WHITE GIMBAL	BK - BLACK WH - WHITE

*Universal mounting brackets used for all grid ceiling types only. See mounting section for details

OPTIONS	RUN TYPE	FIXTURE HEAD SPACING
2C - 2 CIRCUIT 3C - 3 CIRCUIT CP - CHICAGO PLENUM	S - ____' (STRAIGHT) L - ____'X ____' (L-SHAPE) U - ____'X ____'X ____' (U-SHAPE) R - ____'X ____' (RECTANGLE/SQUARE) Continuous runs available in 6" increments	12" - 12" ON CENTER 18" - 18" ON CENTER 24" - 24" ON CENTER 36" - 36" ON CENTER 48" - 48" ON CENTER CUS(XX) - CUSTOM SPACING * *Specify number of fixture heads (XX)

¹ S80 not available in 27K. H97 available in 30K and 35K as standard

² Forward Phase/Reverse Phase driver available in 120V only

³ DALI-2 (Type 6) provided as standard. Please consult factory for DALI (Type 8) options

BASED ON 65° BEAM ANGLE AND 3500K SOURCE (PER FIXTURE HEAD)

LUMEN OUTPUT	80+ CRI			90+ CRI			97+ CRI		
	DELIVERED LUMENS	SYSTEM WATTS	EFFICACY (LPW)	DELIVERED LUMENS	SYSTEM WATTS	EFFICACY (LPW)	DELIVERED LUMENS	SYSTEM WATTS	EFFICACY (LPW)
700LMs	729	6.5	112	642	6.5	99	598	6.5	92
1000LMs	1057	9.3	114	930	9.25	101	866	9.25	94

LUMEN OUTPUT MULTIPLIER: 27K=0.94, 30K=0.97, 35K=1.00, 40K=1.01

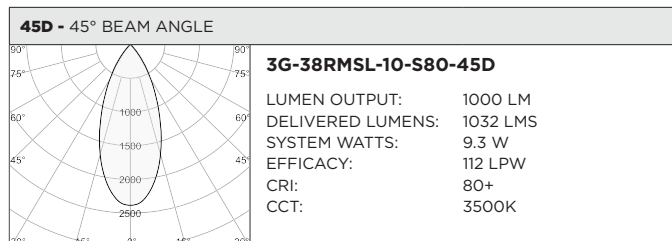
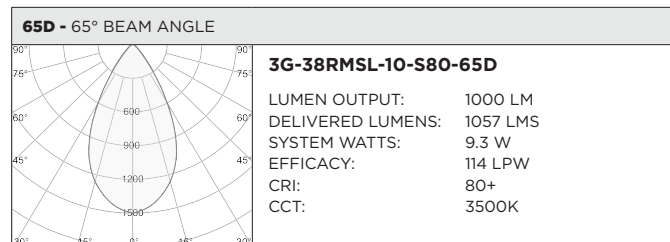
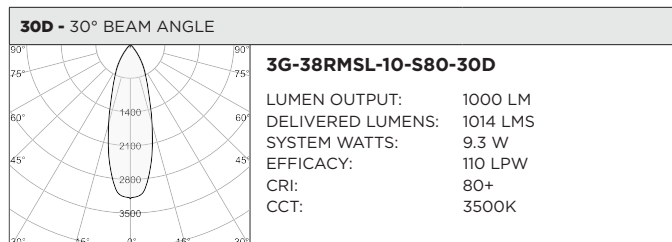

HOUSING

Housing constructed in extruded aluminum and cold rolled steel
Extruded aluminum housing with narrow 2" aperture
Designed for continuous runs in various configurations. Available in 1" increments as standard
Standard matte black powder coated housing interior with optional matte white finish
Aluminum trim flange with matte white powder coated finish and minimal 0.400" overlap
Trimless model features a satin coat mudding flange for seamless ceiling integration

ADJUSTABILITY

Solid aluminum, 30mm machined double gimbals with dual axis adjustability (35°x35°)
Individual fixture heads can slide left or right within the channel. Easily adjustable in field
Each double gimbal can be locked into place

OPTICS

Regressed LED source for enhanced glare control
Proprietary, high performance reflectors. Field replaceable
Available in 30°, 45° and 65°

WARRANTY

5 Year Warranty on LED and drivers
Manufacturer 1 Year Warranty for defects in material and workmanship under normal use
Ambient temperature at fixture should not exceed 25°C

ELECTRICAL

Standard 0-10V, constant current drivers with 100-1% dimming range and >0.9 power factor
Standard 120/277V universal voltage with several driver options
All drivers are integral and easily accessible through luminaire aperture
Each section is powered individually and can be daisy chained together
Fixture sections can be fed separately based on circuit requirement
Remote emergency battery operates for 90 minutes at 10W (not accessible within channel)

LED SYSTEM

Citizen LED module (field replaceable)
Color consistency <2 SDCM
Standard (80+ CRI). Optional (90+ and 97+ CRI)
Available in 27K, 30K, 35K, and 40K
L90 >50,000 hours
5 Year Warranty

MOUNTING

Housing suspended via 1/4" threaded rod or suspension cables (by others)
Trim fixture designed for use in drywall, wood, and other architectural ceiling materials
Trimless fixture designed for use in drywall, mud-in ceiling applications
Flangeless fixture designed for use in wood ceilings
Suitable for various grid ceiling applications (see mounting details)
Maximum ceiling thickness of 3.50". Consult factory for modifications

LISTING

ETL listed and conforms to UL1598 standard. Certified to CSA22.2 No.250.0.
Rated for indoor dry or damp locations

HARD CEILING

WT - TRIM

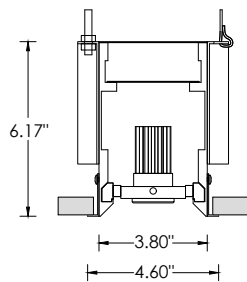

RECOMMENDED CEILING OPENING 4.20"

XTR - TRIMLESS

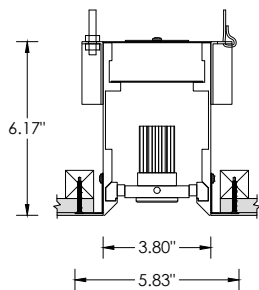

RECOMMENDED CEILING OPENING 4.25"

FX - FLANGELESS

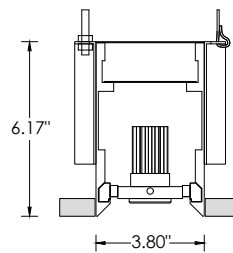

RECOMMENDED CEILING OPENING 3.90"

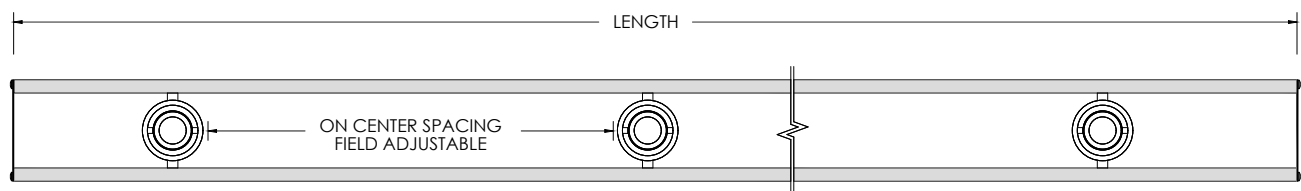

HARD CEILING : MOUNTING DETAILS

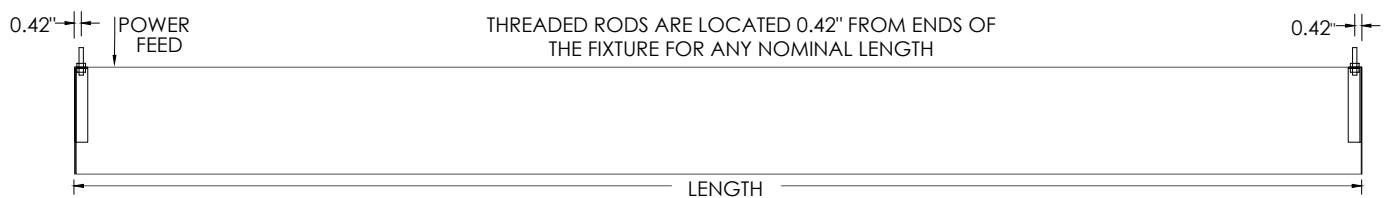

GRID CEILING

9L - 9/16" LAYIN

9TG - 9/16" TEGULAR

15L - 15/16" LAYIN

15TG - 15/16" TEGULAR

**9ST - 9/16" SLOT TEE
TEGULAR**

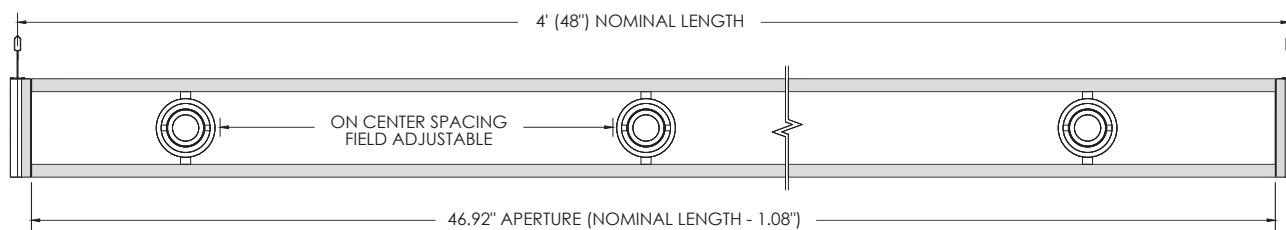
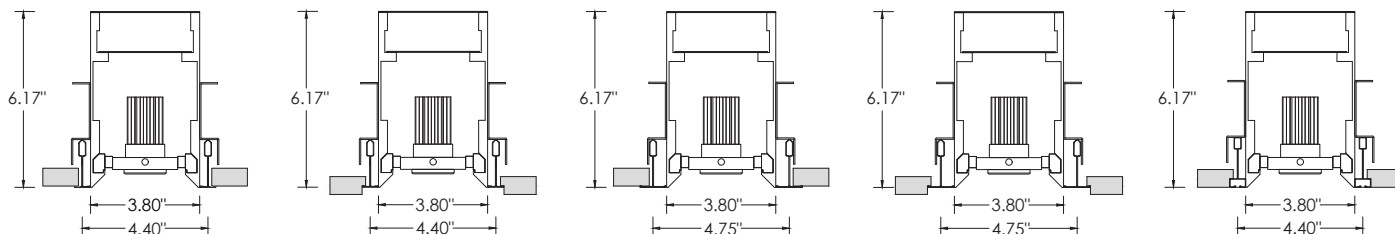

GRID CEILING : MOUNTING DETAILS

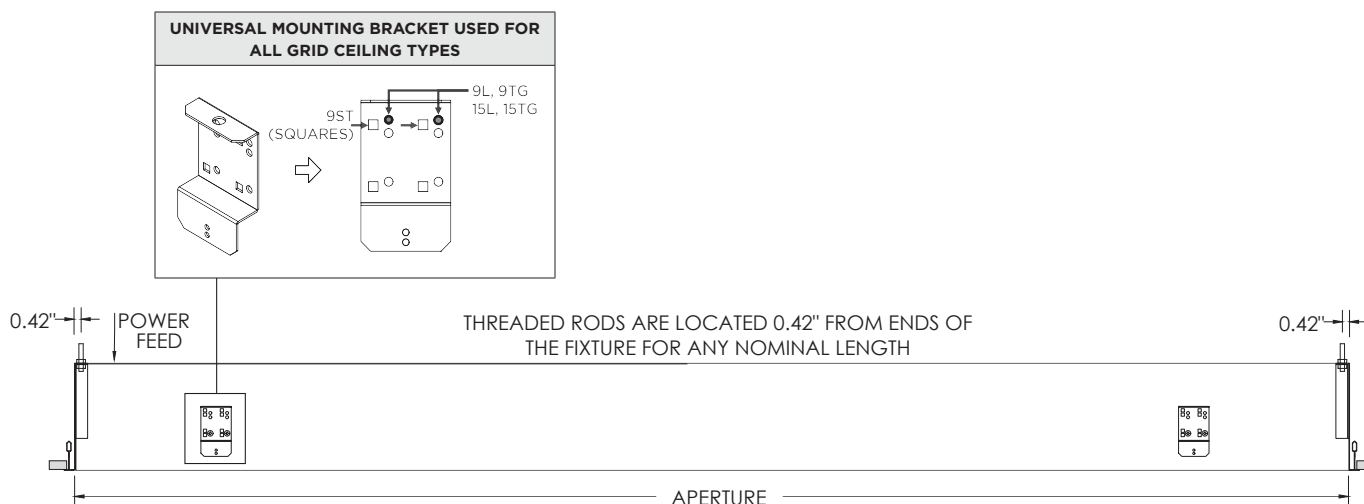

GIMBAL ADJUSTABILITY

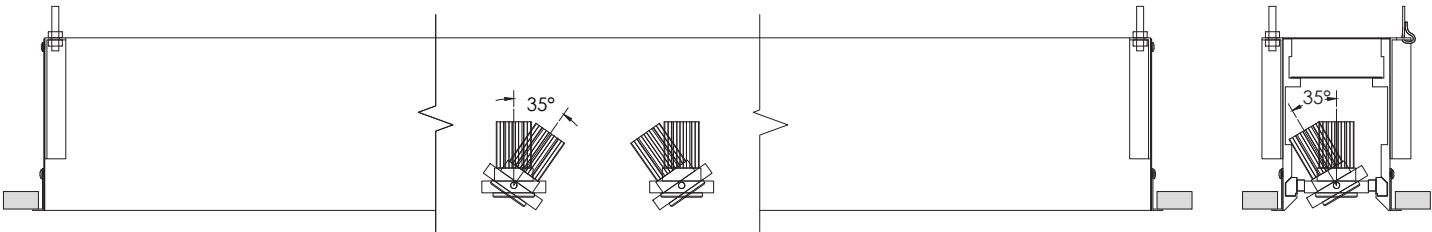

PATTERNS

Specify pattern shape and overall dimensions as shown below
Patterns are connected with 12"x12" mitered corner sections (Fixture heads not available)
Please consult factory for custom patterns and shapes not shown below

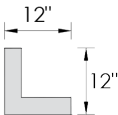

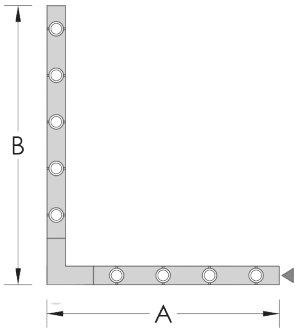
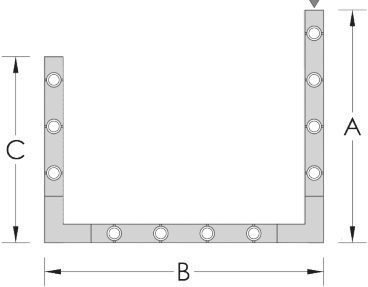
L-SHAPE	U-SHAPE	RECTANGLE/SQUARE
<p>Provide dimensions of AxB Example: L - 6'x8'</p> 	<p>Provide dimensions of AxBxC Example: U - 8'x10'x6"</p> 	<p>Provide dimensions of AxB Example: R - 10'x8'</p> 