

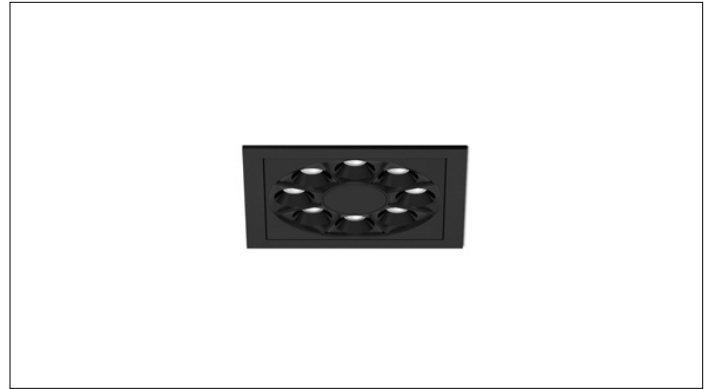

3G-DZ33S

3.3" SQUARE ZOIE
DOWNLIGHT



3.3" square, high performance round Zoie downlight
 Regressed LED source provides maximum visual comfort, UGR <10
 High gloss black or white louvers with proprietary optics and no glare
 Lumen range from 700lm to 3000lm (80+ and 90+ CRI options)
 Shallow housing available along with remodel and other housing options
 100-1% dimming range standard with integral driver options

PROJECT:		TYPE:	
CATALOG#:		DATE:	QTY:

CAT. NO	LUMEN OUTPUT (DELIVERED LUMENS)	CRI	COLOR TEMP	BEAM ANGLE
3G-DZ33S	07 - 700 LUMENS 10 - 1000 LUMENS 15 - 1500 LUMENS 22 - 2200 LUMENS 30 - 3000 LUMENS ¹ <small>Lumen outputs are delivered lumens based on 80+ CRI, 3000K source. See performance chart for all options</small>	S80 - 80+ CRI H90 - 90+ CRI	27K - 2700K ¹ 30K - 3000K 35K - 3500K 40K - 4000K ¹	20D - 20° 40D - 40° 60D - 60°

VOLTAGE	DRIVER	FLANGE TYPE	LOUVER FINISH
UNV - 120/277V 120 - 120V 347 - 347V ²	DIM - 0-10V (100-1%) D01 - 0-10V (100-0.1%) ³ DALI - DALI (100-1%) ³ DHL2 - LUTRON HI-LUME (1% ECOSYSTEM) DMX - DMX (100-0%) ³	BT - BLACK TRIM WT - WHITE TRIM ST - SILVER TRIM XTR - TRIMLESS MWF - FLANGELESS (MILLWORK) ⁴	BLV - BLACK WLV - WHITE

HOUSING TYPE	OPTIONS
RMD - REMODEL (NON-IC) NCF - NEW CONSTRUCTION FRAME (NON-IC) SH - SHALLOW HOUSING (IC RATED) ⁵ NC - NEW CONSTRUCTION HOUSING IC - NEW CONSTRUCTION IC HOUSING ⁵	CP - CHICAGO PLENUM ⁶ BH - C-CHANNEL BAR HANGERS (FOR NC & IC HOUSINGS ONLY) EMR - EMERGENCY BATTERY (REMOTE) ⁷

¹ 3000lm not available in 90CRI. 2700K only available in 90CRI and 4000K only available in 80CRI
² 347V available in 0-10V only (100-1%)
³ D01, DALI and DMX available up to 2200lm. DALI-2 (Type 6) provided as standard. Consult factory for DALI Type 8 option
⁴ MWF not available with Remodel (NON-IC)
⁵ IC rated Shallow Housing & New Construction IC housing available up to 2200lm with 80CRI source & 1500lm with 90 CRI source
⁶ Chicago Plenum option available with Shallow Housing (2200lm max) and New Construction Housing
⁷ Emergency battery installed remotely by others. Not accessible through the inside of the fixture

BASED ON 40° BEAM ANGLE, 80CRI AND 3000K SOURCE

80+ CRI			90+ CRI		
DELIVERED LUMENS	SYSTEM WATTS	EFFICACY (LPW)	DELIVERED LUMENS	SYSTEM WATTS	EFFICACY (LPW)
700	5.7	123	700	7.1	99
1000	8.5	117	1000	10.1	99
1500	13.1	115	1500	15.7	96
2200	20.3	108	2200	24.3	91
3000	30.7	98	N/A	N/A	N/A

LUMEN OUTPUT MULTIPLIER FOR 80CRI: 27K=N/A, 30K=1.00, 35K=0.98, 40K=1.06
 LUMEN OUTPUT MULTIPLIER FOR 90CRI: 27K=0.80, 30K=0.85, 35K=0.86, 40K=N/A

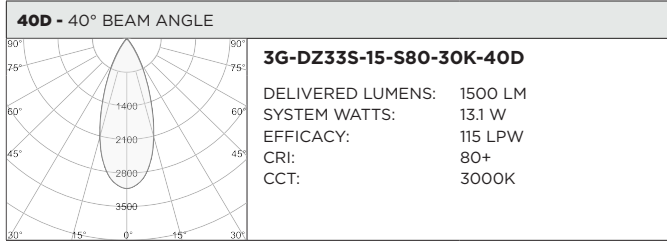
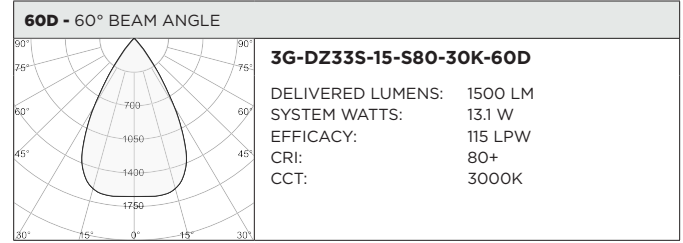
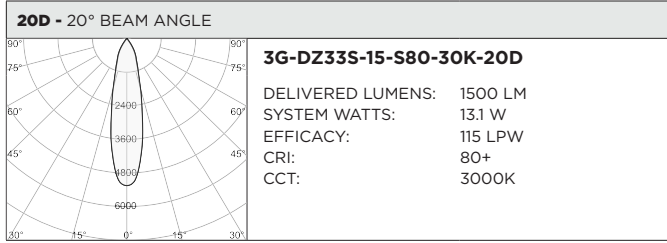

HOUSING

Remodel, new construction frame, shallow housing, and IC housing options available

Maximum ceiling thickness of 1.5". Consult factory for modifications

All housing options designed to be easily converted in field to trim or trimless with minimal components

Housing rated for #12 AWG (4 in, 4 out), 90°C conductors and through branch wiring

TRIM

Cast aluminum trim flange with matte powder coated finish and minimal 0.375" overlap

TRIMLESS

Cast aluminum mudding flange features a grooved surface for easy mud-in application

Integral blocking support provided to ensure fixture is properly secured within ceiling structure

OPTICS

3.3" aperture with regressed LED source for maximum visual comfort

High gloss black or white louvers with proprietary optics and no glare

Polycarbonate multi-faceted reflectors

Available in 20°, 40° and 60°

UGR <10

WARRANTY

5 Year Warranty on LED and drivers

Manufacturer 1 Year Warranty for defects in material and workmanship under normal use

Ambient temperature at fixture should not exceed 25°C

ELECTRICAL

Standard 0-10V, constant current drivers with 100-1% dimming range and >0.9 power factor

Standard 120/277V universal voltage with several driver options

All drivers are integral and easily accessible through luminaire aperture

LED SYSTEM

Osram LED source

Color consistency <2 SDCM

80+ and 90+ CRI

Available in 27K, 30K, 35K, and 40K

L90 >60,000 hours

5 year warranty

MOUNTING

Trim fixture designed for use in drywall, wood, acoustic, and other architectural ceilings

Trimless fixture designed for use in drywall, mud-in ceiling applications

Recommended ceiling cut-out for Millwork Flangeless option (3.525"

diameter for ceilings up to 1"). Contact 3G for thicker ceilings

Recommended ceiling cut-out for all other housing options (3 13/16" diameter)

Bar hangers (14" to 26" extension) ship only with new construction

frame and shallow housings

Optional C-channel bar hangers available for new construction (NC)

and IC housings (IC)

LISTING

ETL listed and conforms to UL1598 standard. Certified to CSA22.2

No.250.0. Rated for indoor locations

RMD - REMODEL (NON-IC)

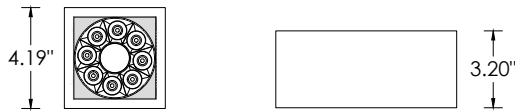
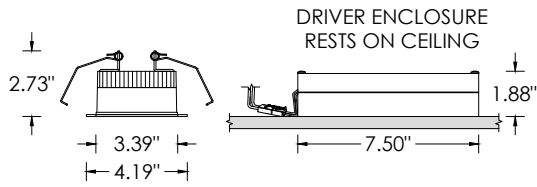

NCF - NEW CONSTRUCTION FRAME (NON-IC)

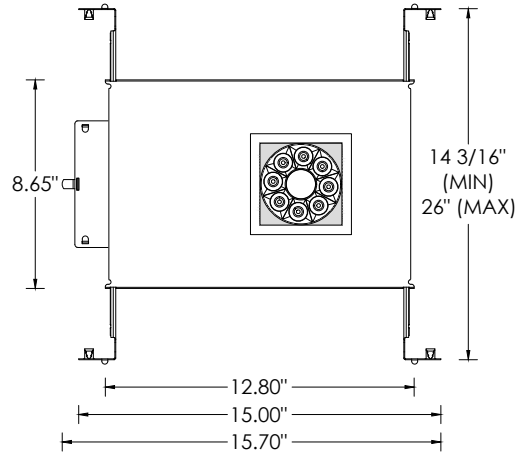
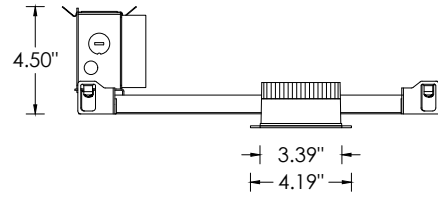

SH - SHALLOW HOUSING (IC AND CP RATED) (2200LM MAX)
(SHIPS WITH BAR HANGERS)

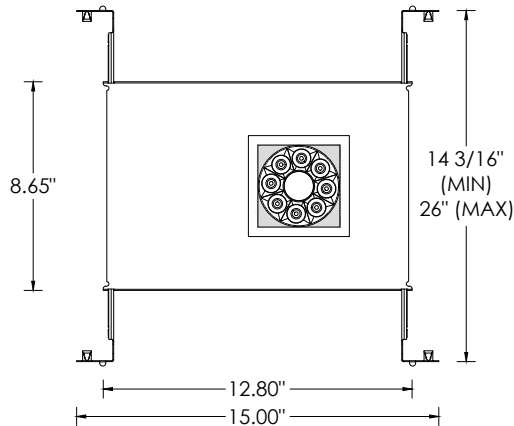
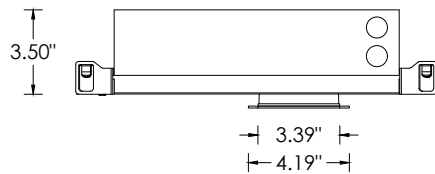

NC - NEW CONSTRUCTION HOUSING (NON-IC AND CP RATED)
IC - NEW CONSTRUCTION IC HOUSING (2200LM MAX)

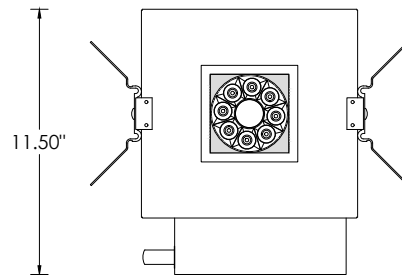
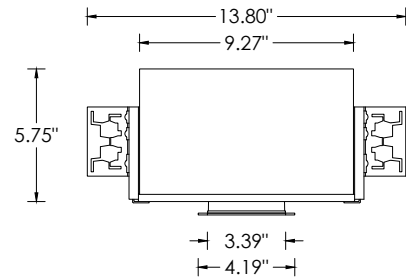

RMD - REMODEL (NON-IC)

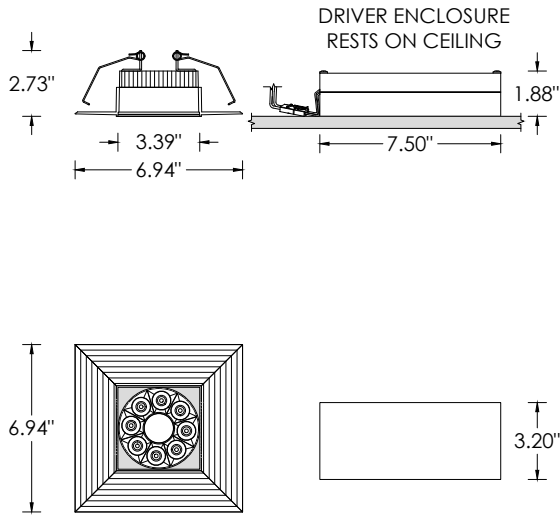

NCF - NEW CONSTRUCTION FRAME (NON-IC)

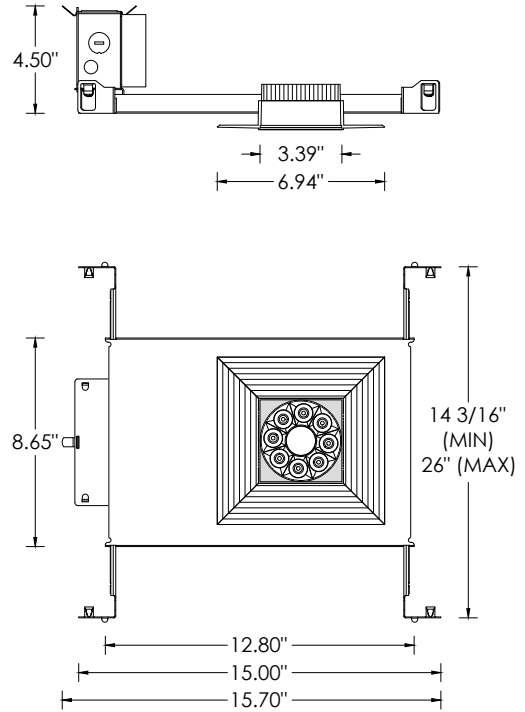

SH - SHALLOW HOUSING (IC AND CP RATED) (2200LM MAX)
(SHIPS WITH BAR HANGERS)

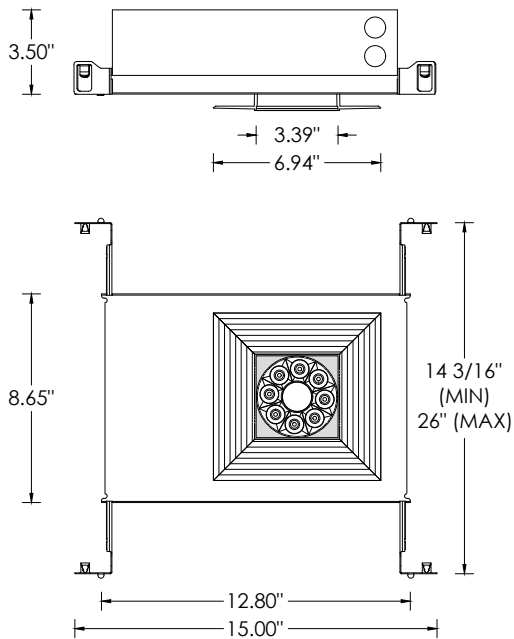

NC - NEW CONSTRUCTION HOUSING (NON-IC AND CP RATED)
IC - NEW CONSTRUCTION IC HOUSING (2200LM MAX)

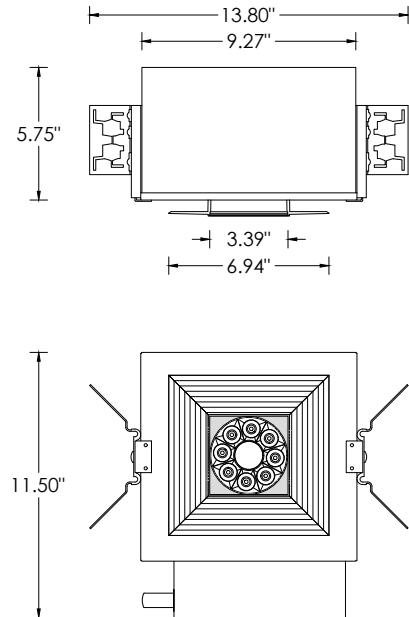

NCF - NEW CONSTRUCTION FRAME (NON-IC)

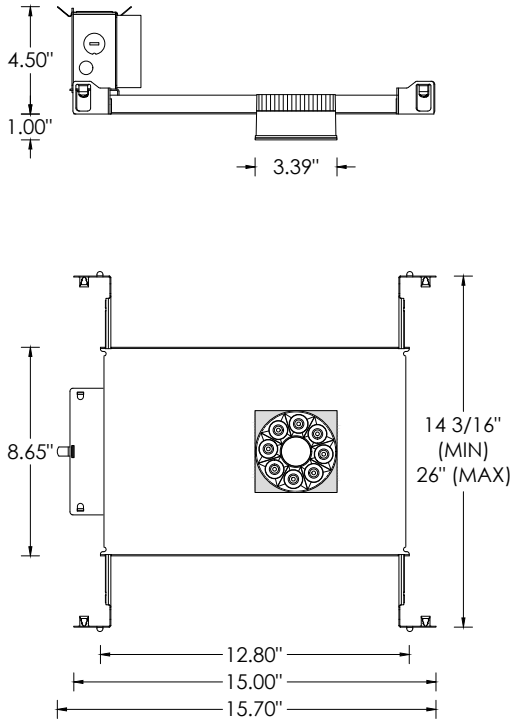

**SH - SHALLOW HOUSING (IC AND CP RATED) (2200LM MAX)
(SHIPS WITH BAR HANGERS)**

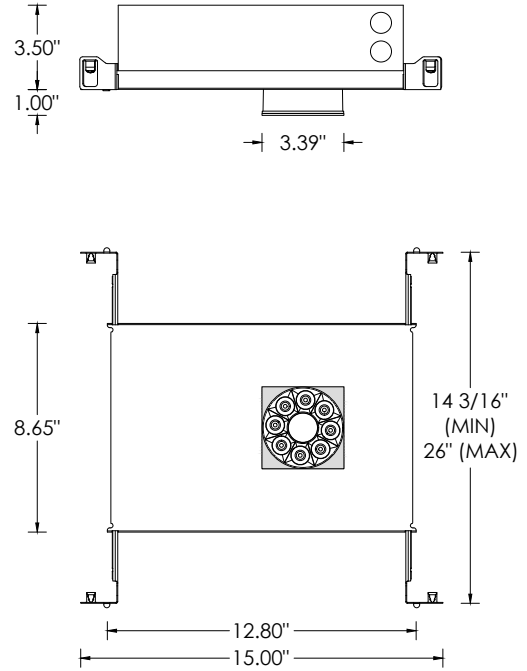

NC - NEW CONSTRUCTION HOUSING (NON-IC AND CP RATED)
IC - NEW CONSTRUCTION IC HOUSING (2200LM MAX)

