

# 3G LIGHTING

## 3G-58RMSL

5.8" RECESSED MADISON SLOT

5.8" recessed slot designed for continuous runs in various configurations  
 Suitable for drywall, wood, and other architectural ceiling applications  
 Suitable for grid ceiling and 6" techzone applications  
 Machined aluminum double gimbals. Adjustable and lockable  
 Individual fixture heads can slide within the channel  
 Easily adjustable in the field for maximum flexibility  
 Lumen range up to 4000lm (80+, 90+, and 97+ CRI options)  
 1% dimming standard with several integral driver options



<b>PROJECT:</b>		<b>TYPE:</b>	
<b>CATALOG#:</b>		<b>DATE:</b>	<b>QTY:</b>

CAT. NO	LUMEN OUTPUT	CRI	COLOR TEMP	BEAM ANGLE	VOLTAGE
<b>3G-58RMSL</b>	<b>10</b> - 1000 LUMENS	<b>S80</b> - 80+ CRI <sup>1</sup>	<b>27K</b> - 2700K	<b>10D</b> - 10° <sup>2</sup>	<b>UNV</b> - 120/277V
	<b>15</b> - 1500 LUMENS	<b>H90</b> - 90+ CRI	<b>30K</b> - 3000K	<b>20D</b> - 20°	<b>120</b> - 120V
	<b>22</b> - 2200 LUMENS	<b>H97</b> - 97+ CRI <sup>1</sup>	<b>35K</b> - 3500K	<b>40D</b> - 40°	<b>347</b> - 347V <sup>3</sup>
	<b>30</b> - 3000 LUMENS		<b>40K</b> - 4000K	<b>60D</b> - 60°	
	<b>40</b> - 4000 LUMENS			<b>90D</b> - 90° *	

\*90D reflector supplied standard with lens

DRIVER	FLANGE TYPE	GIMBAL FINISH	HOUSING INTERIOR
<b>DIM</b> - 0-10V (100-1%) <b>LE</b> - PHASE DIM <sup>4</sup> (TRIAC/ELV, 100-1%) <b>DO1</b> - 0-10V (100-0.1%) <b>DALI</b> - DALI (100-1%) <sup>5</sup> <b>DHL2</b> - LUTRON HI-LUME (1% ECOSYSTEM) <b>DMX</b> - DMX (100-0%)	<b>WT</b> - WHITE TRIM FLANGE <b>XTR</b> - TRIMLESS (MUD-IN DRYWALL) <b>FX</b> - FLANGELESS <b>GCX</b> - GRID CEILING (UNIVERSAL MOUNT) * <b>6TZ</b> - 6" TECHZONE  *Universal mounting brackets used for all grid ceiling types only. See mounting section for details	<b>NG</b> - NATURAL ALUMINUM <b>BG</b> - BLACK GIMBAL <b>WG</b> - WHITE GIMBAL	<b>BK</b> - BLACK <b>WH</b> - WHITE

OPTIONS	RUN TYPE	FIXTURE HEAD SPACING
<b>2C</b> - 2 CIRCUIT OPERATION <b>3C</b> - 3 CIRCUIT OPERATION <b>HXB</b> - BLACK HEXCELL LOUVER <b>LS</b> - LINEAR SPREAD LENS <b>PM</b> - PRISMATIC LENS <b>SB</b> - SANDBLASTED LENS <b>SF</b> - SOFTENING LENS <b>CP</b> - CHICAGO PLENUM <b>EMR</b> - EMERGENCY BATTERY <sup>6</sup> (REMOTE)  Maximum 3 optical accessories. See optical accessories page for more options	<b>S</b> - ____' (STRAIGHT) <b>L</b> - ____' X ____' (L-SHAPE) <b>U</b> - ____' X ____' X ____' (U-SHAPE) <b>R</b> - ____' X ____' (RECTANGLE/SQUARE)  U-Shape and R-Rectangle/Square not available with grid ceiling applications. Continuous runs available in 6" increments	<b>12"</b> - 12" ON CENTER <b>18"</b> - 18" ON CENTER <b>24"</b> - 24" ON CENTER <b>36"</b> - 36" ON CENTER <b>48"</b> - 48" ON CENTER <b>CUS(XX)</b> - CUSTOM SPACING *  *Specify number of fixture heads (XX)

<sup>1</sup> S80 not available in 27K. H97 available in 30K and 35K as standard  
<sup>2</sup> 10D reflector available up to 2200lm  
<sup>3</sup> 347 available in "DIM" 0-10V only (100-1%)  
<sup>4</sup> Phase dimming options available in 120V only  
<sup>5</sup> DALI-2 (Type 6) provided as standard. Please consult factory for DALI (Type 8) options  
<sup>6</sup> Emergency battery installed remotely by others. Not accessible through the inside of the fixture

BASED ON 20° BEAM ANGLE AND 3500K SOURCE (PER FIXTURE HEAD)

LUMEN OUTPUT	80+ CRI			90+ CRI			97+ CRI		
	DELIVERED LUMENS	SYSTEM WATTS	EFFICACY (LPW)	DELIVERED LUMENS	SYSTEM WATTS	EFFICACY (LPW)	DELIVERED LUMENS	SYSTEM WATTS	EFFICACY (LPW)
<b>1000LMs</b>	1080	10.3	105	951	10.3	92	886	10.3	86
<b>1500LMs</b>	1444	14.0	103	1271	14.0	91	1184	14.0	85
<b>2200LMs</b>	2089	22.0	95	1838	22.0	84	1713	22.0	78
<b>3000LMs</b>	2815	31.3	90	2477	31.3	79	2308	31.3	74
<b>4000LMs</b>	3958	43.0	92	3483	43.0	81	N/A	N/A	N/A

LUMEN OUTPUT MULTIPLIER: 27K=0.94, 30K=0.97, 35K=1.00, 40K=1.01

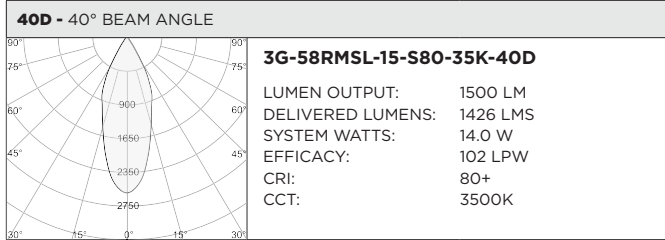
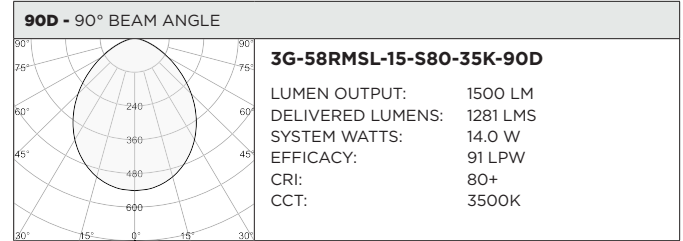
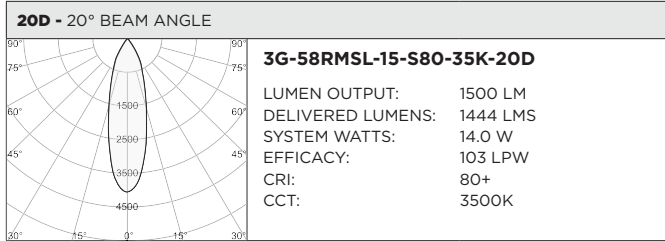
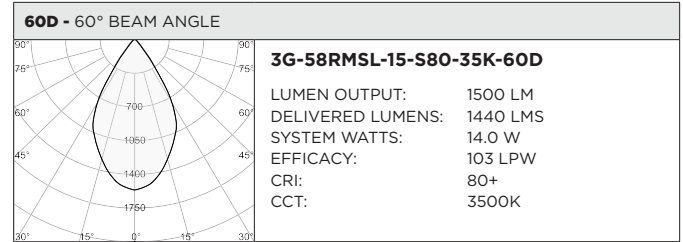
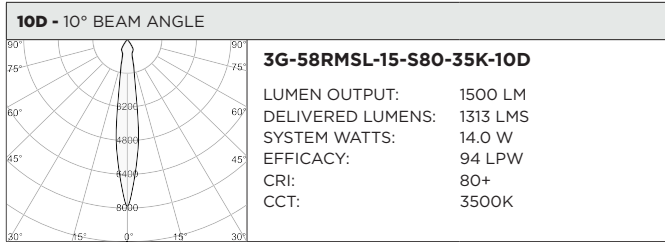

**HOUSING**

Housing constructed in extruded aluminum and cold rolled steel  
Designed for continuous runs in various configurations. Available in 6" increments  
Maximum ceiling thickness of 1.75". Consult factory for modifications  
Standard matte black powder coated finish with optional matte white finish  
Trim flange with matte white powder coated finish and minimal 0.400" overlap  
Trimless model features a satin coat mudding flange for seamless ceiling integration

**ADJUSTABILITY**

Solid aluminum, 70mm machined double gimbals with dual axis  
adjustability (45°x35°)  
Individual fixture heads can slide left or right within the channel. Easily  
adjustable in field  
Each double gimbal can be locked into place

**OPTICS**

Regressed LED source for enhanced glare control  
Proprietary anodized, aluminum reflectors are field replaceable (10°  
reflector not interchangeable)  
Available in 10°, 20°, 40°, 60° and 90°

**LISTING**

ETL listed and conforms to UL1598 standard. Certified to CSA22.2 No.250.0.  
Rated for indoor dry or damp locations

**WARRANTY**

5 Year Warranty on LED and drivers  
Manufacturer 1 Year Warranty for defects in material and workmanship  
under normal use  
Ambient temperature at fixture should not exceed 25°C

**ELECTRICAL**

Standard 0-10V, constant current drivers with 100-1% dimming range  
and >0.9 power factor  
Standard 120/277V universal voltage drivers. Optional 347V, 0-10V driver  
Lutron EcoSystem and eldoLED DALI options available with 100-1% dimming  
eldoLED 0-10V, 100-0.01% dimming range available (D01)  
DMX drivers available with 100-0% dimming range  
120V Forward Phase/Reverse Phase driver option with 100-1% dimming  
Individual fixture sections can be wired independently  
All drivers are integral and easily accessible through the channel aperture  
Remote emergency battery operates for 90 minutes at 10W (not  
accessible within channel)

**LED SYSTEM**

Citizen LED module (field replaceable)  
Color consistency <2 SDCM  
Standard (80+ CRI). Optional (90+ and 97+ CRI)  
Available in 27K, 30K, 35K, and 40K  
L90 >50,000 hours  
5 Year Warranty

**MOUNTING**

New construction housing suspended via 1/4" threaded rod or  
suspension cables (by others)  
Trim fixture designed for use in drywall, wood, and other architectural  
ceiling materials  
Trimless fixture designed for use in drywall, mud-in ceiling applications  
Flangeless fixture designed for use in wood ceilings  
Suitable for various grid ceiling applications (see mounting details)

**HARD CEILING**

**WT - TRIM**

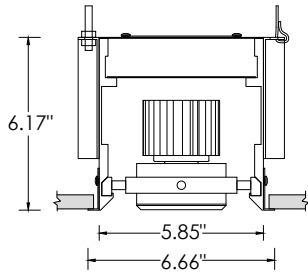

RECOMMENDED CEILING OPENING 6.25"

**XTR - TRIMLESS**

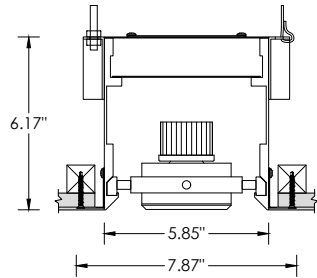

RECOMMENDED CEILING OPENING 6.25"

**FX - FLANGELESS**

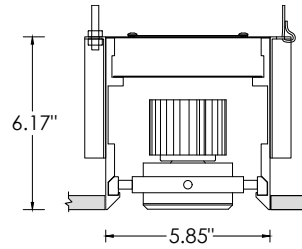

RECOMMENDED CEILING OPENING 5.90"

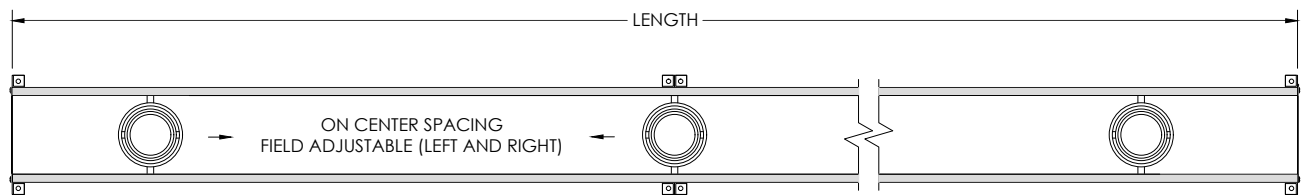

**HARD CEILING : MOUNTING DETAILS**

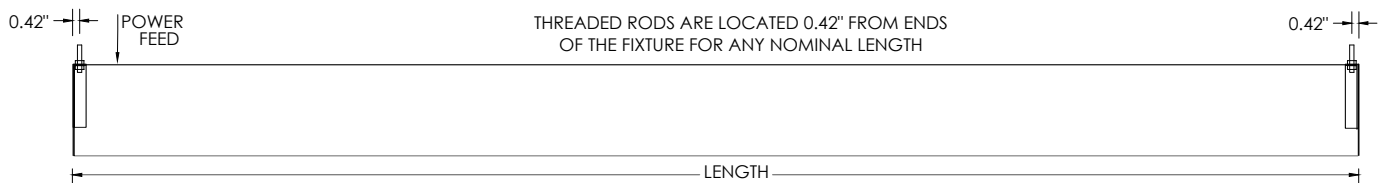

**GRID CEILING**

**9L - 9/16" LAYIN**

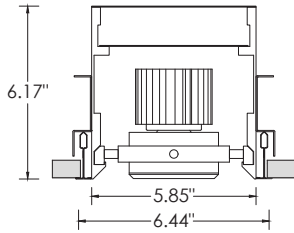

**9TG - 9/16" TEGULAR**

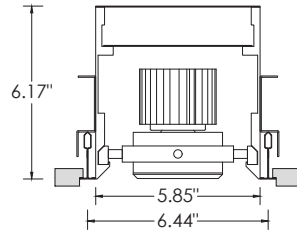

**15L - 15/16" LAYIN**

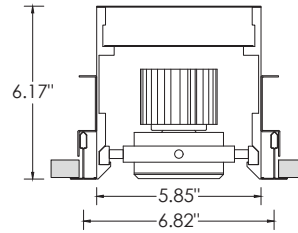

**15TG - 15/16" TEGULAR**

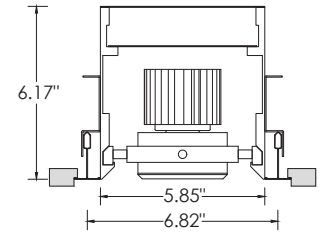

**9ST - 9/16" SLOT TEE TEGULAR**

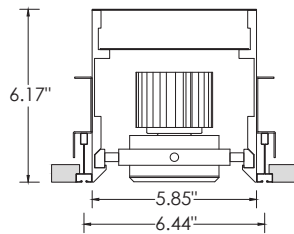

**6TZ - TECHZONE**

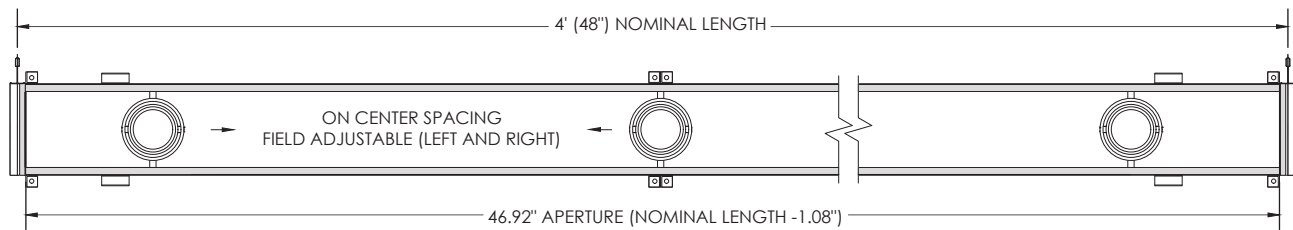
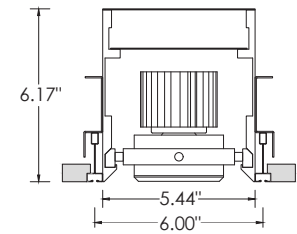

**GRID CEILING : MOUNTING DETAILS**

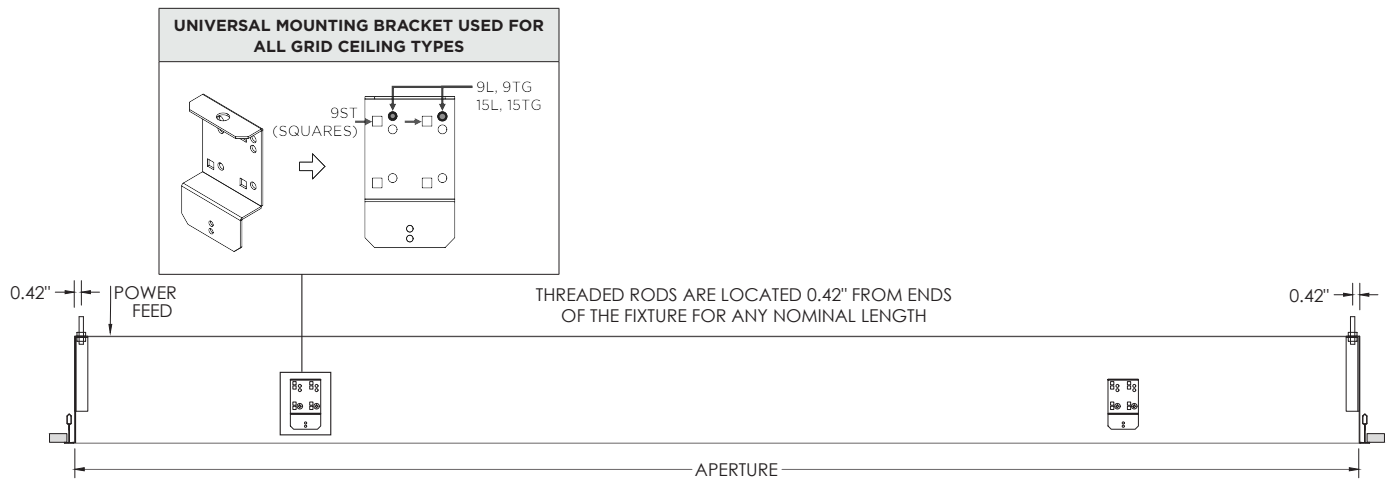

**GIMBAL ADJUSTABILITY**

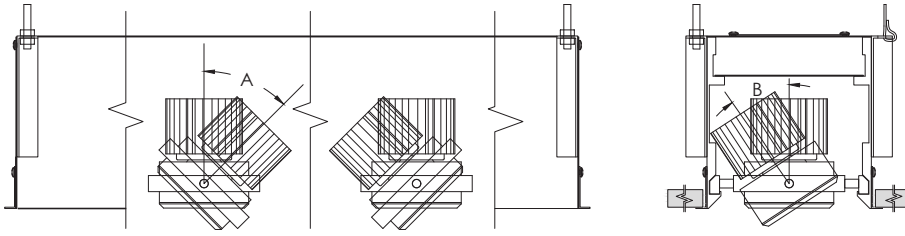

LUMEN OUTPUT	A	B
Up to 2200lm	45°	45°
3000lm/4000lm	45°	35°
5000lm	45°	20°

**PATTERNS**

Specify pattern shape and overall dimensions as shown below  
 Patterns are connected with 12"x12" mitered corner sections (Fixture heads not available)  
 Please consult factory for custom patterns and shapes not shown below

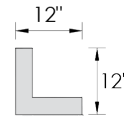

L-SHAPE	U-SHAPE	RECTANGLE/SQUARE
Provide dimensions of AxB Example: <b>L</b> - 6'x8'	Provide dimensions of AxBxC Example: <b>U</b> - 8'x10'x6"	Provide dimensions of AxB Example: <b>R</b> - 10'x8'