

# 3G LIGHTING

## 3G-RC2

2 LIGHT MADISON  
TRIM & TRIMLESS

New construction housing with IC housing option available  
Trim fixture designed to conceal internal hardware  
Trimless fixture features a proprietary aluminum mudding flange  
Machined aluminum double gimbals. Adjustable and lockable  
Regressed LED source for enhanced glare control  
Lumen range up to 4000lm (80+, 90+, and 97+ CRI options)  
1% dimming standard with several integral driver options



<b>PROJECT:</b>		<b>TYPE:</b>	
<b>CATALOG#:</b>		<b>DATE:</b>	<b>QTY:</b>

CAT. NO	LUMEN OUTPUT	CRI	COLOR TEMP	BEAM ANGLE	VOLTAGE
<b>3G-RC2</b>	<b>10</b> - 1000 LUMENS	<b>S80</b> - 80+ CRI <sup>1</sup>	<b>27K</b> - 2700K	<b>10D</b> - 10° <sup>2</sup>	<b>UNV</b> - 120/277V
	<b>15</b> - 1500 LUMENS	<b>H90</b> - 90+ CRI	<b>30K</b> - 3000K	<b>20D</b> - 20°	<b>120</b> - 120V
	<b>22</b> - 2200 LUMENS	<b>H97</b> - 97+ CRI <sup>1</sup>	<b>35K</b> - 3500K	<b>40D</b> - 40°	<b>347</b> - 347V <sup>3</sup>
	<b>30</b> - 3000 LUMENS		<b>40K</b> - 4000K	<b>60D</b> - 60°	
	<b>40</b> - 4000 LUMENS			<b>90D</b> - 90° *	

\*90D reflector supplied standard with lens

DRIVER	FLANGE TYPE	GIMBAL FINISH	HOUSING INTERIOR
<b>DIM</b> - 0-10V (100-1%) <b>LE</b> - PHASE DIM <sup>4</sup> <small>(TRIAC/ELV, 100-1%)</small> <b>DO1</b> - 0-10V (100-0.1%) <b>DALI</b> - DALI (100-1%) <sup>5</sup> <b>DHL2</b> - LUTRON HI-LUME <small>(1% ECOSYSTEM)</small> <b>DMX</b> - DMX (100-0%)	<b>WT</b> - WHITE TRIM <b>ST</b> - SILVER TRIM <b>BT</b> - BLACK TRIM <b>CT</b> - CUSTOM <b>XTR</b> - TRIMLESS (MUD-IN DRYWALL)	<b>NG</b> - NATURAL ALUMINUM <b>BG</b> - BLACK <b>WG</b> - WHITE	<b>BK</b> - BLACK <b>WH</b> - WHITE <b>CF</b> - CUSTOM

HOUSING TYPE	OPTIONS
<b>NC</b> - NEW CONSTRUCTION (NON-IC) <b>IC</b> - IC HOUSING <sup>6</sup>	<b>2C</b> - 2 CIRCUIT <b>HXB</b> - BLACK HEXCELL LOUVER <b>LS</b> - LINEAR SPREAD LENS <b>PM</b> - PRISMATIC LENS <b>SF</b> - SOFTENING LENS <b>STB</b> - BLACK SNOOT <b>STN</b> - NATURAL SNOOT <b>CP</b> - CHICAGO PLENUM <b>BH</b> - C-CHANNEL BAR HANGERS <b>EMR</b> - EMERGENCY BATTERY <sup>7</sup> <small>(REMOTE)</small> <small>Maximum 3 optical accessories. See optical accessories page for more options</small>

<sup>1</sup> S80 not available in 27K. H97 available in 30K and 35K as standard and available up to 3000lm  
<sup>2</sup> 10D reflector available up to 2200lm  
<sup>3</sup> 347 available in "DIM" 0-10V only (100-1%)  
<sup>4</sup> Phase dimming options available in 120V only  
<sup>5</sup> DALI-2 (Type 6) provided as standard. Please consult factory for DALI (Type 8) options  
<sup>6</sup> IC Housing available up to 2200lm  
<sup>7</sup> Emergency battery installed remotely by others. Not accessible through the inside of the fixture

BASED ON 20° BEAM ANGLE AND 3500K SOURCE

LUMEN OUTPUT	80+ CRI			90+ CRI			97+ CRI		
	DELIVERED LUMENS	SYSTEM WATTS	EFFICACY (LPW)	DELIVERED LUMENS	SYSTEM WATTS	EFFICACY (LPW)	DELIVERED LUMENS	SYSTEM WATTS	EFFICACY (LPW)
<b>1000LMs</b>	1080	10.3	105	951	10.3	92	886	10.3	86
<b>1500LMs</b>	1444	14.0	103	1271	14.0	91	1184	14.0	85
<b>2200LMs</b>	2089	22.0	95	1838	22.0	84	1713	22.0	78
<b>3000LMs</b>	2815	31.3	90	2477	31.3	79	2308	31.3	74
<b>4000LMs</b>	3958	43.0	92	3483	43.0	81	N/A	N/A	N/A

LUMEN OUTPUT MULTIPLIER: 27K=0.94, 30K=0.97, 35K=1.00, 40K=1.01

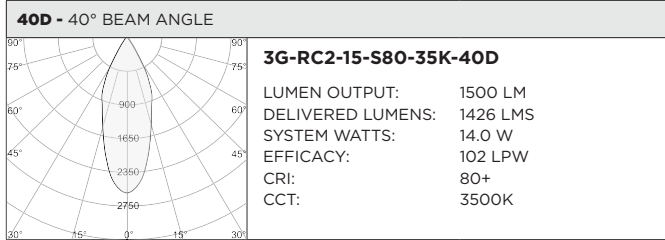
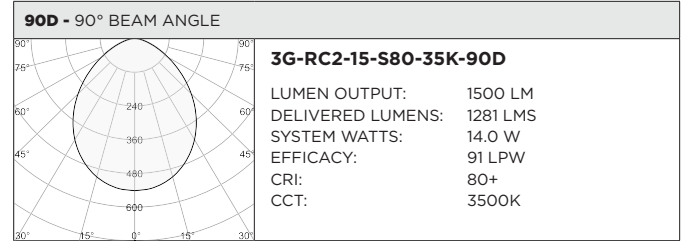
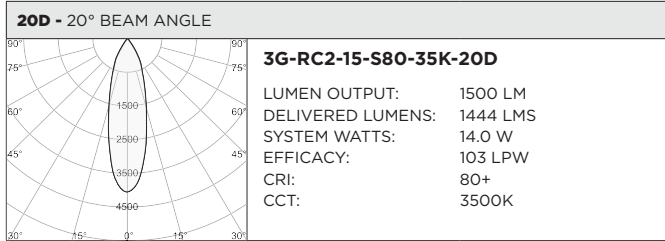
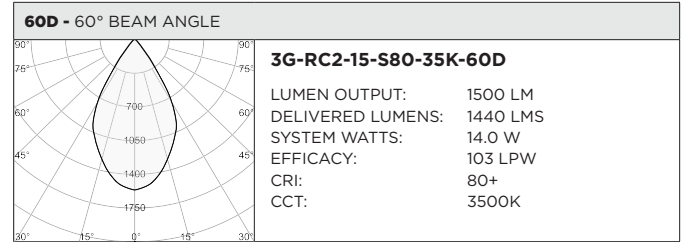
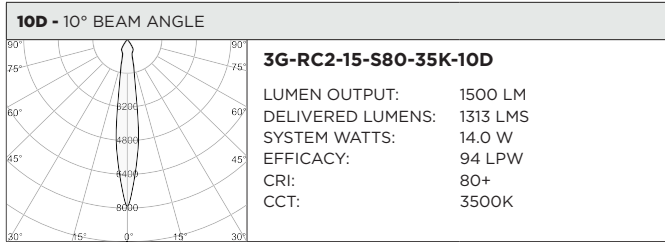

**HOUSING**

New construction housing with IC housing option available  
Housing fabricated in cold rolled steel. Standard black powder coated finish  
Maximum ceiling thickness of 1". Consult factory for modifications  
All housing options designed to be easily converted in field to trim or trimless with minimal components  
Housings are rated for #12 AWG, (4 in, 4 out), 90°C conductors and through branch wiring

**TRIM**

Features a 3/4" removable trim assembly designed to conceal inner hardware

**TRIMLESS**

Aluminum mudding flange features a unique reveal that emulates drywall  
Integral aluminum blocking support provided to ensure fixture is properly secured within ceiling structure

**ADJUSTABILITY**

Solid aluminum double gimbal with dual axis adjustability  
Each double gimbal can be locked in place

**OPTICS**

Regressed LED source for enhanced glare control  
Proprietary anodized, aluminum reflectors are field replaceable (10° reflector not interchangeable)  
Available in 10°, 20°, 40°, 60° and 90°

**LISTING**

ETL listed and conforms to UL1598 standard. Certified to CSA22.2 No.250.0.  
Rated for indoor dry or damp locations

**WARRANTY**

5 Year Warranty on LED and drivers  
Manufacturer 1 Year Warranty for defects in material and workmanship under normal use  
Ambient temperature at fixture should not exceed 25°C

**ELECTRICAL**

Standard 0-10V, constant current drivers with 100-1% dimming range and >0.9 power factor  
Standard 120/277V universal voltage drivers. Optional 347V, 0-10V drivers  
120V Forward Phase/Reverse Phase driver option with 100-1% dimming range  
eldoLED 0-10V driver option available with 100-0.01% dimming range  
eldoLED DALI and Lutron EcoSystem driver options available with 100-1% dimming range  
DMX driver option available with 100-0% dimming range  
All drivers are integral and easily accessible through fixture aperture

**LED SYSTEM**

Citizen LED module (field replaceable)  
Color consistency <2 SDCM  
Standard (80+ CRI). Optional (90+ and 97+ CRI)  
Available in 27K, 30K, 35K, and 40K  
L90 >50,000 hours  
5 Year Warranty

**MOUNTING**

Trim fixture designed for use in drywall, wood, acoustic ceiling tiles, and other architectural ceiling materials  
Trimless fixture designed for use in drywall, mud-in ceiling applications  
Butterfly brackets compatible with 1/2" x 1/2" channel, 1/2", 5/8", 3/4" bar hanger, 1/2" EMT, and furring strips (supplied by others)

**TRIM HOUSING OPTIONS**

- NC** - NEW CONSTRUCTION (NON-IC)
- IC** - IC HOUSING (2200LM MAX)
- CP** - CHICAGO PLENUM HOUSING

LUMEN OUTPUT	A	B	C
Up to 2200lm	45°	45°	45°
2200lm/3000lm	35°	45°	35°
4000lm	20°	45°	30°

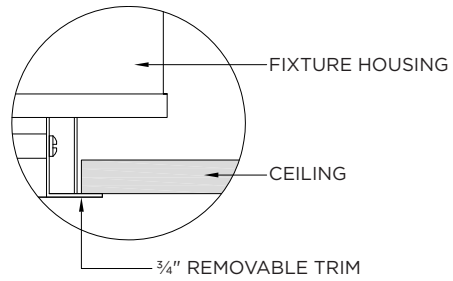
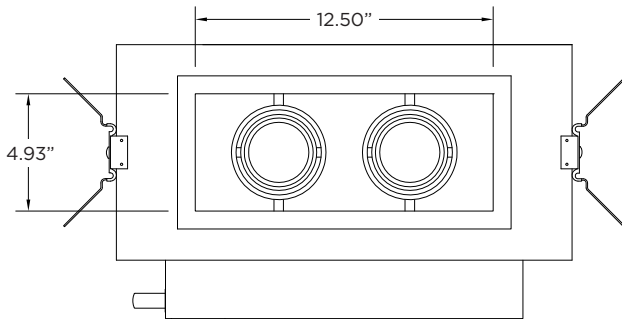
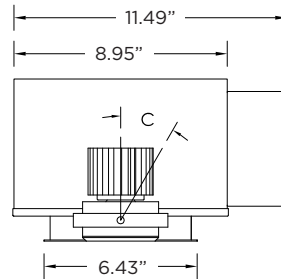
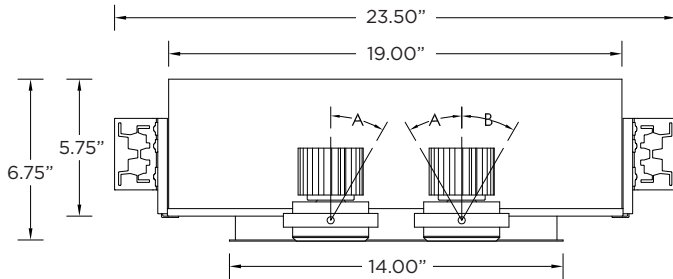

**TRIMLESS HOUSING OPTIONS**

- NC** - NEW CONSTRUCTION (NON-IC)
- IC** - IC HOUSING (2200LM MAX)
- CP** - CHICAGO PLENUM HOUSING

LUMEN OUTPUT	A	B	C
Up to 2200lm	45°	45°	45°
3000lm/2000lm	35°	45°	35°
4000lm	20°	45°	30°

