

## 4.5" WALLWASH CYLINDER - PENDANT

CABLE PENDANT MOUNT



### COMPONENTS

#### STANDARD CANOPY

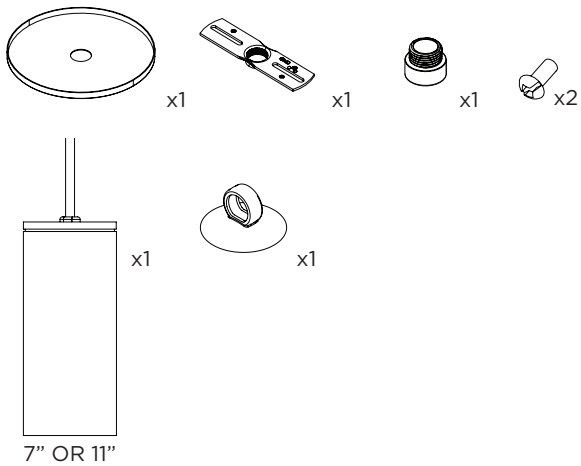

#### CONDUIT FEED CANOPY

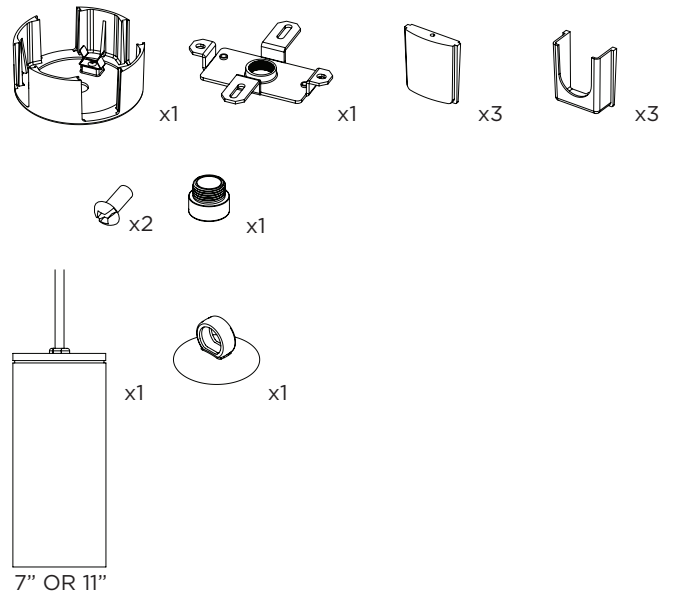

#### 4" OCTAGONAL J-BOX REQUIRED FOR INSTALLATION

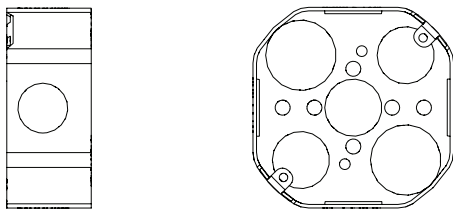

JUNCTION BOX (BY OTHERS)

#### INSTRUCTION KEY

#### INFORMATION

- ADDITIONAL
- ATTENTION
- POWER ON
- POWER OFF

INSTALLATION SHOULD ONLY BE PERFORMED BY A CERTIFIED ELECTRICIAN  
 REFER TO LOCAL/NATIONAL CODES FOR PROPER INSTALLATION  
 FAILURE TO FOLLOW INSTALLATION INSTRUCTION MAY VOID THE WARRANTY  
 DO NOT TOUCH LEDS. LEDS MUST BE PROTECTED FROM MECHANICAL STRESS OR DEBRIS  
 TURN OFF POWER DURING INSTALLATION OR SERVICING

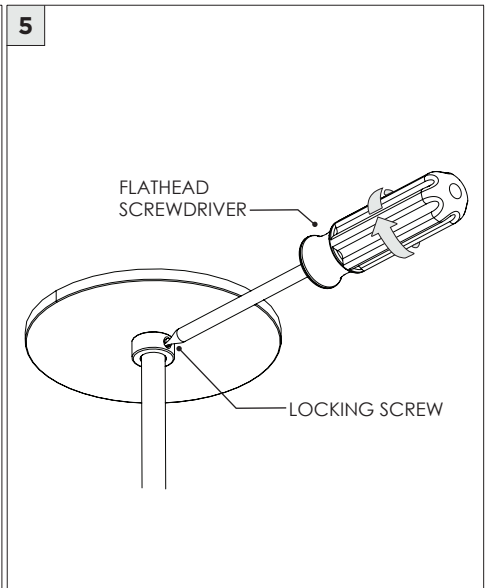
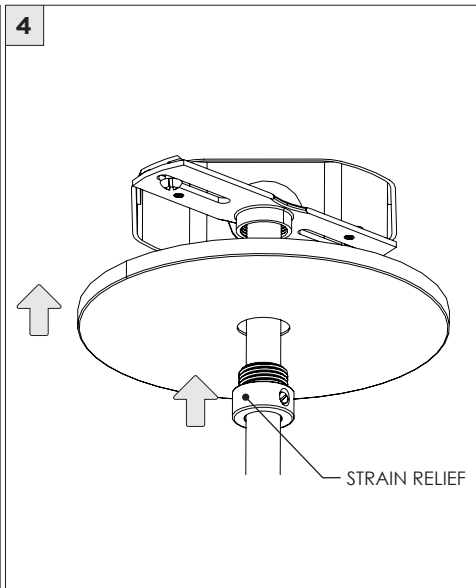
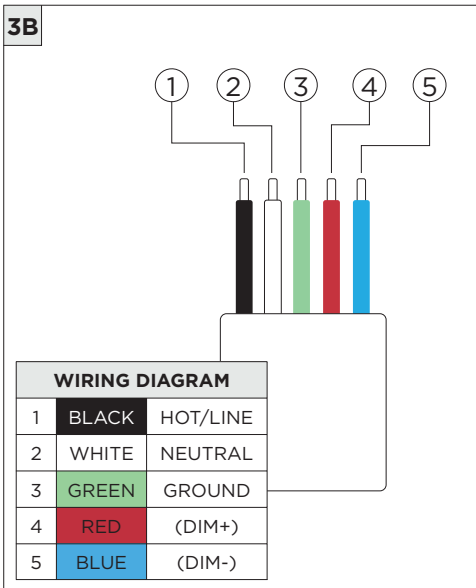
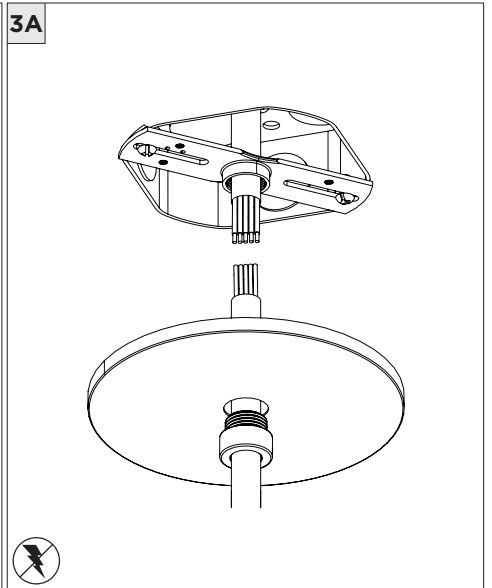
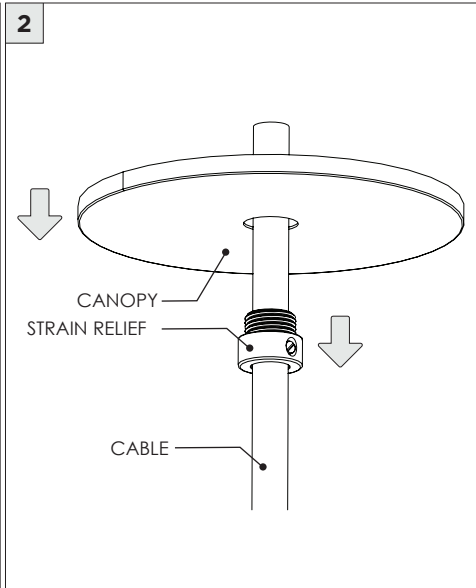
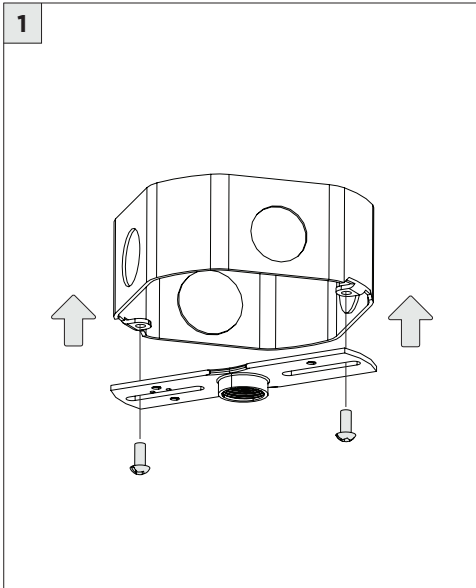

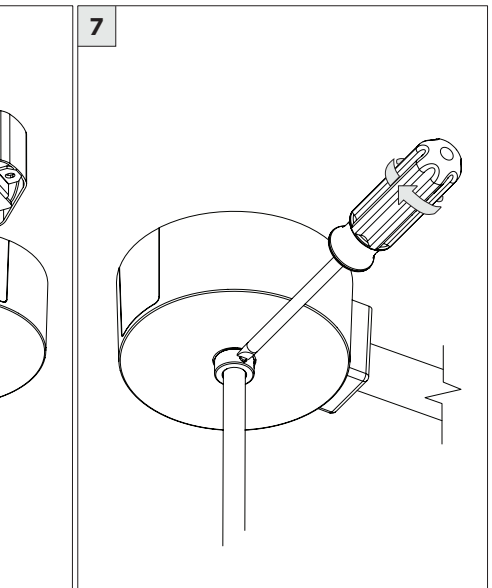
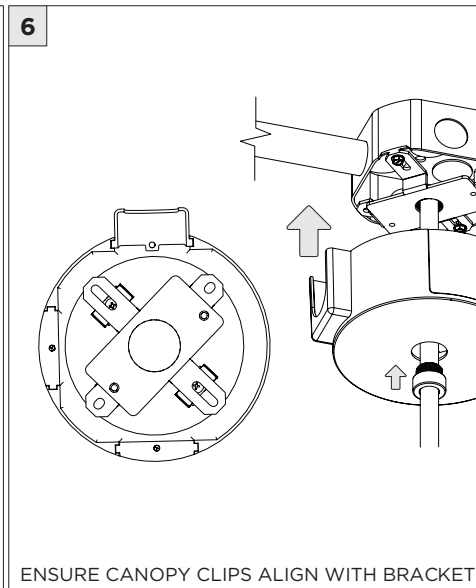
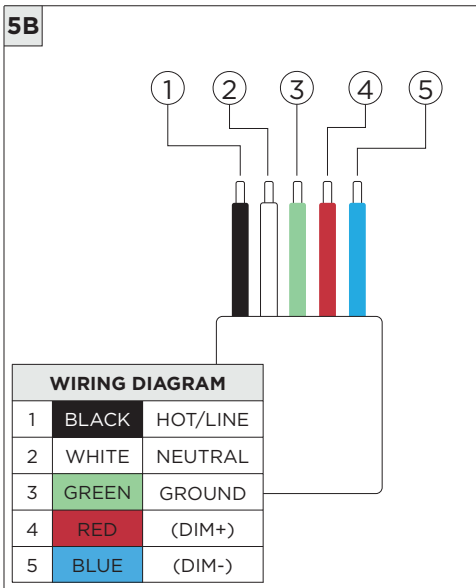
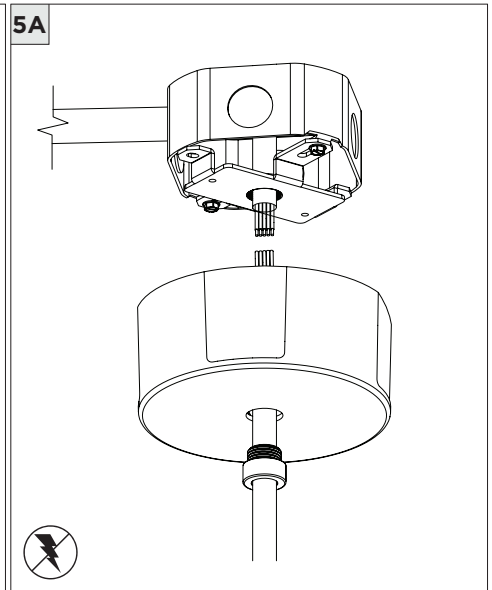
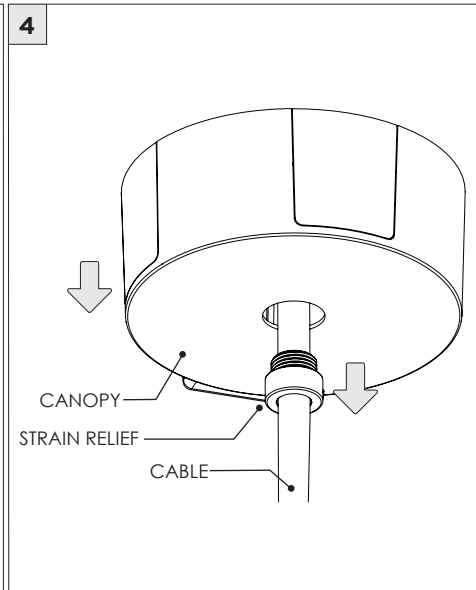
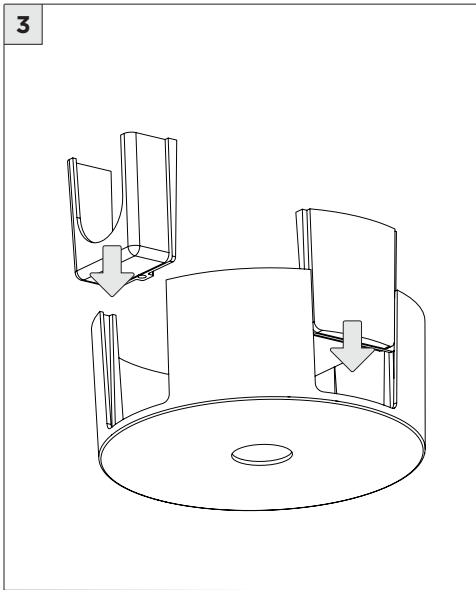
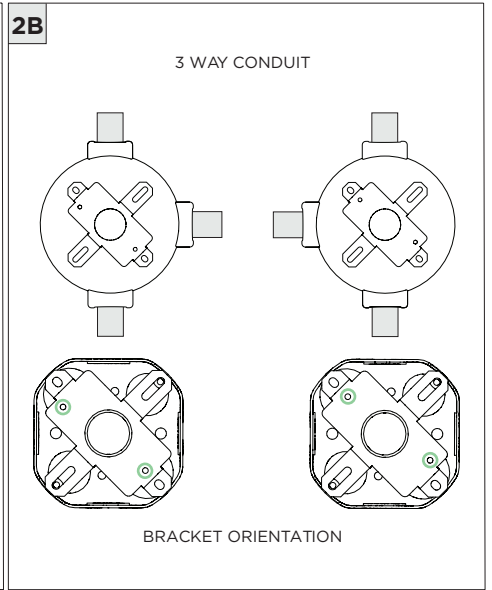
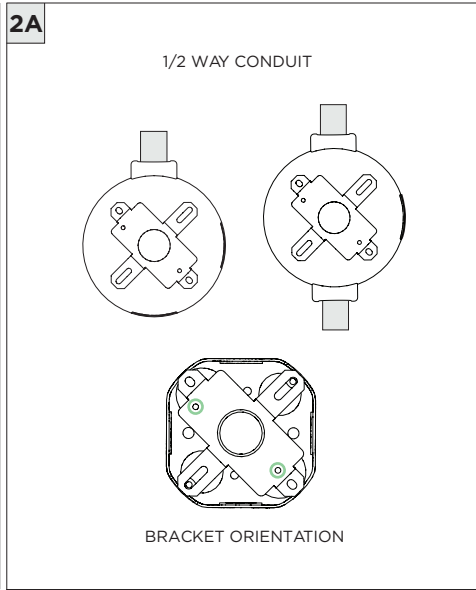
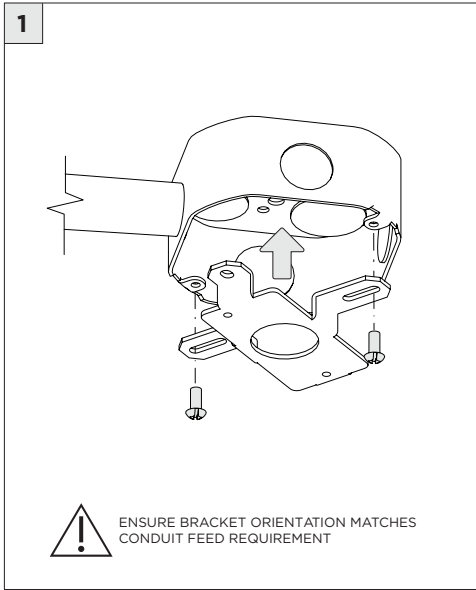

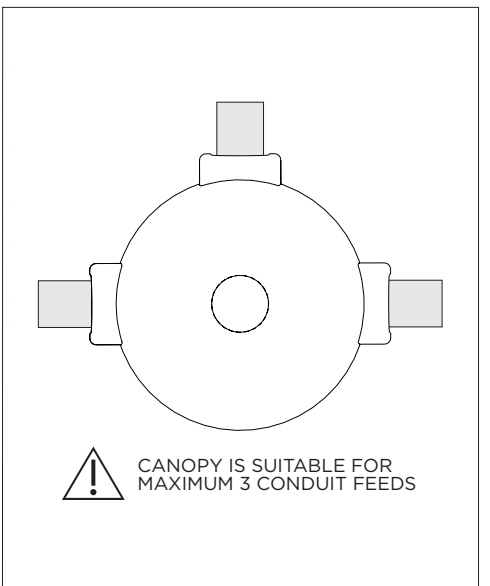
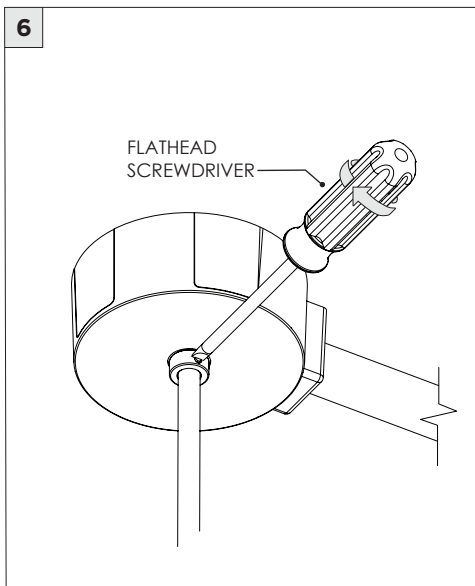
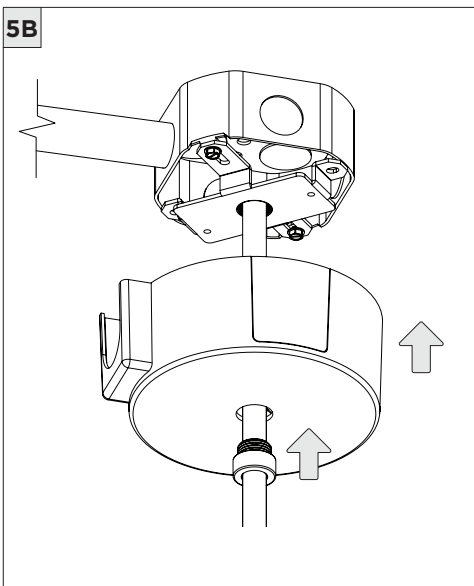
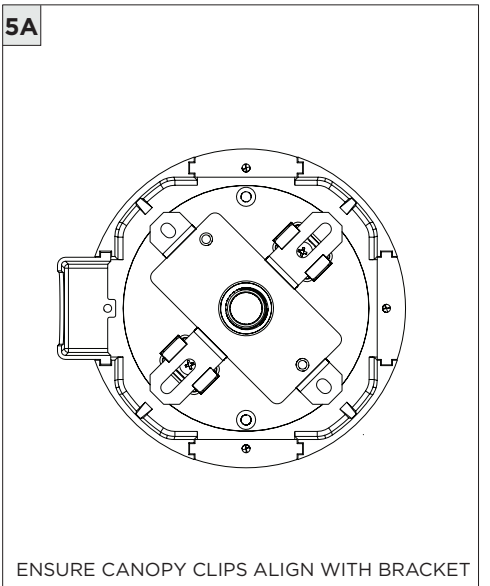
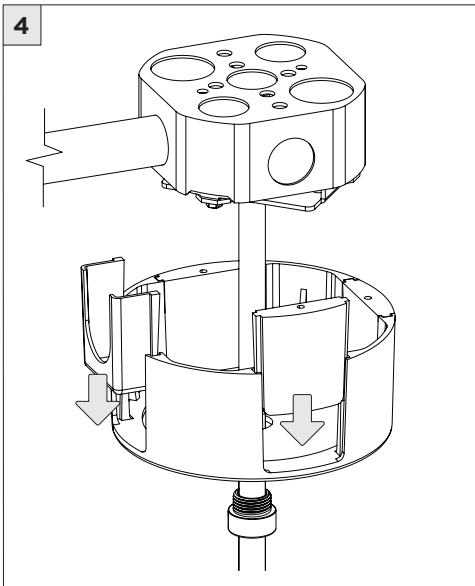
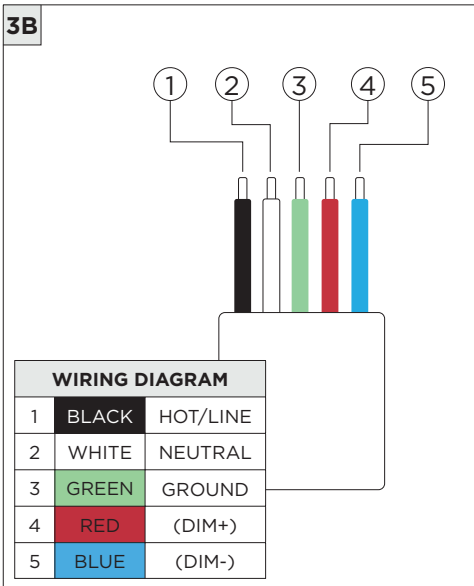
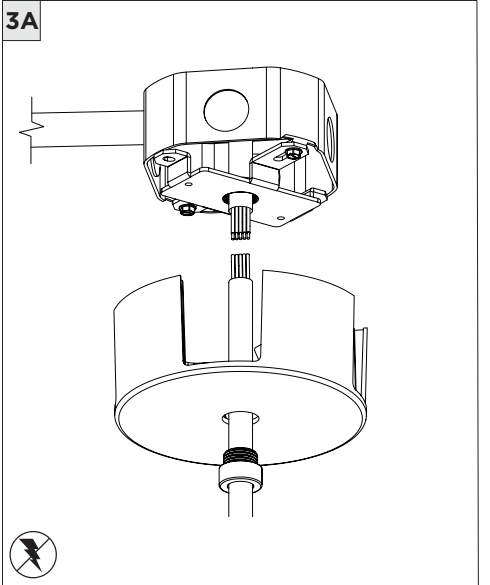
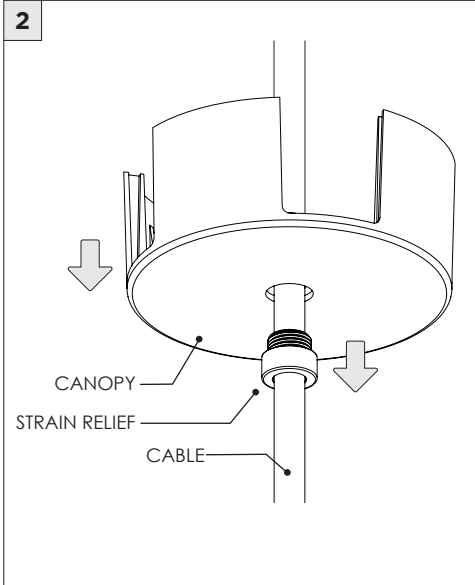
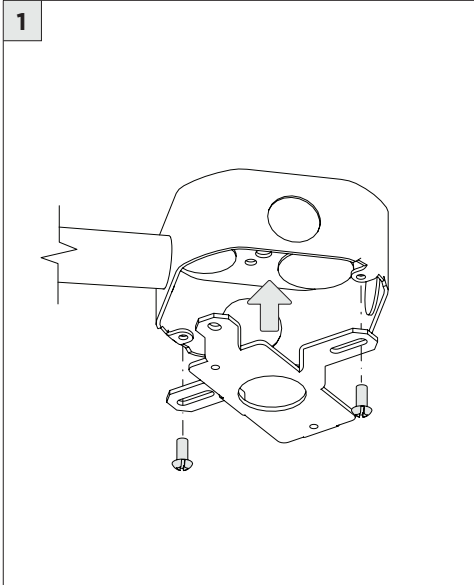

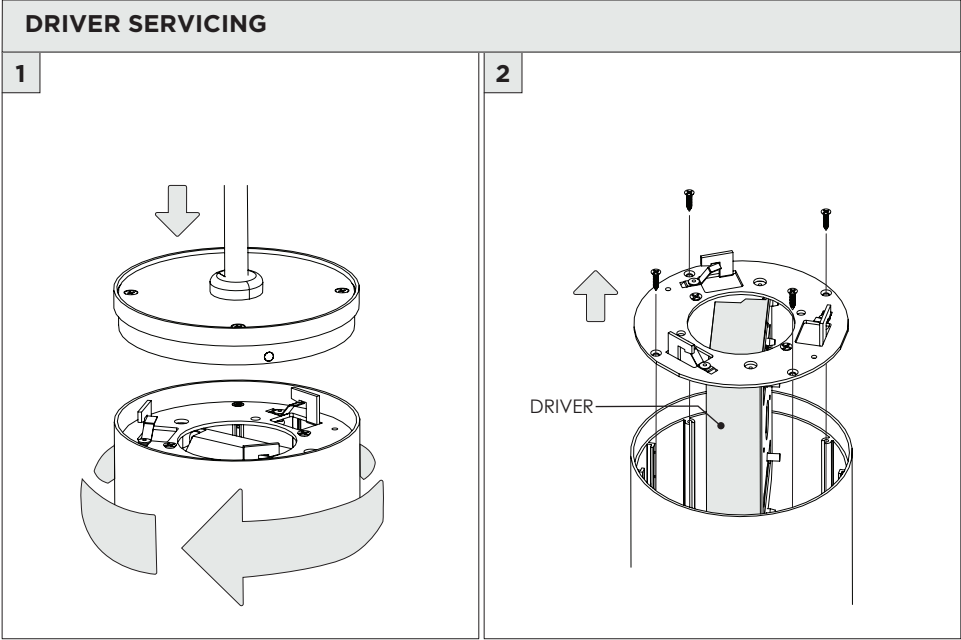

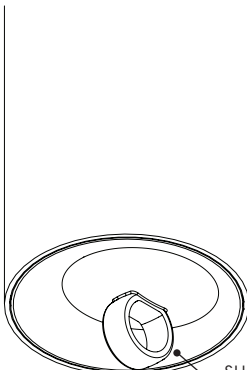
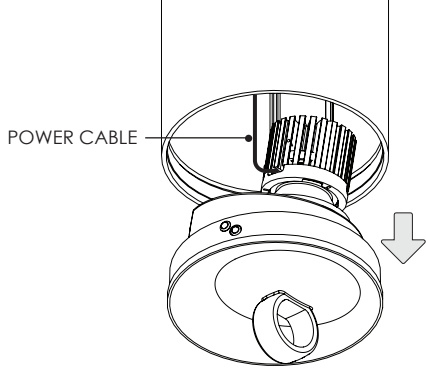
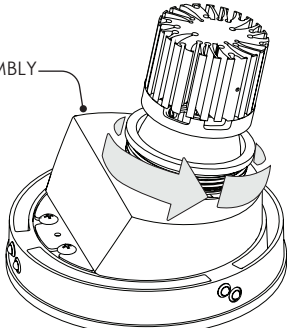
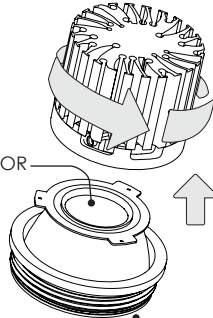
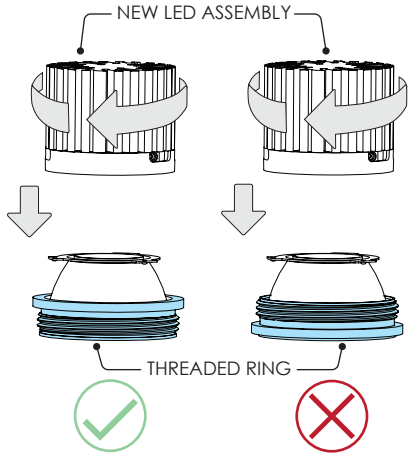
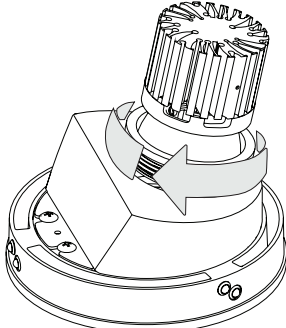
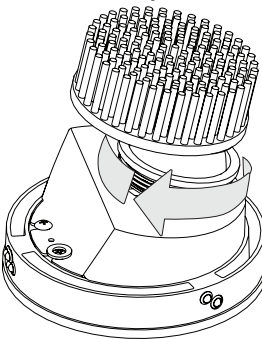
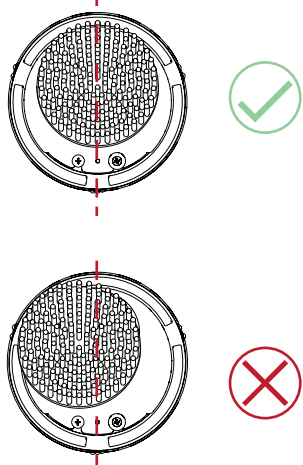
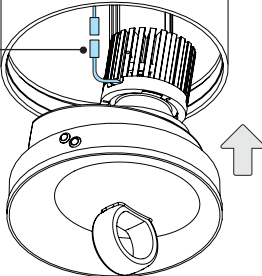
LED SERVICING		
<p><b>1</b></p>  <p>SUCTION CUP</p>	<p><b>2</b></p>  <p>POWER CABLE</p> <p>ENSURE TO DISCONNECT POWER CABLE</p>	<p><b>3</b></p>  <p>INSERT ASSEMBLY</p>
<p><b>4</b> REPLACE LED ASSEMBLY</p>  <p>LED ASSEMBLY</p> <p>REFLECTOR</p> <p>THREADED RING</p>	<p><b>5</b></p>  <p>NEW LED ASSEMBLY</p> <p>THREADED RING</p>	<p><b>6</b></p>  <p>ENSURE THE HEAT SINK IS ALIGNED WITH INSERT ASSEMBLY AND FULLY TIGHTEN THE THREADED RING</p>
<p><b>7</b></p>  <p>2200 LUMEN LED ASSEMBLY</p> <p>FOR 2200 LUMEN FIXTURES</p>	<p><b>7A</b></p> 	<p><b>8</b></p>  <p>POWER CABLE</p> <p>EXACT LED MODEL MAY VARY</p>