

1.5" aperture with one piece extruded aluminum housing  
Individual or continuous runs available. See online configurator  
Direct distribution with multiple source options and various lumen outputs  
Integrated options include Linia, Zoie, Zoie Wall Wash and non-illuminated faceplates  
Extruded acrylic lens with optimal performance and glare control  
Suitable for drywall, wood, grid ceiling, and other architectural ceiling applications  
Asymmetric optics available  
1% dimming standard with several driver options

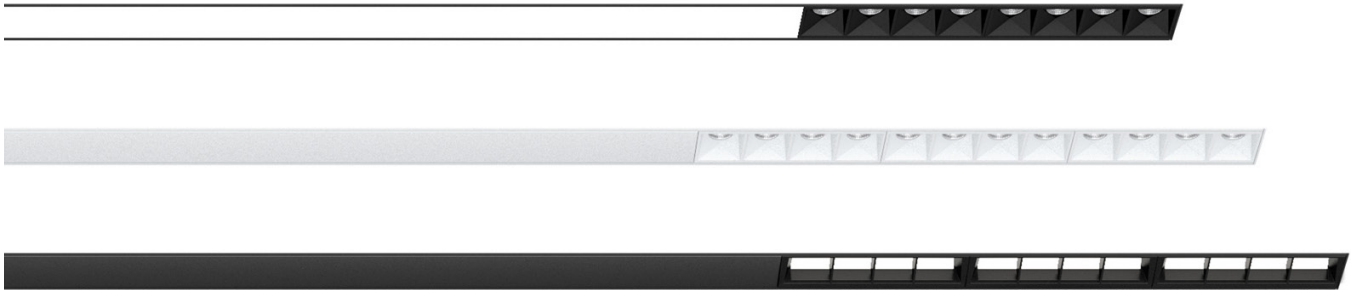

### INTEGRATED OPTIONS

1.5" LINIA



NON ILLUMINATED FACEPLATE



LINEAR ZOIE



ZOIE WALL WASH



### CONFIGURATION OPTIONS (SPECIFY PRODUCT USING ONLINE CONFIGURATOR)

#### SE - START- END

Integrated options located at start and end of run only. Available in 1' increments starting at 4'. See online configurator for length options



#### OC - ON CENTER SPACING

Integrated options with on center spacing starting at 4'(OC4) through 8' (OC8). See online configurator for run length options



**1LI - 1.5" LINIA**



**1N - NON ILLUMINATED**

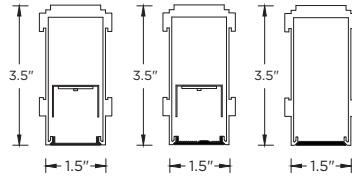

**APERTURE SIZE:** 1.5"  
**COLOR TEMP:** 27K, 30K, 35K, 40K  
**CRI:** 90+  
**R9 VALUE:** 56

**DELIVERED LUMENS:** 250 - 1000 LM/FT  
**EFFICACY:** 91 - 100 LPW \*  
**WATTAGE:** 2.5 - 10.9 W/FT \*

**OPTICS:** FLUSH, ASYMMETRIC

\* Based on 90+ CRI and 3500K

**Z4 - 4" ZOIE**



**Z8 - 8" ZOIE**



**Z12 - 12" ZOIE**

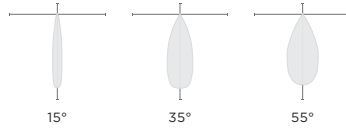
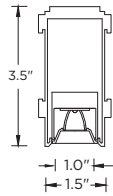

**APERTURE SIZE:** 1.0"  
**COLOR TEMP:** 27K, 30K, 35K, 40K  
**CRI:** 90+

**DELIVERED LUMENS:** 400 - 2400 LM  
**EFFICACY:** 84 - 92 LPW \*  
**WATTAGE:** 4.4 - 28.7 W \*

**OPTICS:** 15°, 35°, 55°

\* Based on 90+ CRI, 35° and 3500K

**Z4WW - 4" ZOIE WALL WASH**



**Z8WW - 8" ZOIE WALL WASH**



**Z12WW - 12" ZOIE WALL WASH**

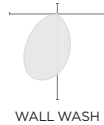
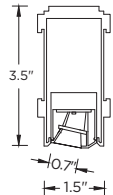

**APERTURE SIZE:** 0.7"  
**COLOR TEMP:** 27K, 30K, 35K, 40K  
**CRI:** 90+

**DELIVERED LUMENS:** 400 - 2400 LM  
**EFFICACY:** 63 - 73 LPW \*  
**WATTAGE:** 5.5 - 37.8 W \*

**OPTICS:** WALL WASH

\* Based on 90+ CRI and 3500K

**OPTICS****1.5" LINIA**

Extruded, satin acrylic lens designed for optimal performance and glare control  
High performance asymmetric optics

**LINEAR ZOIE**

4", 8", and 12" high performance Zoie downlights  
1" apertures with matte black or matte white multi-faceted louvers  
Regressed LED source for enhanced glare control  
Proprietary polycarbonate multi-faceted reflectors  
Available in 15°, 35° and 55°  
UGR <16

**ZOIE WALL WASH**

4", 8", and 12" high performance Zoie Wall Wash downlight  
0.7" aperture with matte black or matte white louver finish  
Regressed LED source for enhanced glare control  
Proprietary high performance wall wash optic and lens  
Smooth, direct and uniform illumination across the top and down the wall

**HOUSING**

Extruded aluminum housing with narrow 1.5" aperture  
Trim flange with matte white powder coated finish and minimal 0.400" overlap  
Trimless model features a satin coat mudding flange for seamless ceiling integration  
24-gauge LED reflector with high reflectance white powder coated finish  
Standard polyester powder coated matte white finish  
Non-illuminated option features an extruded aluminum faceplate with powder coated finish

**MOUNTING**

Housing suspended via 1/4" threaded rod or suspension cables (by others)  
Toolless installation with 3G's proprietary mounting system  
Internal, toolless joiner system (latch and hook) easily connects multiple sections together  
LED reflectors remain in each section during installation with 3G's locking spring system  
Trim fixture designed for use in drywall, wood, and other architectural ceiling materials  
Trimless fixture designed for use in drywall, mud-in ceiling applications  
Flangeless fixture designed for use in wood ceilings. New construction only  
Suitable for various grid ceiling applications (see mounting details)  
Fixture weight: +/- 3 lb/ft

**LED SYSTEM****1.5" LINIA**

Proprietary LED system with color consistency < 3 SDCM  
Available in 27K, 30K, 35K, and 40K  
Standard 90+ CRI with R9 value of 56  
L90 > 60,000 hours

**LINEAR ZOIE**

Osram LED source  
Available in 27K, 30K, 35K, and 40K  
Standard 90+ CRI  
Color consistency < 2 SDCM  
L90 > 60,000 hours

**ZOIE WALL WASH**

Cree LED source  
Available in 27K, 30K, 35K, and 40K  
Standard 90+ CRI  
Color consistency < 2 SDCM  
L90 > 60,000 hours

**ELECTRICAL**

Luminaires are pre-wired with factory installed quick connects and branch circuit wiring  
Standard 0-10V, constant current drivers with 100-1% dimming range and >0.9 power factor  
120V Forward Phase/Reverse Phase driver option with 100-1% dimming range  
Standard 120/277V universal voltage with several driver options  
All drivers are integral and easily accessible through luminaire aperture

**LISTING**

ETL listed and conforms to UL1598 standard. Certified to CSA22.2 NO.250.0.  
Rated for indoor dry or damp locations

**WARRANTY**

5 Year Warranty on LED and drivers Manufacturer  
1 Year Warranty for defects in material and workmanship under normal use  
Ambient temperature at fixture should not exceed 25°C

**HARD CEILING**

**WT - TRIM**

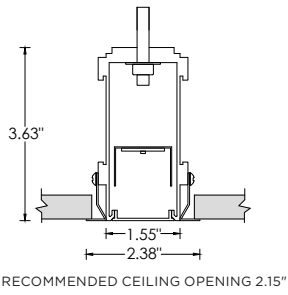

**XTR - TRIMLESS (DRYWALL)**

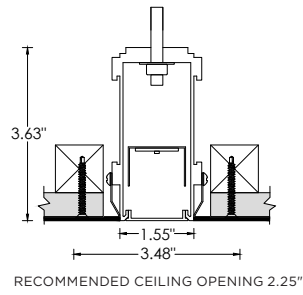

**FX - FLANGELESS (NEW CONSTRUCTION)**

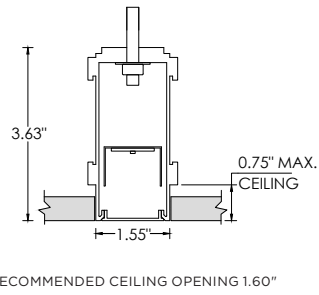

**HARD CEILING : MOUNTING DETAILS**

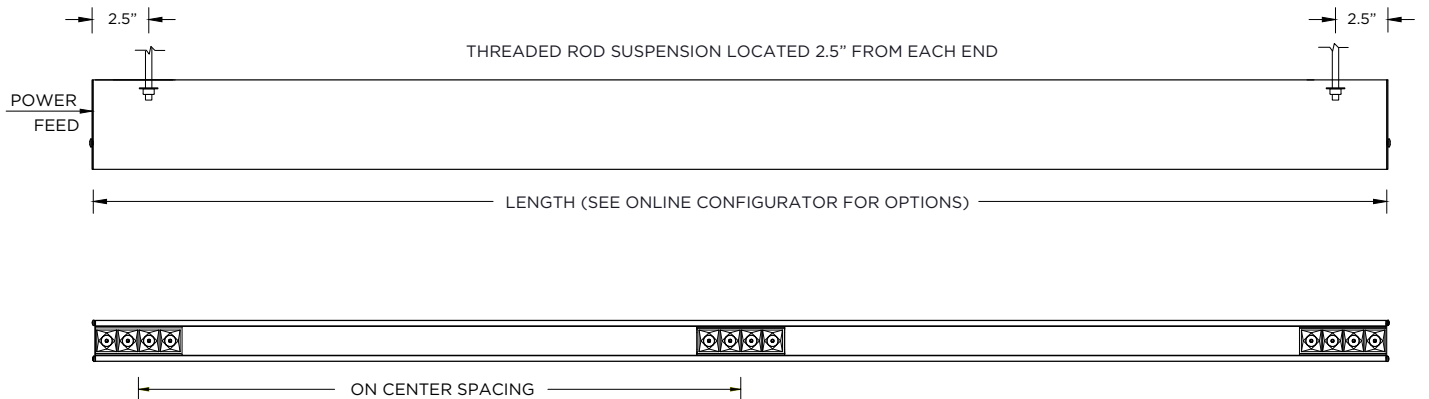
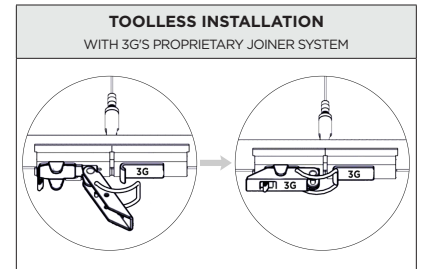

**GRID CEILING**

**9L - 9/16" LAYIN**

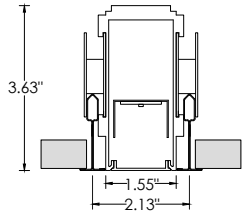

**9TG - 9/16" TEGULAR**

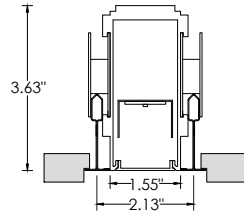

**15L - 15/16" LAYIN**

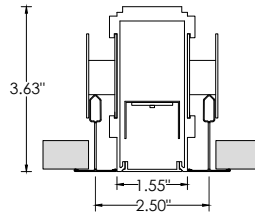

**15TG - 15/16" TEGULAR**

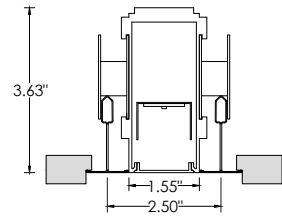

**9TP - 9/16" TEGULAR**

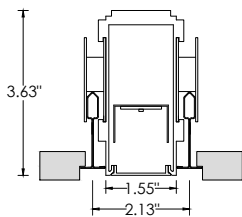

**15TP - 15/16" TEGULAR**

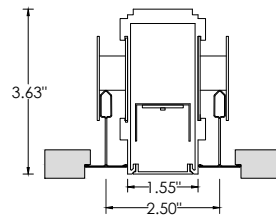

**9ST - 9/16" SLOT TEE TEGULAR**

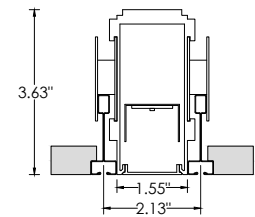

**GRID CEILING : MOUNTING DETAILS**

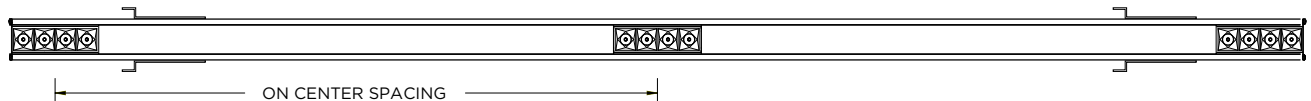
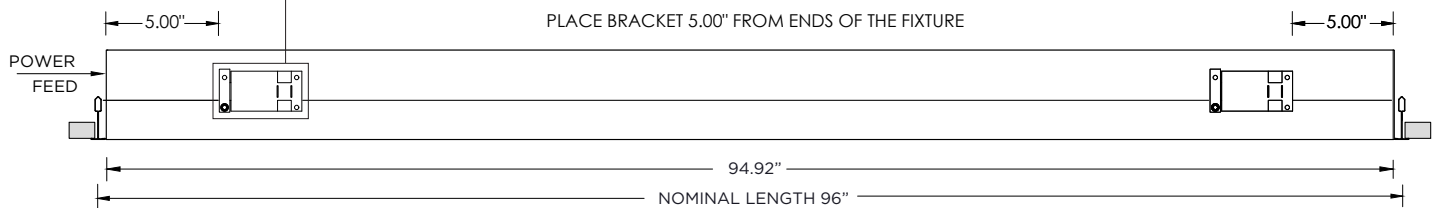
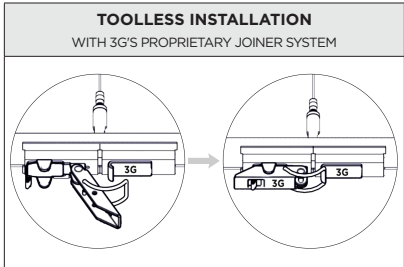
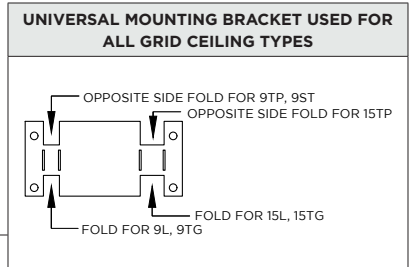

**1.5" LINIA - BASED ON 90+ CRI AND 3500K SOURCE**

LENS OPTION	DELIVERED LUMENS (LM/FT)	SYSTEM WATTS (W/FT)	EFFICACY (LPW)
<b>FLUSH</b>	250	2.5	99
	500	5.0	100
	750	7.9	95
	1000	10.9	91
<b>ASYMMETRIC</b>	250	2.5	96
	500	5.0	95
	750	7.9	93
	1000	10.9	89

LUMEN OUTPUT MULTIPLIER: 27K=0.94, 30K=0.97, 35K=1.00, 40K=1.01

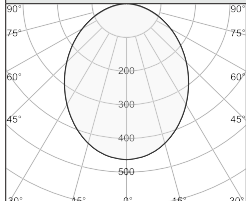
FL - FLUSH	
	<p><b>3G-1RLI-L500-H90-FL</b></p> <p>DELIVERED LUMENS: 500 LM/FT            SYSTEM WATTS: 5.0 W/FT            EFFICACY: 100 LPW            CRI: 90+            CCT: 3500K            LENS OPTION: FLUSH</p>

**LINEAR ZOIE - BASED ON 35°, 90+ CRI AND 3500K SOURCE**

FIXTURE TYPE	DELIVERED LUMENS	SYSTEM WATTS	EFFICACY (LPW)
<b>Z4 - 4" ZOIE</b>	400	4.4	91
	800	9.2	87
<b>Z8 - 8" ZOIE</b>	800	8.8	91
	1600	18.7	86
<b>Z12 - 12" ZOIE</b>	1200	13.1	92
	2400	28.7	84

LUMEN OUTPUT MULTIPLIER: 27K=0.93, 30K=0.96, 35K=1.00, 40K=1.02

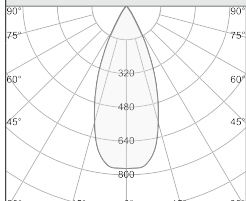
35D - 35° BEAM ANGLE	
	<p><b>3G-Z4-08-H90-35K-35D</b></p> <p>LUMET OUTPUT: 800 LM            DELIVERED LUMENS: 800 LM            SYSTEM WATTS: 9.2 W            EFFICACY: 87 LPW            CRI: 90+            CCT: 3500K</p>

**ZOIE WALL WASH - BASED ON WALL WASH OPTIC, 90+ CRI, AND 3500K SOURCE**

FIXTURE TYPE	DELIVERED LUMENS	SYSTEM WATTS	EFFICACY (LPW)
<b>Z4WW - 4" ZOIE WW</b>	400	5.5	73
	800	12.3	65
<b>Z8WW - 8" ZOIE WW</b>	800	11.3	71
	1600	25.3	63
<b>Z12WW - 12" ZOIE WW</b>	1200	17.1	70
	2400	37.8	63

LUMEN OUTPUT MULTIPLIER: 27K=0.93, 30K=0.96, 35K=1.00, 40K=1.02

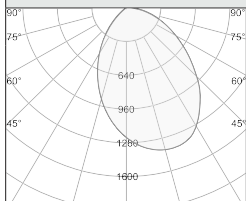
WW - WALL WASH	
	<p><b>3G-Z8WW-08-H90-35K</b></p> <p>LUMEN OUTPUT: 800 LM            DELIVERED LUMENS: 800 LM            SYSTEM WATTS: 11.3 W            EFFICACY: 71 LPW            CRI: 90+            CCT: 3500K</p>