

# 3G LIGHTING

## 3G-58RMSL

5.8" RECESSED  
MADISON SLOT

Solid aluminum double gimbal with dual axis adjustability  
Individual fixture heads can be repositioned in either direction (up to 18")  
Standard 95+ CRI LED system with performance up to 132 LPW  
Delivered lumen range up to 4000lm at 95+ CRI  
Regressed LED source for enhanced glare control  
10° to 90° beam angle options suitable for various applications  
Companion to 3G's Madison product family



### WT - TRIM

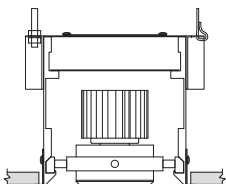

### XTR - TRIMLESS

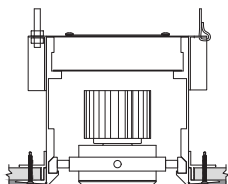

### FX - FLANGELESS

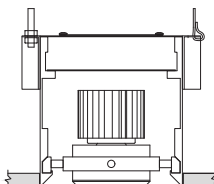

### GCX - GRID CEILING

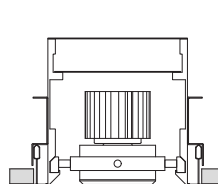

## OPTICS

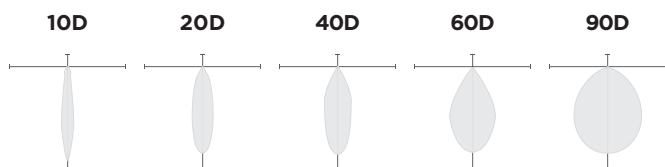

## PERFORMANCE

LUMEN OUTPUT	DELIVERED LUMENS	SYSTEM WATTS	EFFICACY (LPW)
1000	1000	8.1	123
1500	1500	12.3	122
2000	2000	16.2	123
2500	2500	20.5	122
3000	3000	25.8	116
4000	4000	34.2	117

BASED ON 95+ CRI, 35K, 40D OPTIC  
Lumen output and actual wattage may vary +/- 5%

## PATTERNS

Specify pattern shape and overall dimensions as shown below. Patterns are connected with 12"x12" mitered corner sections (Fixture heads not available)  
Please consult factory for custom patterns and shapes not shown below.

L-SHAPE	U-SHAPE	RECTANGLE/SQUARE
<p>Provide dimensions of AxB Example: <b>L</b> - 6'x8'</p>	<p>Provide dimensions of AxBxC Example: <b>U</b> - 8'x10'x6"</p>	<p>Provide dimensions of AxB Example: <b>R</b> - 10'x8'</p>

<b>PROJECT:</b>		<b>TYPE:</b>	
<b>CATALOG#:</b>		<b>DATE:</b>	<b>QTY:</b>

CAT. NO	LUMEN OUTPUT**	CRI	COLOR TEMP	BEAM ANGLE	VOLTAGE
<b>3G-58RMSL</b>	<b>10</b> - 1000 LUMENS <b>15</b> - 1500 LUMENS <b>20</b> - 2000 LUMENS <b>25</b> - 2500 LUMENS <b>30</b> - 3000 LUMENS <b>40</b> - 4000 LUMENS  <small>All lumen outputs are delivered lumens at 95+ CRI</small>	<b>H95</b> - 95+ CRI	<b>27K</b> - 2700K <b>30K</b> - 3000K <b>35K</b> - 3500K <b>40K</b> - 4000K	<b>10D</b> - 10° <sup>1</sup> <b>20D</b> - 20° <b>40D</b> - 40° <b>60D</b> - 60° <b>90D</b> - 90° *  <small>*90D optic supplied with lens Not available with other lens options</small>	<b>UNV</b> - 120/277V <b>120</b> - 120V <b>347</b> - 347V <sup>2</sup>

DRIVER	TRIM FLANGE	GIMBAL FINISH	HOUSING FINISH
<b>DIM</b> - 0-10V (100-1%) <b>LE</b> - PHASE DIM <sup>3</sup> <small>(TRIAC/ELV, 100-1%)</small> <b>DO1</b> - 0-10V (100-0.1%) <b>DALI</b> - DALI (100-1%) <sup>4</sup> <b>DHL2</b> - LUTRON HI-LUME <small>(1% ECOSYSTEM)</small> <b>DMX</b> - DMX (100-0%) <sup>5</sup>	<b>WT</b> - WHITE TRIM (STANDARD) <b>BT</b> - BLACK TRIM <b>XTR</b> - TRIMLESS (MUD-IN DRYWALL) <b>FX</b> - FLANGELESS <b>GCX</b> - GRID CEILING * <small>(UNIVERSAL MOUNT)</small> <b>6TZ</b> - 6" TECHZONE  <small>*Universal mounting brackets used for all grid ceiling types only. See mounting details</small>	<b>NG</b> - NATURAL ALUMINUM <b>BG</b> - BLACK GIMBAL <b>WG</b> - WHITE GIMBAL	<b>BK</b> - BLACK (STANDARD) <b>WH</b> - WHITE

OPTIONS	RUN TYPE	FIXTURE HEAD SPACING
<b>2C</b> - 2 CIRCUIT <b>3C</b> - 3 CIRCUIT <b>SF</b> - SOFTENING LENS <b>LS</b> - LINEAR SPREAD LENS <b>SB</b> - SANDBLASTED LENS <b>HXB</b> - BLACK HEXCELL LOUVER <b>CP</b> - CHICAGO PLENUM <b>EMR</b> - REMOTE EMERGENCY <sup>6</sup> BATTERY  <small>*Lens options not available with 90D optic Maximum 3 optical accessories</small>	<b>S</b> - ____' (STRAIGHT) <b>L</b> - ____'x ____' (L-SHAPE) <b>U</b> - ____'x ____'x ____' (U-SHAPE) <b>R</b> - ____'x ____' (RECTANGLE/SQUARE)  <small>Continuous runs available in 1" increments Patterns not available with grid ceiling</small>	<b>12"</b> - 12" ON CENTER <b>18"</b> - 18" ON CENTER <b>24"</b> - 24" ON CENTER <b>36"</b> - 36" ON CENTER <b>48"</b> - 48" ON CENTER <b>CUS</b> - CUSTOM SPACING SPECIFY NUMBER OF DOWNLIGHTS " <b>CUS(XX)</b> "

- <sup>1</sup> 10D reflector available up to 2000lm  
<sup>2</sup> 347 available in "DIM" 0-10V only (100-1%)  
<sup>3</sup> Phase dimming options available in 120V only  
<sup>4</sup> DALI-2 (Type 6) provided as standard  
<sup>5</sup> DMX driver available up to 3000lm  
<sup>6</sup> Supplied with enclosure with Emergency Battery and driver. Installed remotely by others.  
 Not accessible through fixture aperture

**\*\*** 3G has upgraded our LED system and overall performance at no additional cost. We now offer 95+CRI as standard. All lumen outputs are delivered lumens. This upgraded LED system is more efficient than our previous 80CRI, 90CRI, and 97CRI options. Please see the last page of this spec sheet to cross-reference old lumen outputs with our new, 95+CRI lumen output options

## PERFORMANCE

LUMEN OUTPUT	DELIVERED LUMENS	SYSTEM WATTS	EFFICACY (LPW)
1000	1000	8.1	123
1500	1500	12.3	122
2000	2000	16.2	123
2500	2500	20.5	122
3000	3000	25.8	116
4000	4000	34.2	117

BASED ON 95+ CRI, 35K, 40D OPTIC  
Lumen output and actual wattage may vary +/- 5%

## HOUSING

Housing constructed in extruded aluminum and cold rolled steel  
Designed for continuous runs in various configurations  
Maximum ceiling thickness of 1.75". Consult factory for modifications  
Standard matte black powder coated housing finish  
Trim flange with power coated finish and 0.400" overlap  
Trimless model features a perforated galvanized mudding flange

## ADJUSTABILITY

Solid aluminum double gimbal with dual axis adjustability  
Individual fixture heads can be repositioned in either direction (up to 18")  
Each double gimbal can be locked in place

## OPTICS

Proprietary anodized, aluminum reflectors  
Beam angle available in 10°, 20°, 40° and 60°, and 90°  
Reflectors are field replaceable (10° and 20° reflectors not interchangeable)

## LED SYSTEM

Standard 95+ CRI  
Color consistency <2 SDCM  
Available in 27K, 30K, 35K, and 40K  
L90 > 50,000 hours

## ELECTRICAL

Standard 0-10V, constant current drivers  
100-1% dimming range and >0.9 power factor  
Standard 120/277V universal voltage with several driver options  
120V Forward Phase/Reverse Phase driver option (100-1%)  
Integral drivers are easily accessible through luminaire aperture

## MULTIPLIERS

BEAM ANGLE	
10D	1.05
20D	1.03
40D	1.00
60D	1.00
90D	0.90

COLOR TEMP	
2700K	0.98
3000K	1.00
3500K	1.00
4000K	1.02

## EMERGENCY

7W output for 90 minutes (One fixture head +/- 850lm at 95+ CRI)  
Title 24 Certified  
Remote emergency battery not accessible through fixture aperture  
Maximum remote mounting distance:  
3000lm or below - 50ft (12AWG) or 25ft (14AWG)  
Above 3000lm - 30ft (12AWG) or 20ft (14AWG)  
Caution: Emergency Battery utilizes more than one power source and servicing should be performed by qualified personnel

## MOUNTING

New construction housing suspended via 1/4" threaded rod or suspension cables (by others)  
Trim fixture designed for use in drywall, wood, and other architectural ceiling materials  
Trimless fixture designed for use in drywall, mud-in ceiling applications  
Flangeless fixture designed for use in wood ceilings  
Suitable for various grid ceiling applications (see mounting details)

## LISTING

ETL listed and conforms to UL1598 standard  
Certified to CSA22.2 No.250.0.  
Rated for dry or damp locations

## WARRANTY

5 year limited warranty  
LED system rated for operation in ambient environments up to 25°C

**HARD CEILING**

**WT - TRIM**

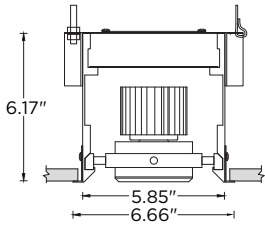

RECOMMENDED CEILING  
CUT-OUT 6.25"

**XTR - TRIMLESS**

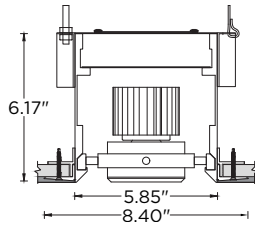

RECOMMENDED CEILING  
CUT-OUT 6.25"

**FX - FLANGELESS**

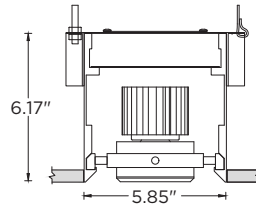

RECOMMENDED CEILING  
CUT-OUT 5.90"

**TRIM**

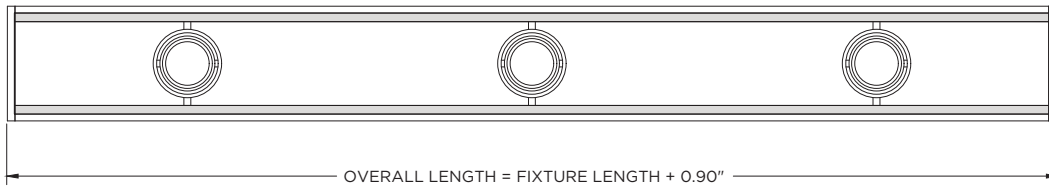

**TRIMLESS (MUD-IN DRYWALL)**

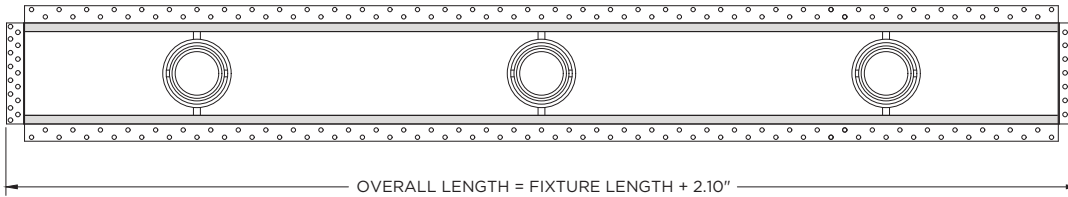

**FLANGELESS**

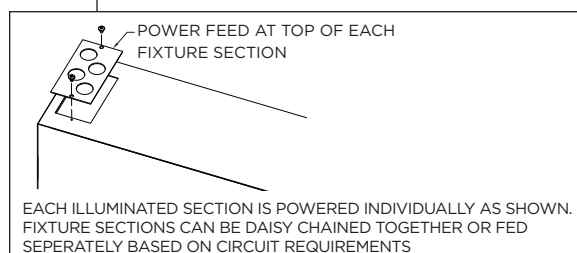
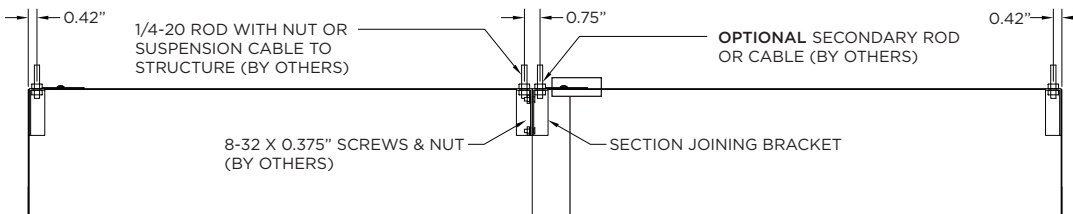
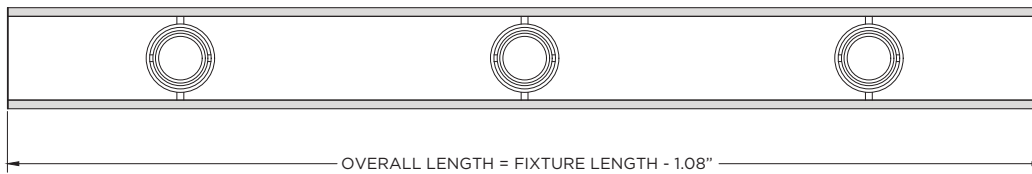

**GRID CEILING**

**9L - 9/16" LAYIN**

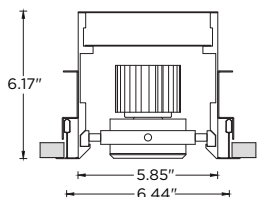

**9TG - 9/16" TEGULAR**

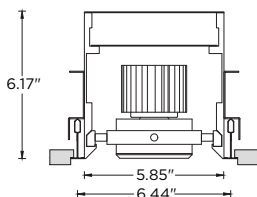

**15L - 15/16" LAYIN**

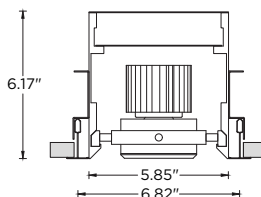

**15TG - 15/16" TEGULAR**

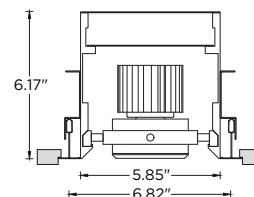

**9ST - 9/16" SLOT TEE TEGULAR**

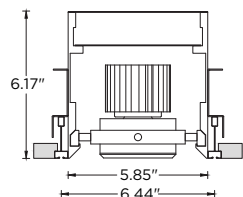

**6TZ - TECHZONE**

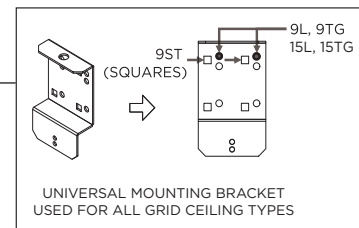
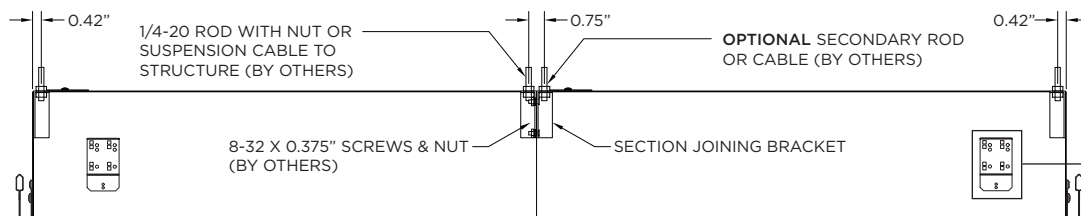
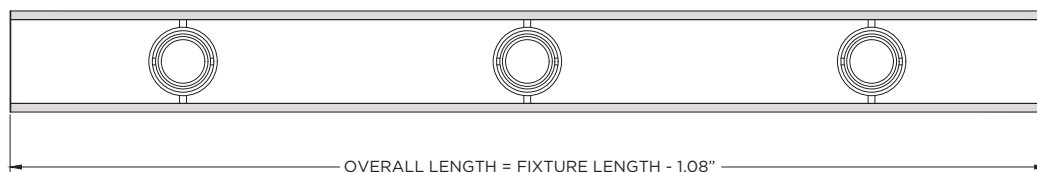
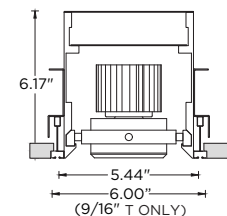

**GIMBAL ADJUSTABILITY**

**WIDTH**

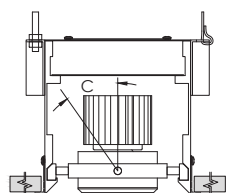

**LENGTH**

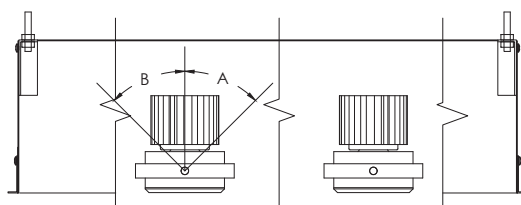

LUMEN OUTPUT	A	B	C
Up to 3000lm	45°	45°	30°
4000lm	45°	45°	20°

## LUMEN OUTPUT REFERENCE CHART

3G has upgraded our LED system and overall performance at no additional cost. We now offer 95+CRI as standard. All lumen outputs are delivered lumens. This new LED system is more efficient than our previous 80CRI, 90CRI, and 97CRI options. Please use these charts to cross-reference old lumen outputs with our new, 95+CRI lumen output options

### 80CRI REFERENCE CHARTS

MATCH THE GRADIENT SHADE FROM THE OLD LUMEN OUTPUT CHART TO THE NEW LUMEN OUTPUT OPTION

OLD 80CRI SPECS			
LUMEN OUTPUT	DELIVERED LUMENS	SYSTEM WATTS	EFFICACY (LPW)
1000	1080	10.3	105
1500	1444	14.0	103
2200	2089	22.0	95
3000	2815	31.1	90
4000	3958	43.0	92

NEW 95+CRI SPECS			
LUMEN OUTPUT	DELIVERED LUMENS	SYSTEM WATTS	EFFICACY (LPW)
1000	1000	8.1	123
1500	1500	12.3	122
2000	2000	16.2	123
2500	2500	20.5	122
3000	3000	25.8	116
4000	4000	34.2	117

### 90CRI REFERENCE CHARTS

MATCH THE GRADIENT SHADE FROM THE OLD LUMEN OUTPUT CHART TO THE NEW LUMEN OUTPUT OPTION

OLD 90CRI SPECS			
LUMEN OUTPUT	DELIVERED LUMENS	SYSTEM WATTS	EFFICACY (LPW)
1000	951	10.3	92
1500	1271	14.0	91
2200	1838	22.0	84
3000	2477	31.1	79
4000	3483	43.0	81

NEW 95+CRI SPECS			
LUMEN OUTPUT	DELIVERED LUMENS	SYSTEM WATTS	EFFICACY (LPW)
1000	1000	8.1	123
1500	1500	12.3	122
2000	2000	16.2	123
2500	2500	20.5	122
3000	3000	25.8	116
4000	4000	34.2	117