

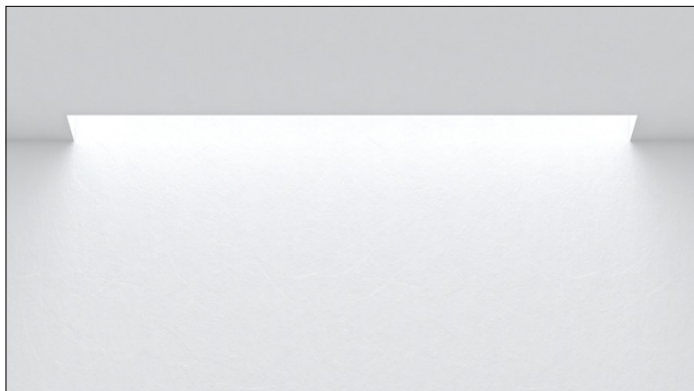

3G-4RPE

3.5" PERIMETER
TUNABLE WHITE & RGBW



3GT **3GB**

Narrow 3.5" aperture with one piece extruded aluminum housing
Designed for continuous runs in 1' increments as standard
12" fully illuminated end filler option is field cuttable for odd lengths
LED system with performance up to 147 lumens per watt
Lens position available in flush, 1", 2" and 3" regressed options
Asymmetric optics available for room side performance
1% dimming standard with several integral driver options

PROJECT:		TYPE:	
CATALOG#:		DATE:	QTY:

CAT. NO	LED SOURCE	LUMEN OUTPUT	CRI	VOLTAGE
3G-4RPE	TW - TUNABLE WHITE (2700K-6500K) RGBW - INFINITE COLOR ¹ (3500K WHITE)	D250 - 250 LM/FT ² D500 - 500 LM/FT D750 - 750 LM/FT D1000 - 1000 LM/FT ³ DC - CUSTOM OUTPUT * (SPECIFY LM/FT) <small>*Specify custom lumen outputs in 50lm increments (ie: DC600, DC650, DC700) Custom output cannot exceed D1000 Lumen outputs suitable for white LED source only</small>	S80 - 80+ CRI H90 - 90+ CRI ¹	UNV - 120/277V

DRIVER	FLANGE TYPE	LENS OPTION	OPTIONS
D01 - 0-10V (100-0.1%) DALI - DALI (100-1%) DMX - DMX (100-0%) ¹ DHLT - LUTRON T-SERIES (100-0.1%)	GCX - GRID CEILING * (UNIVERSAL MOUNT) WT - WHITE TRIM FLANGE XTR - TRIMLESS (SHEETROCK) FX - FLANGELESS <small>*Grid ceiling fixtures ship with universal mounting brackets suitable for all ceiling types. See mounting section for details</small>	FL - FLUSH LENS DASY - ASYMMETRIC LENS ¹ RG1 - 1" REGRESSED RG2 - 2" REGRESSED RG3 - 3" REGRESSED	EF - END FILLER * EMC - EMERGENCY CIRCUIT ⁴ CP - CHICAGO PLENUM <small>*12" fully illuminated end filler option is field cuttable for odd lengths</small>

RUN TYPE
S - ____' (STRAIGHT) * L - ____'X ____' (L-SHAPE) U - ____'X ____'X ____' (U-SHAPE) <small>*Individual units available from 2' to 8' Continuous runs available in 1" increments as standard EF (End Filler) option for odd lengths (tunable white only)</small>

- ¹ RGBW LED source available with S80 (80+ CRI) and DMX driver option only. Not available with asymmetric optic or EM options
² D250 (250LM/FT) not available in 2' and 3' lengths. Specify DC400 for 2' and 3' fixture lengths when outputs lower than 500LM/FT are required
³ D1000 (1000LM/FT) not available for H90 (90+ CRI)
⁴ EMC (emergency circuit) option available for tunable white LED source only. Not available with RGBW

3GT - Tunable White
3GB - RGBW

BASED ON 4' LENGTH WITH FLUSH LENS (TUNABLE WHITE AND 90+ CRI)

COLOR TEMP	DELIVERED LUMENS (LM/FT)	SYSTEM WATTS (W/FT)	EFFICACY (LPW)
2700K	250	2.4	120
	500	4.5	115
	750	6.9	113
	1000	9.6	112
3500K	250	2.4	103
	500	4.5	111
	750	6.9	109
	1000	9.6	104
6500K	250	2.4	161
	500	4.5	160
	750	6.9	152
	1000	9.6	145

EFFICACY (LPW) ADJUSTMENT FACTOR: 90CRI=0.88

FL - FLUSH LENS

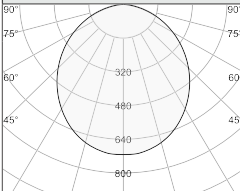

3G-4RPE-TW-D500-H90-FL

DELIVERED LUMENS: 500 LM/FT (2000LM)
SYSTEM WATTS: 4.5 W/FT (15.2W)
EFFICACY: 111 LPW
CRI: 90+
CCT: 3500K
LENS OPTION: FLUSH

RG1 - 1" REGRESSED

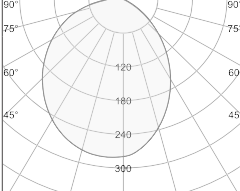

3G-4RPE-TW-D500-H90-RG1

DELIVERED LUMENS: 500 LM/FT (2000LM)
SYSTEM WATTS: 4.5 W/FT (15.2W)
EFFICACY: 109 LPW
CRI: 90+
CCT: 3500K
LENS OPTION: 1" REGRESSED

RG2 - 2" REGRESSED

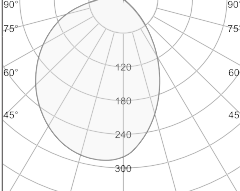

3G-4RPE-TW-D500-H90-RG2

DELIVERED LUMENS: 500 LM/FT (2000LM)
SYSTEM WATTS: 4.5 W/FT (15.2W)
EFFICACY: 107 LPW
CRI: 90+
CCT: 3500K
LENS OPTION: 2" REGRESSED

RG3 - 3" REGRESSED

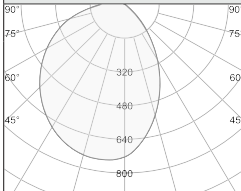

3G-4RPE-TW-D500-H90-RG3

DELIVERED LUMENS: 500 LM/FT (2000LM)
SYSTEM WATTS: 4.5 W/FT (15.2W)
EFFICACY: 105 LPW
CRI: 90+
CCT: 3500K
LENS OPTION: 3" REGRESSED

DASY - ASYMMETRIC LENS

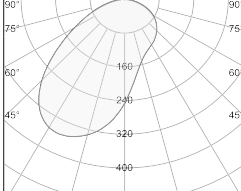

3G-4RPE-TW-D500-H90-DASY

DELIVERED LUMENS: 500 LM/FT (2000LM)
SYSTEM WATTS: 3.9 W/FT (15.2W)
EFFICACY: 128 LPW
CRI: 90+
CCT: 3500K
LENS OPTION: ASYMMETRIC

BASED ON 4' LENGTH (RGBW WITH 80+ CRI AND 3500K SOURCE)

COLOR TEMP	DELIVERED LUMENS (LM/FT)	SYSTEM WATTS (W/FT)	EFFICACY (LPW)
3500K	250	2.2	119
	500	4.6	113
	750	7.8	96
	1000	11.3	89

LUMINOUS INTENSITY PER LED	RGB	INTENSITY MIN-MAX (MCD)
	RED	355 - 805
	GREEN	710 - 1400
	BLUE	140 - 355

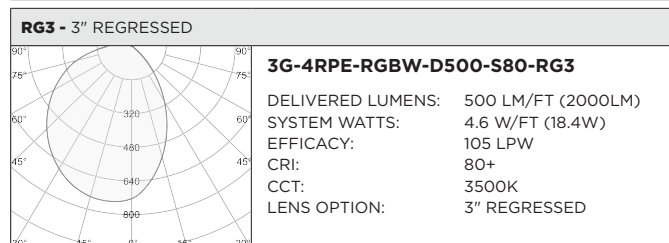
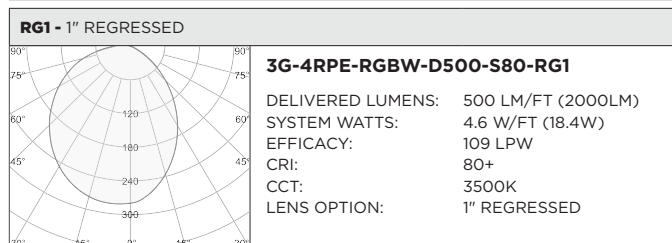
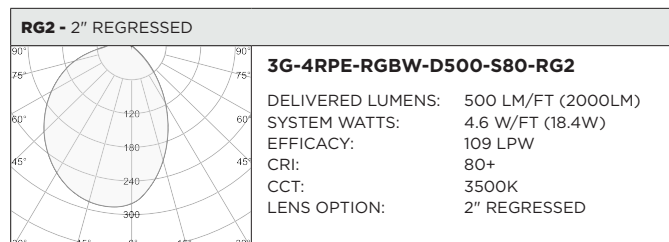
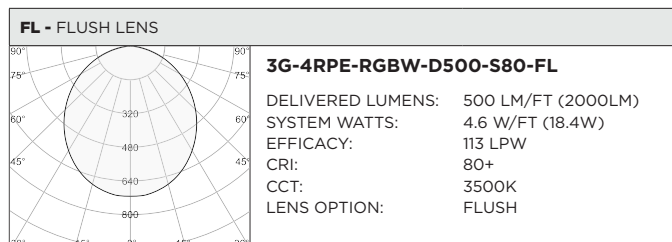

HOUSING

Extruded aluminum housing with narrow 3.5" aperture
Individual units and continuous runs available in 1' increments
12" fully illuminated end filler option is field cuttable for odd lengths
Trim flange with matte white powder coated finish and minimal 0.400" overlap
Trimless model features a satin coat mudding flange for seamless ceiling
24-gauge LED reflector with high reflectance white powder coated finish
Standard polyester powder coated matte white finish

OPTICS

Extruded, satin acrylic lens designed for optimal performance and glare control. Up to 8' continuous
Lens position available in flush, 1", 2", and 3" regressed options
High performance asymmetric optics available

LED SYSTEM FOR TUNABLE WHITE

Proprietary LED system with color consistency <3 SDCM
2700K-6500K CCT range
Standard 80+CRI. Optional 90+CRI. (R9 value of 56 for 90+CRI)
L90 >60,000 hours
5 Year Warranty

LED SYSTEM FOR RGBW

Proprietary LED system with color consistency <3 SDCM
White LED available in 35K with 80+ CRI
L80 >72,000 hours
Red (335-805 mcd)
Green (710-1400 mcd)
Blue (140-355 mcd)
5 Year Warranty

ELECTRICAL

Luminaires are pre-wired with factory installed quick connects and branch circuit wiring
Multiple driver options available for tunable white LED system
All drivers are integral and easily accessible through luminaire aperture

MOUNTING

New construction housing suspended via ¼" threaded rod or suspension cables (by others)
Trim fixture designed for use in drywall, wood, and other architectural ceilings
Trimless fixture designed for use in drywall, mud-in ceiling applications
Flangeless fixture designed for use in wood ceilings
Suitable for various grid ceiling applications (see mounting details)
Standard mounting available in flush and regressed options up to 3".
Consult 3G for modifications
Fixture weight: +/- 3 lbs/ft

LISTING

ETL listed and conforms to UL1598 standard
Certified to CSA22.2 NO.250.0.
Rated for dry or damp locations

WARRANTY

5 year limited warranty
LED system rated for operation in ambient environments up to 25°C

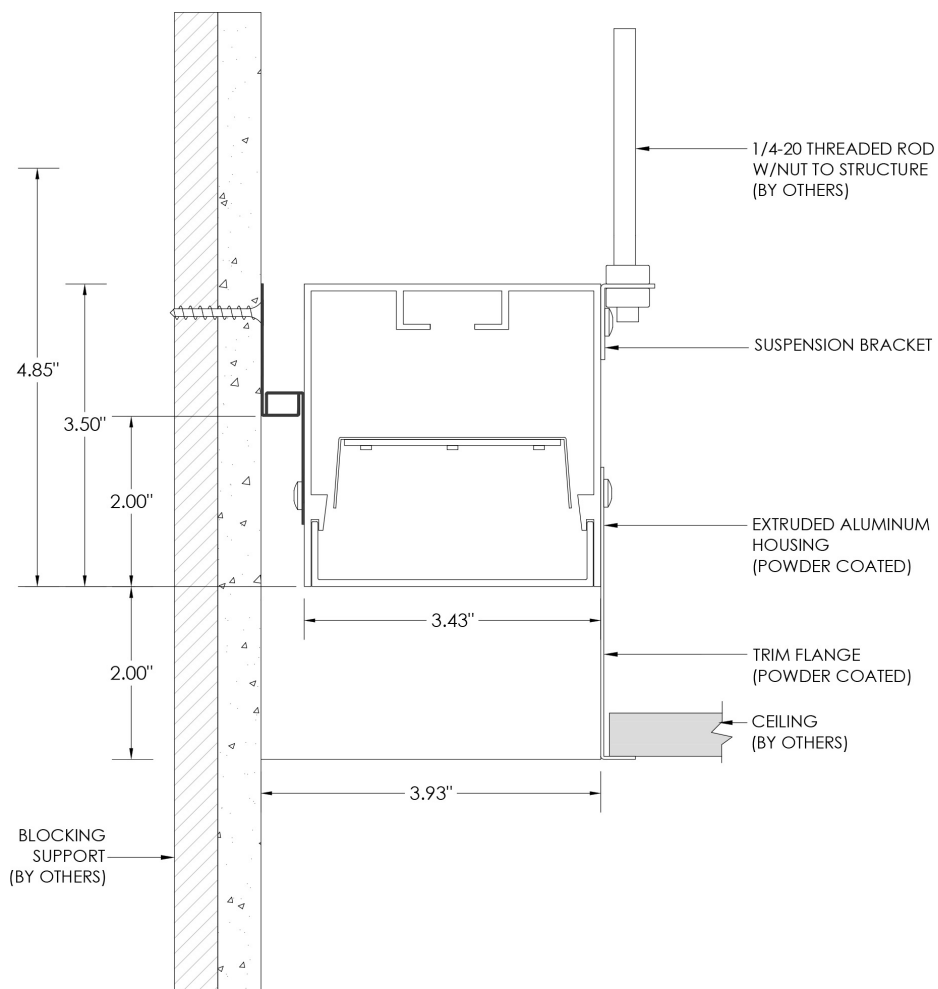

LENS POSITION

FL - FLUSH
DASY - ASYMMETRIC OPTIC
(ROOM SIDE)

RG1 - 1" REGRESSED

RG2 - 2" REGRESSED

RG3 - 3" REGRESSED

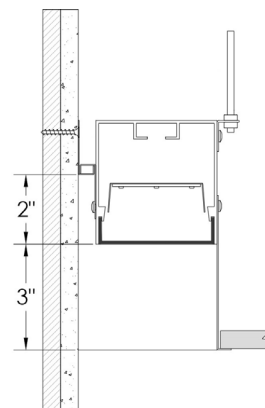
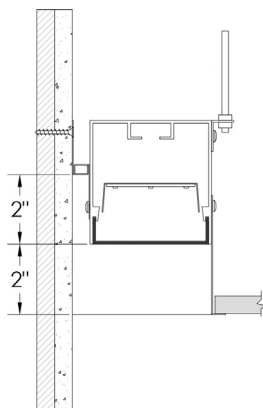
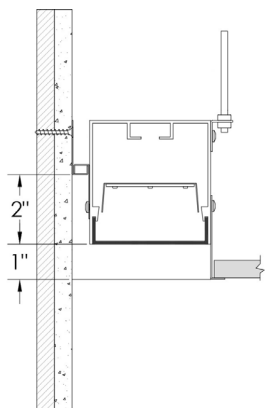
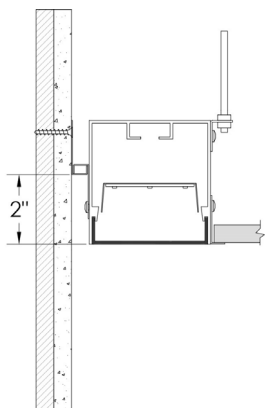

HARD CEILING MOUNTING TYPES

FLUSH

WT - TRIM

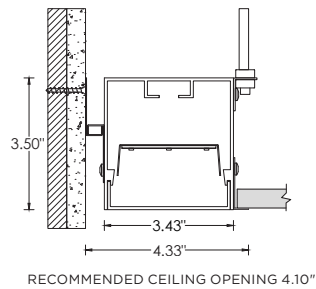

XTR - TRIMLESS

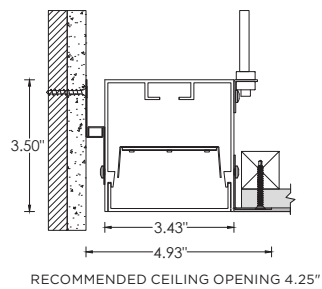

FX - FLANGELESS

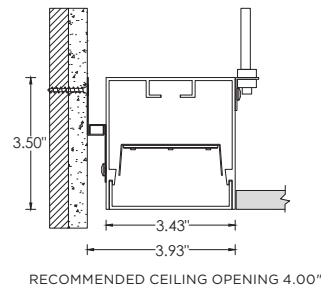

2" REGRESSED

WT - TRIM

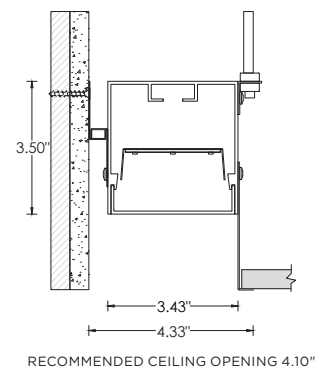

XTR - TRIMLESS

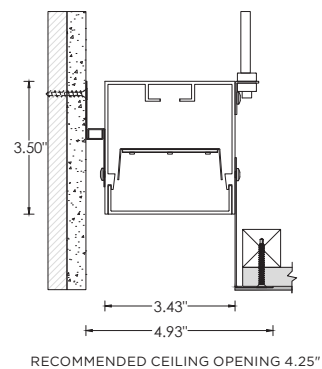

FX - FLANGELESS

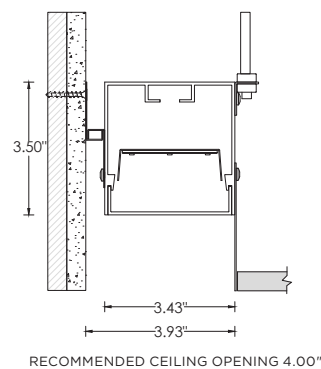

GRID CEILING MOUNTING TYPES

FLUSH

9L - 9/16" LAYIN

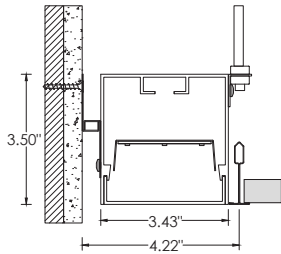

9TG - 9/16" TEGULAR

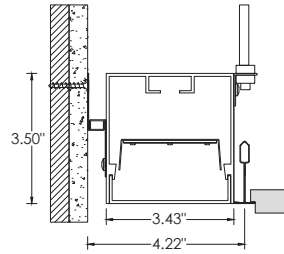

15L - 15/16" LAYIN

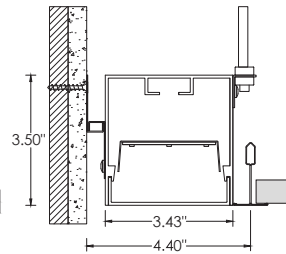

15TG - 15/16" TEGULAR

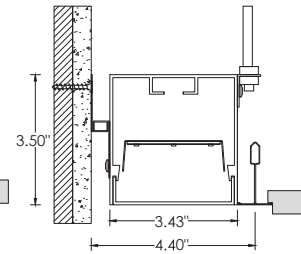

9ST - 9/16" SLOT TEE TEGULAR

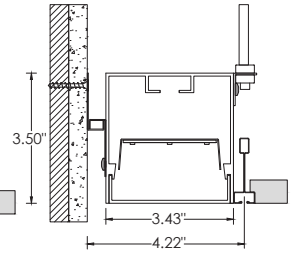

2" REGRESSED

9L - 9/16" LAYIN

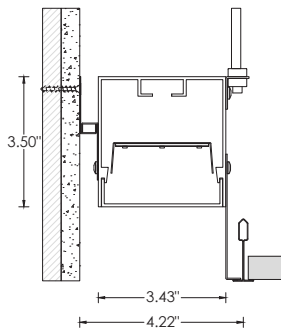

9TG - 9/16" TEGULAR

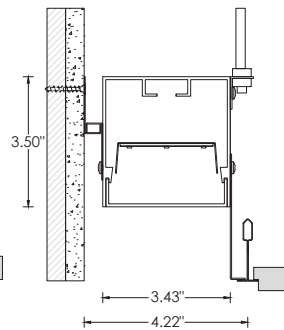

15L - 15/16" LAYIN

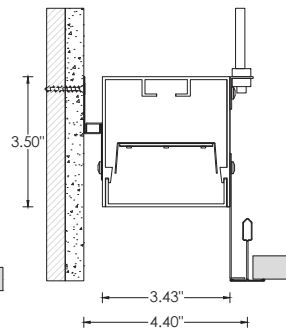

15TG - 15/16" TEGULAR

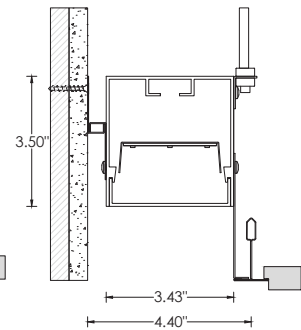

9ST - 9/16" SLOT TEE TEGULAR

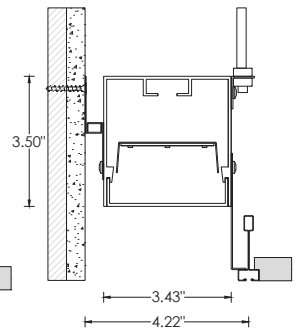

PATTERNS

Specify pattern shape and overall dimensions as shown below
Patterns are connected with fully illuminated 12"x12" L, T, and X-shaped sections
Please consult factory for custom patterns and shapes not shown below



L-SHAPE	U-SHAPE
Provide dimensions of AxB Example: L - 6'x8'	Provide dimensions of AxBxC Example: U - 8'x10'x6"
