



3G-DL33SF

3.3" SQUARE FIXED
DOWNLIGHT



Small 3.3" square, high performance downlight
 Regressed LED source for enhanced glare control
 Lumen range up to 4000lm (80+, 90+, and 97+ CRI options)
 Wet location option available
 Shallow housing available along with remodel and other housing options
 1% dimming standard with several integral driver option

ORDERING INFORMATION

PROJECT:	<input type="text"/>	TYPE:	<input type="text"/>
CATALOG #:	<input type="text"/>	DATE:	<input type="text"/>

CAT. NO	LUMEN OUTPUT	CRI	COLOR TEMP	BEAM ANGLE	VOLTAGE
3G-DL33SF	10 - 1000 LUMENS	S80 - 80+ CRI	27K - 2700K	20D - 20° ²	UNV - 120/277V
	15 - 1500 LUMENS	H90 - 90+ CRI	30K - 3000K	40D - 40°	120 - 120V
	22 - 2200 LUMENS	H97 - 97+ CRI ¹	35K - 3500K	60D - 60°	347 - 347V (0-10V ONLY)
	30 - 3000 LUMENS		40K - 4000K	90D - 90° *	
	40 - 4000 LUMENS				

* 90D reflector supplied standard with lens

DRIVER	FLANGE TYPE	BEVELED INSERT	HOUSING TYPE
DIM - 0-10V (STANDARD 100-1%) LE - PHASE DIMMING ³ (TRIAC/ELV, 100-1%) LTEA - LUTRON HI-LUME LTEA ³ (FWD PHASE, 100-1%) D01 - 0-10V (eldoLED, 100-0.1%) ⁴ DALI - DALI (100-1%) ⁴ DHL2 - LUTRON HI-LUME LDE1 (1% ECOSYSTEM) DMX - DMX (eldoLED, 100-0%) ⁴	WT - WHITE TRIM BT - BLACK TRIM XTR - TRIMLESS MWF - FLANGELESS (MILLWORK) ⁵	WI - WHITE SI - SILVER BI - BLACK	RMD - REMODEL (NON-IC) NCF - NEW CONSTRUCTION FRAME (NON-IC) SH - SHALLOW HOUSING ⁶ (IC RATED & CP RATED) NC - NEW CONSTRUCTION HOUSING (CP RATED) IC - NEW CONSTRUCTION IC HOUSING ⁶

OPTIONS
SF70 - SOFTENING LENS (SUPPLIED STANDARD) LS70 - LINEAR SPREAD LENS SB70 - SANDBLASTED LENS WL - WET LOCATION (SOFTENING LENS) ⁷ CP - CHICAGO PLENUM ⁸ AT - AIRTIGHT HOUSING ⁹ BH - C-CHANNEL BAR HANGERS EMR - EMERGENCY BATTERY (REMOTE) ¹⁰ Maximum 1 optical accessory

¹ 97+ CRI available up to 3000lm. Available in 30K and 35K as standard
² 20D reflector available up to 2200lm
³ Phase dimming options available in 120V only
⁴ D01, DALI and DMX available up to 2200lm. DALI-2 (Type 6) provided as standard. consult factory for DALI Type 8 option
⁵ MWF not available with Remodel (NON-IC)
⁶ IC rated Shallow Housing and New Construction IC housing available up to 2200lm
⁷ Wet location option provided standard with sealed softening lens. Not available with trimless option
⁸ Chicago Plenum option available with Shallow Housing (2200lm max) and New Construction Housing
⁹ Airtight Housing option available with Shallow Housing only (2200lm max)
¹⁰ Emergency battery installed remotely by others. Not accessible through the inside of the fixture

OCTOBER 1, 2021



PERFORMANCE CHART BASED ON 60° BEAM ANGLE AND 3500K SOURCE WITH SOFTENING LENS

LUMEN OUTPUT	80+ CRI			90+ CRI			97+ CRI		
	DELIVERED LUMENS	SYSTEM WATTS	EFFICACY (LPW)	DELIVERED LUMENS	SYSTEM WATTS	EFFICACY (LPW)	DELIVERED LUMENS	SYSTEM WATTS	EFFICACY (LPW)
1000LMs	925	10.4	89	814	10.4	78	759	10.4	73
1500LMs	1258	14.2	89	1107	14.2	78	1031	14.2	73
2200LMs	1832	22.5	81	1612	22.5	72	1502	22.5	67
3000LMs	2443	31.8	77	2150	31.8	68	2003	31.8	63
4000LMs	3309	44.2	75	2912	44.2	66	N/A	N/A	N/A

LUMEN OUTPUT ADJUSTMENT FACTORS	CCT	Multiplier
	2700K	0.945
	3000K	0.985
	3500K	1.00
	4000K	1.01

PHOTOMETRY

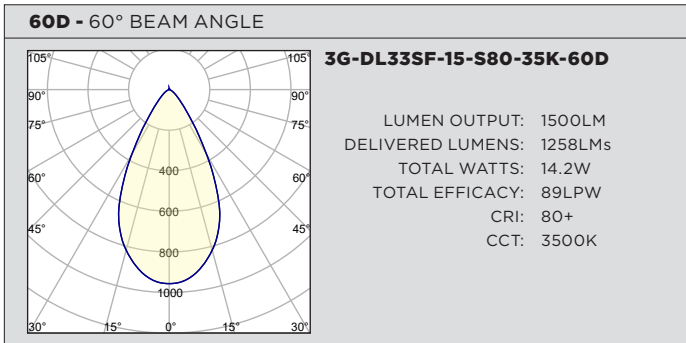
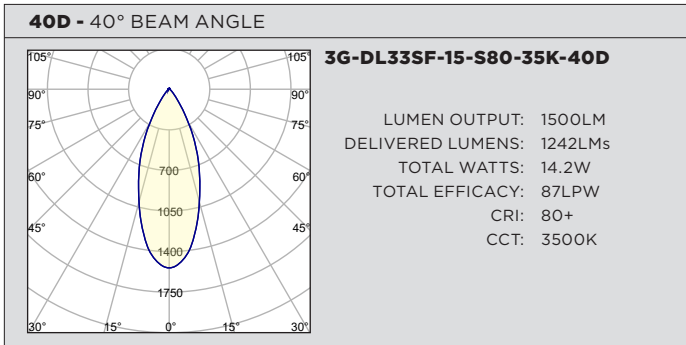
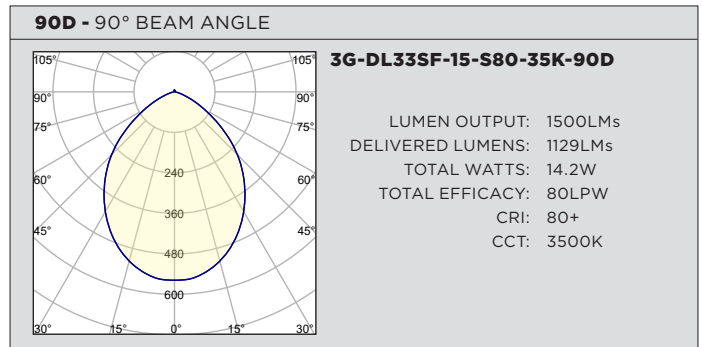
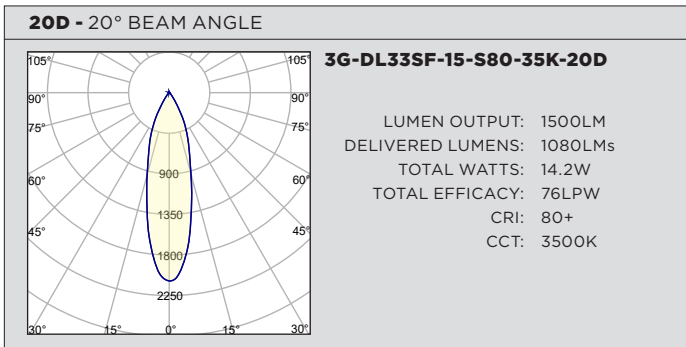

TECHNICAL**HOUSING**

Remodel, new construction frame, shallow housing, and IC housing options available
Maximum ceiling thickness of 1" (1.5" for Remodel housing). Consult factory for modifications
All housing options designed to be easily converted in field to trim or trimless with minimal components
Housing rated for #12 AWG (4 in, 4 out), 90°C conductors and through branch wiring

BEVELED INSERT

Cast aluminum beveled insert with matte powder coated finish
3.3" aperture with regressed LED source for enhanced glare control

TRIM

Cast aluminum trim flange with matte powder coated finish and minimal 0.375" overlap

TRIMLESS

Cast aluminum mudding flange features a grooved surface for easy mud-in application
Integral blocking support provided to ensure fixture is properly secured within ceiling structure

OPTICS

Regressed LED source for enhanced glare control
Proprietary anodized, aluminum reflectors are field replaceable (20° reflector not interchangeable)
Available in 20°, 40°, 60°, and 90°
All models provided standard with softening lens
Wet location option supplied standard with sealed softening lens

ELECTRICAL

Standard 0-10V, constant current drivers with 100-1% dimming range and >0.9 power factor
Standard 120/277V universal voltage drivers. Optional 347V, 0-10V drivers
120V Forward Phase/Reverse Phase driver option with 100-1% dimming range
eldoLED 0-10V driver option available with 100-0.01% dimming range
eldoLED DALI and Lutron EcoSystem driver options available with 100-1% dimming range
DMX driver option available with 100-0% dimming range
All drivers are integral and easily accessible through fixture aperture

LED SYSTEM

Citizen LED module (field replaceable)
Color consistency <2 SDCM
Standard (80+ CRI). Optional (90+ and 97+ CRI)
Available in 27K, 30K, 35K, and 40K
L90 >50,000 hours
5 Year Warranty

MOUNTING

Trim fixture designed for use in drywall, wood, acoustic, and other architectural ceilings
Trimless fixture designed for use in drywall, mud-in ceiling applications
Recommended ceiling cut-out for Millwork Flangeless option (3.625" x 3.625" for ceilings up to 1"). Contact 3G for thicker ceilings
Recommended ceiling cut-out for all housing options (3 15/16" x 3 15/16")
New construction frame and IC rated shallow housings ship with bar hangers (14" to 26" extension)
Standard new construction and IC housings available with optional c-channel bar hangers

LISTING

ETL listed and tested to cUL standards. Suitable for dry and damp locations

WARRANTY

5 Year Warranty on LED and drivers
Manufacturer 1 Year Warranty for defects in material and workmanship under normal use
Ambient temperature at fixture should not exceed 25°C

TRIM HOUSING OPTIONS

RMD - Remodel (Non-IC)

2200lm max 3000lm/4000lm

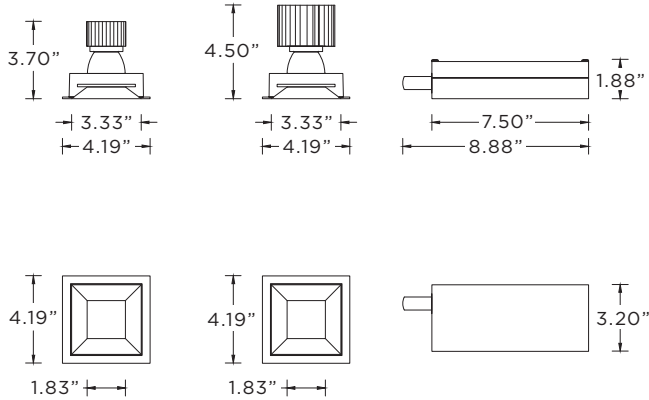

NCF - New Construction Frame (Non-IC)

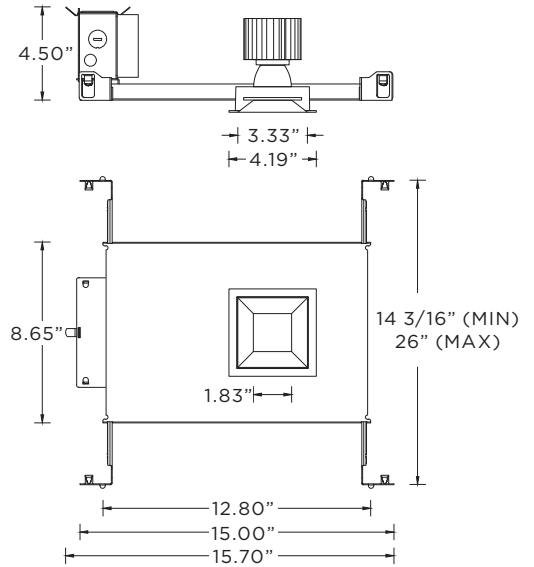

SH - Shallow Housing (IC and Chicago Plenum Rated) (2200lm max)

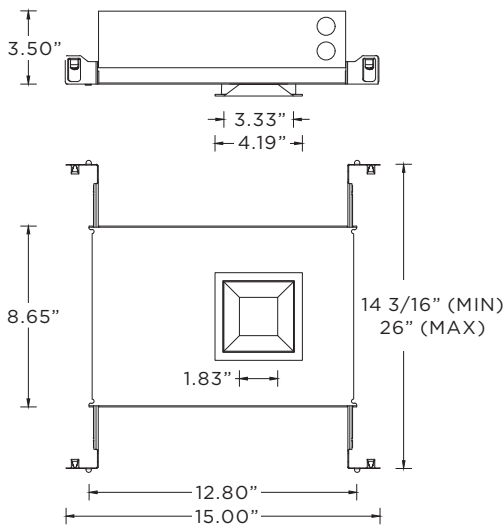

**NC - New Construction Housing (Non-IC and CP rated)
IC - New Construction IC Housing (2200lm max)**

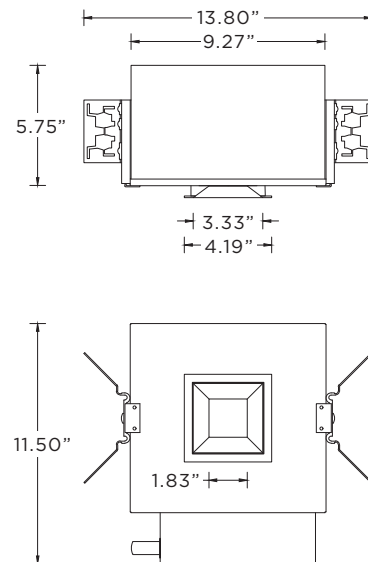

TRIMLESS HOUSING OPTIONS

RMD - Remodel (Non-IC)

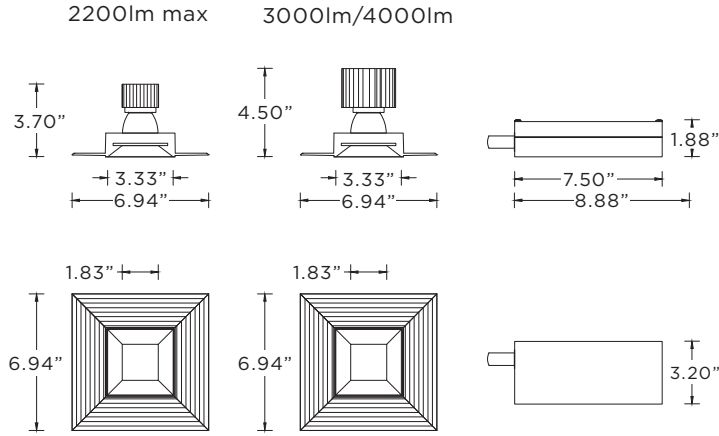

NCF - New Construction Frame (Non-IC)

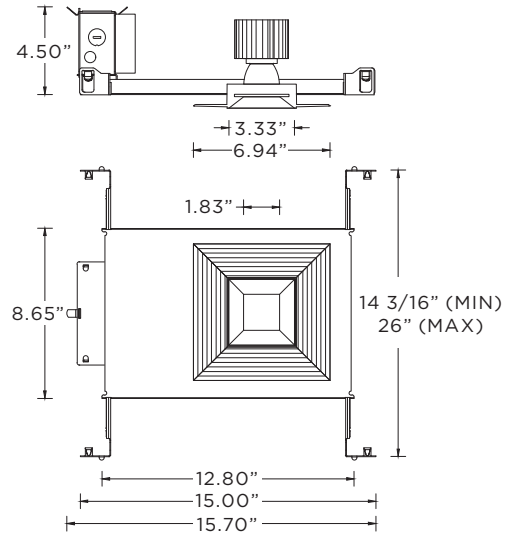

SH - Shallow Housing (IC and Chicago Plenum Rated) (2200lm max)

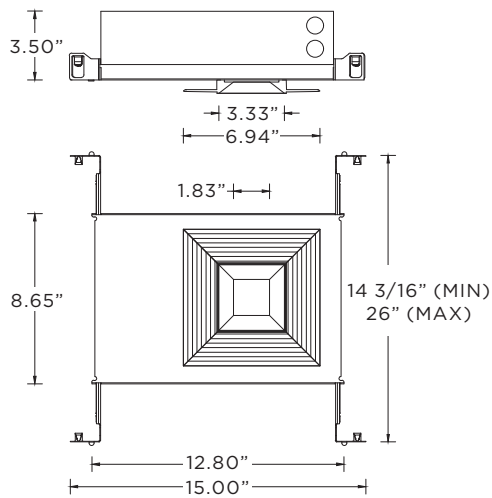

NC - New Construction Housing (Non-IC and CP rated)

IC - New Construction IC Housing (2200lm max)

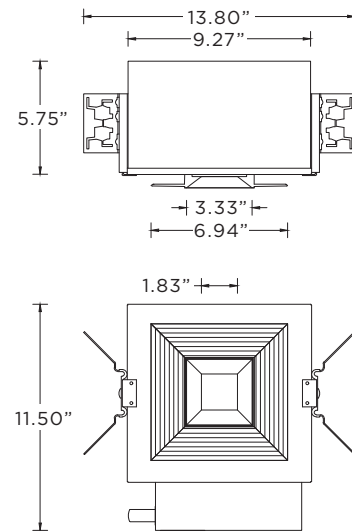

FLANGELESS MILLWORK OPTIONS

NCF - New Construction Frame (Non-IC)

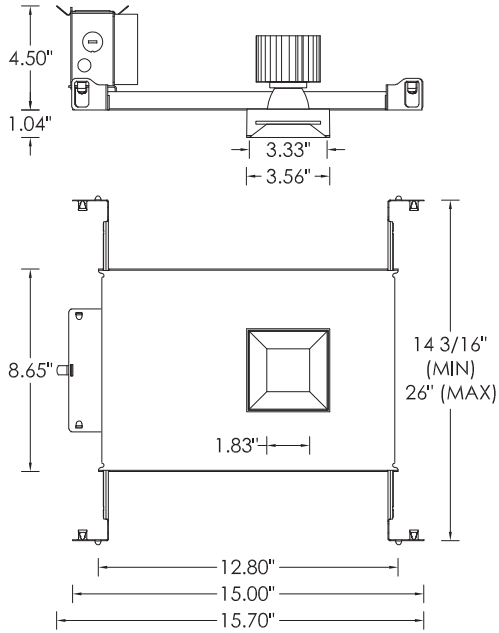

SH - Shallow Housing (IC and Chicago Plenum Rated) (2200lm max)

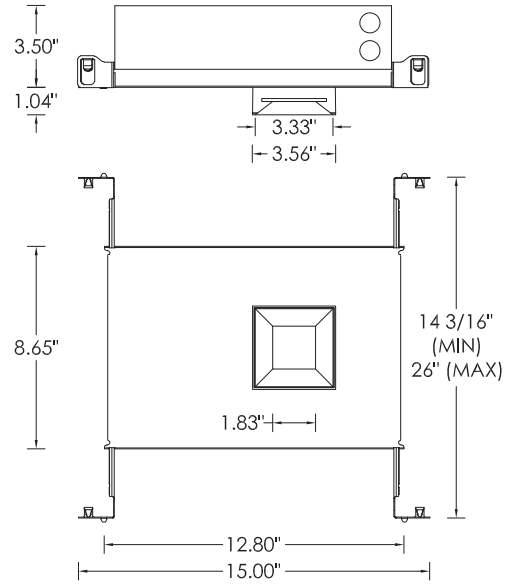

NC - New Construction Housing (Non-IC and CP rated)
IC - New Construction IC Housing (2200lm max)

