

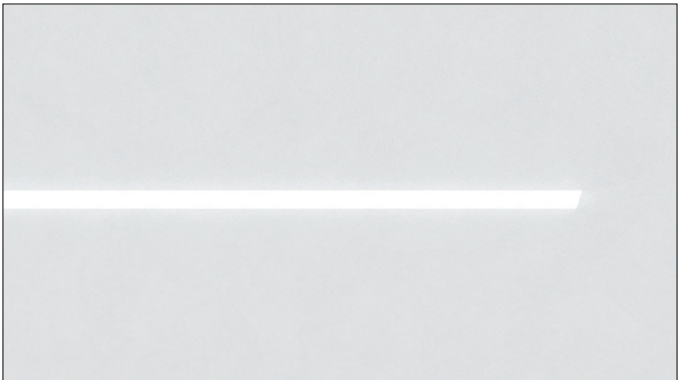

**3G-1RLI**  
**1.5" RECESSED LINIA**  
FLANGELESS/TRIM FLANGE



**⚠ FOR NEW CONSTRUCTION INSTALLATION ONLY**

FIXTURE TYPES	INCLUDED COMPONENTS
<p>1RLI PROFILE</p>	<p><b>Standalone Fixtures (2' to 8')</b></p> <p>INDIVIDUAL      LENS</p>
<p><b>Continuous Runs (9' to 16')</b></p> <p>STARTER      ENDER      LENS</p>	<p><b>Continuous Runs (17' and longer)</b></p> <p>STARTER      JOINER      ENDER      LENS</p>

INSTRUCTION KEY	INFORMATION
	ADDITIONAL
	ATTENTION
	POWER ON
	POWER OFF
	INSTALLATION SHOULD ONLY BE PERFORMED BY A CERTIFIED ELECTRICIAN REFER TO LOCAL/NATIONAL CODES FOR PROPER INSTALLATION FAILURE TO FOLLOW INSTALLATION INSTRUCTION MAY VOID THE WARRANTY DO NOT TOUCH LEDS. LEDS MUST BE PROTECTED FROM MECHANICAL STRESS OR DEBRIS TURN OFF POWER DURING INSTALLATION OR SERVICING

OVERVIEW

**3G-1RLI - FLANGELESS - FX**



**FLANGELESS - FX**

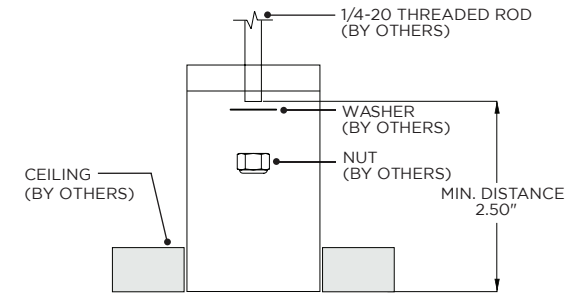

**FLANGELESS - FX - CEILING CUT-OUT DIMENSIONS**

FIXTURE TYPE	WIDTH	LENGTH
3G-1RLI	1.600"	LENGTH + 0.125"

**3G-1RLI - WHITE TRIM FLANGE - WT**

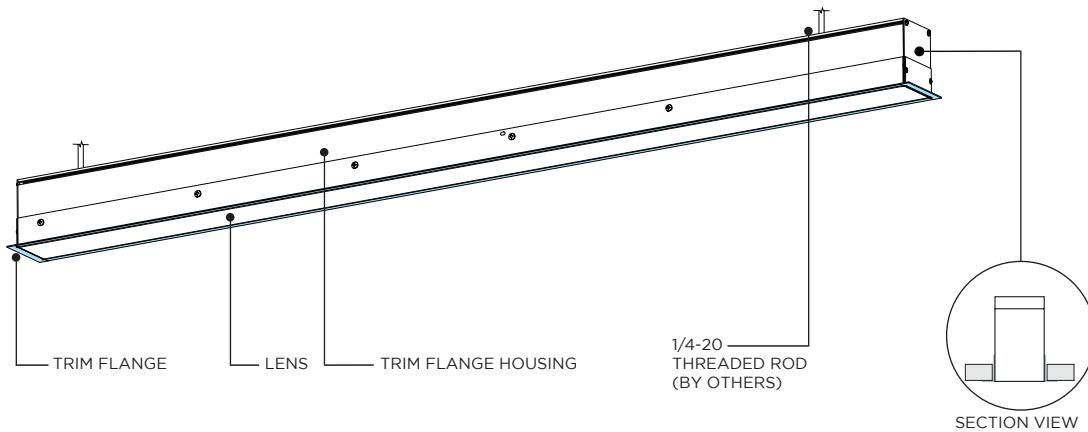

**WHITE TRIM FLANGE - WT**

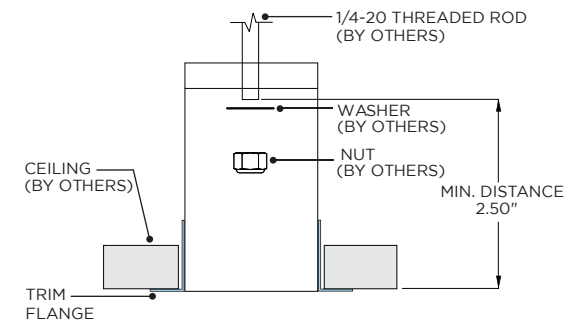

**WHITE TRIM FLANGE - WT - CEILING CUT-OUT DIMENSIONS**

FIXTURE TYPE	WIDTH	LENGTH
3G-1RLI	2.150"	LENGTH + 0.380"

ASYMMETRIC LENS ORIENTATION

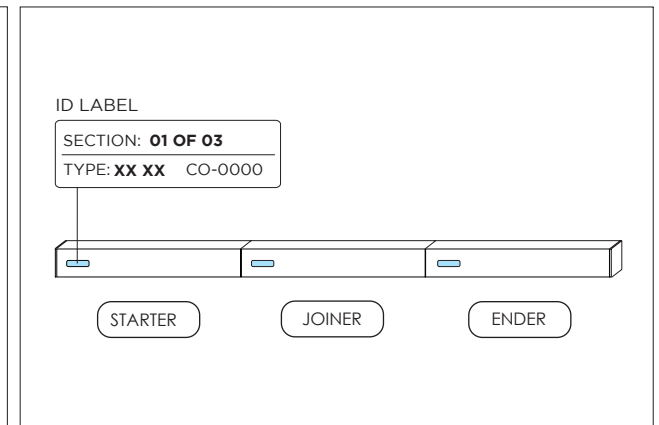
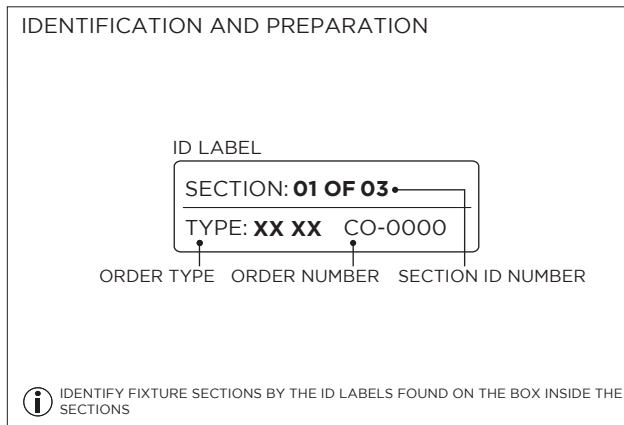
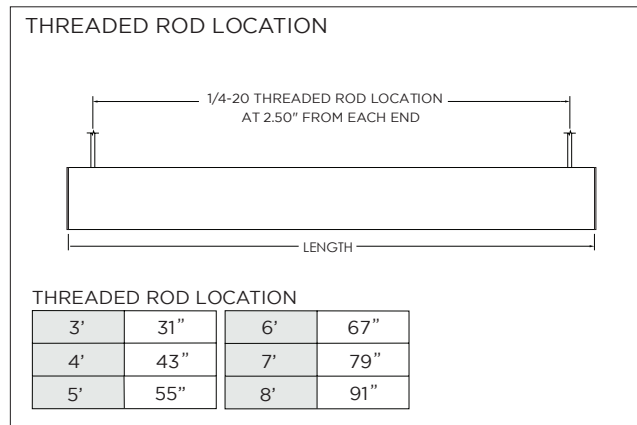
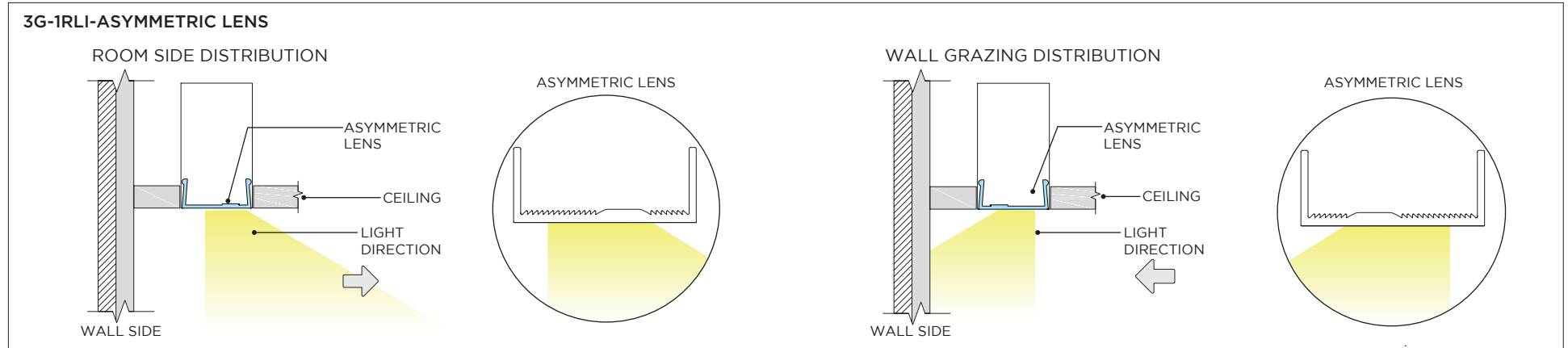

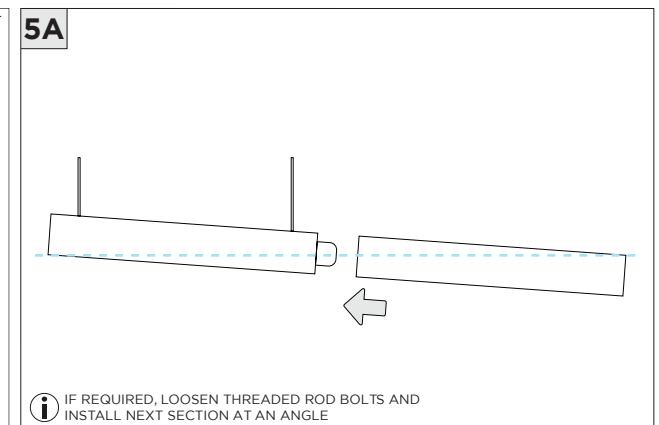
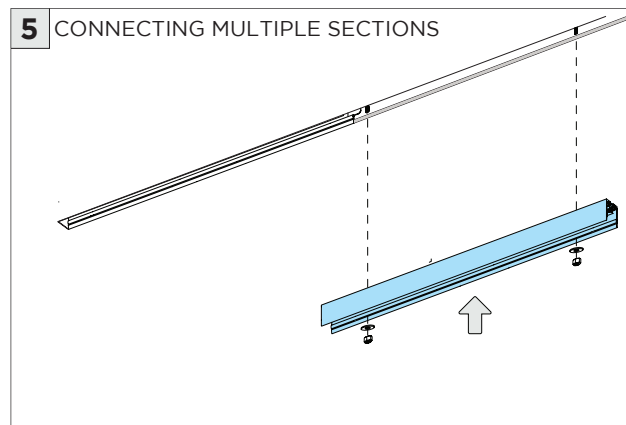
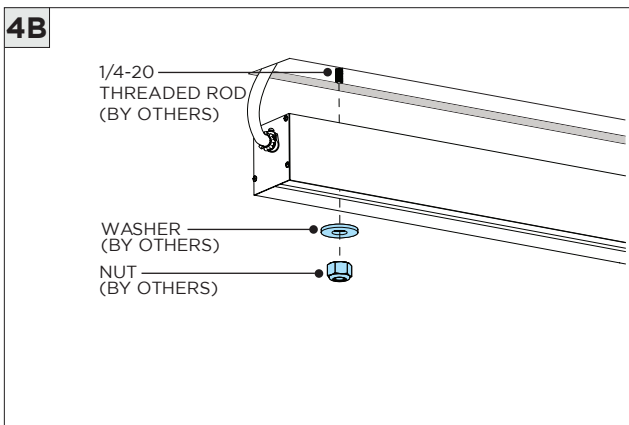
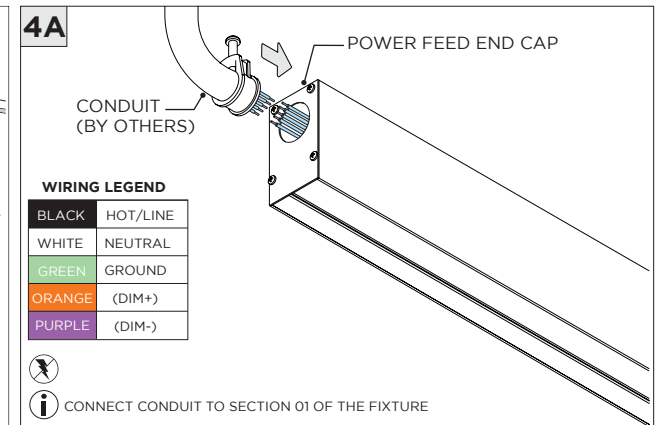
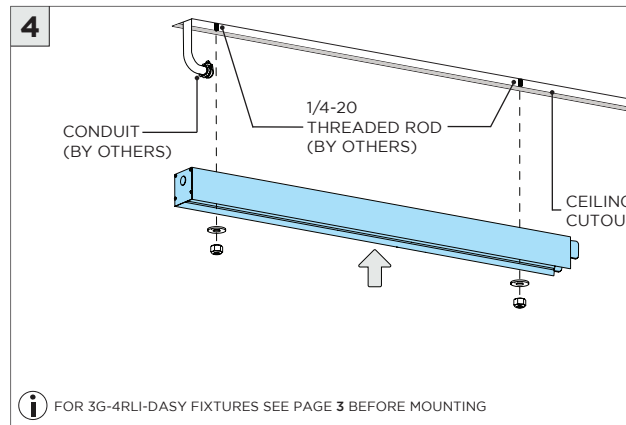
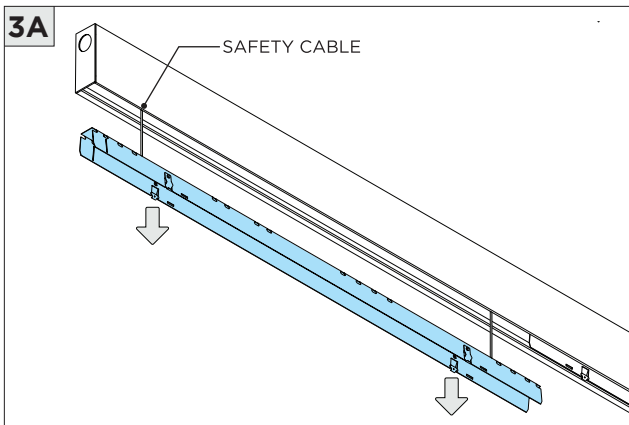
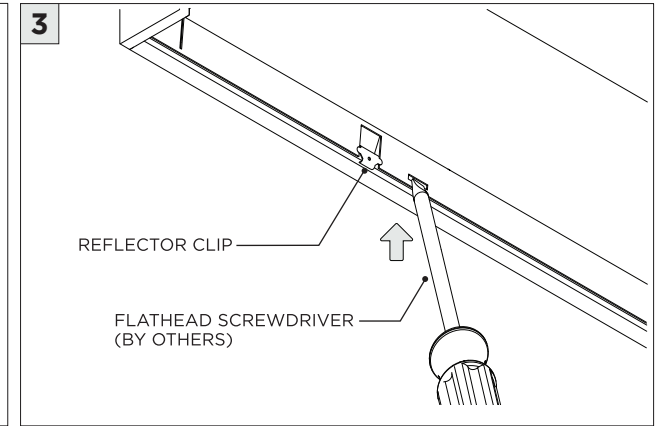
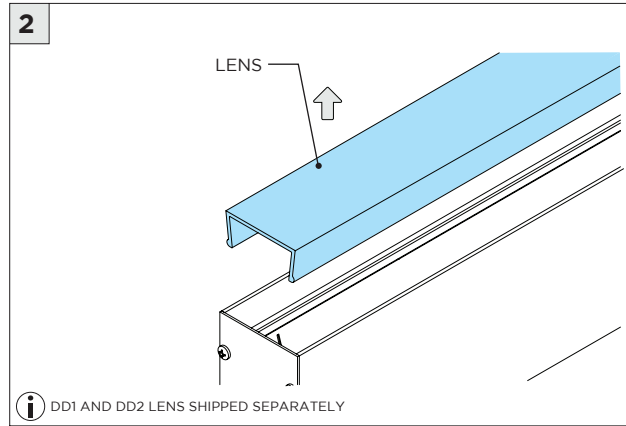
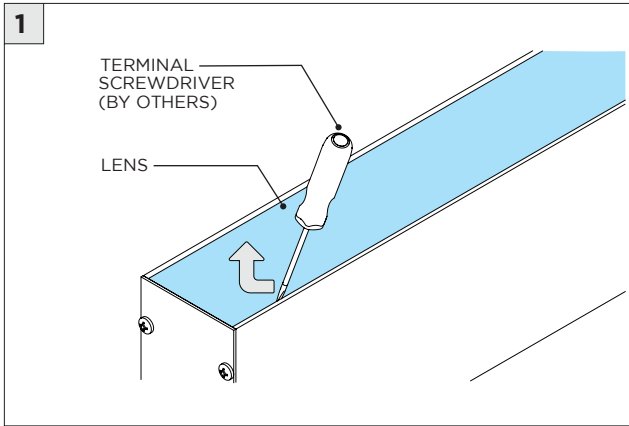

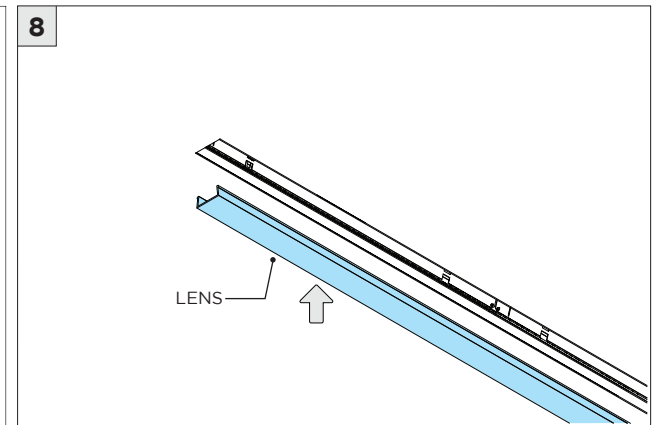
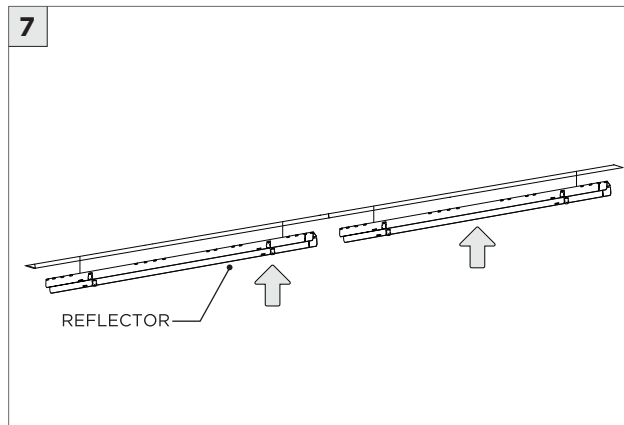
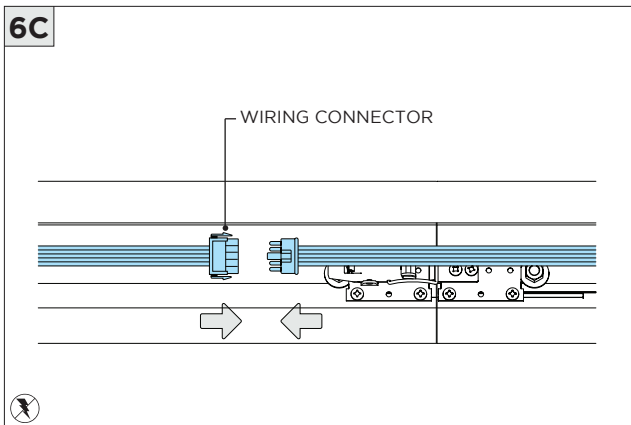
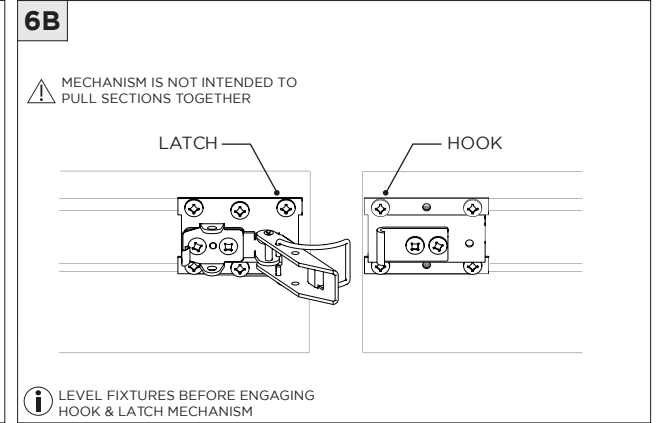
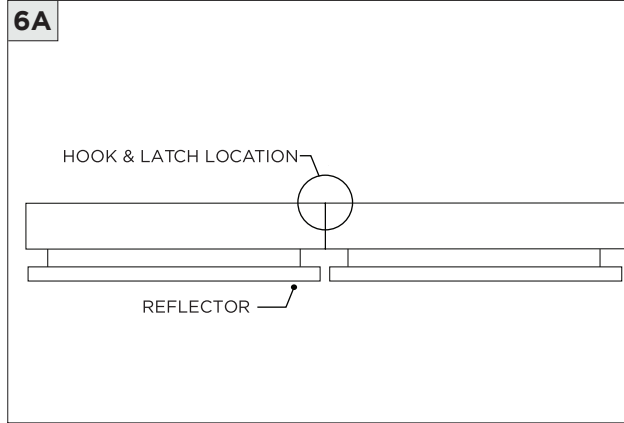
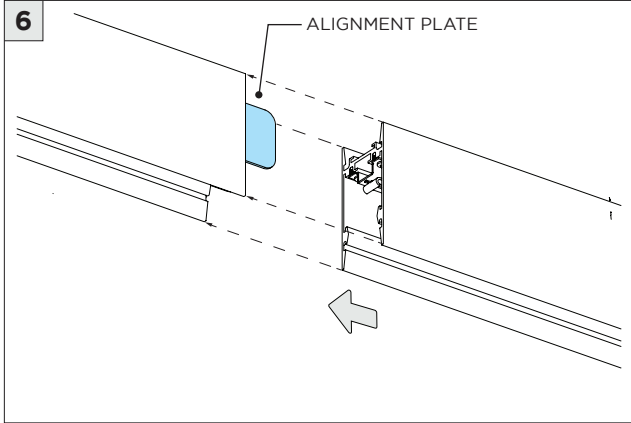

**DRIVER SERVICING**

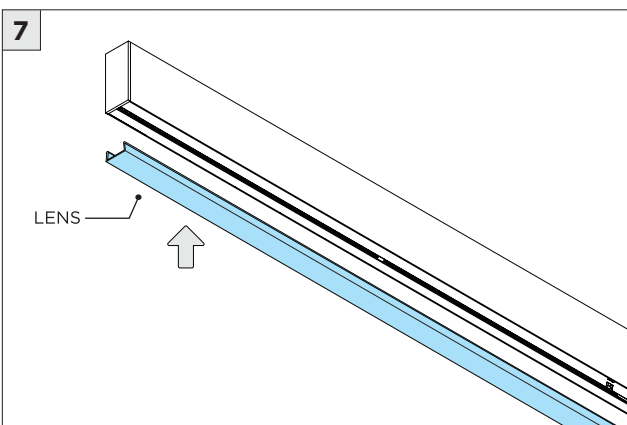
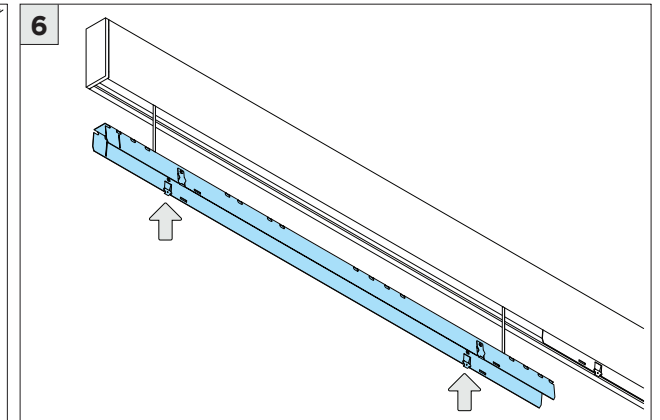
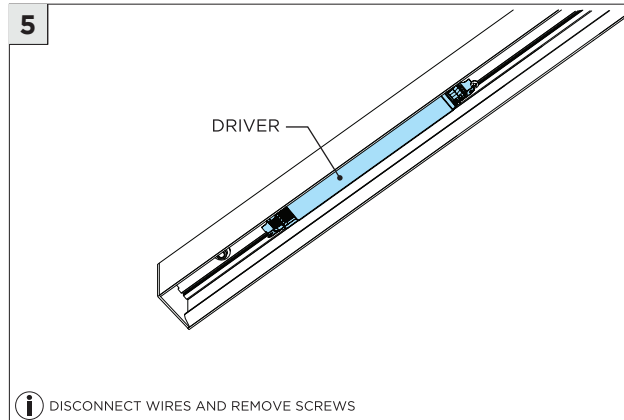
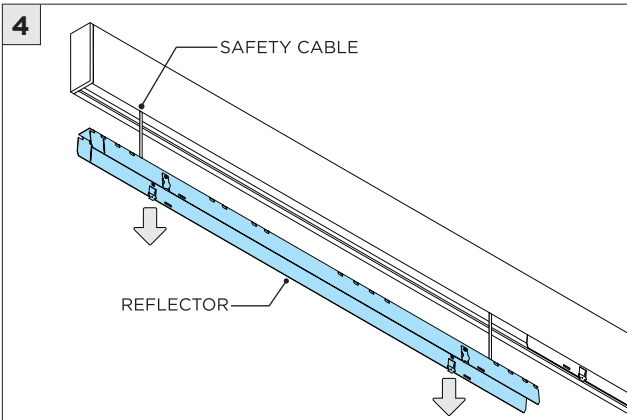
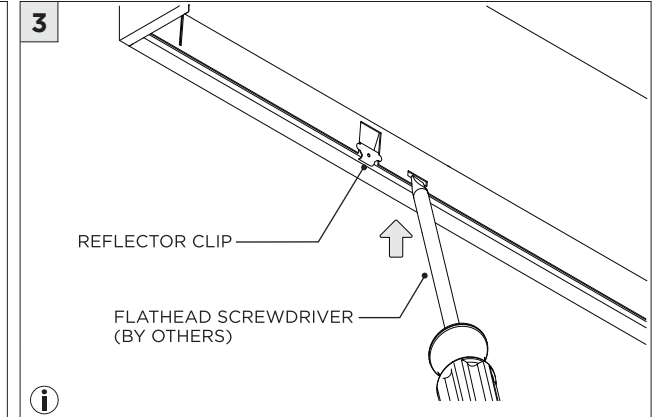
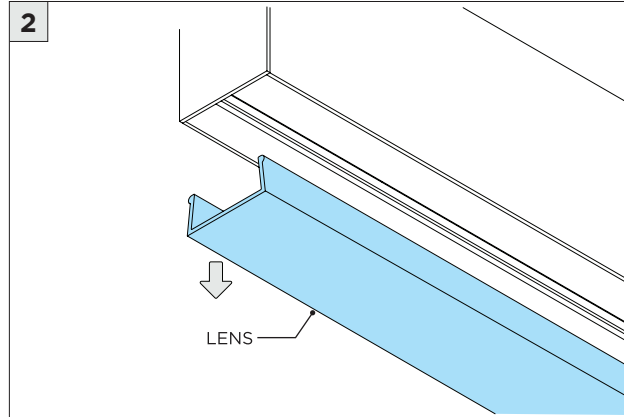
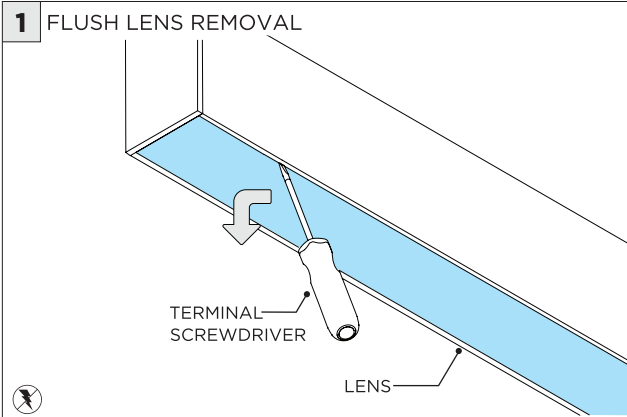

**LED SERVICING - DIRECT**

