

## 4.5" MINI MADISON CYLINDER

SURFACE MOUNT



### COMPONENTS

#### STANDARD CANOPY

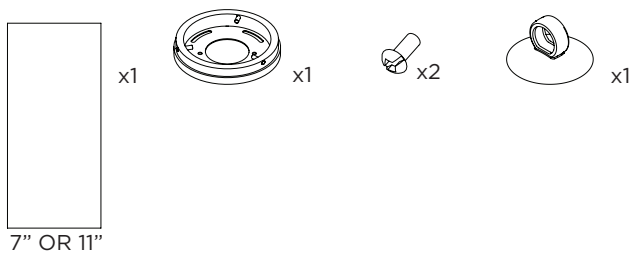

#### CONDUIT FEED CANOPY

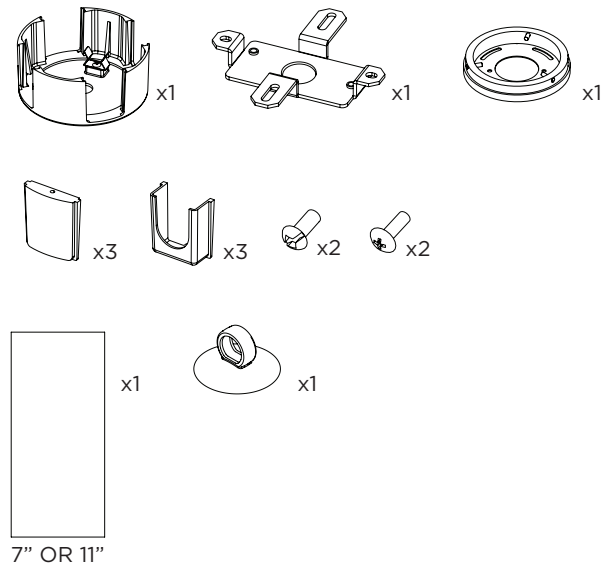

#### 4" OCTAGONAL J-BOX REQUIRED FOR INSTALLATION

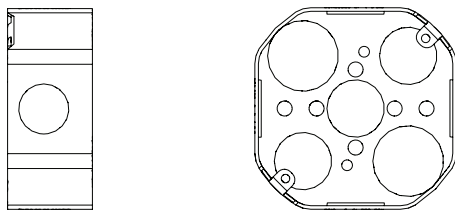

JUNCTION BOX (BY OTHERS)

INSTRUCTION KEY	INFORMATION
⚠ ADDITIONAL	INSTALLATION SHOULD ONLY BE PERFORMED BY A CERTIFIED ELECTRICIAN
ℹ ATTENTION	REFER TO LOCAL/NATIONAL CODES FOR PROPER INSTALLATION
⚡ POWER ON	FAILURE TO FOLLOW INSTALLATION INSTRUCTION MAY VOID THE WARRANTY
⏻ POWER OFF	DO NOT TOUCH LEDS. LEDS MUST BE PROTECTED FROM MECHANICAL STRESS OR DEBRIS
	TURN OFF POWER DURING INSTALLATION OR SERVICING

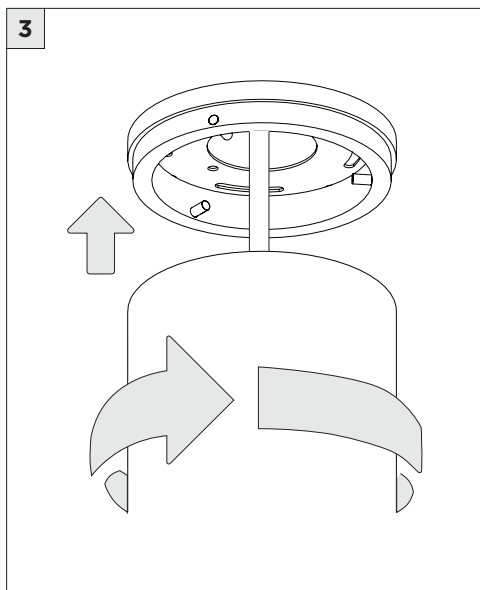
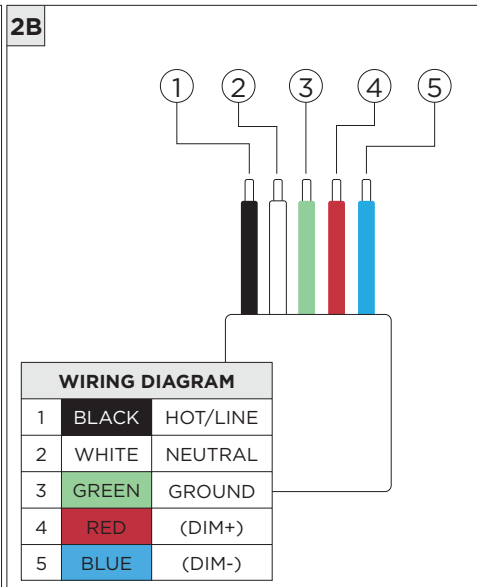
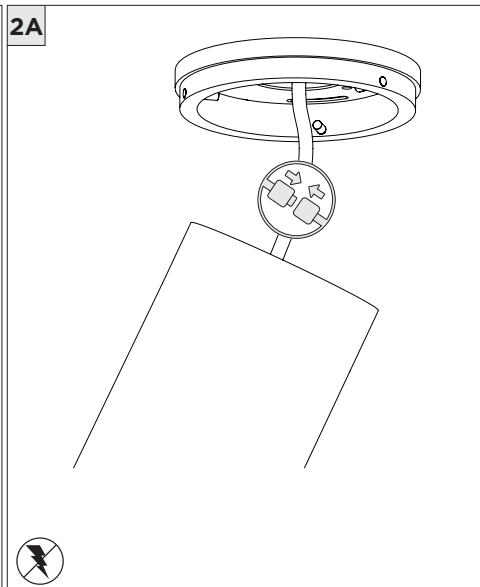
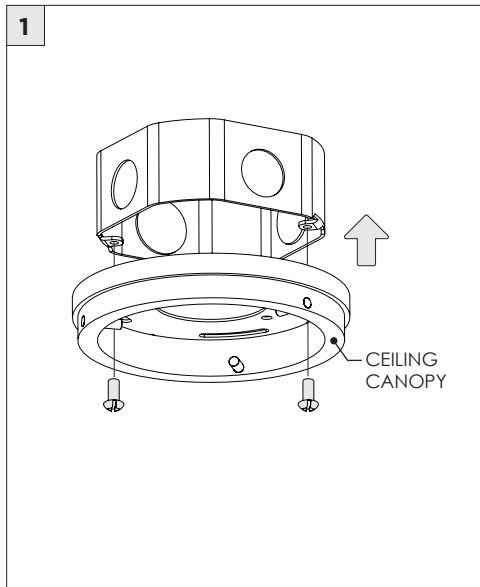

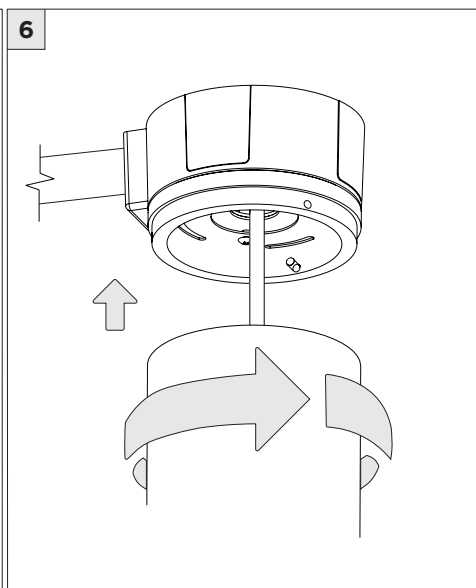
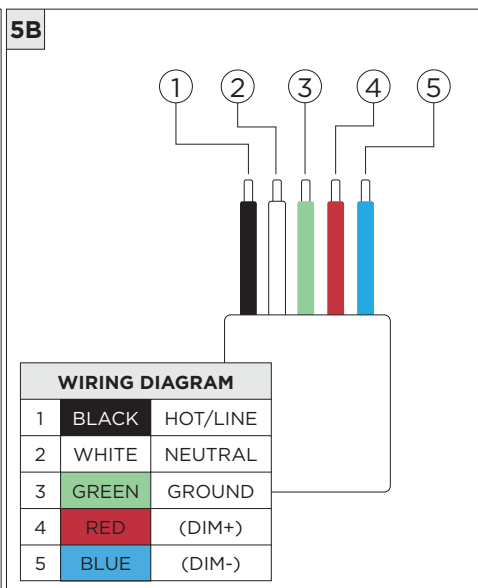
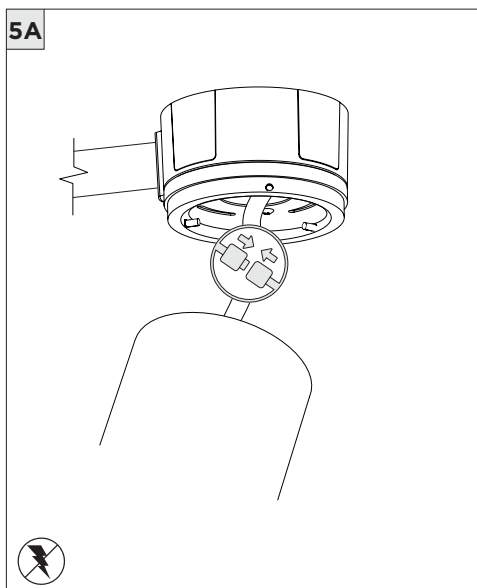
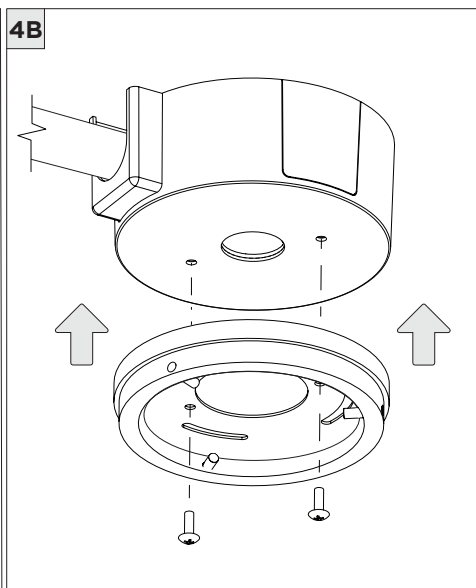
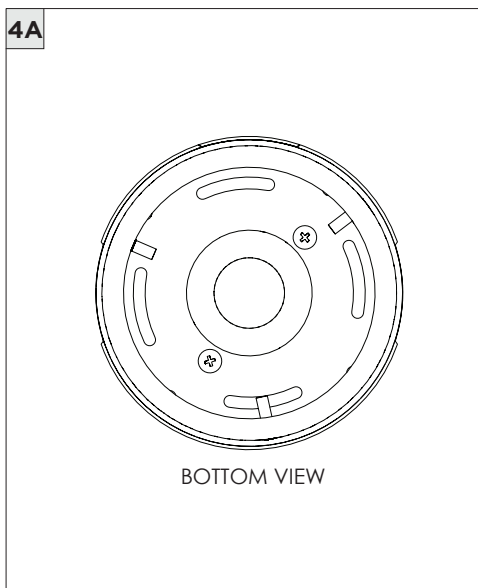
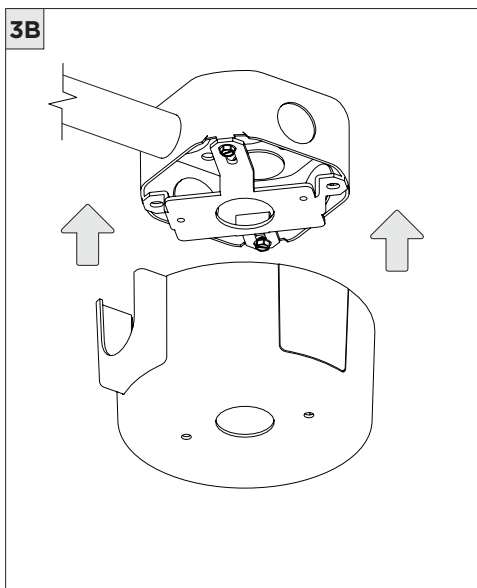
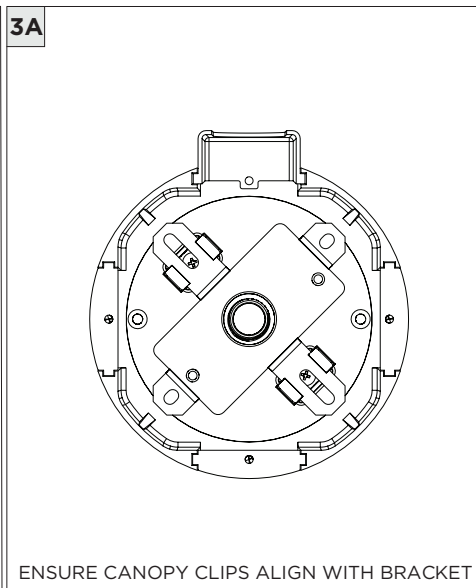
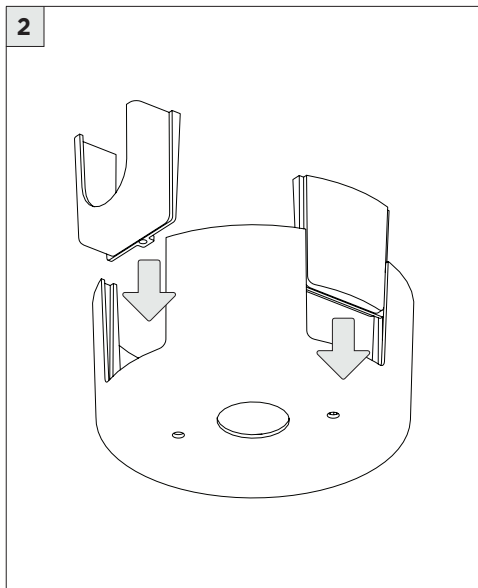
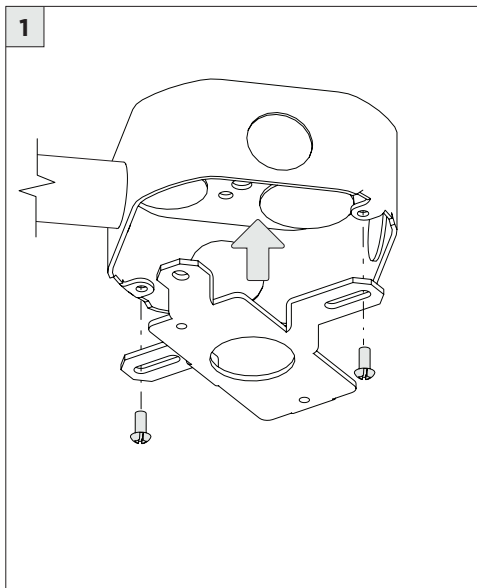

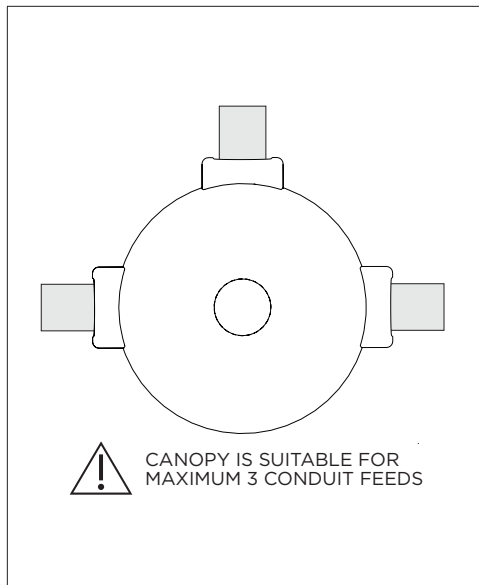

### DRIVER SERVICING

1

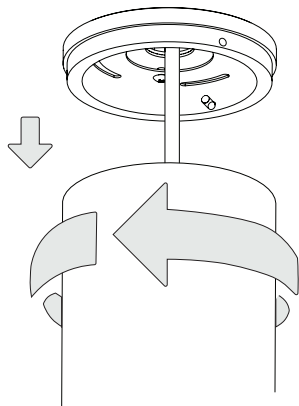

2

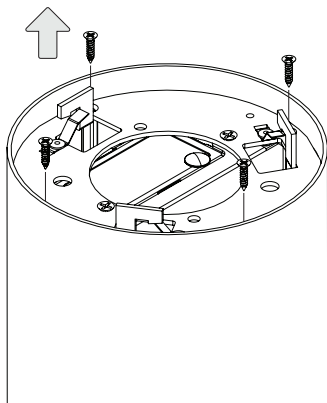

2

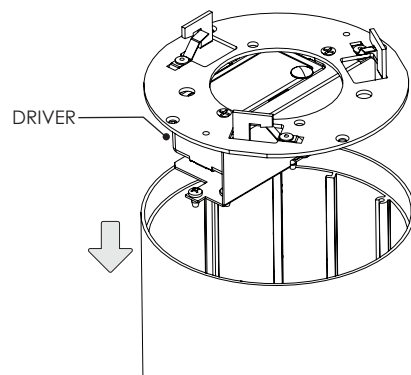

### LED SERVICING

1

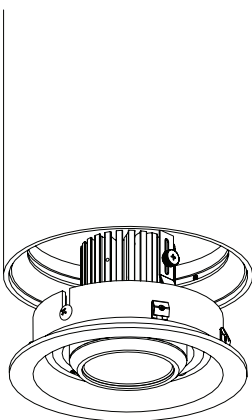

2

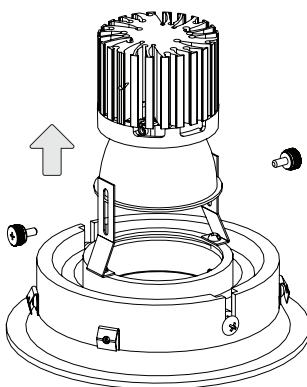

3

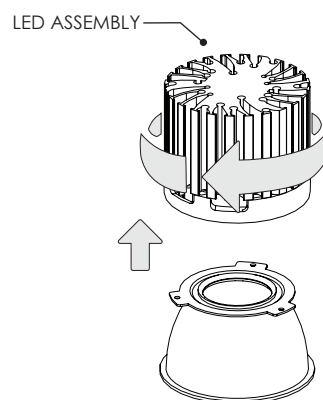

### DRIVER SERVICING

1

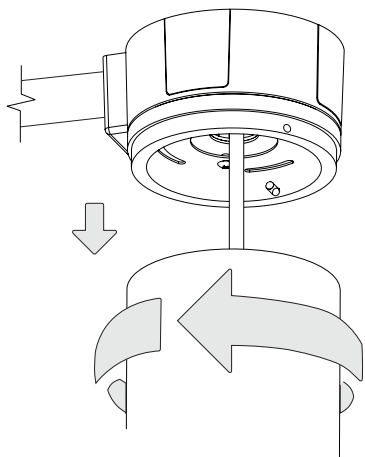

2

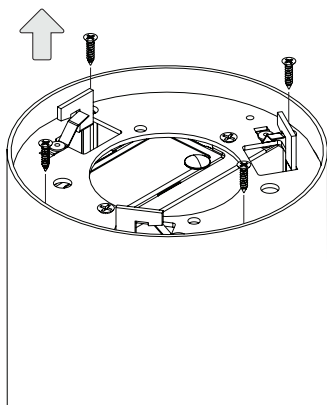

2

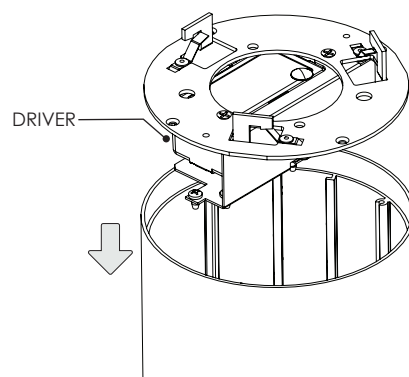

### LED SERVICING

1

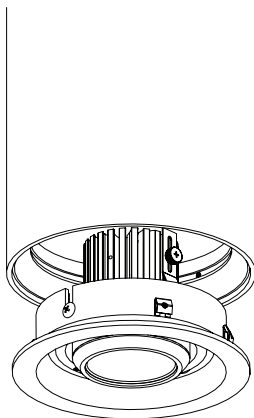

2

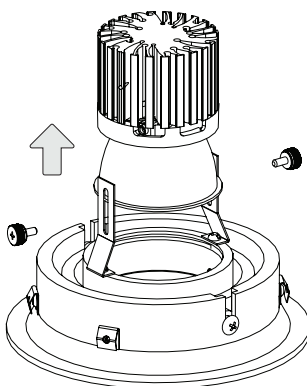

3

