

# 3G LIGHTING

## 3G-1WLI-D

1.5" LINEAR DIRECT  
WALL MOUNTED



Narrow 1.5" aperture with one piece extruded aluminum housing  
Individual or continuous runs available in multiple run configurations  
Direct distribution with multiple lumen output options  
LED system with performance up to 118 lumens per watt  
Extruded acrylic lens with optimal performance and glare control  
Asymmetric optics available  
1% dimming standard with several driver options

<b>PROJECT:</b>		<b>TYPE:</b>	
<b>CATALOG#:</b>		<b>DATE:</b>	<b>QTY:</b>

CAT. NO	LUMEN OUTPUT	CRI	COLOR TEMP	VOLTAGE
<b>3G-1WLI-D</b>	<b>D250</b> - 250 LM/FT <sup>1</sup> <b>D500</b> - 500 LM/FT <b>D750</b> - 750 LM/FT <b>D1000</b> - 1000 LM/FT <sup>2</sup> <b>DC__</b> - CUSTOM OUTPUT (SPECIFY LM/FT) *  <small>*Specify custom lumen outputs in 50lm increments (ie: DC600, DC650, DC700) Custom output cannot exceed D1000</small>	<b>S80</b> - 80+ CRI <sup>3</sup> <b>H90</b> - 90+ CRI	<b>27K</b> - 2700K <b>30K</b> - 3000K <b>35K</b> - 3500K <b>40K</b> - 4000K	<b>UNV</b> - 120/277V <b>347</b> - 347V <sup>4</sup>

DRIVER	LENS OPTION	FINISH	OPTIONS
<b>DIM</b> - 0-10V (100-1%) <b>D01</b> - 0-10V (100-0.1%) <b>DALI</b> - DALI (100-1%) <sup>5</sup> <b>DHL2</b> - LUTRON HI-LUME (1% ECOSYSTEM) <b>DMX</b> - DMX (100-0%)	<b>FL</b> - FLUSH <b>DASY</b> - ASYMMETRIC LENS	<b>WH</b> - WHITE <b>BK</b> - BLACK <b>SV</b> - SILVER	<b>EMB</b> - EMERGENCY BATTERY * (INTEGRAL) <b>EMC</b> - EMERGENCY CIRCUIT  <small>*Minimum 4' section</small>

RUN TYPE
<b>S</b> - ____' (STRAIGHT) * <b>L</b> - ____'X ____' (L-SHAPE) <b>U</b> - ____'X ____'X ____' (U-SHAPE)  <small>*Individual units available from 2' to 8' Continuous runs available in 1" increments as standard</small>

<sup>1</sup> D250 (250LM/FT) not available in 2' length with DALI, D01, DMX, or DHL2. Specify minimum DC350 for those driver options  
<sup>2</sup> D1000 (1000LM/FT) not available with H90 (90+ CRI)  
<sup>3</sup> S80 (80+ CRI) not available with 27K  
<sup>4</sup> 347 available in "DIM" 0-10V only (100-1%)  
<sup>5</sup> DALI-2 (Type 6) provided as standard. Please consult factory for DALI (Type 8) options

DELIVERED LUMENS PER FOOT BASED ON 80+ CRI 3500K LED SOURCE

**LENS OPTION**

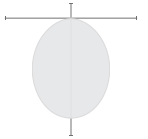
FLUSH	DELIVERED LUMENS (LM/FT)	SYSTEM WATTS (W/FT)	EFFICACY (LPW)
	250	2.2	112
	500	4.4	112
	750	6.8	110
	1000	9.3	107

ASYMMETRIC	DELIVERED LUMENS (LM/FT)	SYSTEM WATTS (W/FT)	EFFICACY (LPW)
	250	2.1	118
	500	4.2	118
	750	6.5	115
	1000	8.9	112

**LUMEN OUTPUT MULTIPLIERS**

COLOR TEMP	80+ CRI	90+ CRI
2700K	N/A	0.78
3000K	0.97	0.83
3500K	1.00	0.86
4000K	1.02	0.88

**HOUSING**

Extruded aluminum housing with narrow 1.5" aperture  
 Die cast aluminum end caps add 1/4" to each end of luminaire  
 Individual units and continuous runs available in 1" increments as standard  
 24-gauge LED reflector with high reflectance white powder coated finish  
 Standard polyester powder coated matte white finish. Optional finishes available

**OPTICS**

Extruded, satin acrylic lens designed for optimal performance and glare control. Up to 8' continuous  
 High performance asymmetric optics available

**LISTING**

ETL listed and conforms to UL1598 standard. Certified to CSA22.2 NO.250.0. Rated for indoor dry or damp locations

**WARRANTY**

5 Year Warranty on LED and drivers  
 Manufacturer 1 Year Warranty for defects in material and workmanship under normal use  
 Ambient temperature at fixture should not exceed 25°C

**ELECTRICAL**

Standard 0-10V, constant current drivers with 100-1% dimming range and >0.9 power factor  
 Standard 120/277V universal voltage with several driver options  
 Luminaires are pre-wired with factory installed quick connects and branch circuit wiring  
 All drivers are integral and easily accessible through luminaire aperture  
 Minimum 4' and maximum 6' length for each integral emergency battery. 10W output for 90 minutes

**LED SYSTEM**

Proprietary LED system with color consistency <3 SDCM  
 Available in 27K, 30K, 35K, and 40K  
 Standard 80+CRI. Optional 90+CRI  
 R9 value of 56 for 90+CRI  
 L90 >60,000 hours  
 5 Year Warranty

**MOUNTING**

Toolless installation with 3G's proprietary mounting system  
 Internal, toolless joiner system (latch and hook) easily connects multiple sections together  
 LED reflectors remain within each fixture section during installation with 3G's click and lock spring system  
 Suitable for wall mount applications (2"x4" junction box)  
 Fixture is secured to mounting brackets that fasten directly to wall  
 Suitable for various architectural ceilings (see mounting details)  
 Fixture weight: +/- 2.5 lb/ft

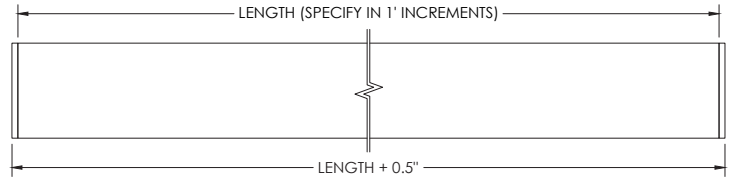
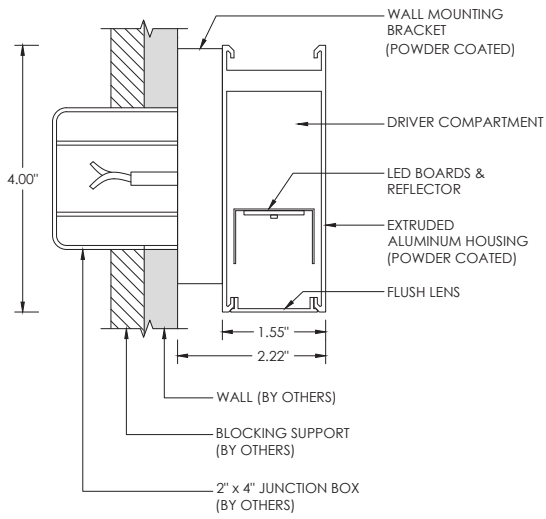

**LENS OPTION**

**FL - FLUSH**

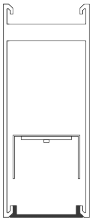

**DASY - ASYMMETRIC**

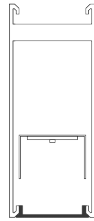

**PATTERNS**

Specify pattern shape and overall dimensions as shown below  
 Patterns are connected with fully illuminated 12"x12" L-shaped sections  
 Please consult factory for custom patterns and shapes not shown below



L-SHAPE	U-SHAPE
Provide dimensions of Ax B Example: L - 6'x8'	Provide dimensions of Ax BxC Example: U - 8'x10'x6"

**MOUNTING DETAILS**

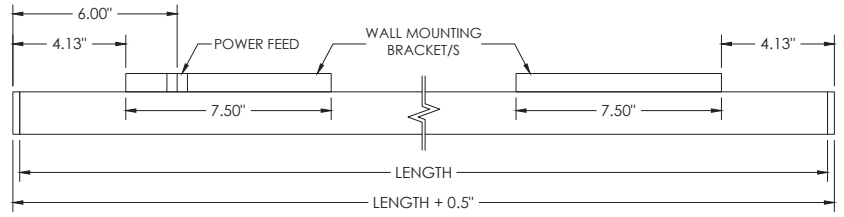
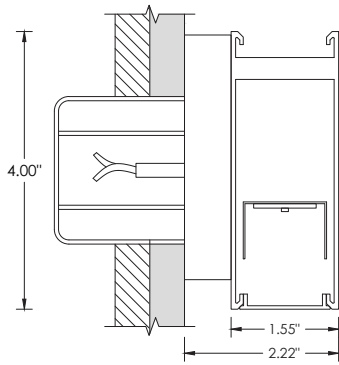

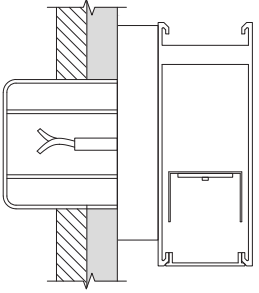
POWER FEED	NON POWER FEED
<p>2" x 4" SLOTTED JUNCTION BOX (BY OTHERS)</p> 	<p>MOUNTING SCREWS (BY OTHERS)</p> 