

3.3" DOWNLIGHT CYLINDER DEEP REGRESS PENDANT

STEM PENDANT MOUNT



i THE IMAGES SHOWN ARE FOR ILLUSTRATION ONLY AND MAY NOT BE AN EXACT REPRESENTATION OF THE PRODUCT

COMPONENTS

STANDARD CANOPY

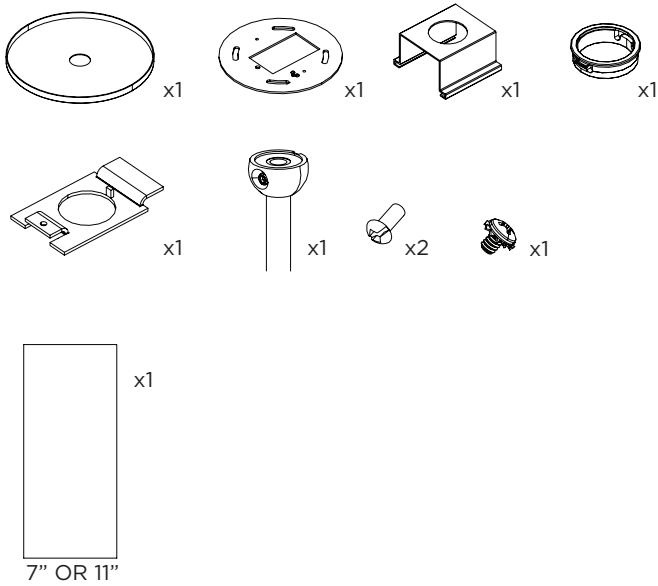

CONDUIT FEED CANOPY

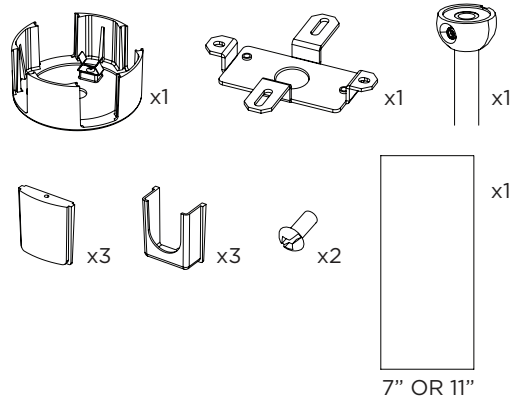

POWER CANOPY

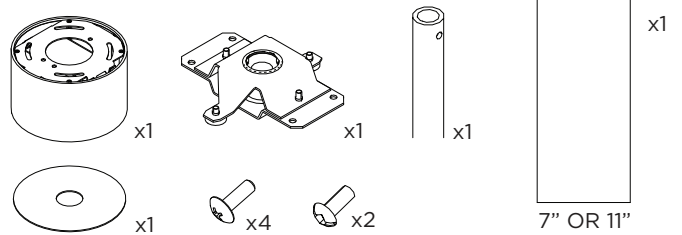

4" OCTAGONAL J-BOX REQUIRED FOR INSTALLATION

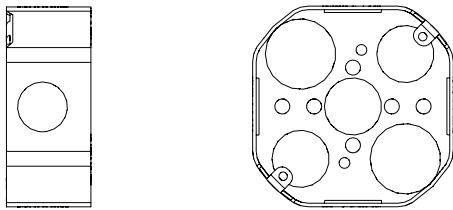

JUNCTION BOX (BY OTHERS)

SUITABLE FOR SLOPED CEILING

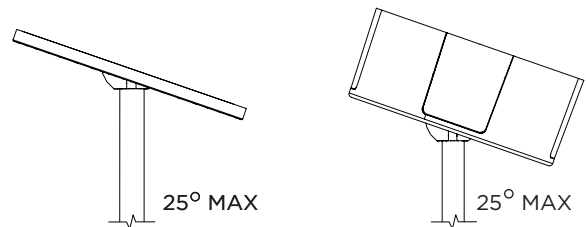

INSTRUCTION KEY

INFORMATION

- ADDITIONAL
- ATTENTION
- POWER ON
- POWER OFF

INSTALLATION SHOULD ONLY BE PERFORMED BY A CERTIFIED ELECTRICIAN
 REFER TO LOCAL/NATIONAL CODES FOR PROPER INSTALLATION
 FAILURE TO FOLLOW INSTALLATION INSTRUCTION MAY VOID THE WARRANTY
 DO NOT TOUCH LEDS. LEDS MUST BE PROTECTED FROM MECHANICAL STRESS OR DEBRIS
 TURN OFF POWER DURING INSTALLATION OR SERVICING

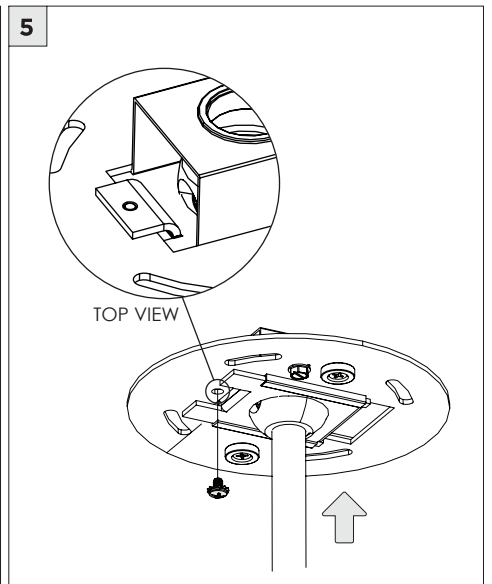
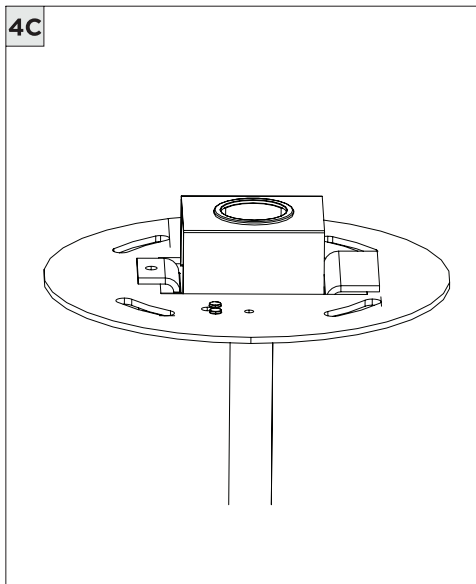
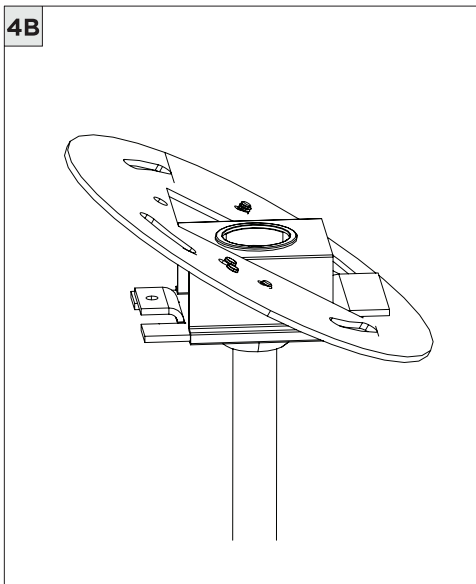
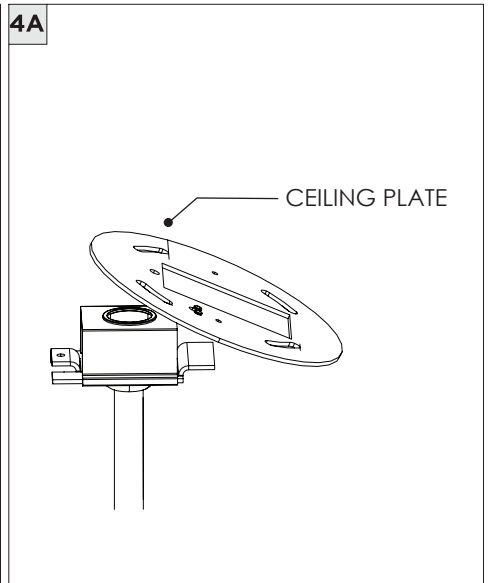
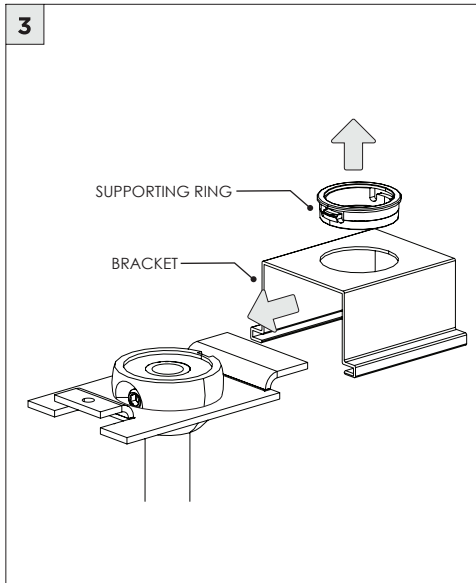
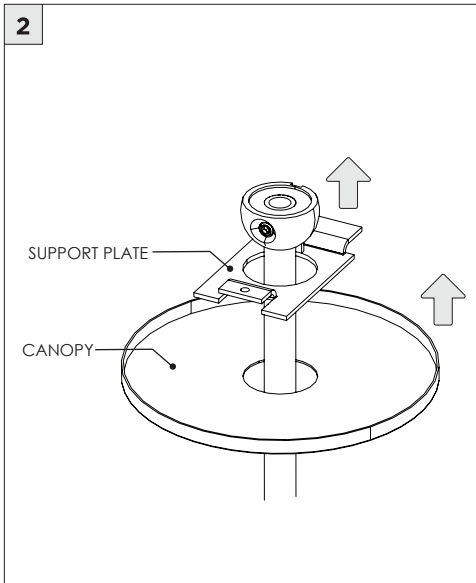
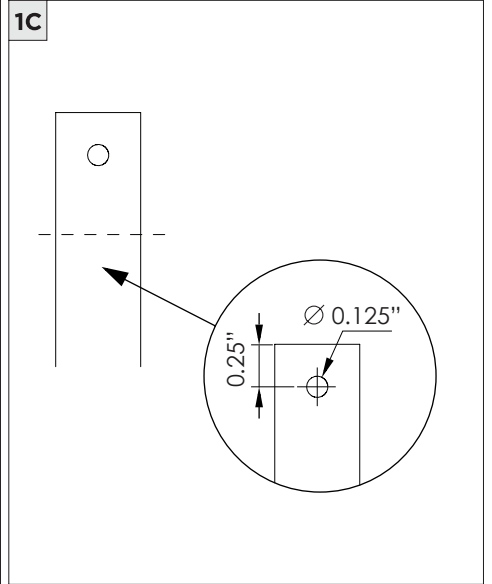
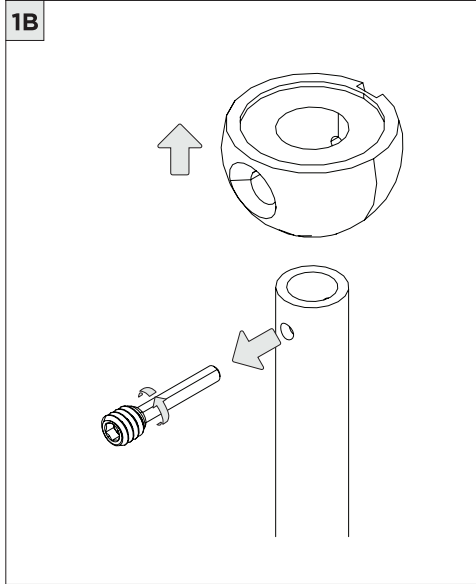
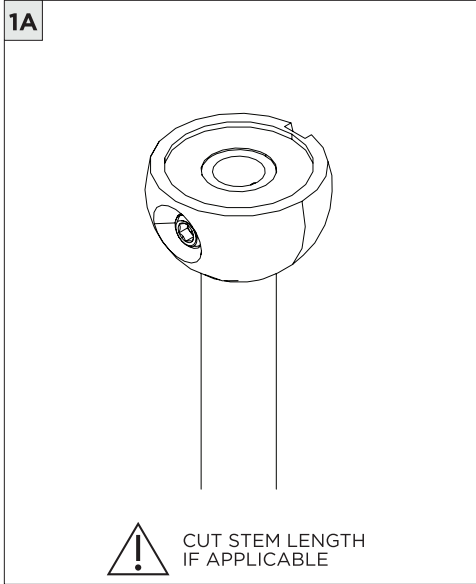

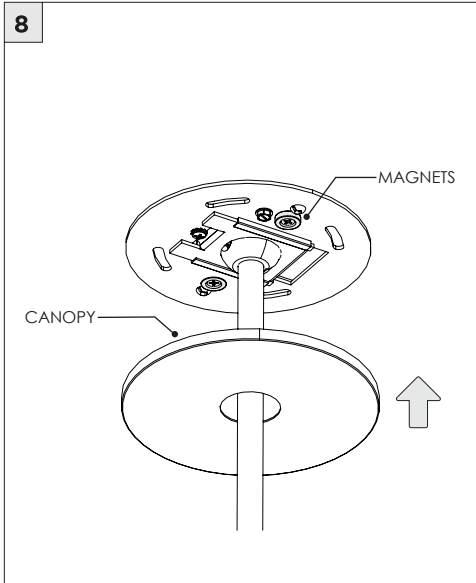
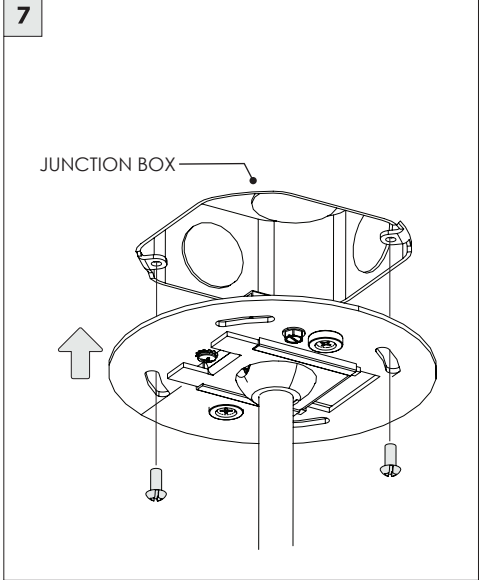
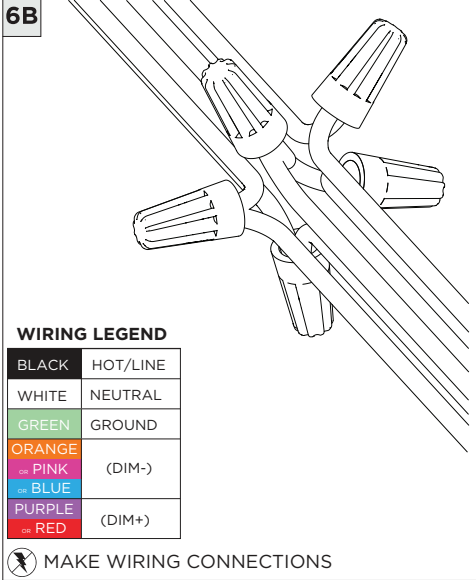
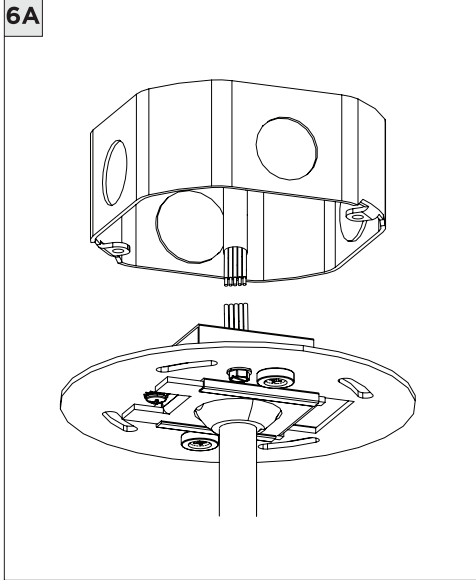

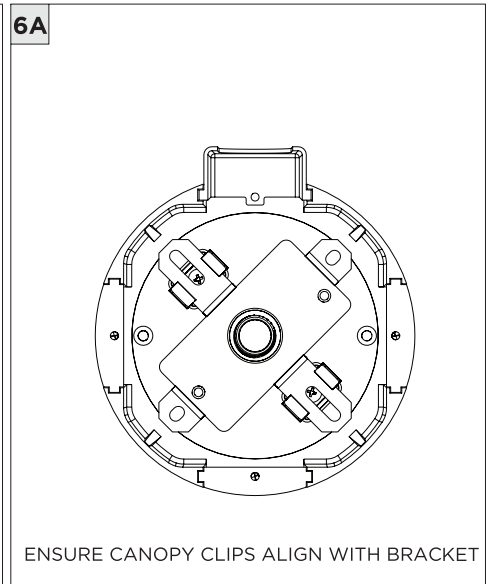
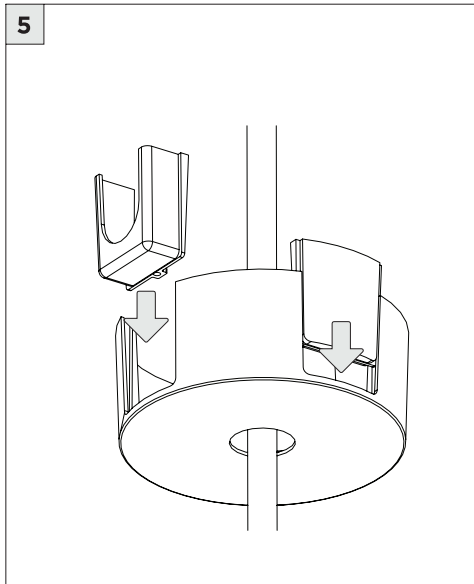
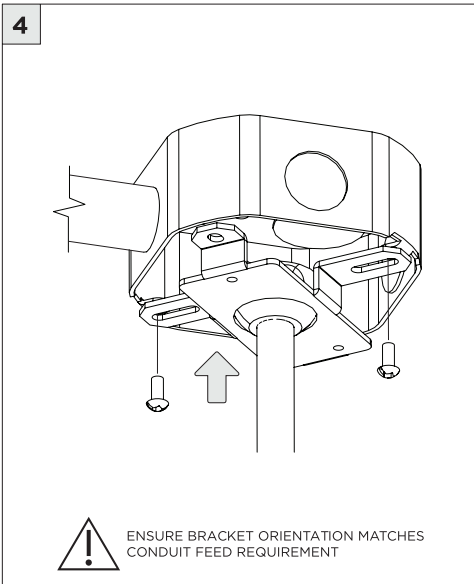
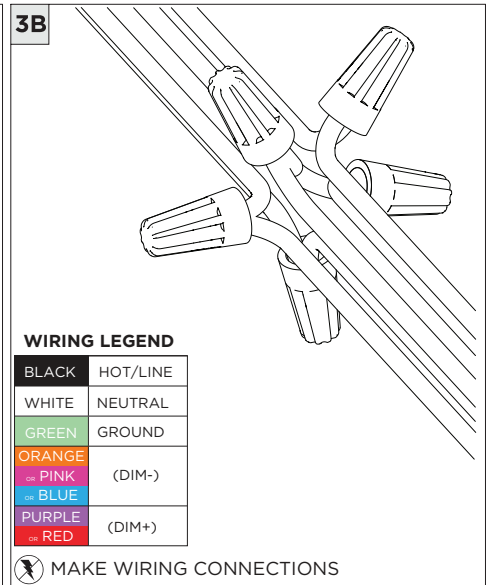
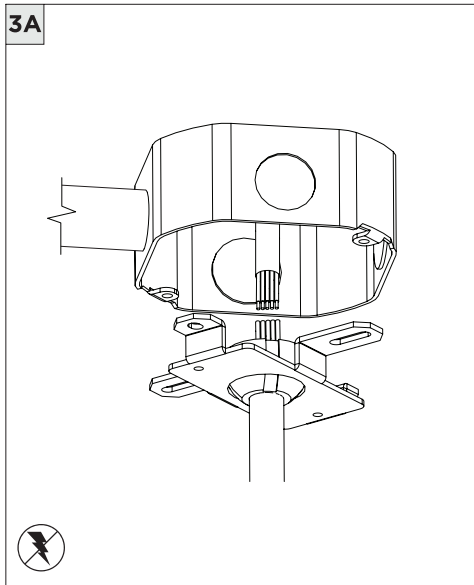
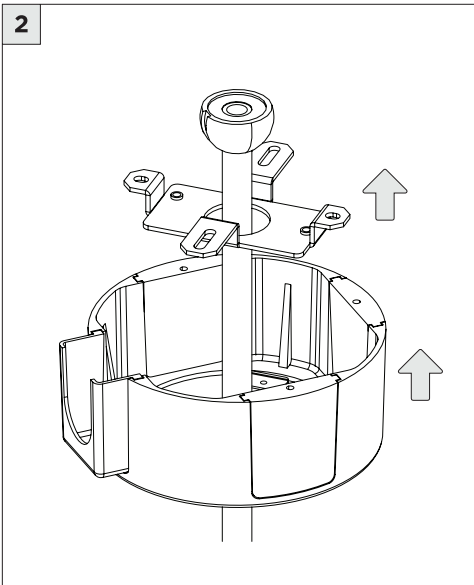
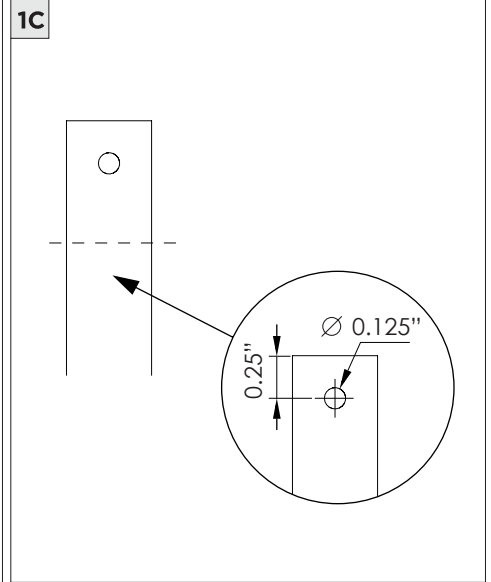
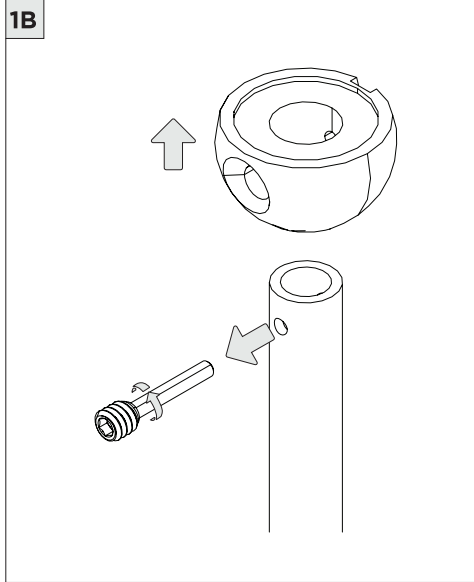
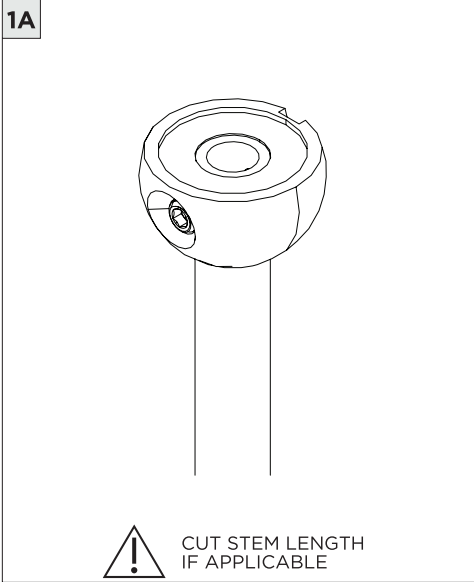

6B

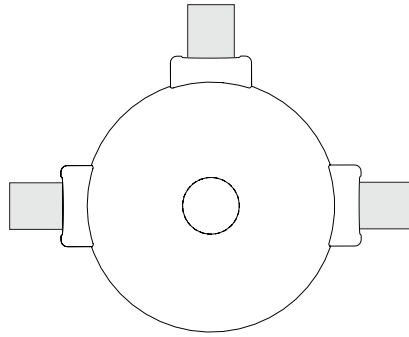
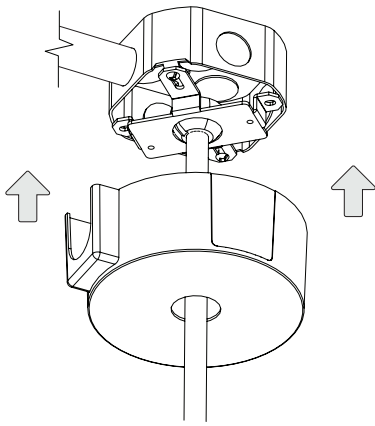

CANOPY IS SUITABLE FOR
MAXIMUM 3 CONDUIT FEEDS

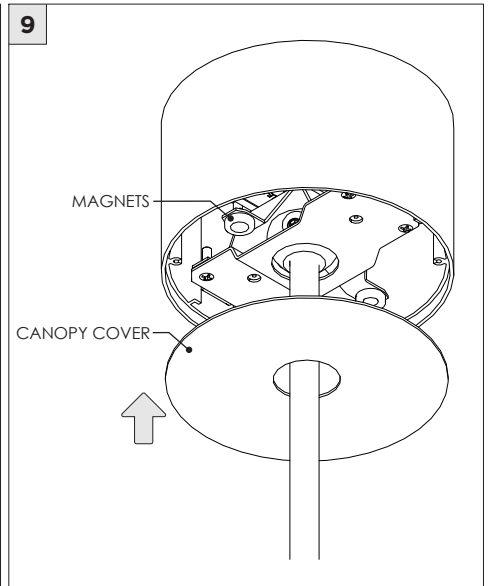
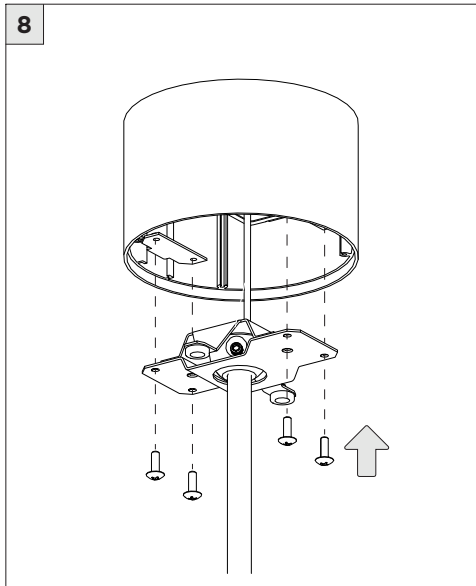
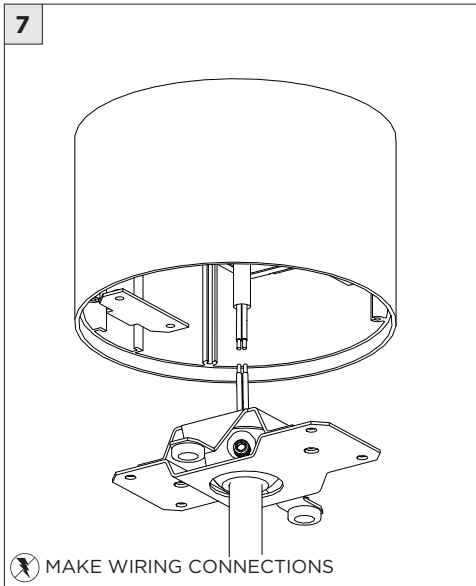
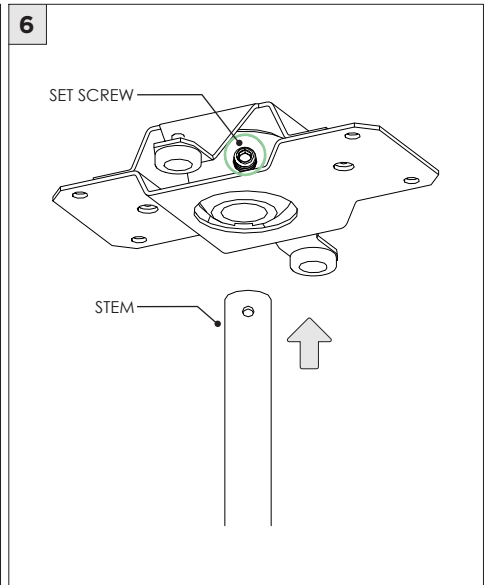
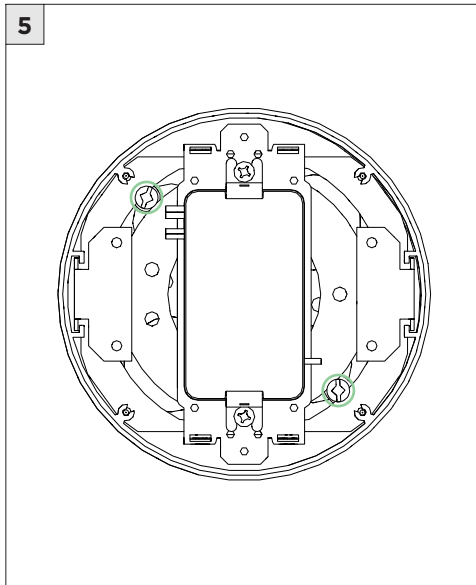
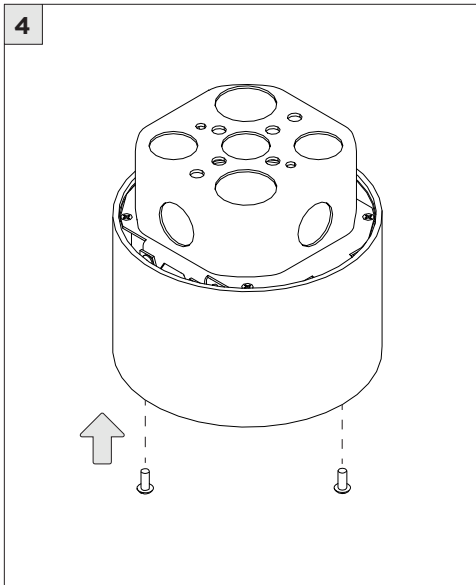
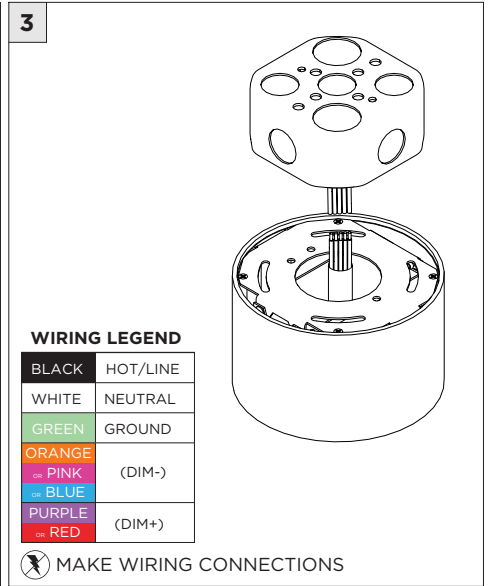
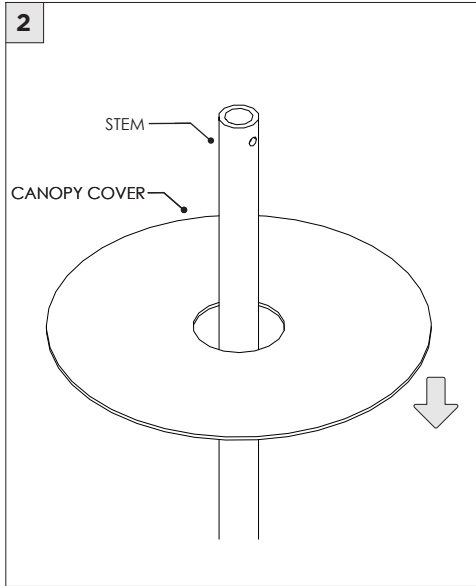
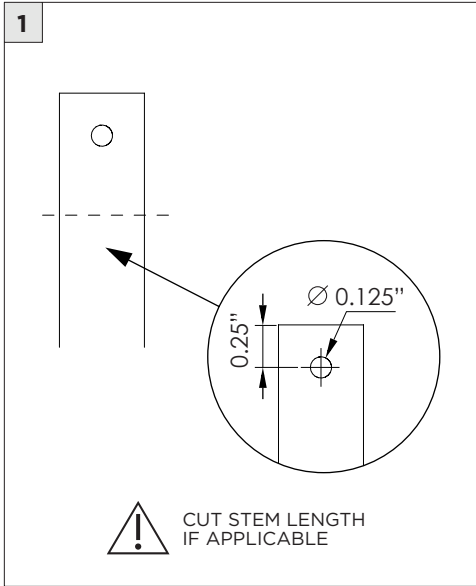

1 CONDUIT FEED CANOPY

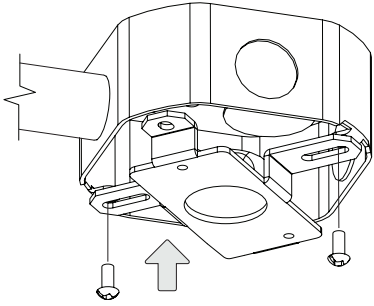

2

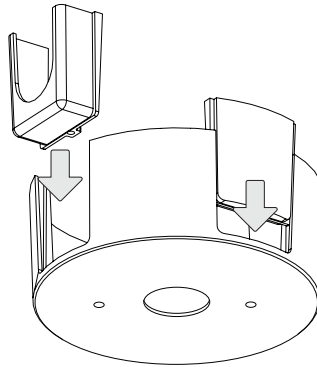

3

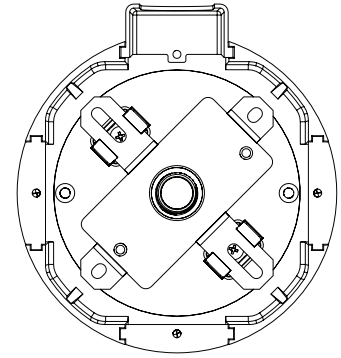

ENSURE CANOPY CLIPS ALIGN WITH BRACKET

4

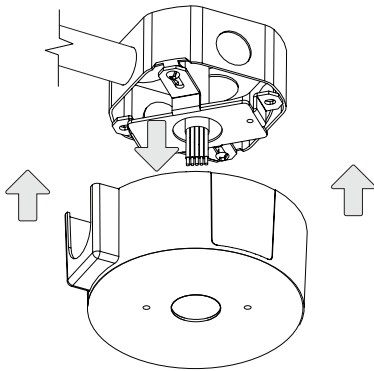

CONNECT CANDUIT CANOPY AND FEED
JUNCTION BOX WIRES THROUGH HOLE

5

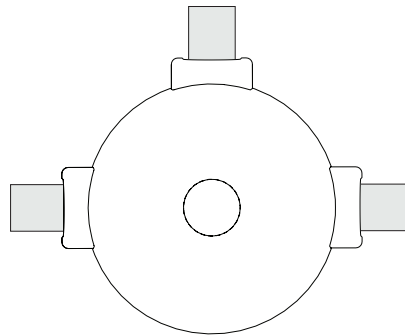

! CANOPY IS SUITABLE FOR
MAXIMUM 3 CONDUIT FEEDS

6 POWER CANOPY

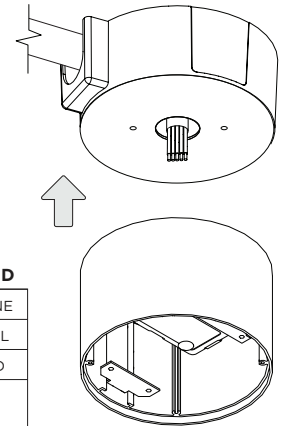

WIRING LEGEND

BLACK	HOT/LINE
WHITE	NEUTRAL
GREEN	GROUND
ORANGE	(DIM-)
PINK	(DIM-)
BLUE	(DIM-)
PURPLE	(DIM+)
RED	(DIM+)

! MAKE WIRING CONNECTIONS

7

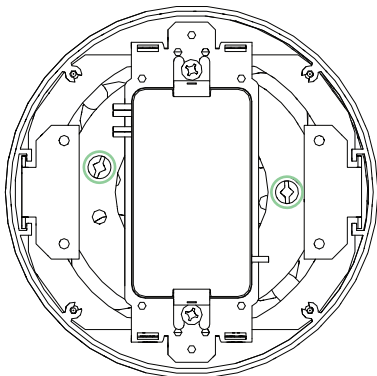

8

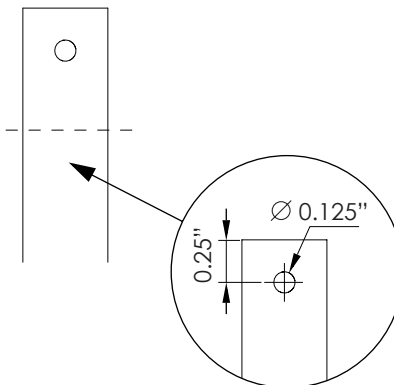

! CUT STEM LENGTH
IF APPLICABLE

9

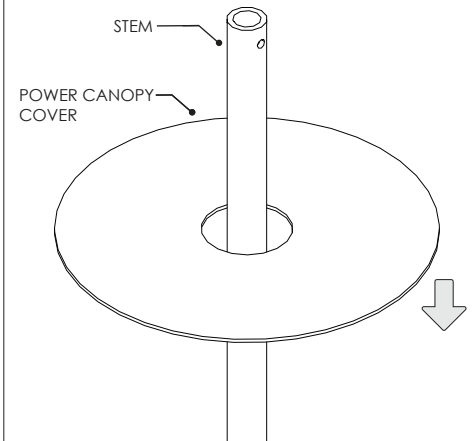

10

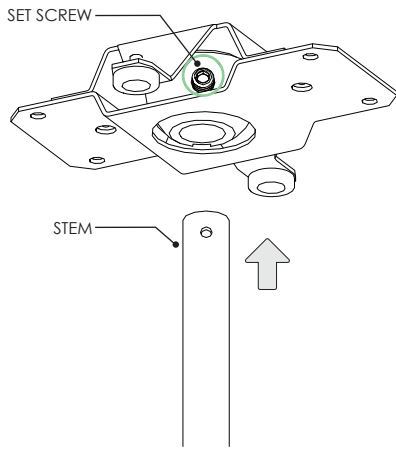

11

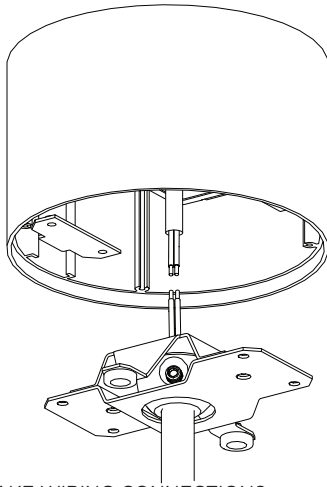

12

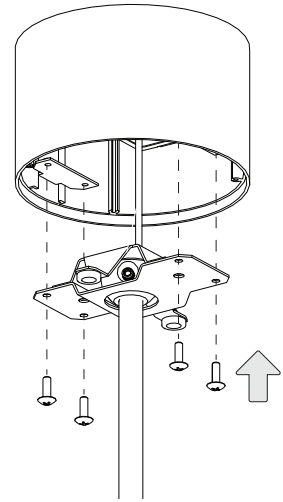

13

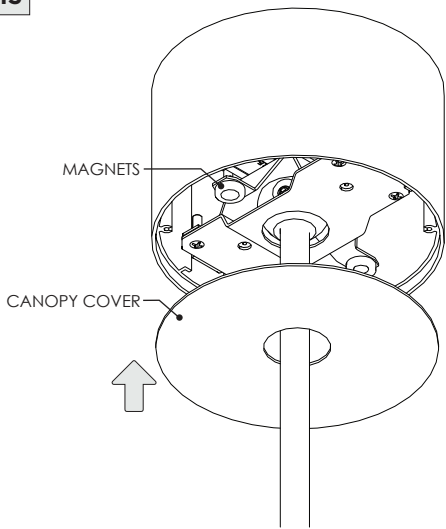

DRIVER SERVICING

1

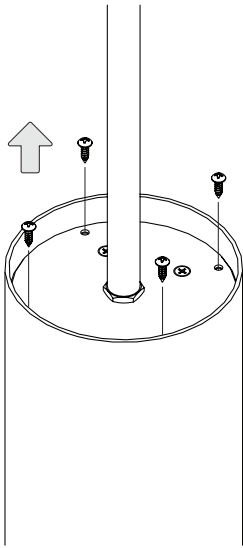

2

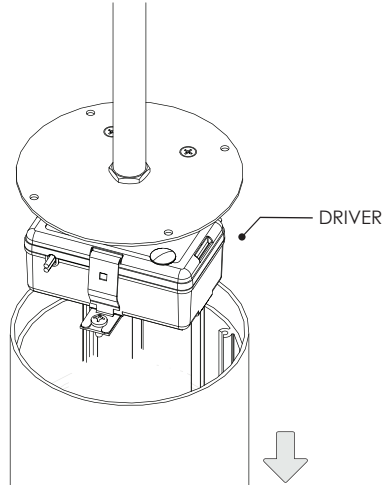

LED SERVICING

1

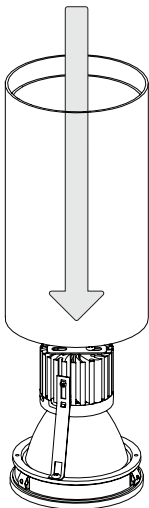

REPEAT DRIVER SERVICING STEPS
DISCONNECT LED WIRES AND REMOVE LED INSERT

2

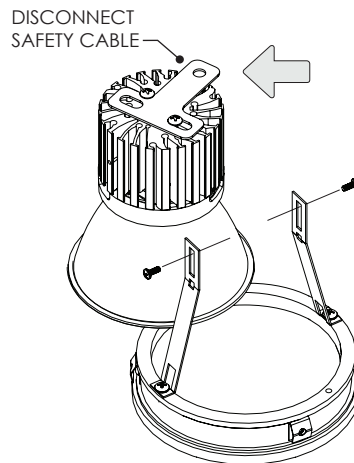

3

