

# 3G LIGHTING

## 3G-PDL33RM3

3.3" MICRO MADISON CYLINDER  
7" AND 11" HEIGHT

3.3" diameter high performance adjustable cylinders  
1.2" Regressed LED source with enhanced glare control  
Companion to 3G's Madison product family  
Machined aluminum trim features 3G's Micro Madison double gimbal  
Extruded aluminum housing with powder coated finish  
Lumen range up to 1000lm (80+, 90+, and 97+ CRI options)  
1% dimming standard with integral driver options



### ORDERING INFORMATION

<b>PROJECT:</b>	<input type="text"/>	<b>TYPE:</b>	<input type="text"/>
<b>CATALOG #:</b>	<input type="text"/>	<b>DATE:</b>	<input type="text"/>

CAT. NO	FIXTURE HEIGHT	LUMEN OUTPUT	CRI	COLOR TEMP	BEAM ANGLE
<b>3G-PDL33RM3</b>	<b>7H</b> - 7" HEIGHT	<b>07</b> - 700 LUMENS * <b>10</b> - 1000 LUMENS	<b>S80</b> - 80+ CRI <b>H90</b> - 90+ CRI <b>H97</b> - 97+ CRI <sup>1</sup>	<b>27K</b> - 2700K <b>30K</b> - 3000K <b>35K</b> - 3500K <b>40K</b> - 4000K	<b>30D</b> - 30° <b>45D</b> - 45° <b>65D</b> - 65°
	<b>11H</b> - 11" HEIGHT				
			* 700 lumens not available in 7H fixture height		

VOLTAGE	DRIVER	HOUSING FINISH	GIMBAL FINISH
<b>UNV</b> - 120/277V <b>120</b> - 120V	<b>DIM</b> - 0-10V (STANDARD 100-1%) <b>LE</b> - PHASE DIMMING <sup>2</sup> (TRIAC/ELV, 100-1%)	<b>WH</b> - WHITE <b>BK</b> - BLACK <b>SV</b> - SILVER <b>CF</b> - CUSTOM RAL COLOR	<b>NG</b> - NATURAL <b>BG</b> - BLACK <b>WG</b> - WHITE

CANOPY	SUSPENSION TYPE	SUSPENSION LENGTH
<b>WCN</b> - WHITE (STANDARD) <b>BCN</b> - BLACK <b>SCN</b> - SILVER <b>CFW</b> - WHITE CONDUIT FEED CANOPY <b>CFB</b> - BLACK CONDUIT FEED CANOPY <b>CFS</b> - SILVER CONDUIT FEED CANOPY	<b>WC</b> - WHITE CABLE <b>BC</b> - BLACK CABLE <b>RSW</b> - WHITE RIGID STEM <b>RSB</b> - BLACK RIGID STEM <b>RSS</b> - SILVER RIGID STEM <b>RSC</b> - CUSTOM RAL STEM	<b>C60</b> - 60" CABLE <b>C120</b> - 120" CABLE <b>S48</b> - 48" STEM <b>S96</b> - 96" STEM

All suspension options are field cuttable

<sup>1</sup> 97+ CRI available in 30K and 35K as standard  
<sup>2</sup> Phase dimming options available in 120V only

JANUARY 20, 2021

### PERFORMANCE CHART BASED ON 65° BEAM ANGLE AND 3500K SOURCE

LUMEN OUTPUT	80+ CRI			90+ CRI			97+ CRI		
	DELIVERED LUMENS	SYSTEM WATTS	EFFICACY (LPW)	DELIVERED LUMENS	SYSTEM WATTS	EFFICACY (LPW)	DELIVERED LUMENS	SYSTEM WATTS	EFFICACY (LPW)
<b>700LMs</b>	729	6.5	112	642	6.5	99	598	6.5	92
<b>1000LMs</b>	1057	9.3	114	930	9.25	101	866	9.25	94

LUMEN OUTPUT ADJUSTMENT FACTORS	CCT	Multiplier
	2700K	0.94
	3000K	0.97
	3500K	1.00
	4000K	1.01

### PHOTOMETRY

#### 30D - 30° BEAM ANGLE

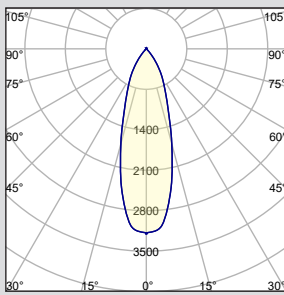

#### 3G-PDL33RM3-10-S80-35K-30D

LUMEN OUTPUT: 1000LMs  
 DELIVERED LUMENS 1014LMs  
 SYSTEM WATTS: 9.3W  
 EFFICACY: 110LPW  
 CRI: 80+  
 CCT: 3500K

#### 45D - 45° BEAM ANGLE

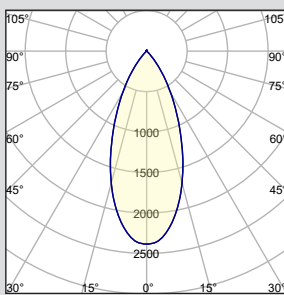

#### 3G-PDL33RM3-10-S80-35K-45D

LUMEN OUTPUT: 1000LMs  
 DELIVERED LUMENS 1032LMs  
 SYSTEM WATTS: 9.3W  
 EFFICACY: 112LPW  
 CRI: 80+  
 CCT: 3500K

#### 65D - 65° BEAM ANGLE

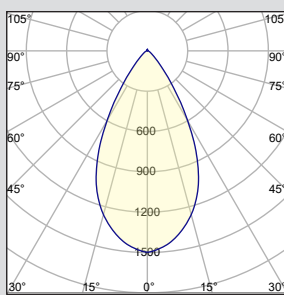

#### 3G-PDL33RM3-10-S80-35K-65D

LUMEN OUTPUT: 1000LMs  
 DELIVERED LUMENS 1057LMs  
 SYSTEM WATTS: 9.3W  
 EFFICACY: 114LPW  
 CRI: 80+  
 CCT: 3500K

**TECHNICAL****HOUSING**

Extruded aluminum housing with powder coated finish

**BEVELED INSERT**

3.3" machined aluminum trim insert feature 3G's Micro Madison double gimbal

Solid aluminum 30mm double gimbal with dual axis adjustability (35°x35°)

**OPTICS**

Regressed LED source for enhanced glare control

Proprietary, high performance reflectors. Field replaceable

Available in 30°, 45° and 65°

**ELECTRICAL**

Standard 0-10V, constant current drivers with 100-1% dimming range and >0.9 power factor

Standard 120/277V universal voltage drivers

120V Forward Phase/Reverse Phase driver option with 100-1% dimming range

All drivers are integral and easily accessible through fixture aperture

**LED SYSTEM**

Citizen LED module (field replaceable)

Color consistency <2 SDCM

Standard (80+ CRI). Optional (90+ and 97+ CRI)

Available in 27K, 30K, 35K, and 40K

L90 >50,000 hours

5 Year Warranty

**MOUNTING**

1/2" diameter rigid stem option with sloped ceiling adapter (field cuttable)

Standard, 18-gauge, 5 conductor single circuit braided power feed (black and white finish)

All hardware included for mounting to 4" octagonal junction box

Canopy provided in white finish as standard

Conduit feed cut-out canopy option designed to mount to 4" octagonal junction box

**LISTING**

ETL listed and tested to cUL standards. Suitable for dry and damp locations

**WARRANTY**

5 Year Warranty on LED and drivers

Manufacturer 1 Year Warranty for defects in material and workmanship under normal use

Ambient temperature at fixture should not exceed 25°C

**DRAWINGS AND DIMENSIONS**

**RECESSED 4" OCTAGONAL JUNCTION BOX BY OTHERS  
STANDARD CANOPY MOUNT**

**CABLE SUSPENSION**

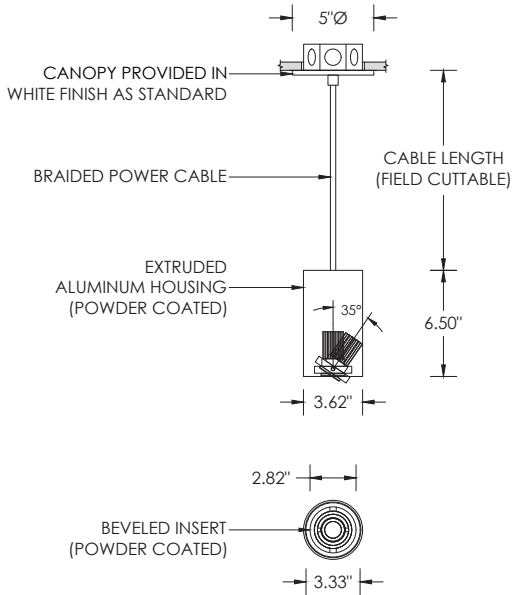

**STEM SUSPENSION**

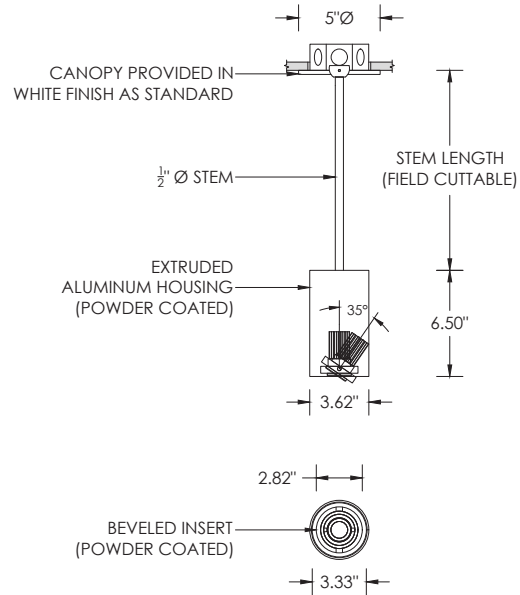

**SUITABLE FOR SLOPED CEILING**

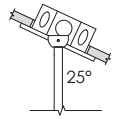

**CABLE SUSPENSION**

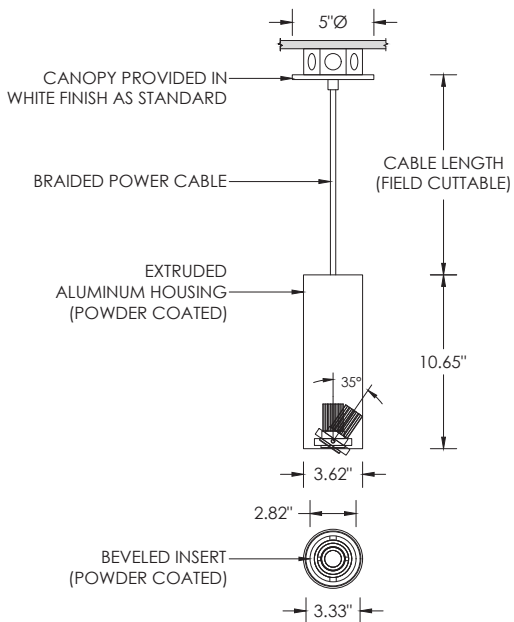

**STEM SUSPENSION**

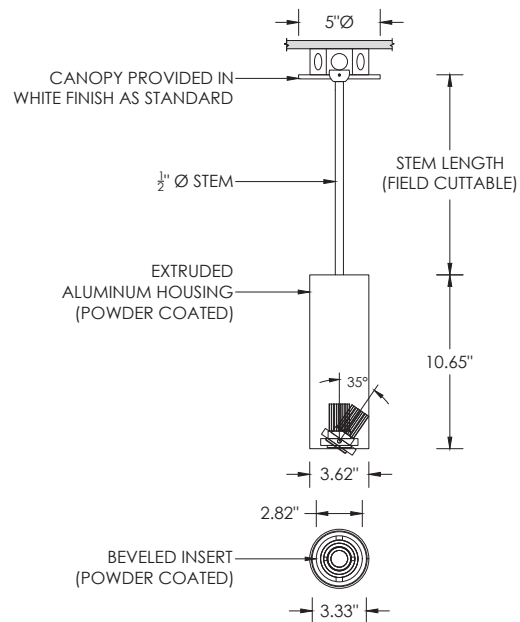

**SUITABLE FOR SLOPED CEILING**

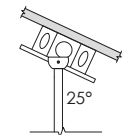

**DRAWINGS AND DIMENSIONS**

**SURFACE 4" OCTAGONAL X 1.5" DEEP JUNCTION BOX BY OTHERS  
CONDUIT FEED CANOPY MOUNT (CFX OPTION)**

**CABLE SUSPENSION**

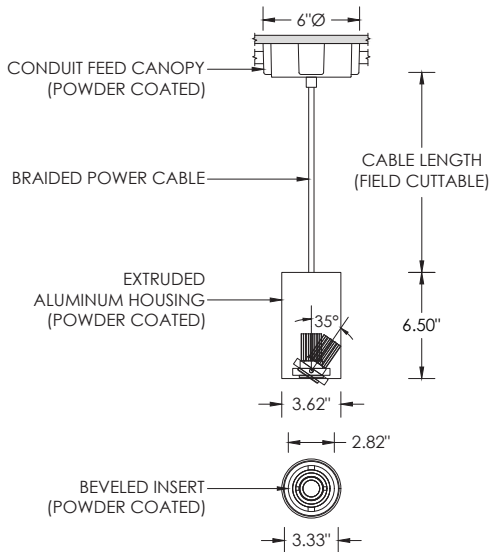

**STEM SUSPENSION**

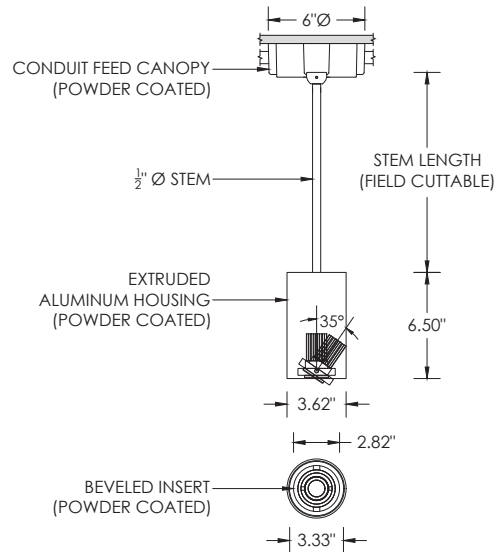

**SUITABLE FOR SLOPED CEILING**

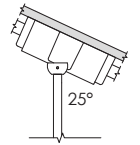

**CABLE SUSPENSION**

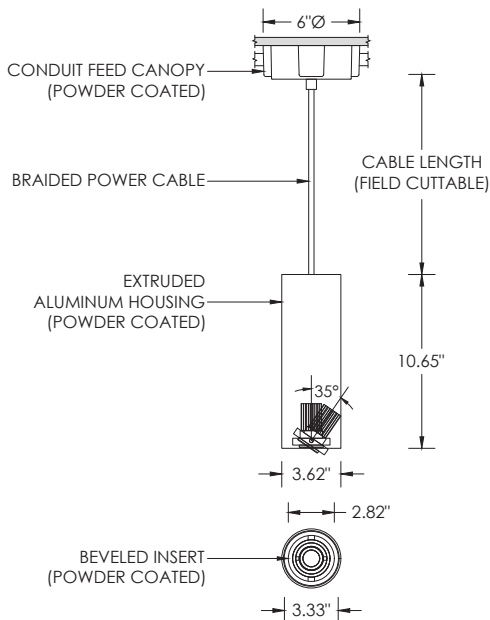

**STEM SUSPENSION**

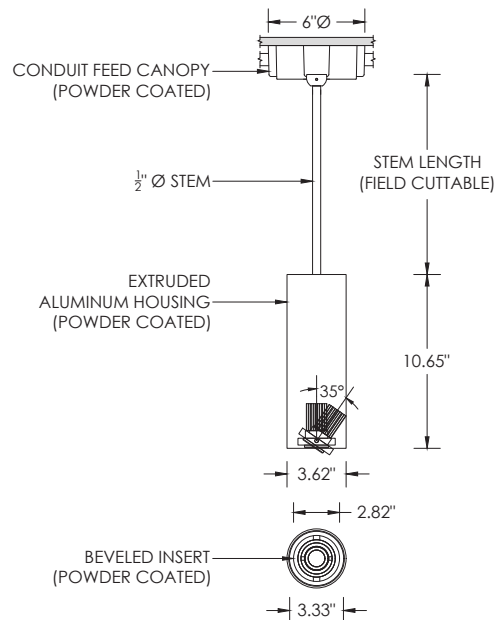

**SUITABLE FOR SLOPED CEILING**

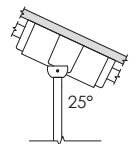

**DRAWINGS AND DIMENSIONS**

**CONDUIT FEED CANOPY MOUNTING OPTIONS**

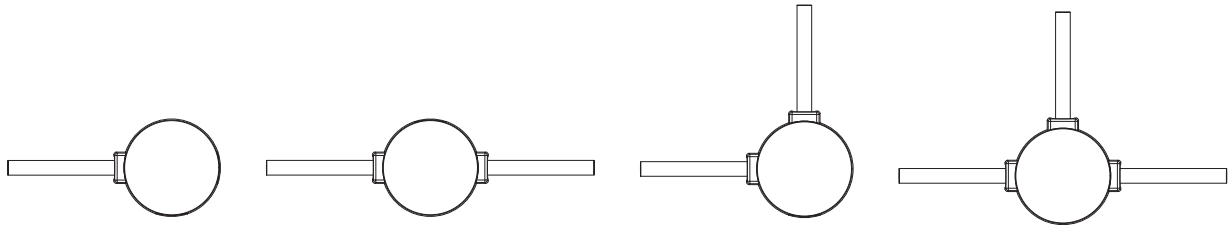

CONDUIT COVER  
3 PROVIDED WITH EACH  
CONDUIT FEED CANOPY

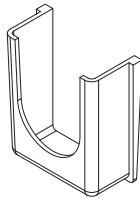

BLANK  
2 PROVIDED WITH EACH  
CONDUIT FEED CANOPY

