

## 3.3" MICRO MADISON CYLINDER

SURFACE MOUNT



### COMPONENTS

#### STANDARD CANOPY

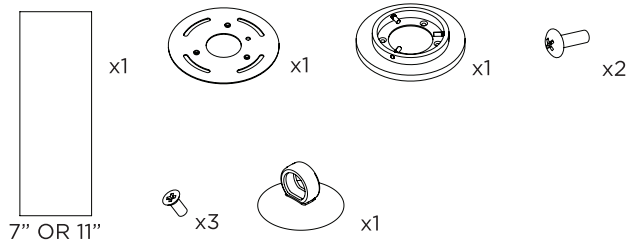

#### CONDUIT FEED CANOPY

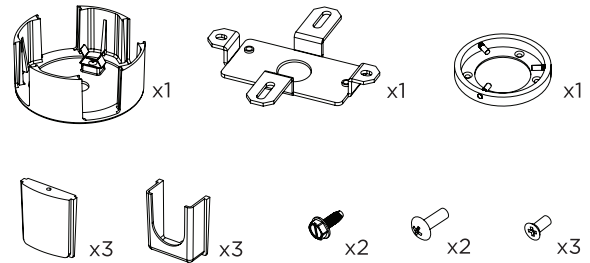

#### SEAMLESS CANOPY (FOR NEW CONSTRUCTION ONLY)

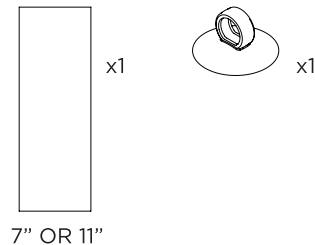
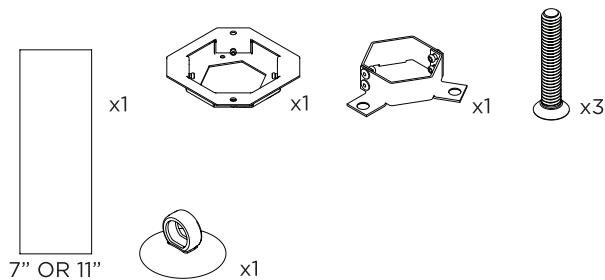

#### 4" OCTAGONAL J-BOX REQUIRED FOR INSTALLATION

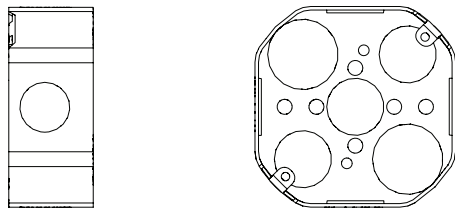

JUNCTION BOX (BY OTHERS)

#### INSTRUCTION KEY

#### INFORMATION

- ⚠ ADDITIONAL
- ⓘ ATTENTION
- ⚡ POWER ON
- ⏻ POWER OFF

INSTALLATION SHOULD ONLY BE PERFORMED BY A CERTIFIED ELECTRICIAN  
REFER TO LOCAL/NATIONAL CODES FOR PROPER INSTALLATION  
FAILURE TO FOLLOW INSTALLATION INSTRUCTION MAY VOID THE WARRANTY  
DO NOT TOUCH LEDS. LEDS MUST BE PROTECTED FROM MECHANICAL STRESS OR DEBRIS  
TURN OFF POWER DURING INSTALLATION OR SERVICING

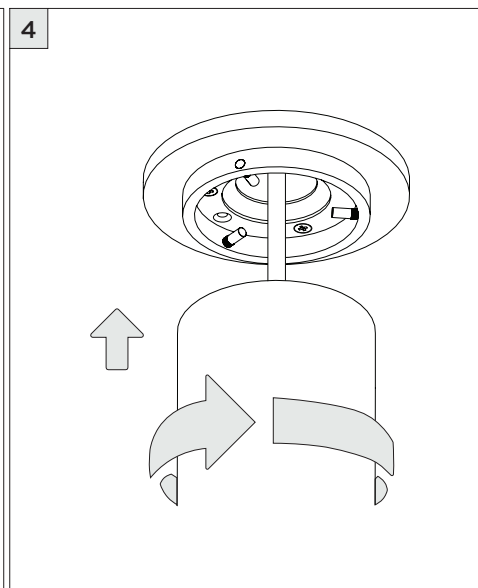
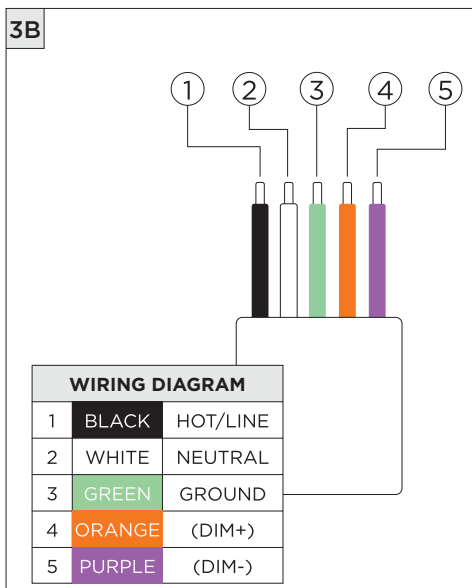
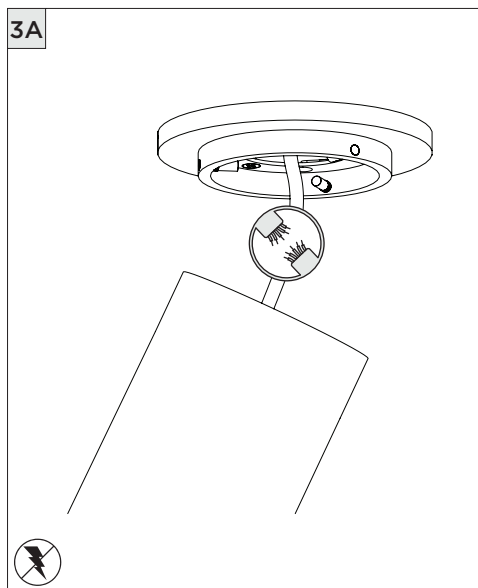
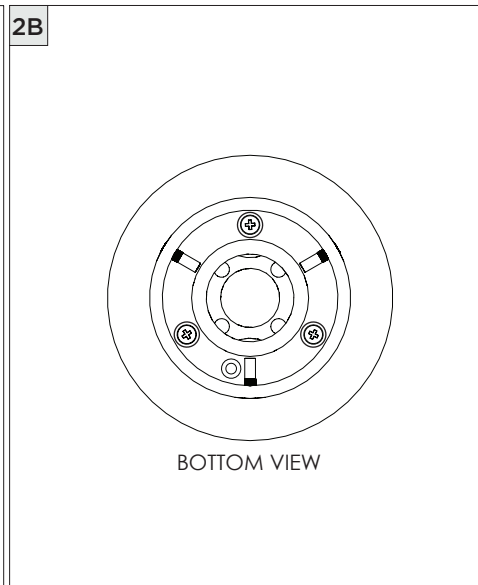
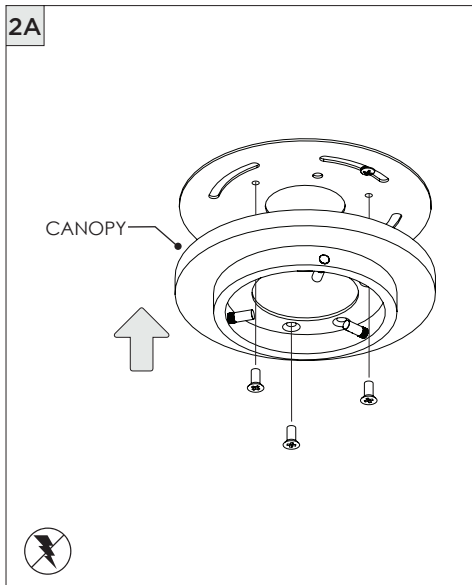
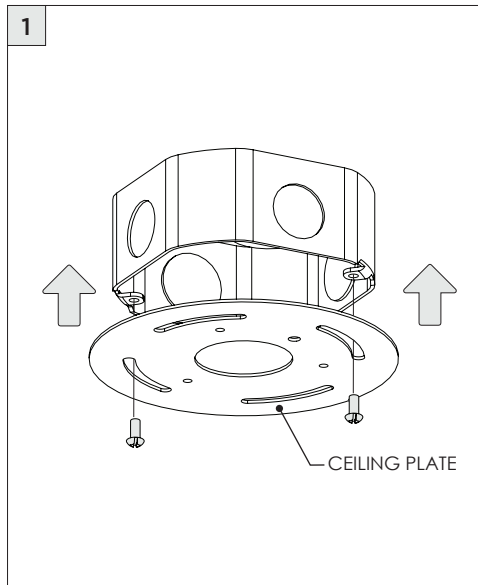

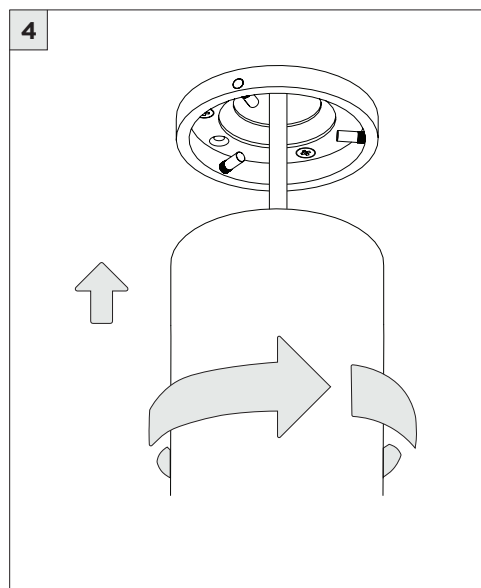
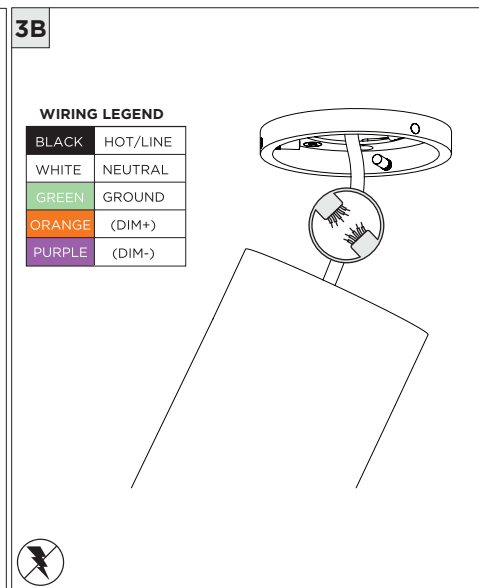
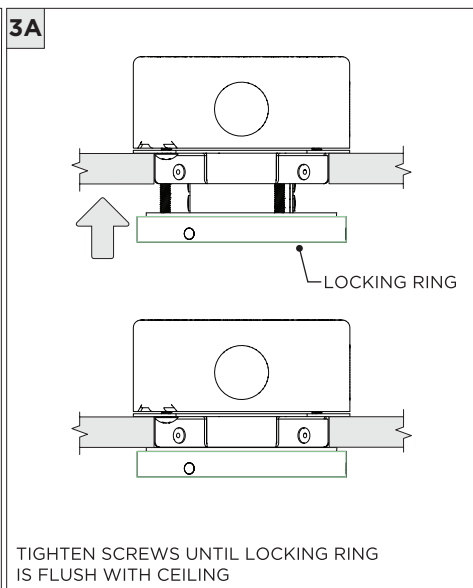
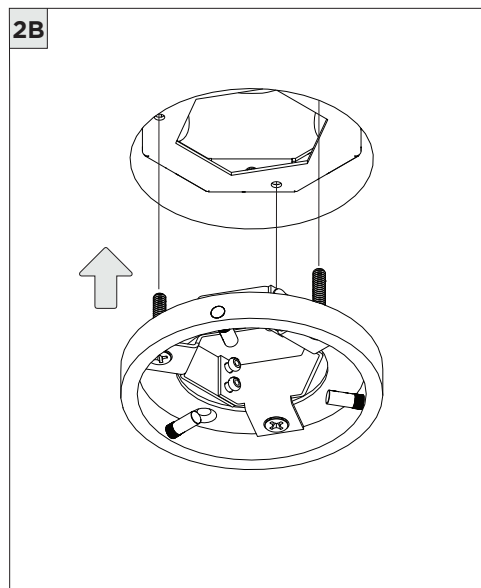
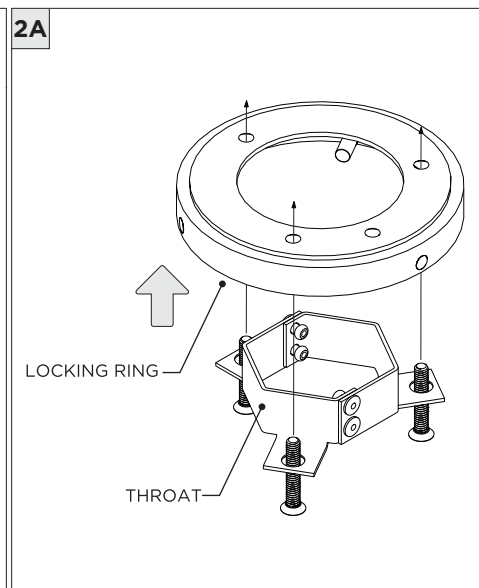
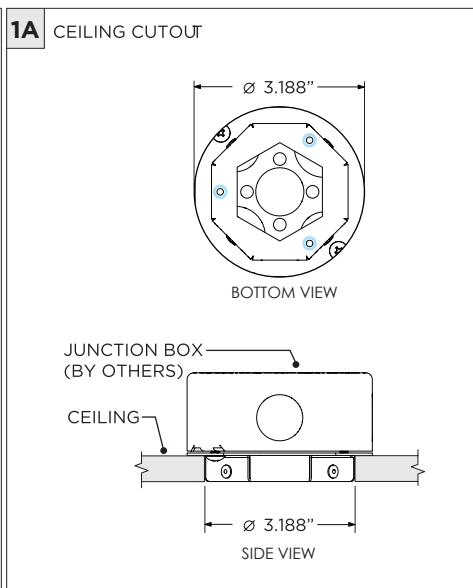
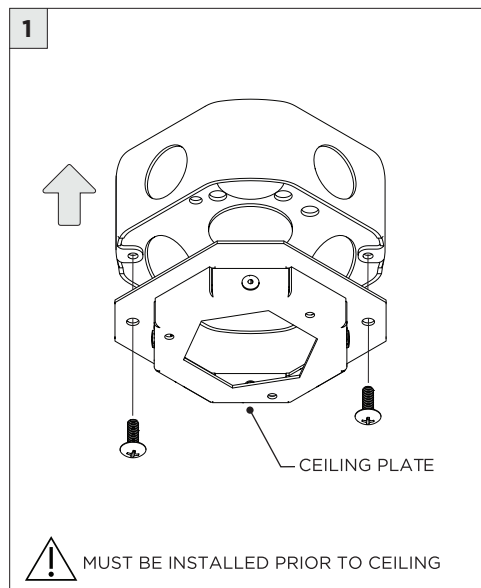

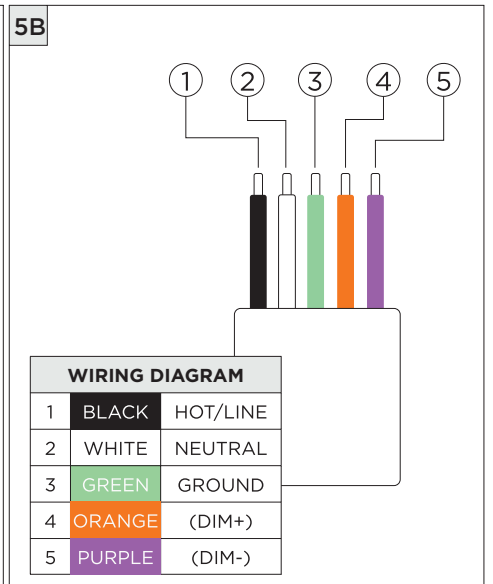
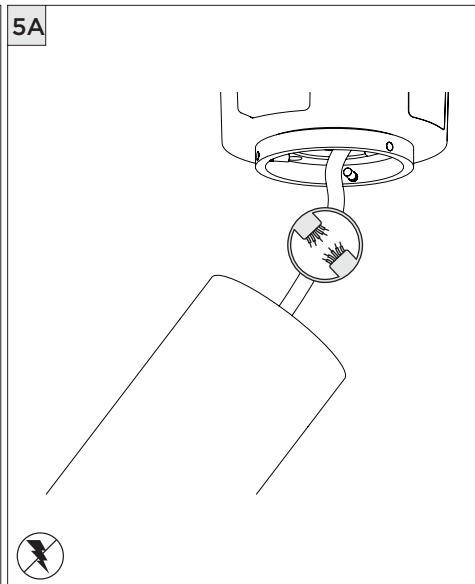
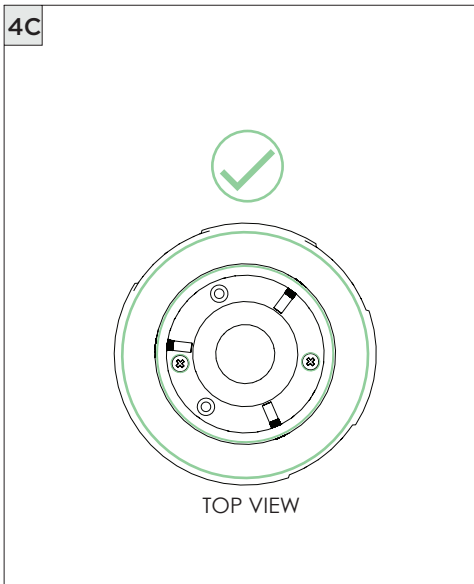
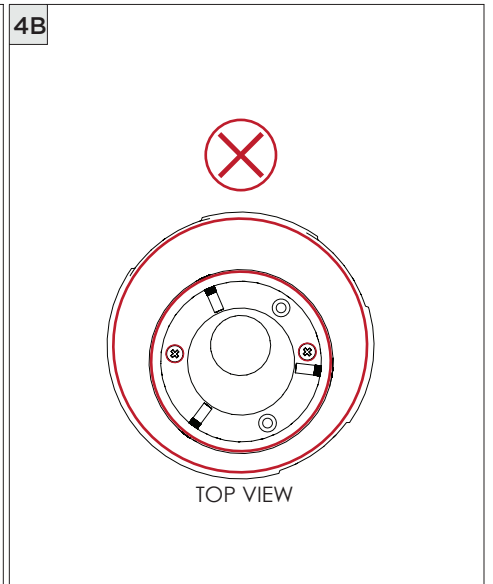
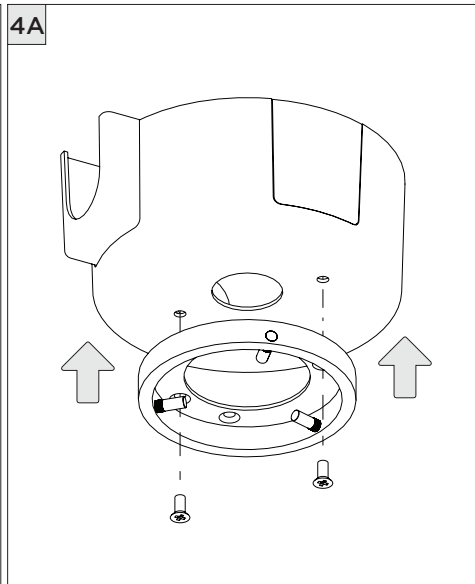
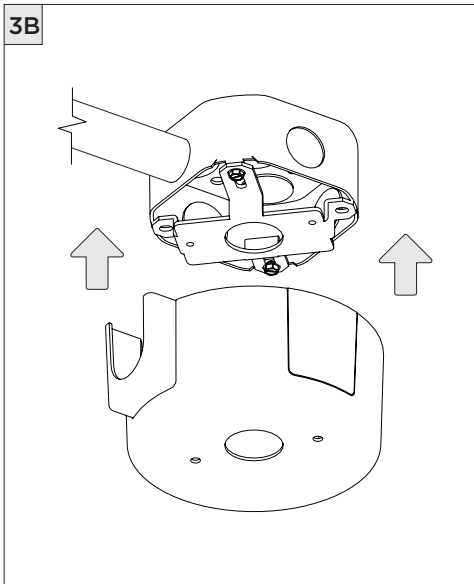
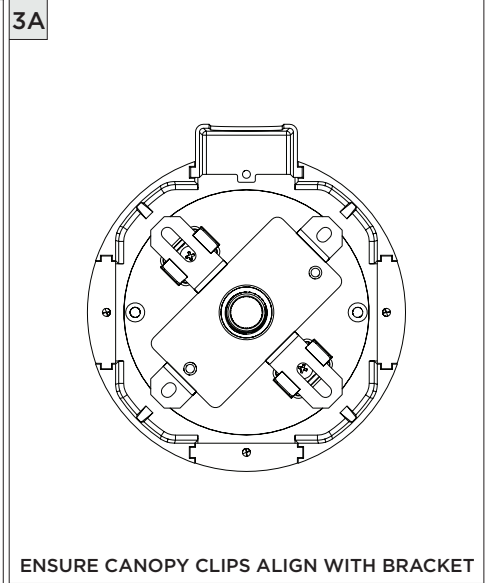
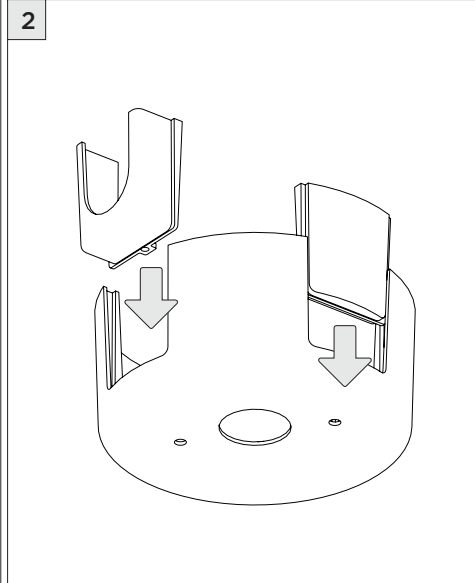
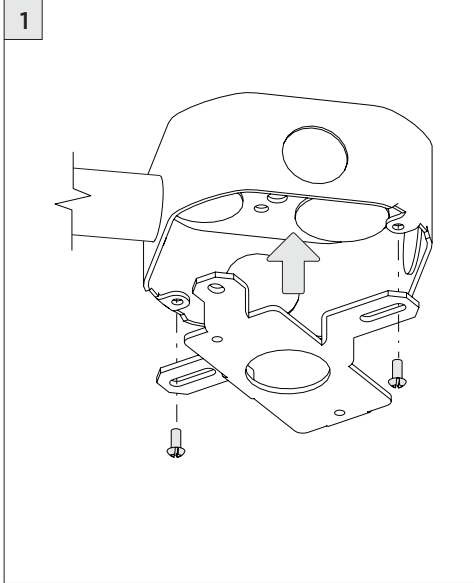

6

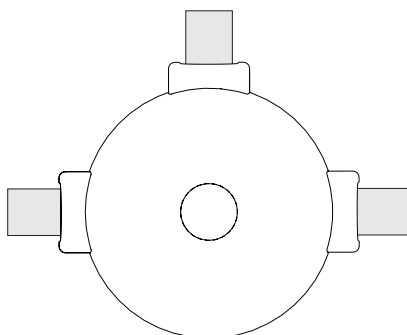
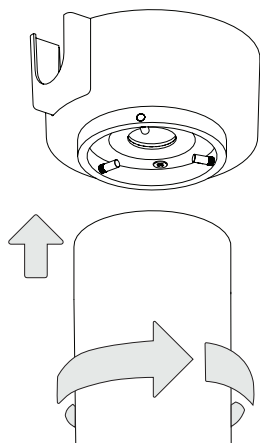

CANOPY IS SUITABLE FOR  
MAXIMUM 3 CONDUIT FEEDS

### DRIVER SERVICING

1

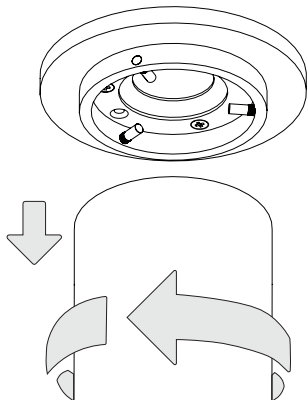

2

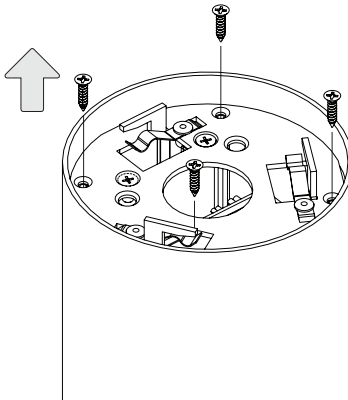

3

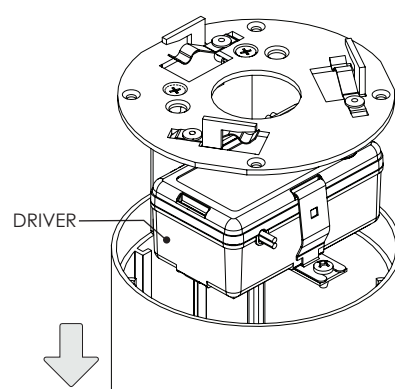

### LED SERVICING

1

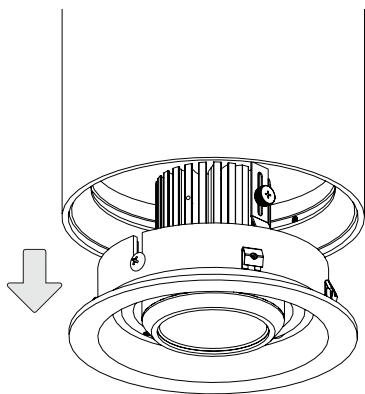

2

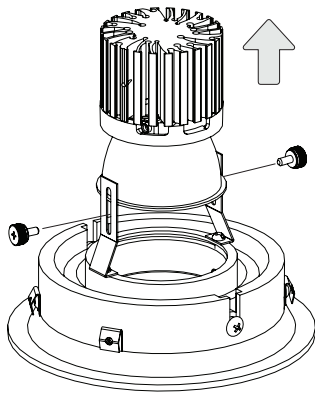

3

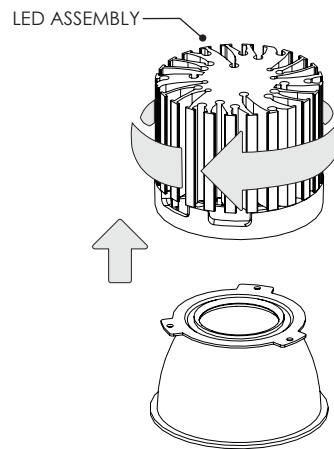

**DRIVER SERVICING**

1

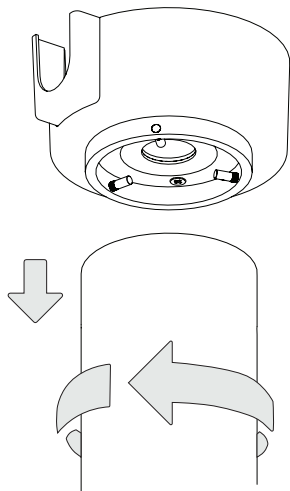

2

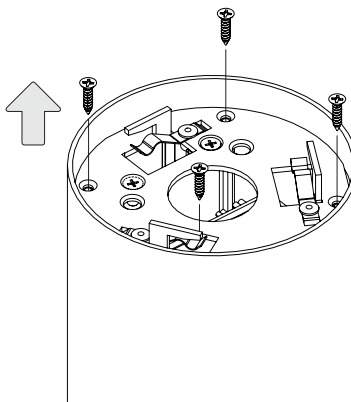

3

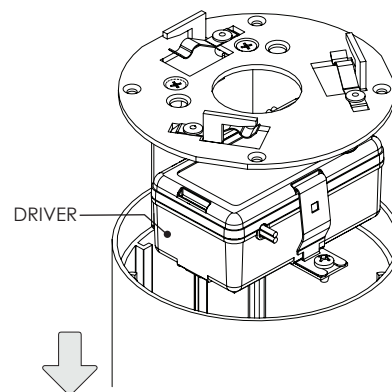

**LED SERVICING**

1

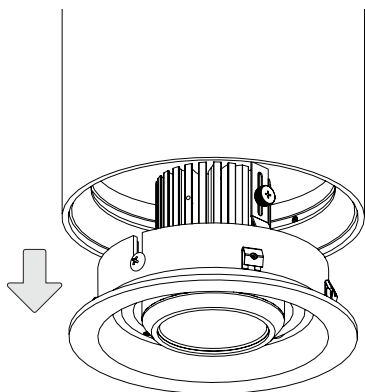

2

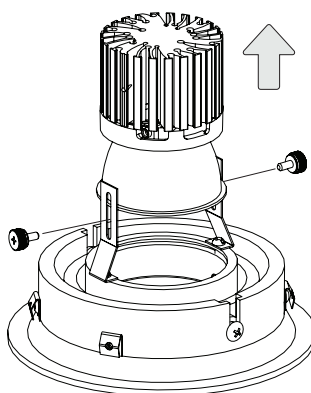

3

