

3G LIGHTING

3G-SDZ33R

3.3" ZOIE CYLINDER
3", 7" AND 11" HEIGHT

3.3" diameter Surface Mounted Zoie Cylinder
Companion to 3G-DZ33R Round Zoie Downlight
Regressed LED source provides maximum visual comfort, UGR <10
High gloss black or white louvers with proprietary optics and no glare
Extruded aluminum housing with powder coated finish
Lumen range from 1000lm to 2000lm (80+ and 90+ CRI options)
100-1% dimming range standard with integral driver options

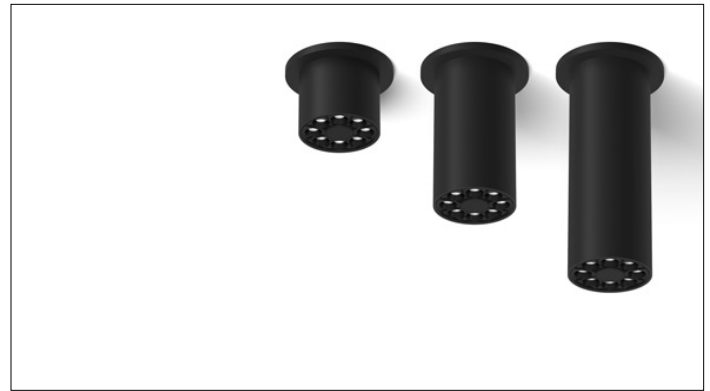

PROJECT:		TYPE:		
CATALOG#:		DATE:	QTY:	
CAT. NO	FIXTURE HEIGHT	LUMEN OUTPUT	CRI	COLOR TEMP
3G-SDZ33R	3H - 3" HEIGHT *	10 - 1000 LUMENS	S80 - 80+ CRI	27K - 2700K ¹
	7H - 7" HEIGHT *	15 - 1500 LUMENS	H90 - 90+ CRI	30K - 3000K
	11H - 11" HEIGHT	17 - 1750 LUMENS		35K - 3500K
		20 - 2000 LUMENS		40K - 4000K ¹
*3H & 7H up to 1750lm (80+CRI) *3H & 7H up to 1500lm (90+CRI) *3H & 7H available with remote driver only (RDIM)		Lumen outputs are delivered lumens based on 80+ CRI, 3000K source. See performance chart for all options		
BEAM ANGLE	VOLTAGE	DRIVER	HOUSING FINISH	LOUVER FINISH
20D - 20°	UNV - 120/277V	DIM - 0-10V (100-1%)	BK - BLACK TRIM	BLV - BLACK
40D - 40°	347 - 347V ²	D01 - 0-10V (100-0.1%)	WH - WHITE TRIM	WLV - WHITE
60D - 60°		DALI - DALI (100-1%) ³	SV - SILVER TRIM	
		DHL2 - LUTRON HI-LUME (1% ECOSYSTEM)		
		DMX - DMX (100-0%)		
		RDIM - REMOTE 0-10V (100-1%)		
OPTIONS				
CFB - BLACK CONDUIT FEED CANOPY				
CFW - WHITE CONDUIT FEED CANOPY				
CFS - SILVER CONDUIT FEED CANOPY				
FXC - SEAMLESS CANOPY OPTION *				
EMR - EMERGENCY BATTERY (REMOTE) ⁴				
*Seamless canopy mount (FXC) must be installed prior to ceiling installation.				

- ¹ 2700K only available in 90CRI and 4000K only available in 80CRI
² 347 available in "DIM" 0-10V only (100-1%). Not available with 3" height and 7" height
³ DALI-2 (Type 6) provided as standard. Consult factory for DALI Type 8 option
⁴ Emergency battery installed remotely by others. Not accessible through the inside of the fixture

PERFORMANCE

LUMEN OUTPUT	DELIVERED LUMENS	SYSTEM WATTS	EFFICACY (LPW)
1000	1000	8.4	122.4
1500	1500	13.2	117.4
1750	1750	15.4	116.8
2000	2000	18.4	111.7

BASED ON 80+ CRI, 3000K WITH 20D OPTIC
Lumen output and actual wattage may vary +/- 5%

MULTIPLIERS

COLOR TEMP	80+ CRI
2700K	N/A
3000K	1.00
3500K	0.97
4000K	1.16

COLOR TEMP	90+ CRI
2700K	0.77
3000K	0.86
3500K	0.86
4000K	N/A

BEAM ANGLE	
20D	1.00
40D	0.97
60D	0.94

HOUSING

Extruded aluminum housing with powder coated finish
Twist and lock construction with no visible hardware

OPTICS

3.3" aperture with regressed LED source for maximum visual comfort
High gloss black or white louvers with proprietary optics and no glare
Polycarbonate multi-faceted reflectors
Available in 20°, 40° and 60°
UGR <10

LISTING

ETL listed and conforms to UL1598 standard. Certified to CSA22.2 No.250.0. Rated for indoor locations

WARRANTY

5 Year Warranty on LED and drivers
Manufacturer 1 Year Warranty for defects in material and workmanship under normal use
Ambient temperature at fixture should not exceed 25°C

MOUNTING

All hardware included for mounting to 4" octagonal junction box
Twist and lock mechanism
Seamless canopy option designed to mount to 4" octagonal junction box for new construction only
Conduit feed cut-out canopy option designed to mount to 4" octagonal junction box

ELECTRICAL

Standard 0-10V, constant current drivers with 100-1% dimming range and >0.9 power factor
Standard 120/277V universal voltage with several driver options
11" model available with integral drivers that are easily accessible through luminaire aperture
3" & 7" models available with remote, 0-10V driver within enclosure.
Maximum remote mounting distance of 100ft (12AWG) or 50ft (14AWG)

EMERGENCY

Remote emergency battery installed by others (not accessible through fixture aperture)
7W output for 90 minutes (+/- 700lm at 80+ CRI)
CA Title 24 Certified
Maximum remote mounting distance:
50ft (12AWG) or 25ft (14AWG) for fixtures operating at 3000lm or below
30ft (12AWG) or 20ft (14AWG) for fixtures operating above 3000lm
Caution: Emergency Battery utilizes more than one power source and servicing should be performed by qualified personnel

LED SYSTEM

Osram LED source
Color consistency <2 SDCM
80+ and 90+ CRI
Available in 27K, 30K, 35K, and 40K
L90 >60,000 hours
5 year warranty

RECESSED 4" OCTAGONAL JUNCTION BOX BY OTHERS
STANDARD CANOPY MOUNT

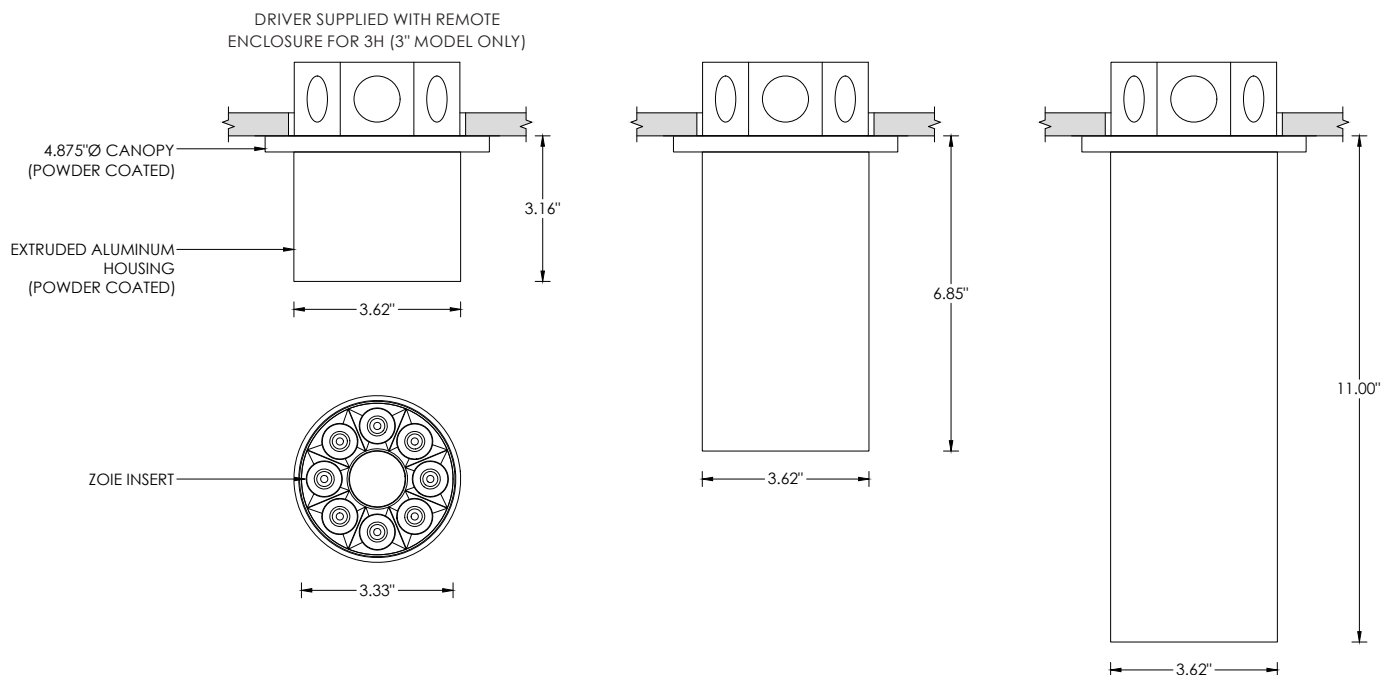

RECESSED 4" OCTAGONAL JUNCTION BOX BY OTHERS
SEAMLESS CANOPY MOUNT (FXC OPTION) FOR NEW CONSTRUCTION ONLY

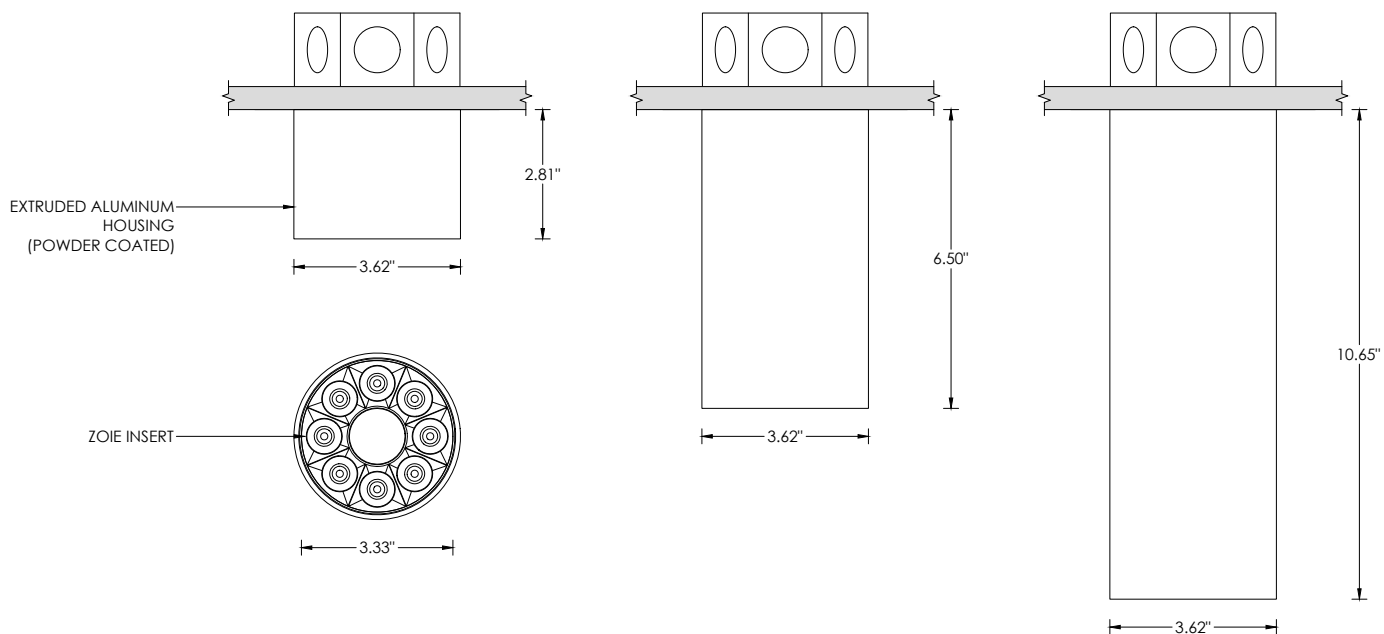

SURFACE 4" OCTAGONAL X 1.5" DEEP JUNCTION BOX BY OTHERS
CONDUIT FEED CANOPY MOUNT (CFX OPTION)

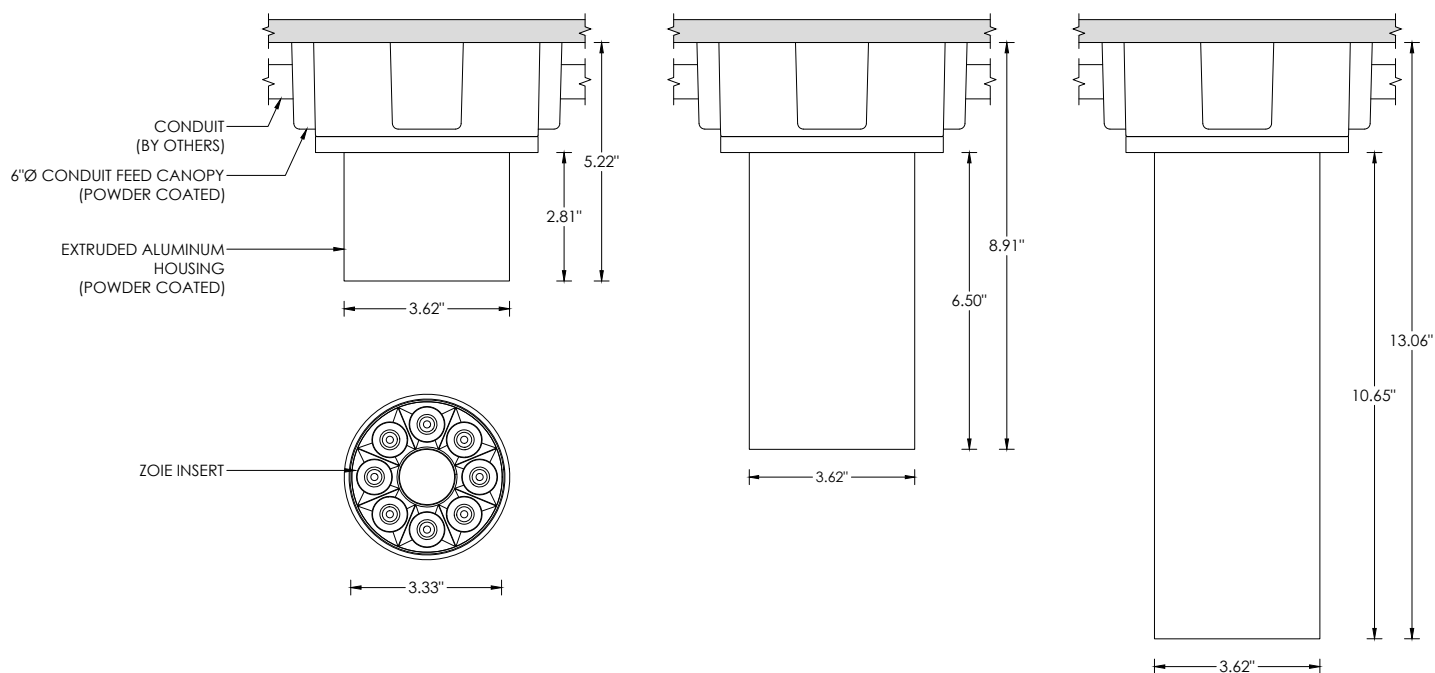

CONDUIT FEED CANOPY MOUNTING OPTIONS

