

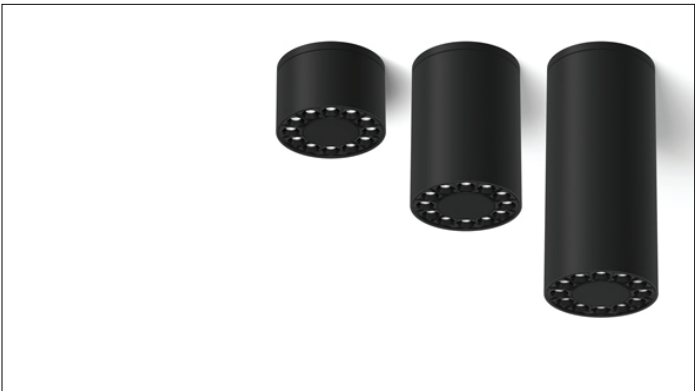

4.5" ZOIE  
CYLINDER  
SURFACE MOUNT



THE IMAGES SHOWN ARE FOR ILLUSTRATION ONLY AND MAY NOT BE AN EXACT REPRESENTATION OF THE PRODUCT

COMPONENTS

STANDARD CANOPY

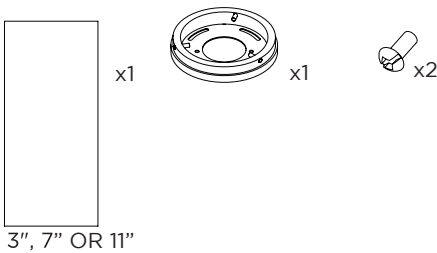

CONDUIT FEED CANOPY

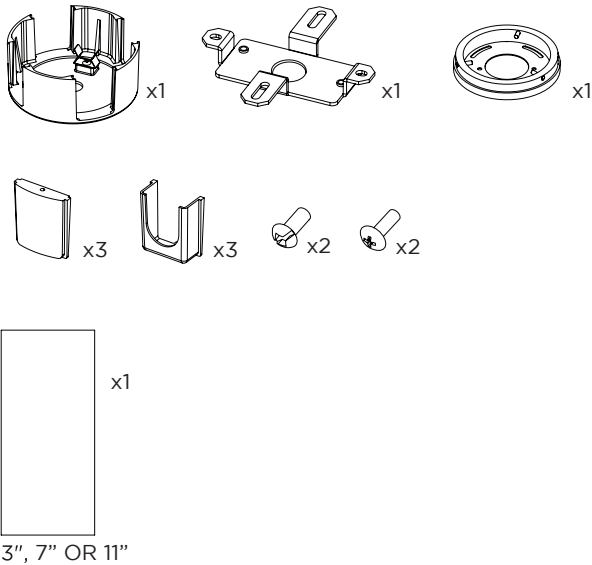

4" OCTAGONAL J-BOX REQUIRED FOR INSTALLATION

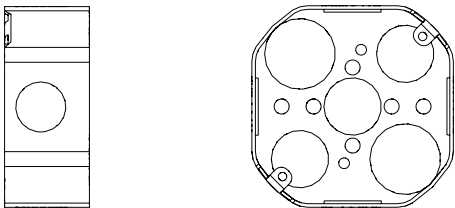

JUNCTION BOX (BY OTHERS)

INSTRUCTION KEY	INFORMATION
ADDITIONAL	INSTALLATION SHOULD ONLY BE PERFORMED BY A CERTIFIED ELECTRICIAN
ATTENTION	REFER TO LOCAL/NATIONAL CODES FOR PROPER INSTALLATION
POWER ON	FAILURE TO FOLLOW INSTALLATION INSTRUCTION MAY VOID THE WARRANTY
POWER OFF	DO NOT TOUCH LEDS. LEDS MUST BE PROTECTED FROM MECHANICAL STRESS OR DEBRIS
	TURN OFF POWER DURING INSTALLATION OR SERVICING

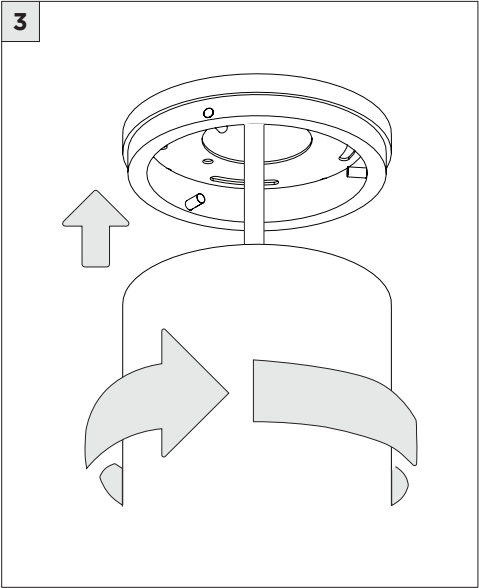
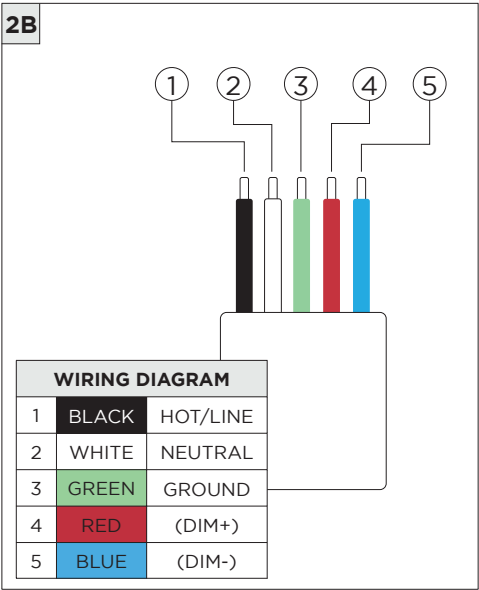
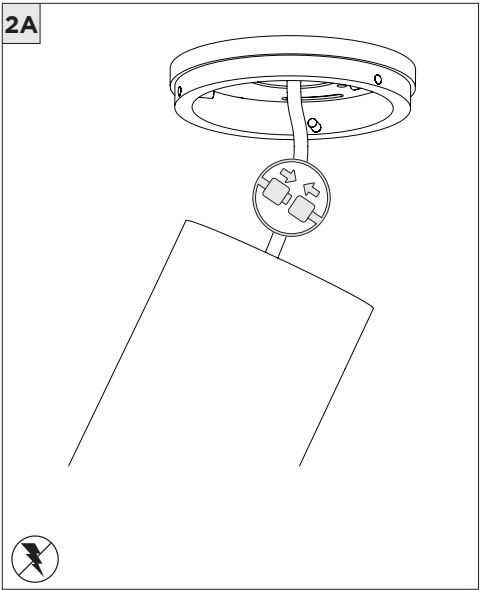
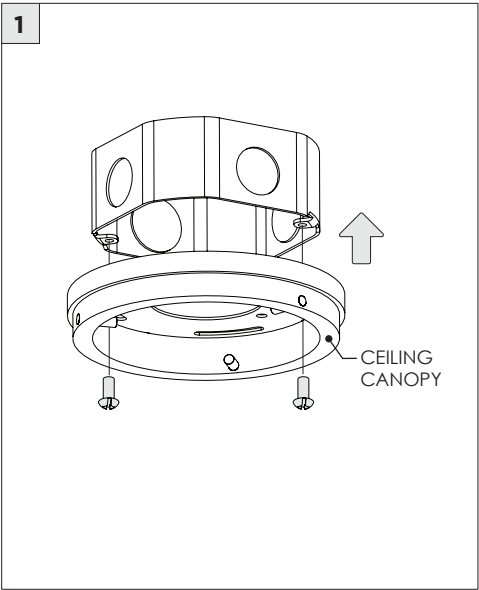

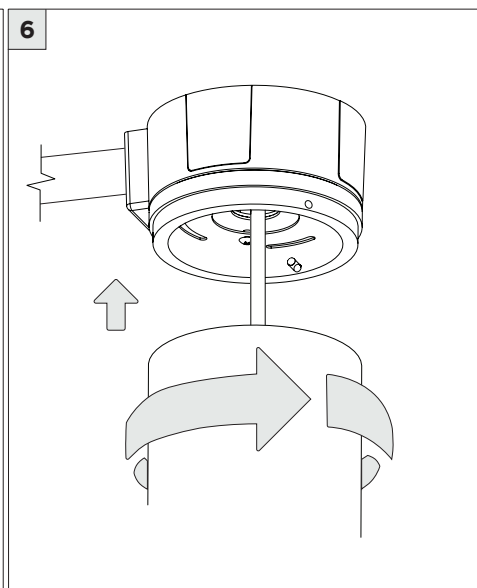
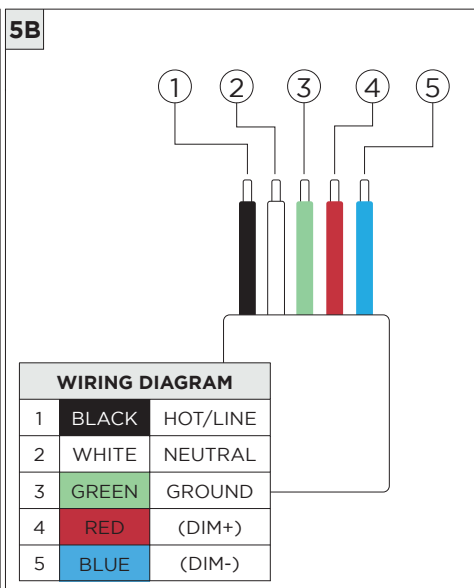
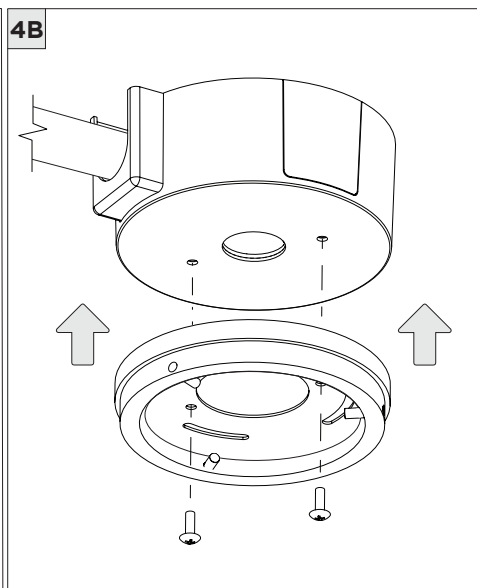
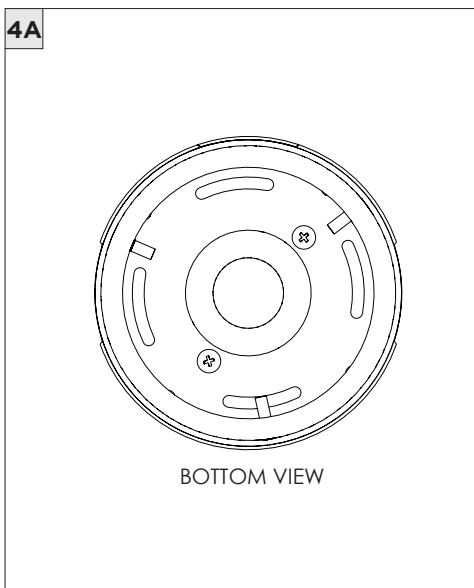
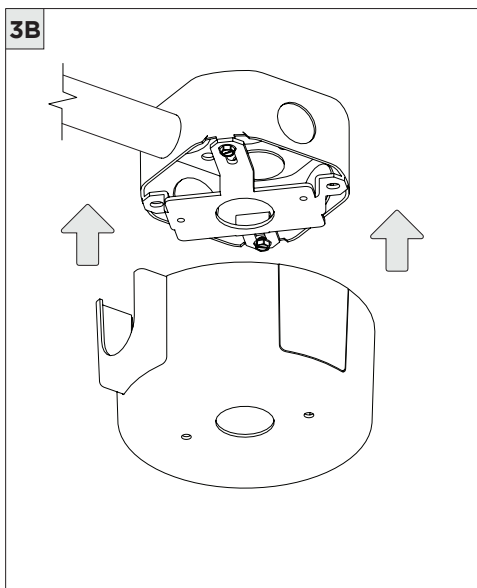
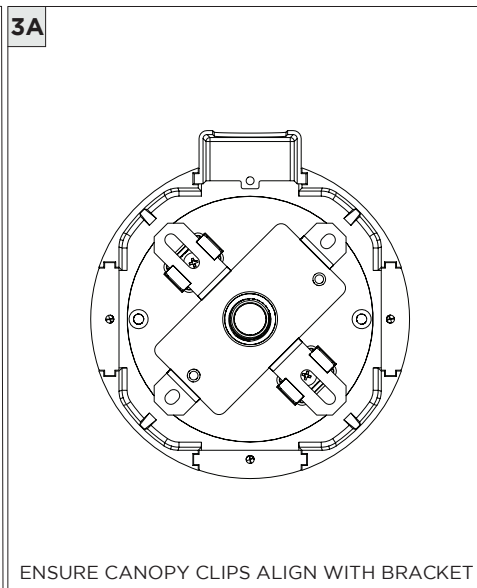
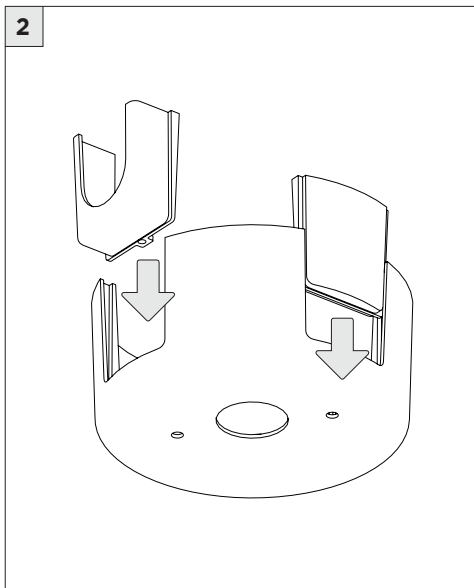
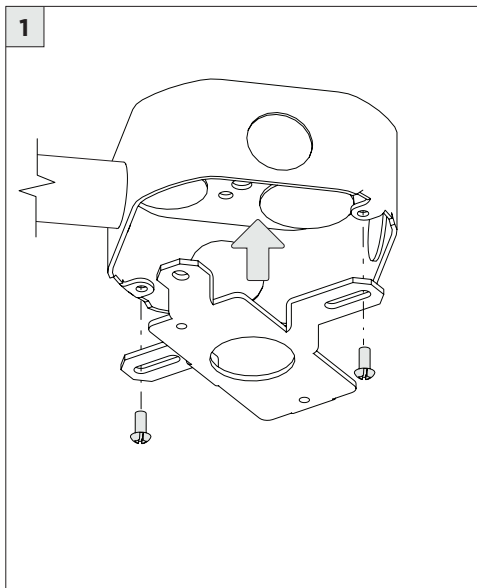

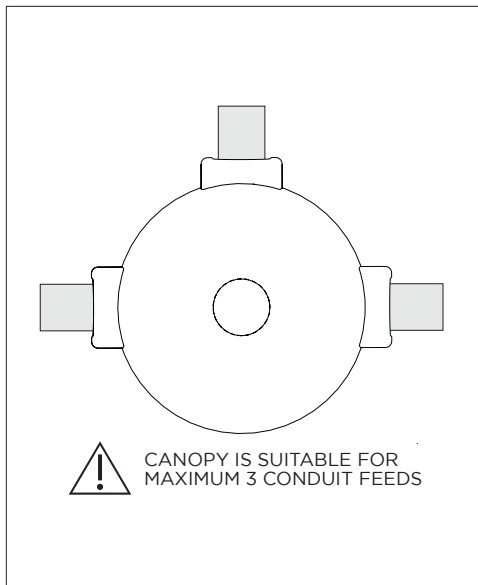

### DRIVER SERVICING

1

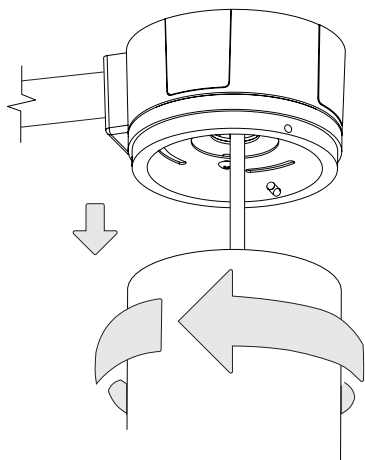

2

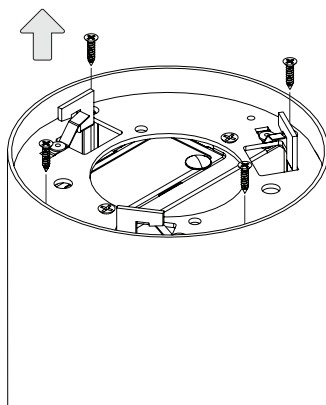

3

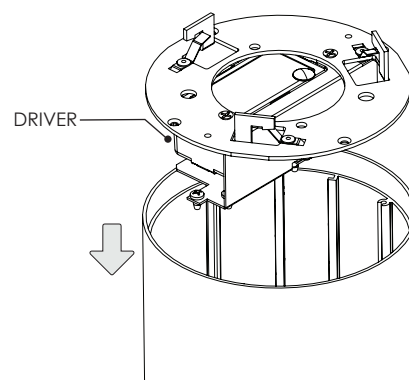

### LED SERVICING

1

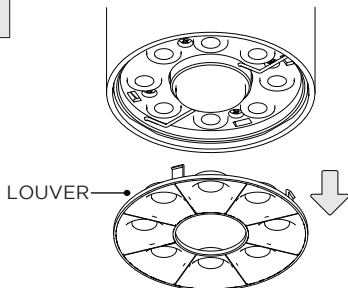

UNCLIP LOUVER FROM LED ASSEMBLY

2

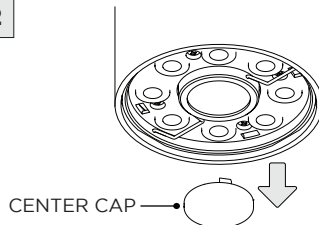

UNCLIP CENTER CAP FROM LED ASSEMBLY

3

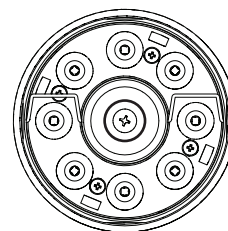

LOCATE CENTER SCREW

4

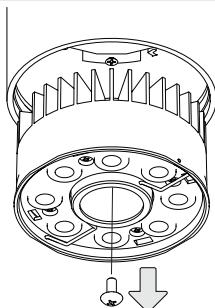

UNSCREW CENTER SCREW TO REMOVE LED ASSEMBLY

5

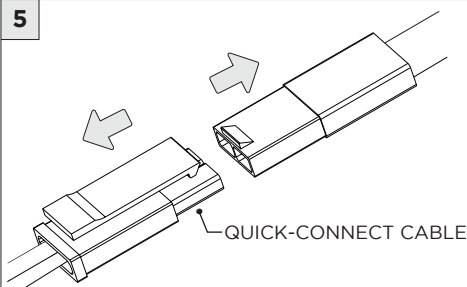

DISCONNECT QUICK-CONNECT CABLE FROM LED ASSEMBLY

6

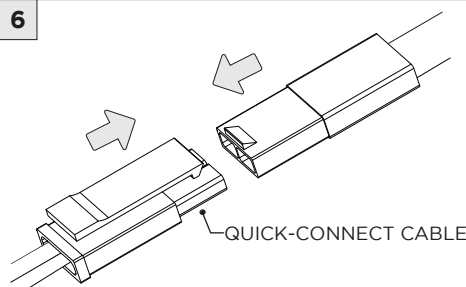

CONNECT QUICK-CONNECT CABLE TO NEW LED ASSEMBLY

7

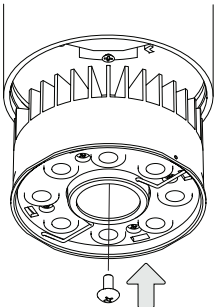

SCREW NEW LED ASSEMBLY INTO CYLINDER

8

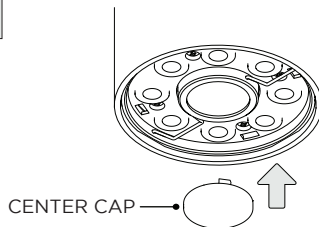

CENTER CAP

9

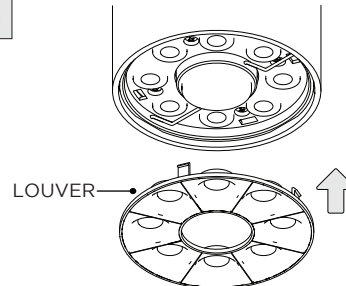

LOUVER