

4.5" WALLWASH CYLINDER - PENDANT

STEM PENDANT MOUNT



COMPONENTS

STANDARD CANOPY

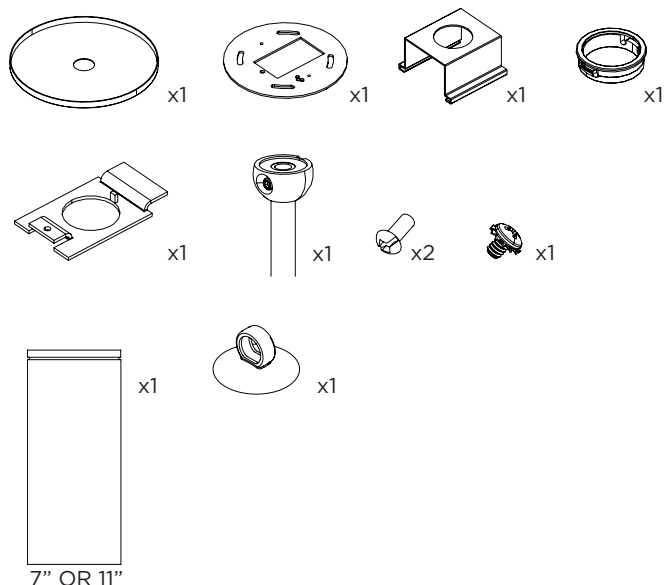

CONDUIT FEED CANOPY

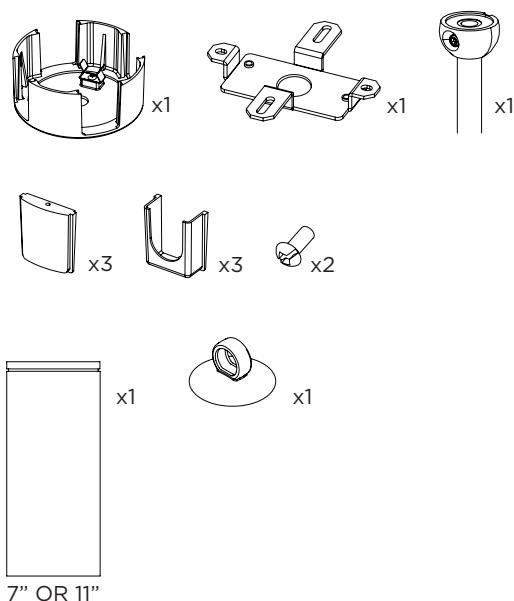

4" OCTAGONAL J-BOX REQUIRED FOR INSTALLATION

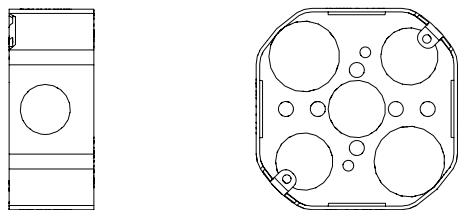

JUNCTION BOX (BY OTHERS)

SUITABLE FOR SLOPED CEILING

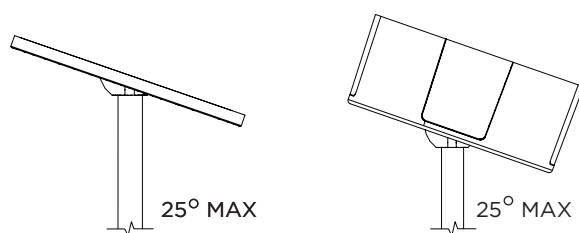

INSTRUCTION KEY	INFORMATION
⚠️ ADDITIONAL	INSTALLATION SHOULD ONLY BE PERFORMED BY A CERTIFIED ELECTRICIAN
ⓘ ATTENTION	REFER TO LOCAL/NATIONAL CODES FOR PROPER INSTALLATION
⚡ POWER ON	FAILURE TO FOLLOW INSTALLATION INSTRUCTION MAY VOID THE WARRANTY
⏻ POWER OFF	DO NOT TOUCH LEDS. LEDS MUST BE PROTECTED FROM MECHANICAL STRESS OR DEBRIS
	TURN OFF POWER DURING INSTALLATION OR SERVICING

1A

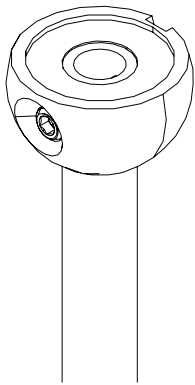

CUT STEM LENGTH
IF APPLICABLE

1B

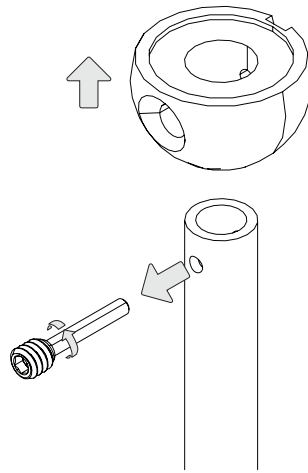

1C

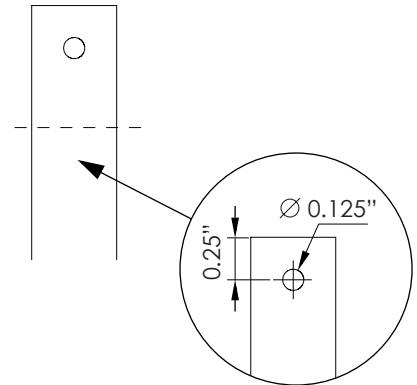

2

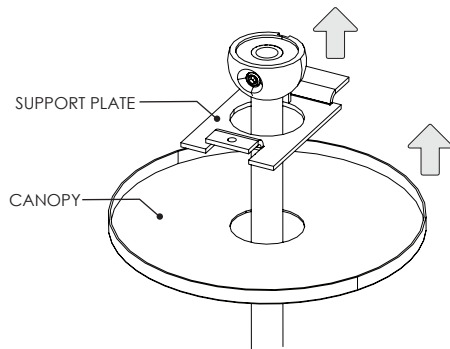

3

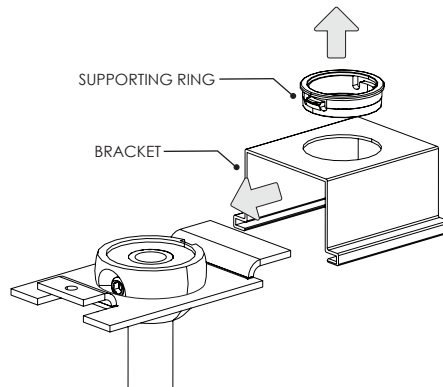

4A

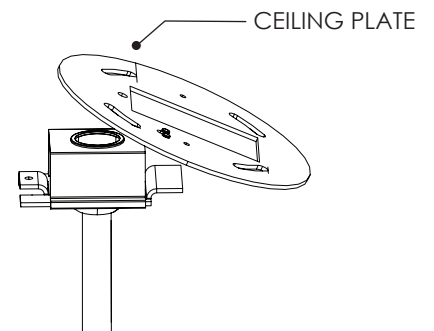

4B

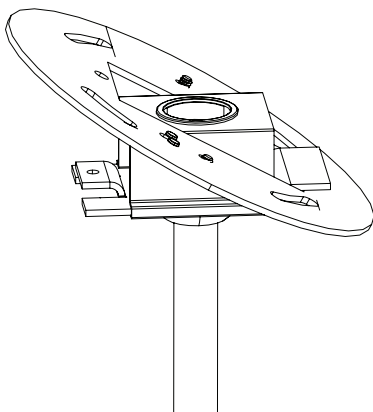

4C

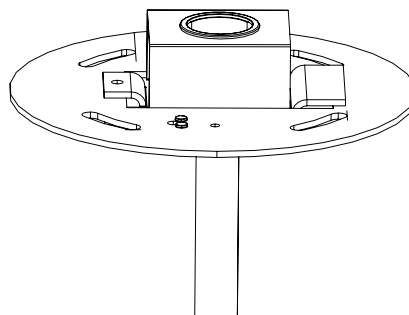

5

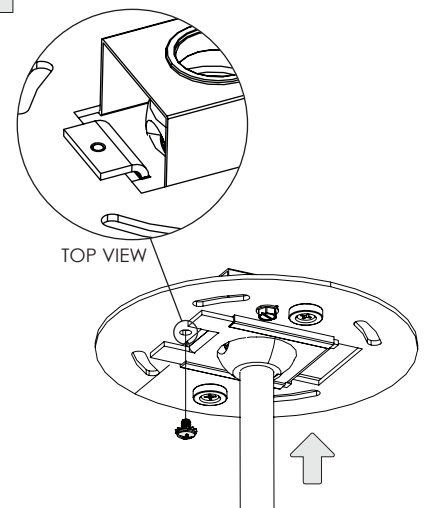

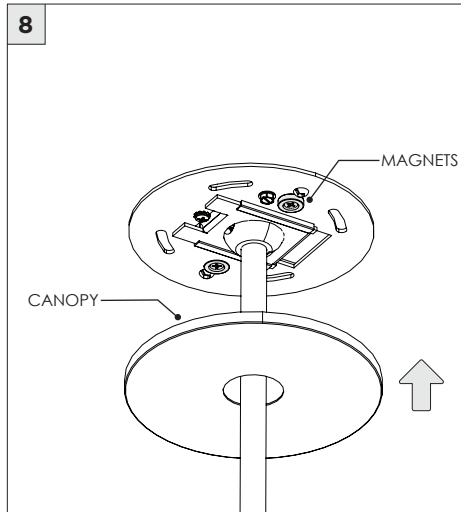
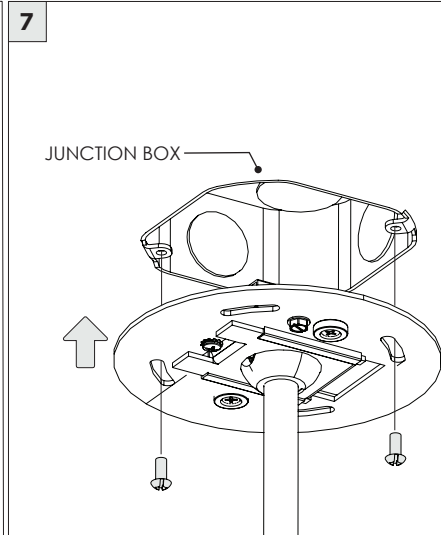
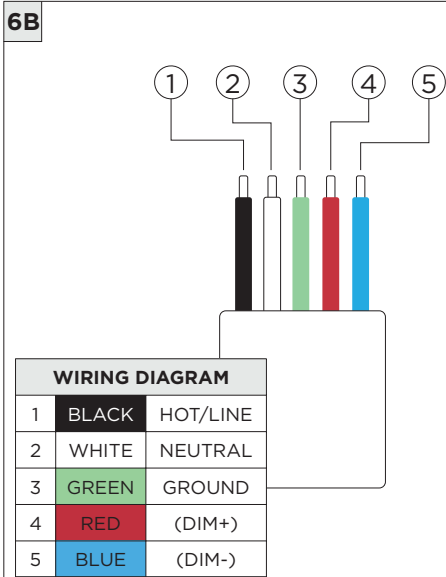
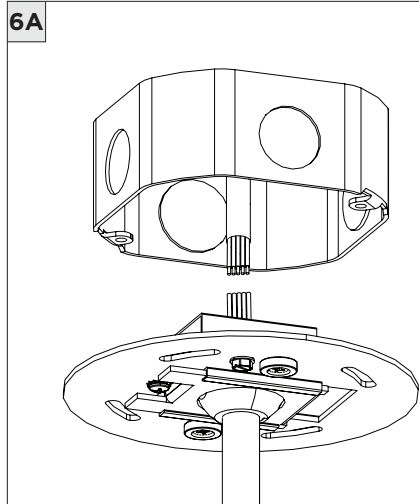

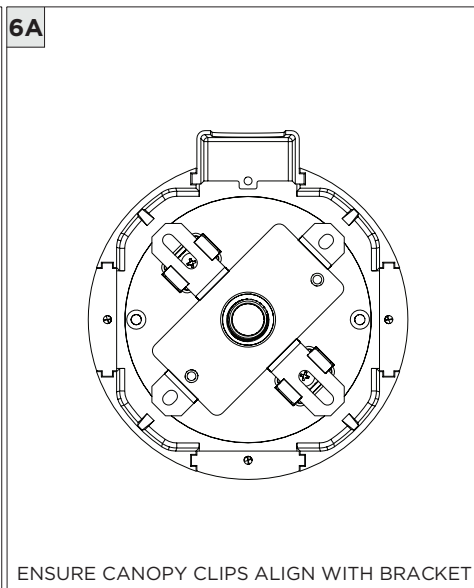
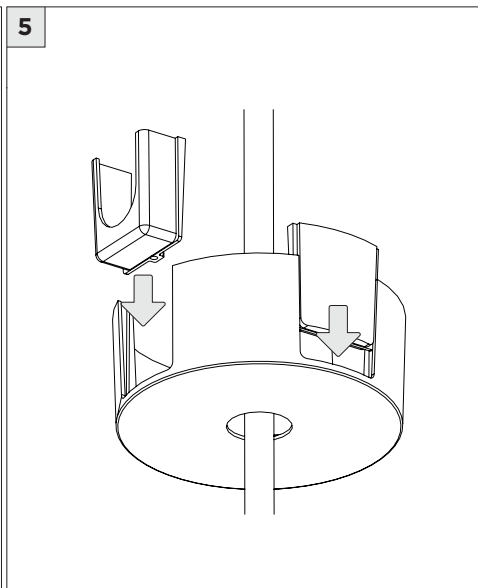
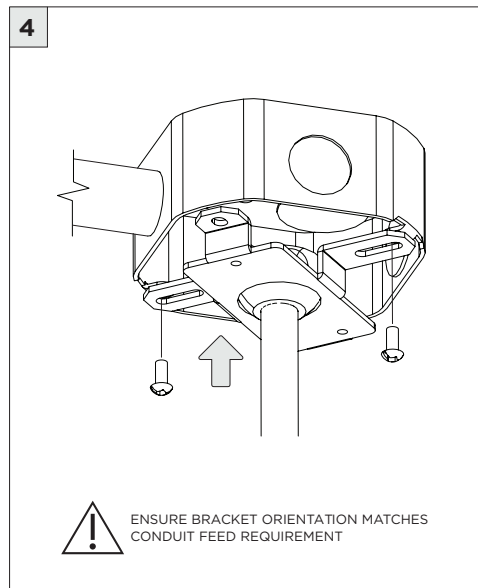
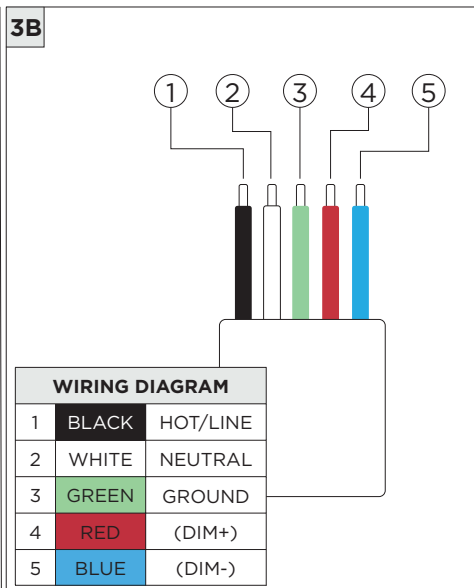
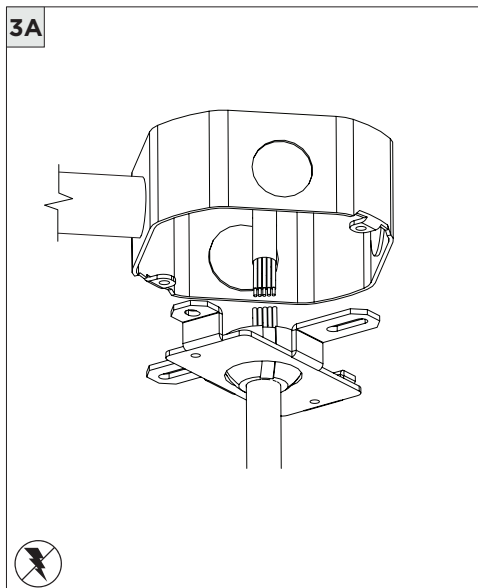
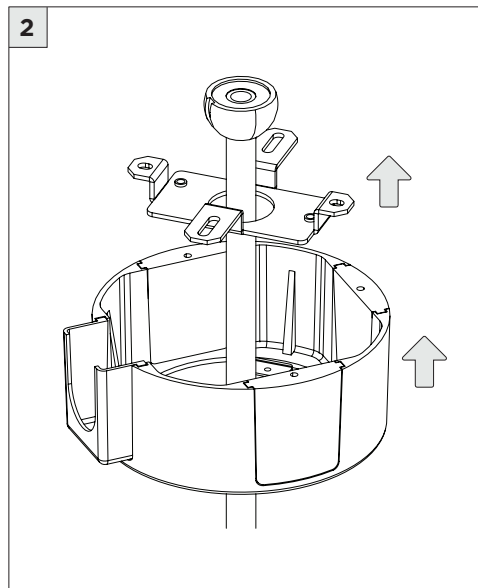
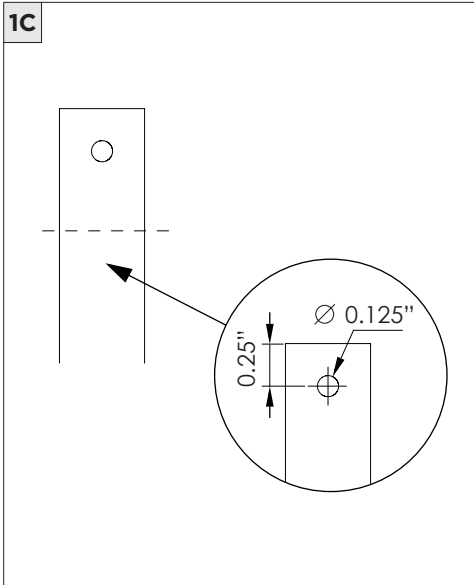
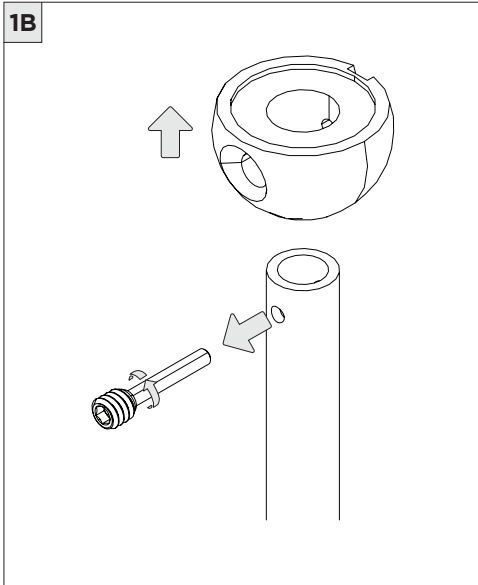
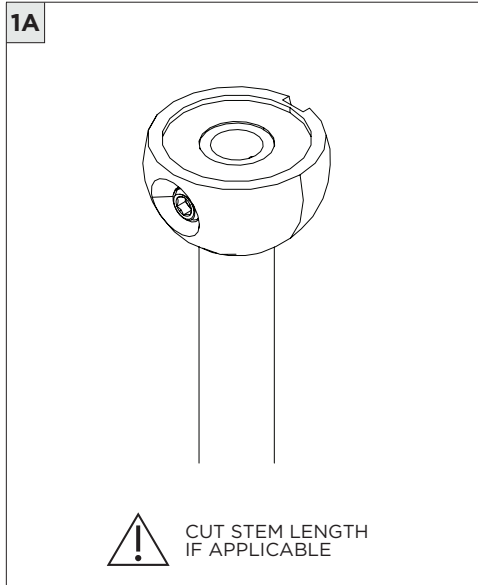

6B

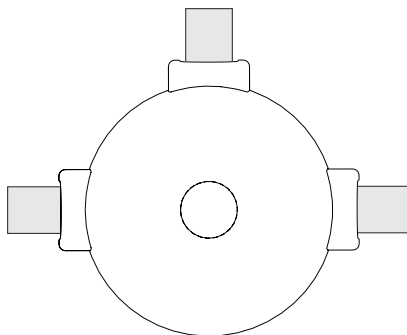
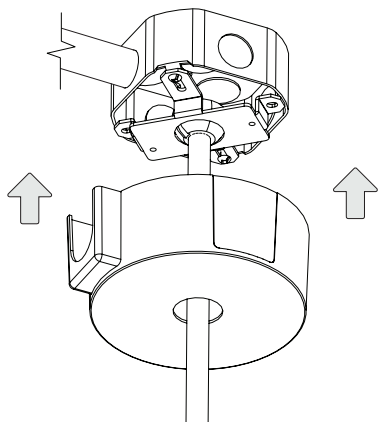

CANOPY IS SUITABLE FOR
MAXIMUM 3 CONDUIT FEEDS

DRIVER SERVICING

1

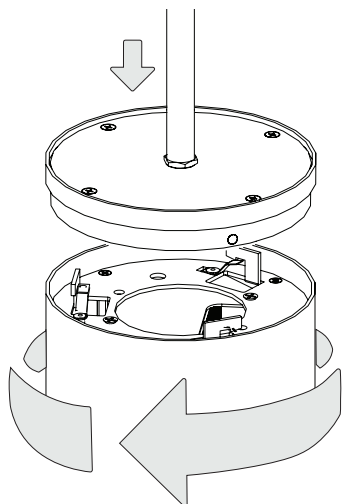

2

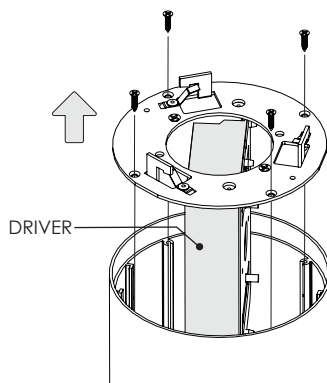

LED SERVICING

1

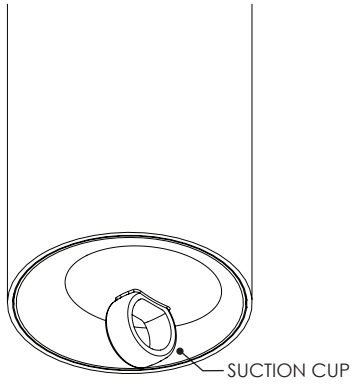

2

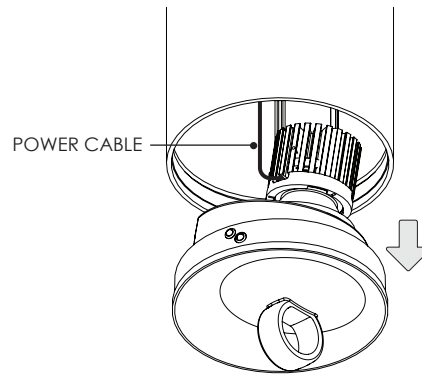

ENSURE TO DISCONNECT POWER CABLE

3

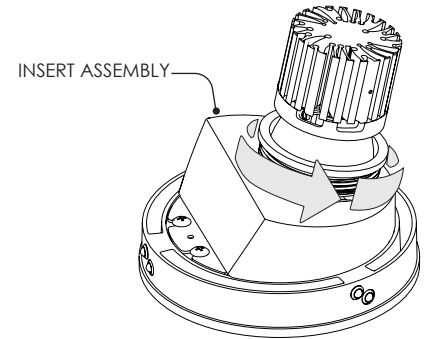

4 REPLACE LED ASSEMBLY

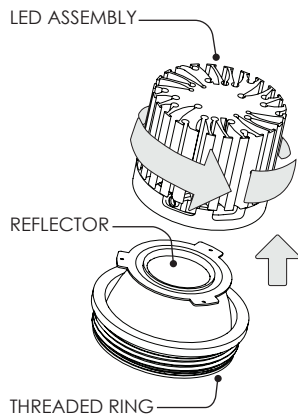

5

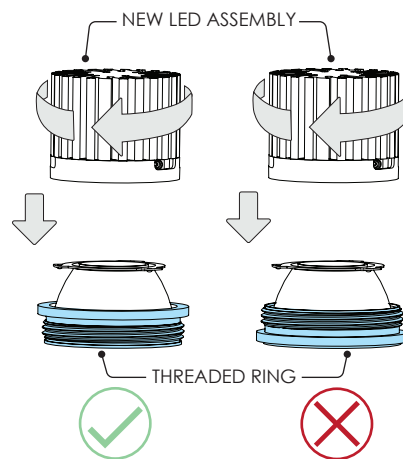

6

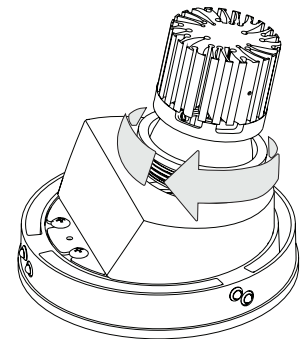

ENSURE THE HEAT SINK IS ALIGNED WITH INSERT ASSEMBLY AND FULLY TIGHTEN THE THREADED RING

7

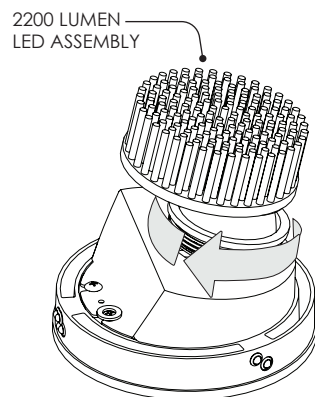

FOR 2200 LUMEN FIXTURES

7A

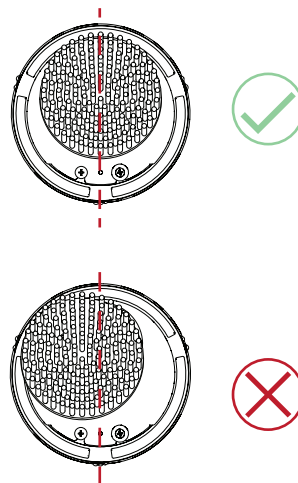

8

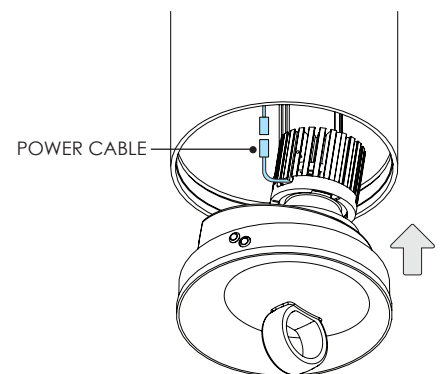

EXACT LED MODEL MAY VARY