



**3Gi-58RSL, 3Gi-48RSL**  
**5.8", and 4.8" INTEGRATED RECESSED SLOT**  
GRID CEILING



**⚠ FOR NEW CONSTRUCTION INSTALLATION ONLY**  
**ℹ THE IMAGES SHOWN ARE FOR ILLUSTRATION PURPOSES ONLY AND MAY NOT BE AN EXACT REPRESENTATION OF THE PRODUCT**

FIXTURE TYPES		INCLUDED COMPONENTS				
58RSL PROFILE	48RSL PROFILE					
ILLUMINATED OPTIONS		INTEGRATED MECHANICAL OPTIONS				
<b>DL33R - 3.3" ROUND DOWNLIGHT</b>	<b>DL33S - 3.3" SQUARE DOWNLIGHT</b>	<b>DZ33R - 3.3" ROUND ZOIE</b>	<b>DZ33S - 3.3" SQUARE ZOIE</b>	<b>CM - CAMERA</b>	<b>SP - SPEAKER</b>	<b>OS - OCCUPANCY SENSOR</b>
<b>M7 - MADISON DUAL AXIS</b>	<b>4LI - 3.5" LINIA</b>	<b>2LI - 2" LINIA</b>		<b>WF - WIFI ACCESS POINT</b>	<b>MC - MICROPHONE</b>	
				<b>HV - HVAC</b>	<b>SD - SMOKE DETECTOR</b>	<b>ST - FIRE STROBE</b>
					<b>FS - FIRE SPRINKLER</b>	<b>JB - JUNCTION BOX</b>

INSTRUCTION KEY	INFORMATION
<b>⚠</b> ADDITIONAL	INSTALLATION SHOULD ONLY BE PERFORMED BY A CERTIFIED ELECTRICIAN
<b>ℹ</b> ATTENTION	REFER TO LOCAL/NATIONAL CODES FOR PROPER INSTALLATION
<b>⚡</b> POWER ON	FAILURE TO FOLLOW INSTALLATION INSTRUCTION MAY VOID THE WARRANTY
<b>⏻</b> POWER OFF	DO NOT TOUCH LEDS. LEDS MUST BE PROTECTED FROM MECHANICAL STRESS OR DEBRIS
	TURN OFF POWER DURING INSTALLATION OR SERVICING

OVERVIEW

GRID CEILING

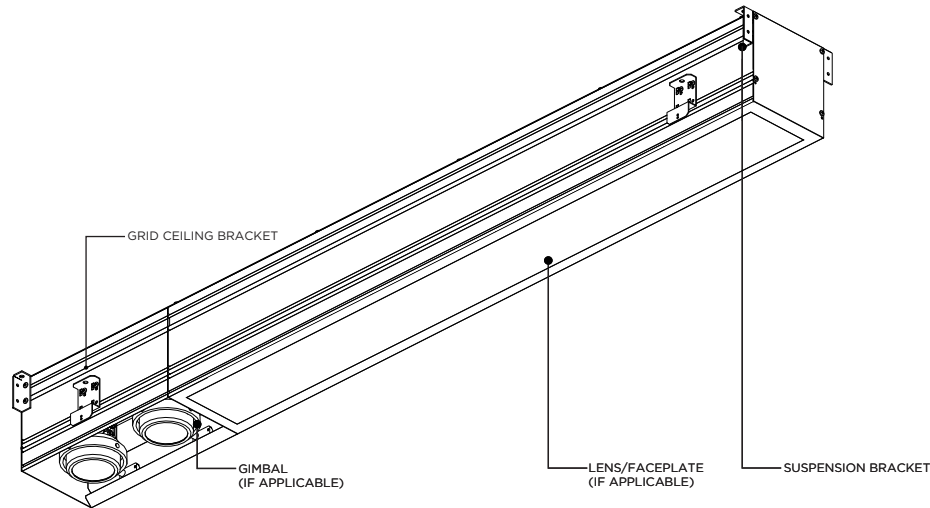

**i ALL INTEGRATED MECHANICAL OPTIONS ARE PROVIDED AS 6" SECTIONS**

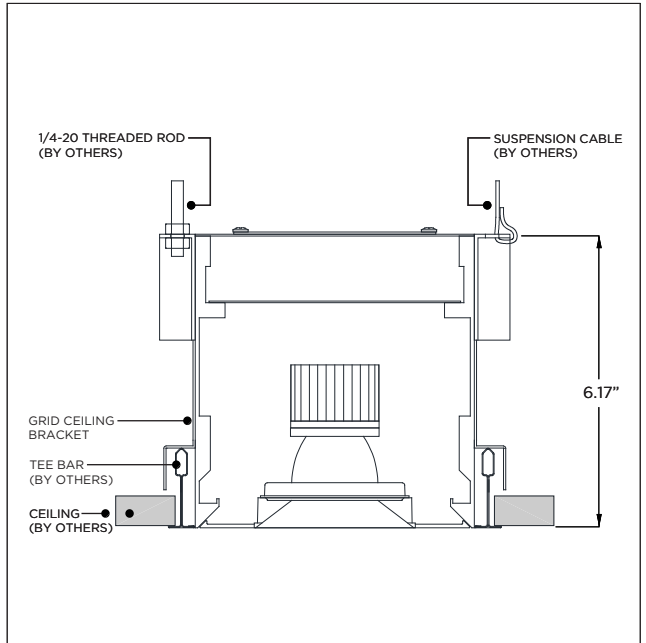

GRID CEILING MOUNTING BRACKET

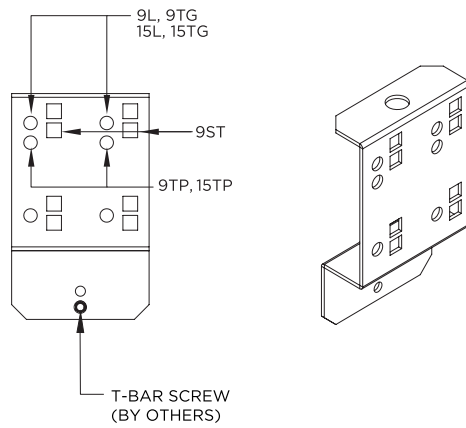

**i UNIVERSAL MOUNTING BRACKET FOR ALL GRID CEILING TYPES**

ASYMMETRIC LENS ORIENTATION

**3Gi-2" LINEAR - ASYMMETRIC LENS/REFLECTOR ORIENTATION**

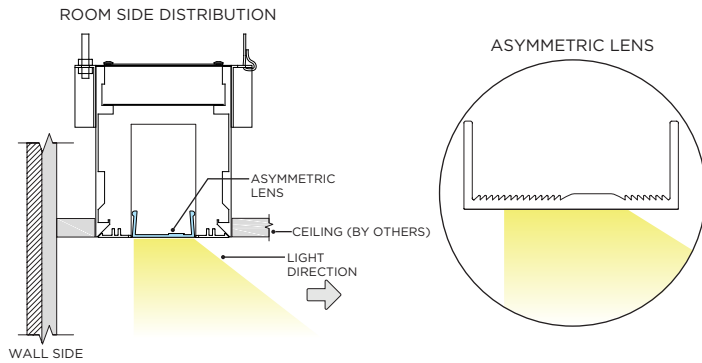

**3Gi-4" LINEAR - ASYMMETRIC LENS/REFLECTOR ORIENTATION**

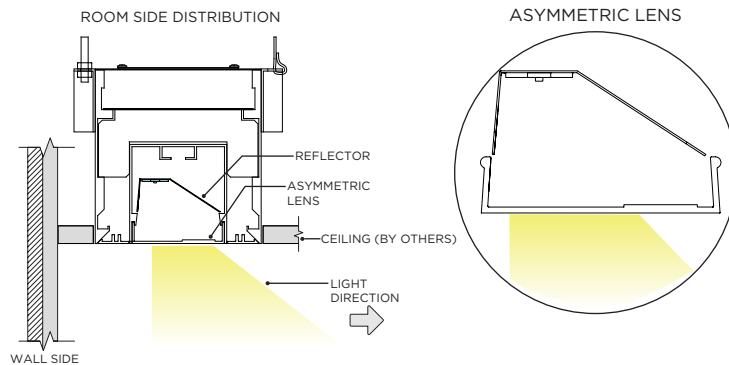

THREADED ROD LOCATION

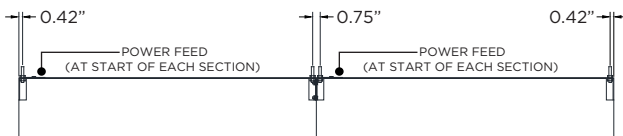

IDENTIFICATION AND PREPARATION

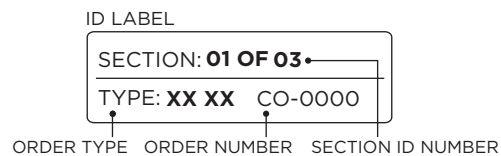

**i** IDENTIFY FIXTURE SECTIONS BY THE ID LABELS FOUND ON THE BOX INSIDE THE SECTIONS

ID LABEL

SECTION: 01 OF 03

TYPE: XX XX CO-0000



STARTER

JOINER

ENDER

OVERVIEW

**3Gi-58RSL**

**9L - 9/16" LAYIN**

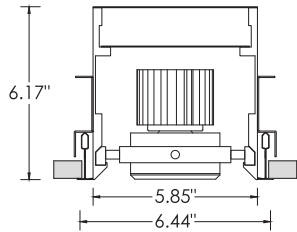

**9TG - 9/16" TEGULAR**

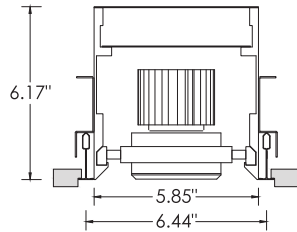

**15L - 15/16" LAYIN**

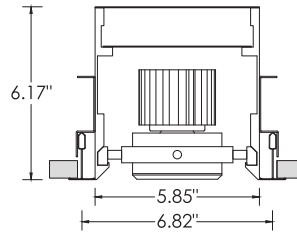

**15TG - 15/16" TEGULAR**

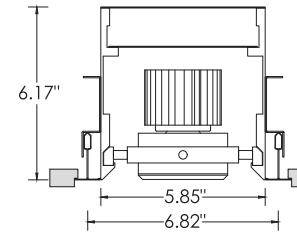

**9ST - 9/16" SLOT TEE**  
TEGULAR

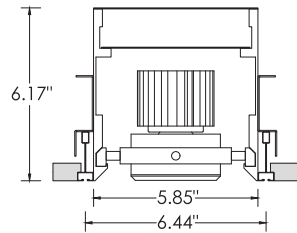

**6TZ - TECHZONE**

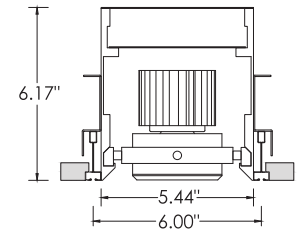

**3Gi-48RSL**

**9L - 9/16" LAYIN**

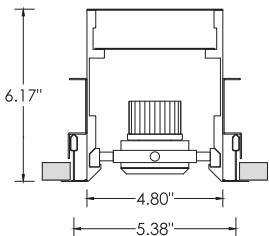

**9TG - 9/16" TEGULAR**

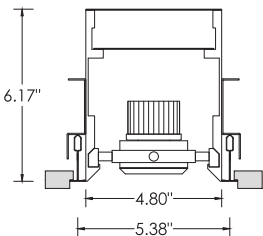

**15L - 15/16" LAYIN**

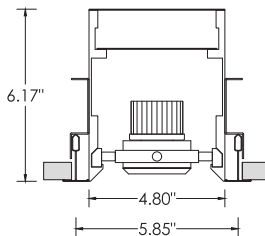

**15TG - 15/16" TEGULAR**

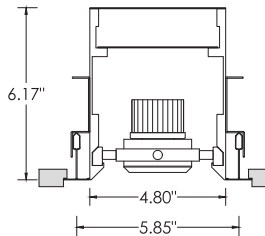

**9ST - 9/16" SLOT TEE**  
TEGULAR

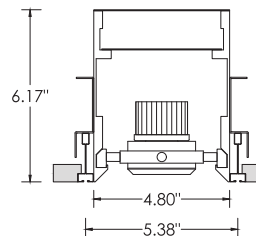



## 1 INTEGRATED MECHANICAL COMPONENTS



**i** ALL INTEGRATED MECHANICAL COMPONENTS ARE NOT INSTALLED BY 3G

## 2 MICROPHONE SHOWN AS EXAMPLE

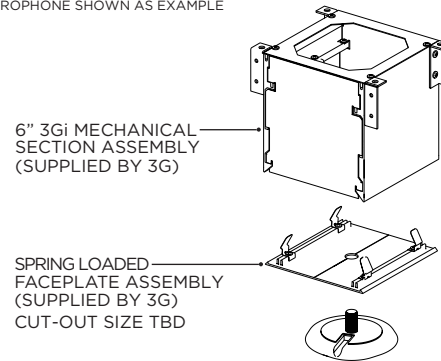

UNCLIP FACEPLATE FROM HOUSING TO ACCESS INSIDE OF HOUSING SECTION

## INTEGRATED HVAC

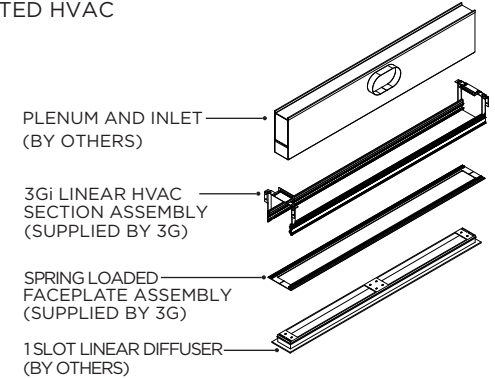

**i** ALL INTEGRATED HVAC COMPONENTS ARE NOT INSTALLED BY 3G

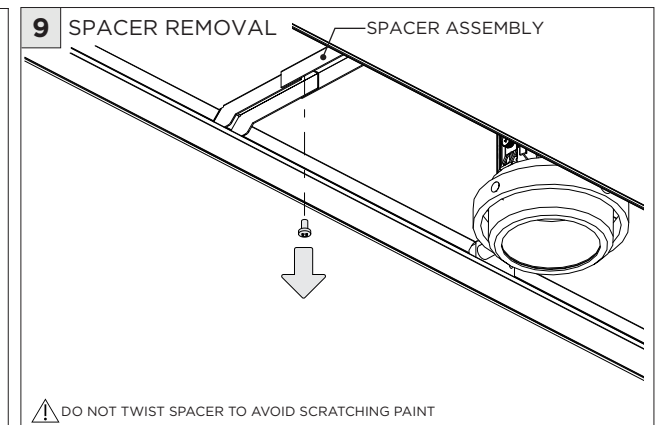
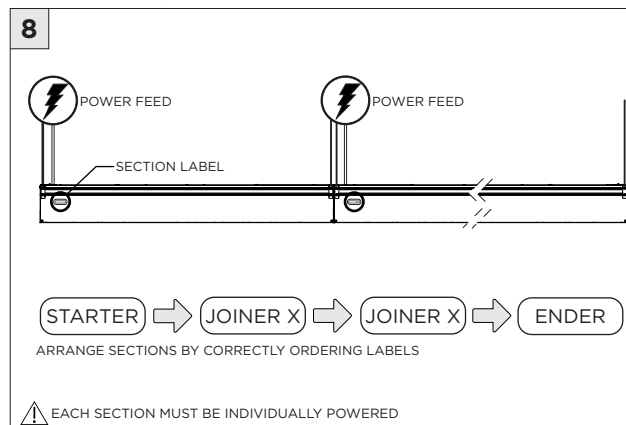
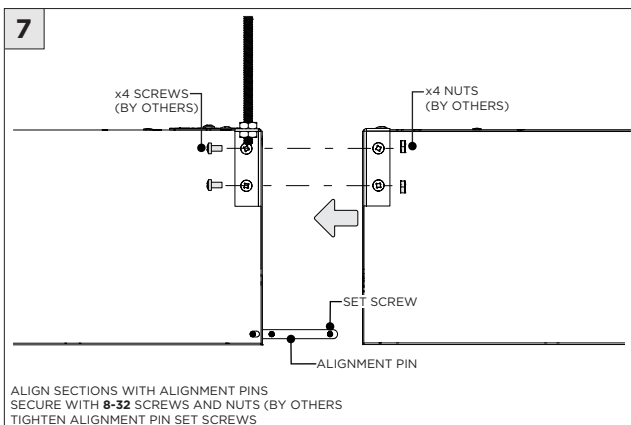
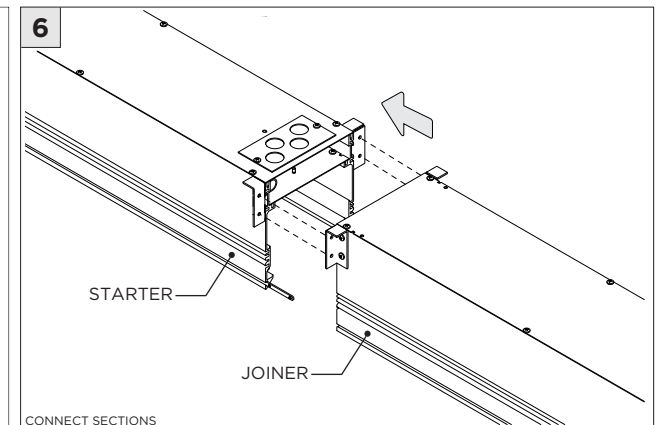
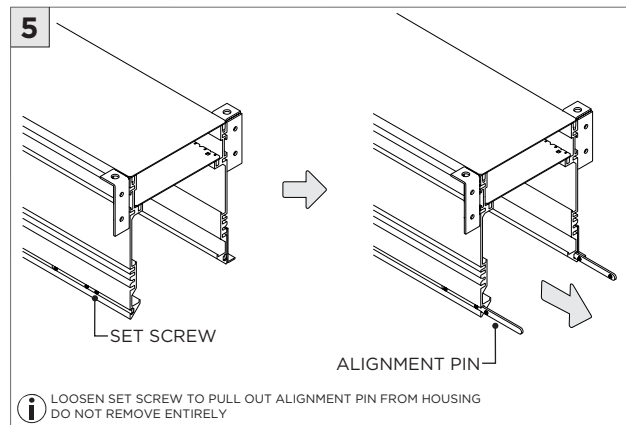
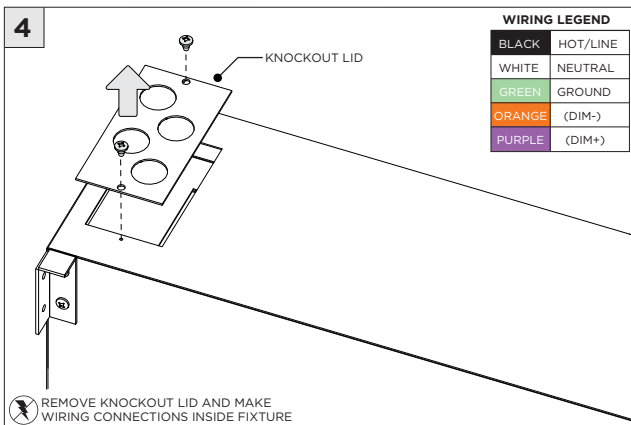
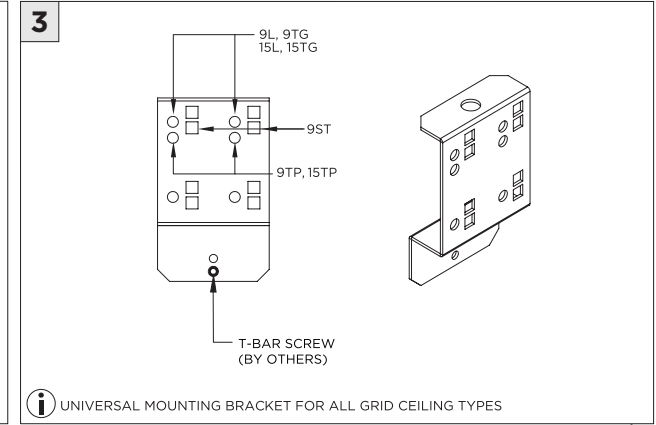
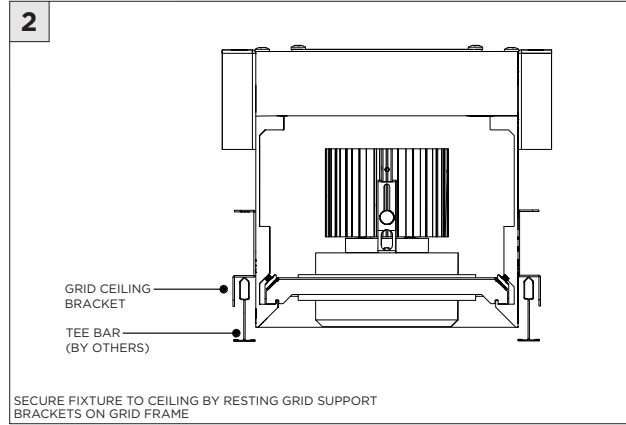
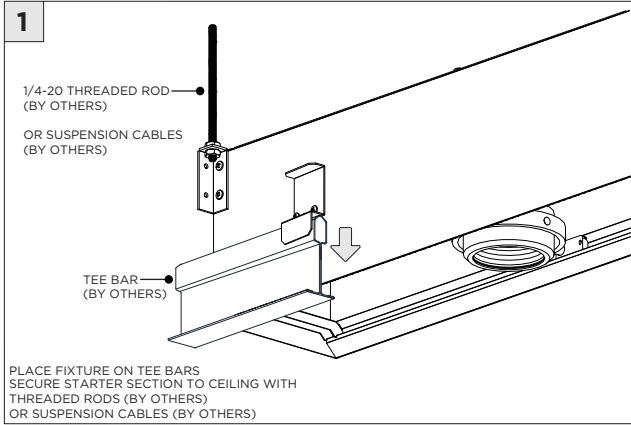

**10**

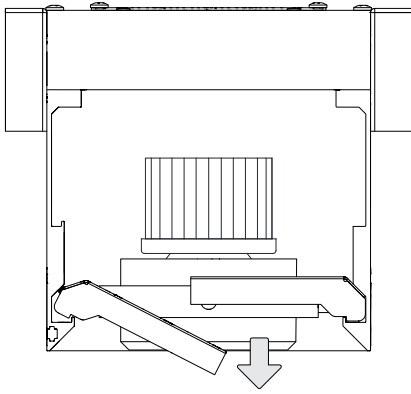

**11**

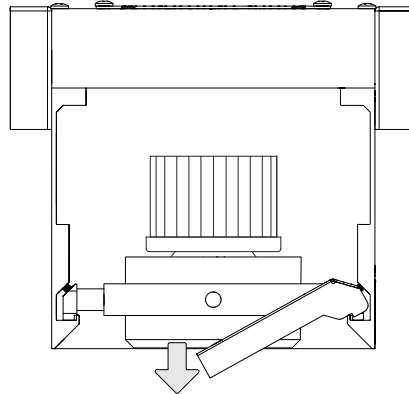

**LED SERVICING - GIMBAL**

**1**

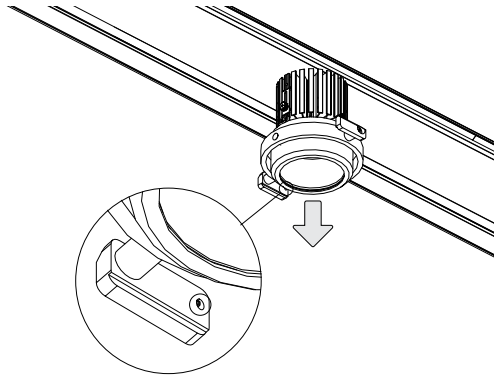

**2**

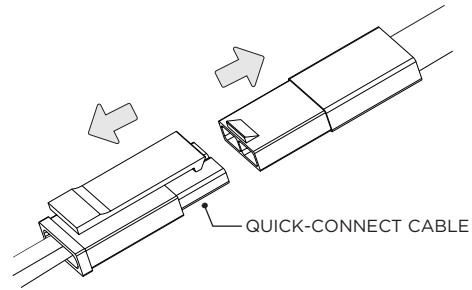

DISCONNECT QUICK-CONNECT CABLE FROM LED ASSEMBLY

**3**

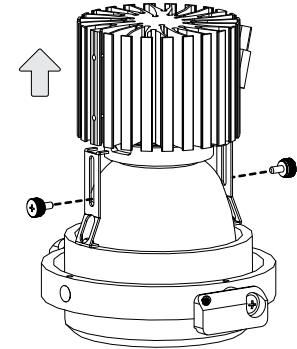

**4**

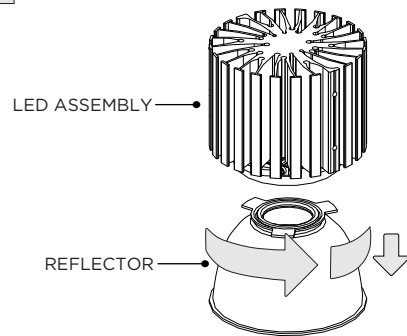

TWIST REFLECTOR TO REMOVE FROM LED ASSEMBLY

**DL33RA - ADJUSTING DOWNLIGHT ANGLE**

**1**

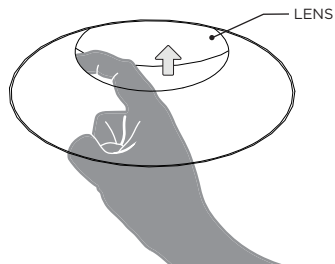

LIFT LENS AND DETATCH INSERT FROM LED ASSEMBLY

**2**

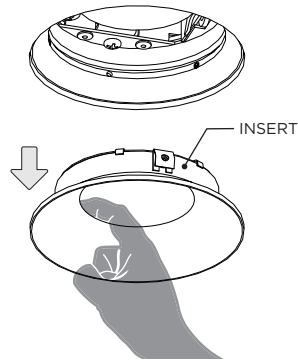

**3**

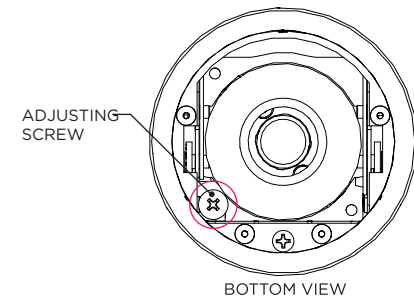

**4**

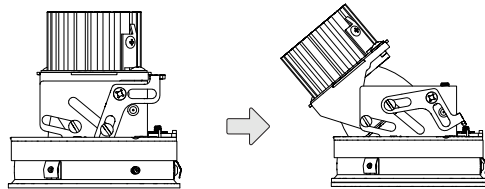

**DL33SA - ADJUSTING DOWNLIGHT ANGLE**

**1**

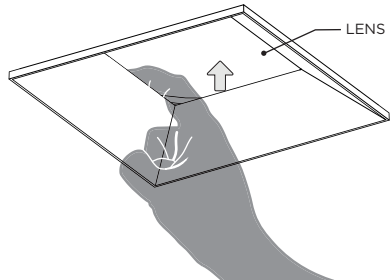

LIFT LENS AND DETATCH INSERT FROM ADAPTER RING

**2**

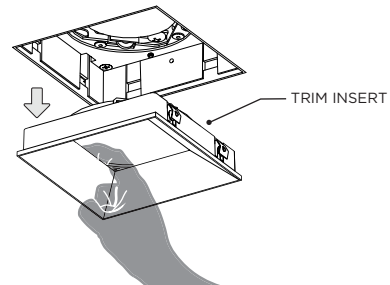

**3**

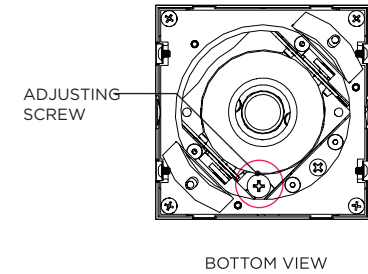

**4**

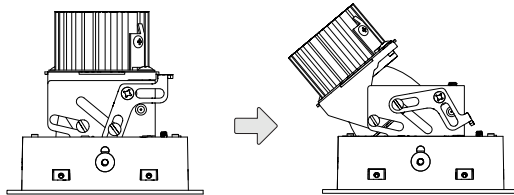

**DRIVER SERVICING**

**1 FLUSH LENS REMOVAL**

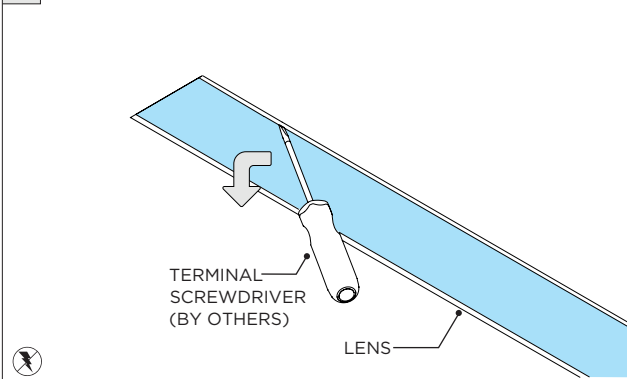

**2**

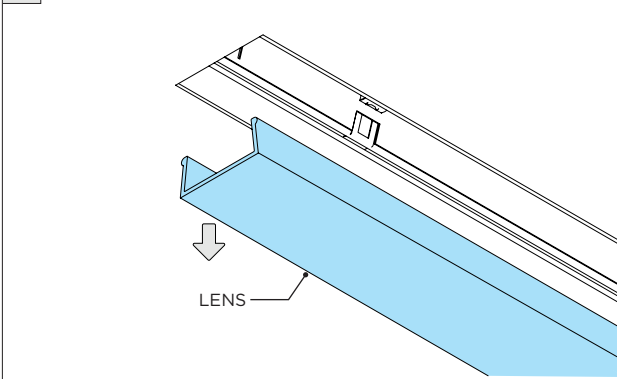

**2A DROP LENS REMOVAL**

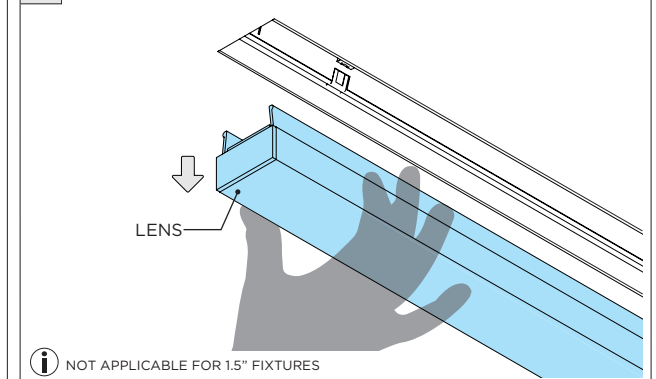

**3**

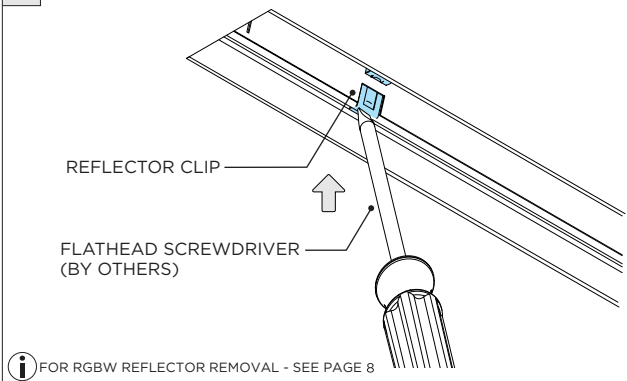

**4**

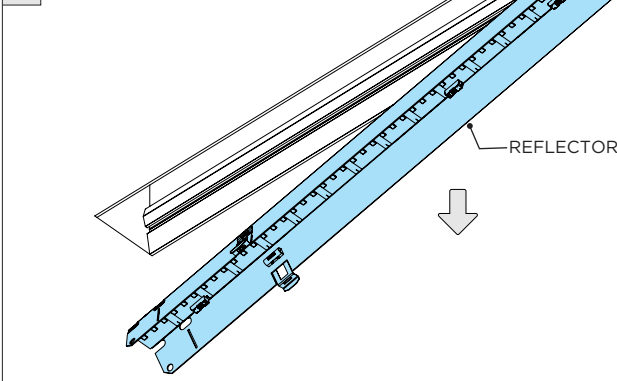

**5**

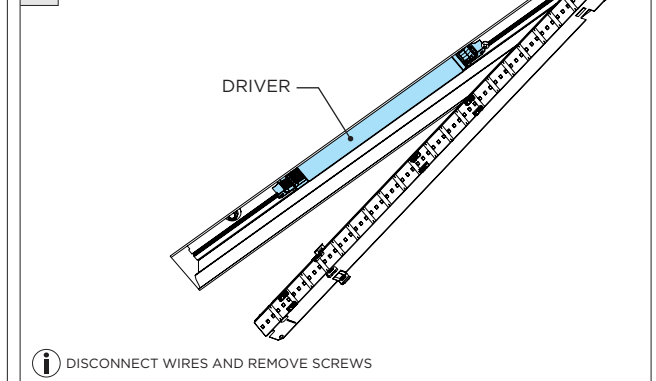

**6**

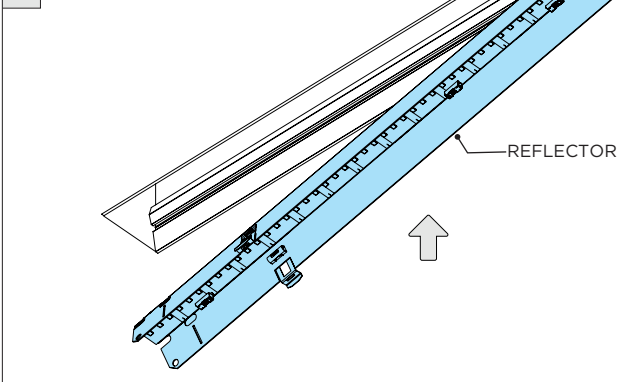

**7**

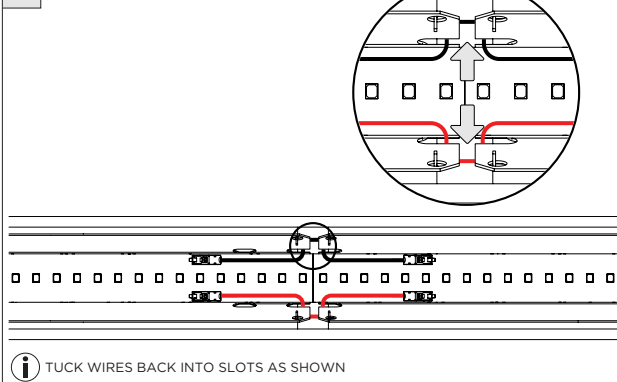

**8**

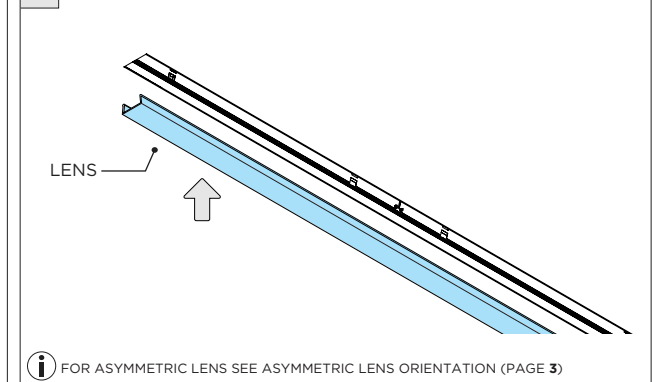

**LINEAR LED SERVICING**

**1**

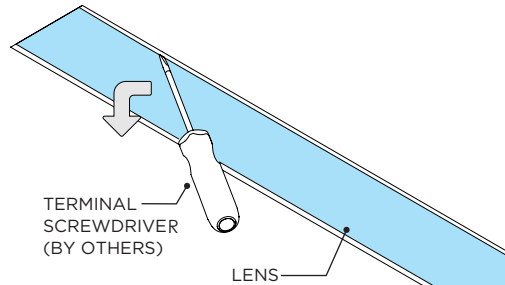

**2**

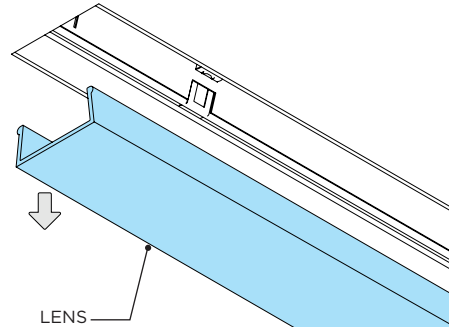

**2A** DROP LENS REMOVAL

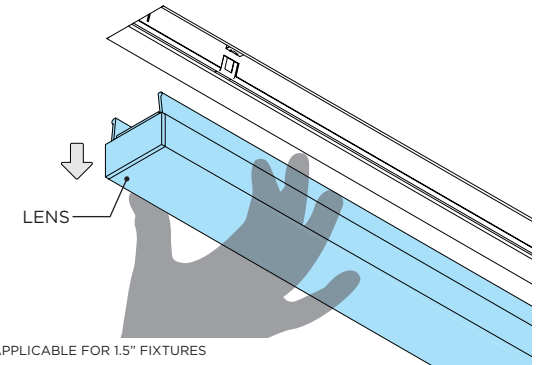

**3**

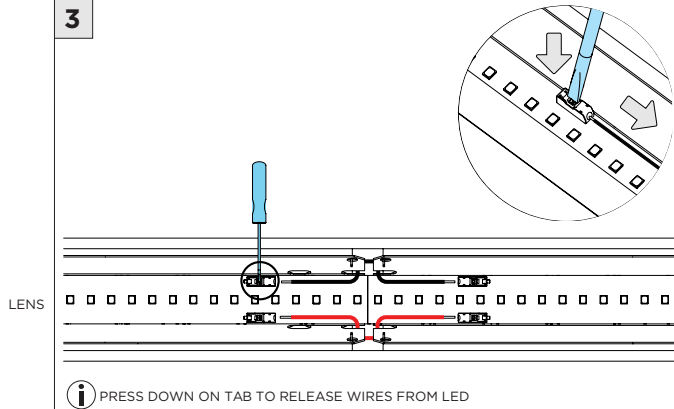

**4**

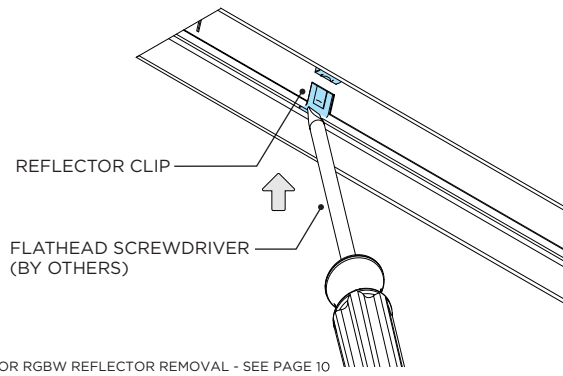

**5**

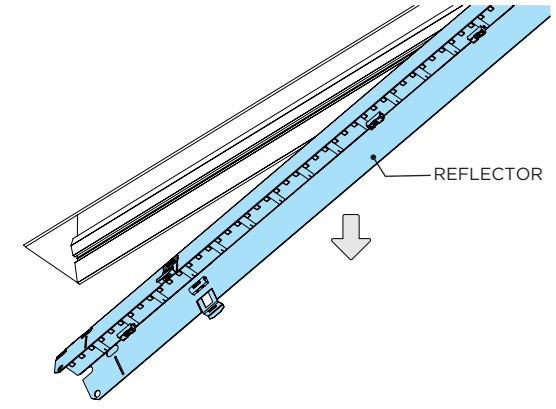

**6**

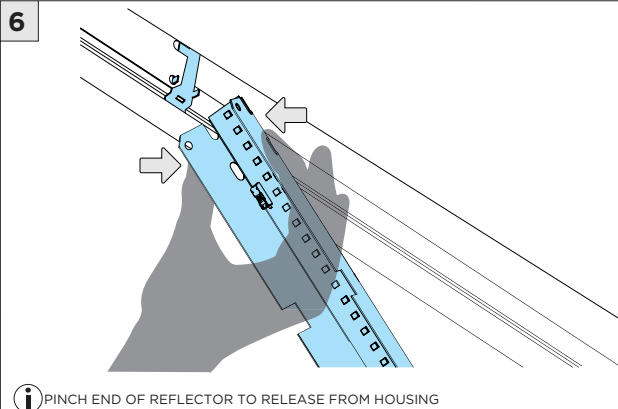

**7**

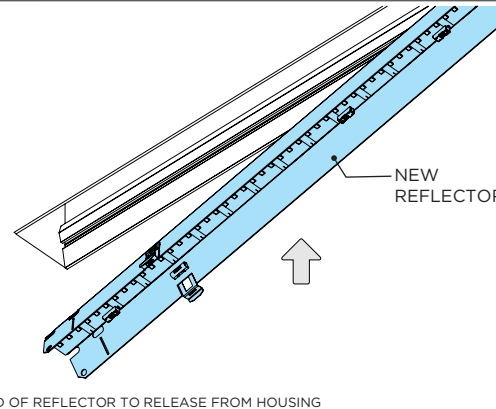

**8**

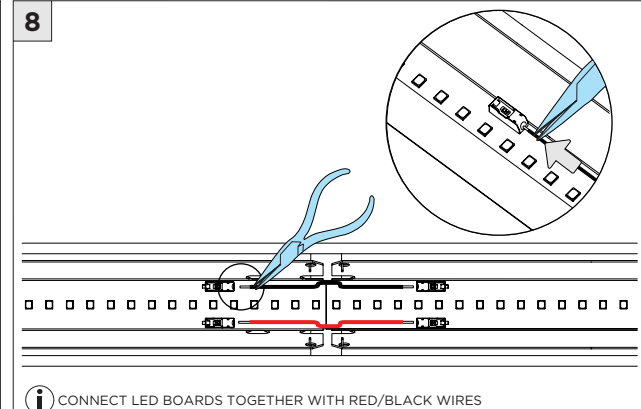



**LINEAR LED SERVICING**

**9**

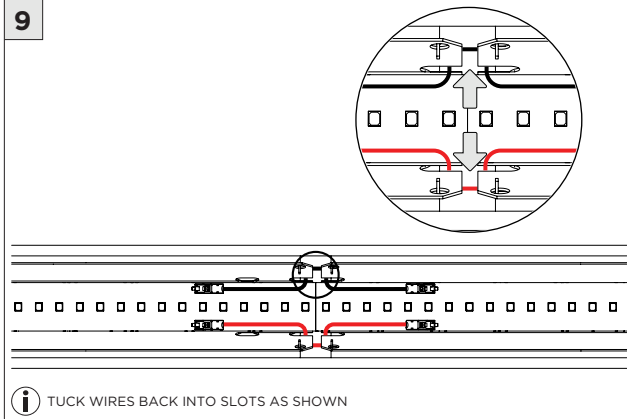

**10**

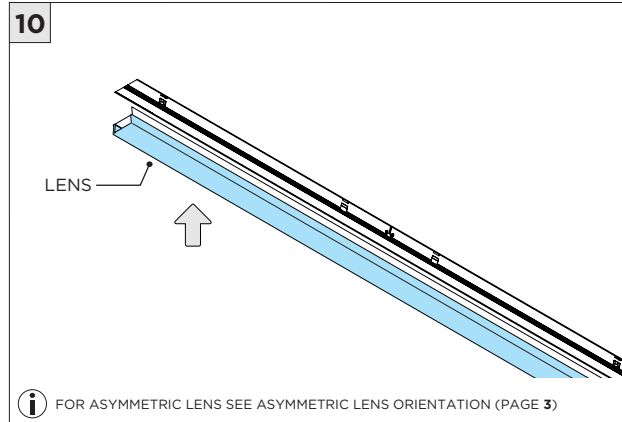

**LED SERVICING - DL33R**

**1**

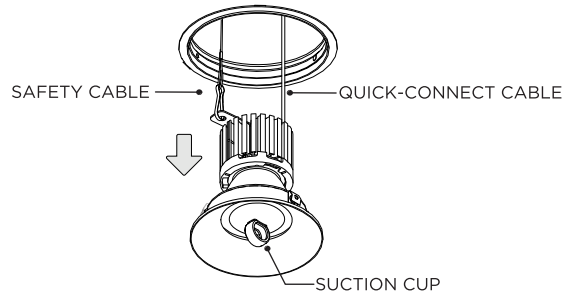

REMOVE LED ASSEMBLY FROM CEILING

**2**

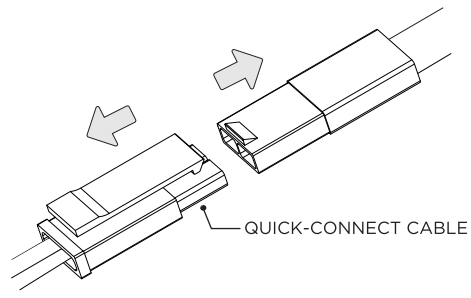

DISCONNECT SAFETY CABLE & QUICK-CONNECT CABLE FROM LED ASSEMBLY

**3**

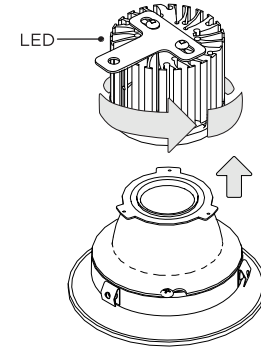

**4 FOR DL45**

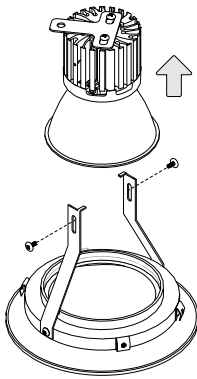

**LED SERVICING - DL33RA**

**1**

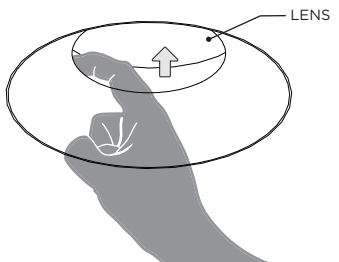

LENS

LIFT LENS AND DETATCH INSERT FROM LED ASSEMBLY

**2**

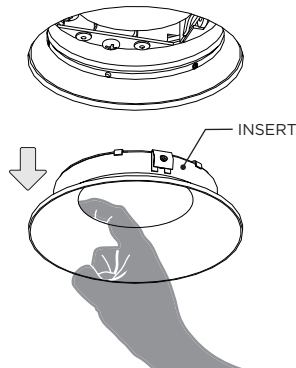

INSERT

**3**

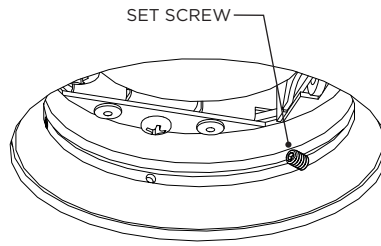

SET SCREW

LOOSEN THREE SET SCREWS INSIDE ADAPTER RING

⚠ DO NOT FULLY REMOVE SET SCREWS FROM ADAPTER RING

**4**

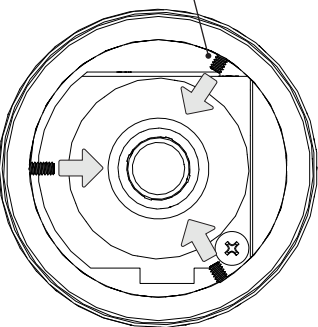

SET SCREW

BOTTOM VIEW

**5**

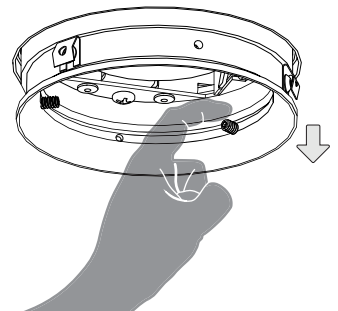

UNCLIP ADAPTER RING FROM CEILING BY PULLING DOWN ON EACH SET SCREW

**6**

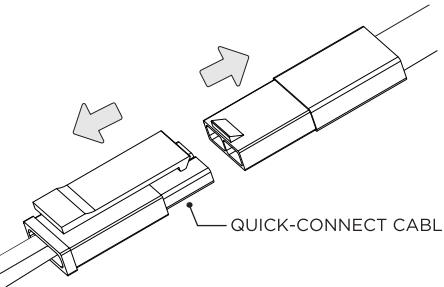

QUICK-CONNECT CABLE

DISCONNECT QUICK-CONNECT CABLE FROM LED ASSEMBLY

**7**

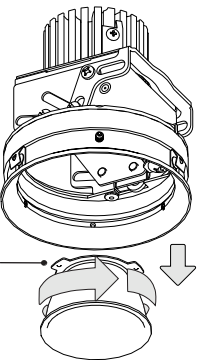

REFLECTOR

TWIST REFLECTOR TO REMOVE

**8**

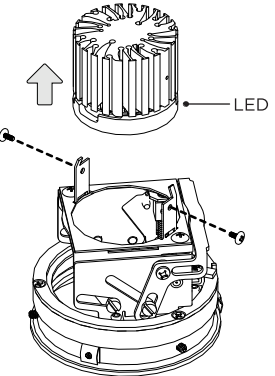

LED

**LED SERVICING - DL33S**

**1**

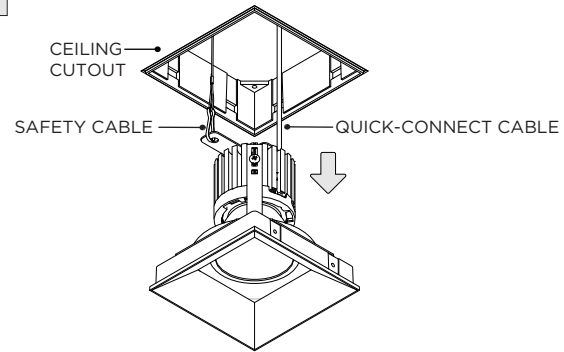

REMOVE LED ASSEMBLY FROM CEILING

**2**

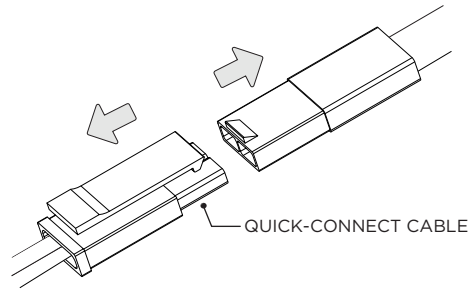

DISCONNECT SAFETY CABLE & QUICK-CONNECT CABLE FROM LED ASSEMBLY

**3**

**FOR DL33/DL45**

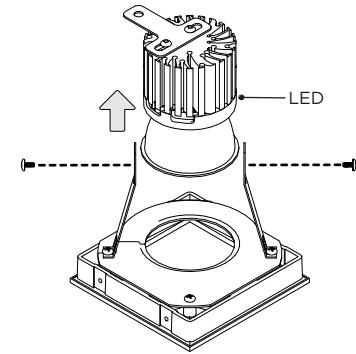

**LED SERVICING - DL33SA**

**1**

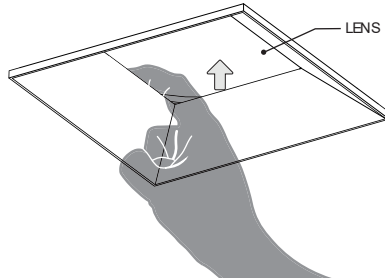

LIFT LENS AND DETACH INSERT FROM ADAPTER RING

**2**

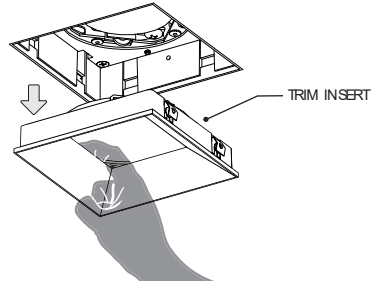

**3**

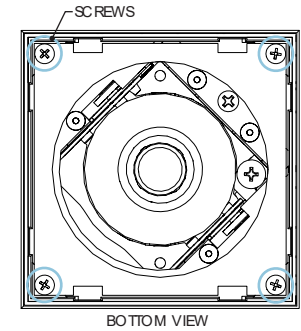

REMOVE 4 SCREWS TO DETACH LED ASSEMBLY FROM CEILING

**4**

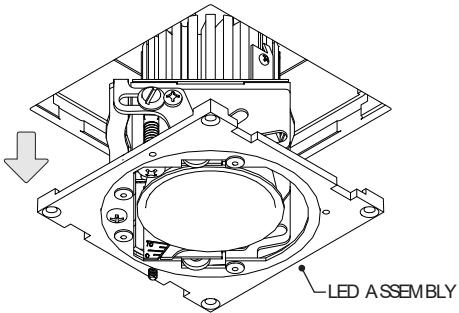

**5**

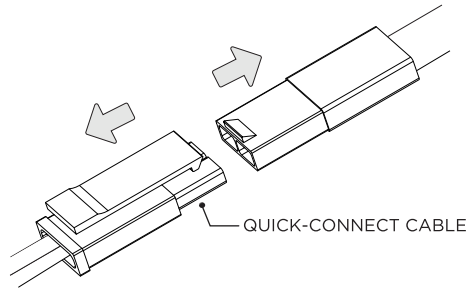

DISCONNECT QUICK-CONNECT CABLE FROM LED ASSEMBLY

**6**

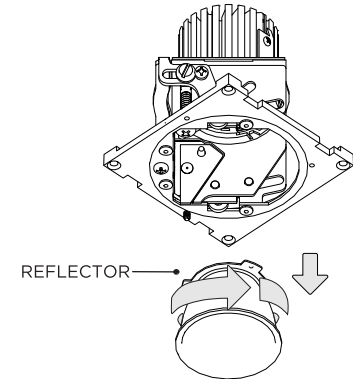

TWIST REFLECTOR TO REMOVE

**7**

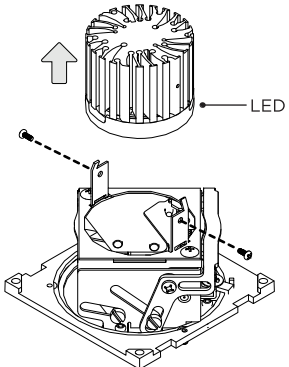

**LED SERVICING - DZ33R**

**1**

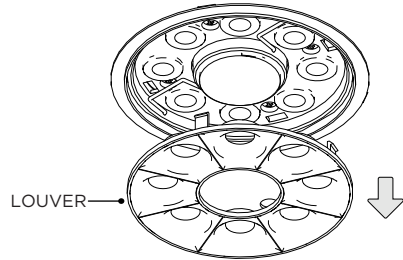

UNCLIP LOUVER FROM LED ASSEMBLY

**2**

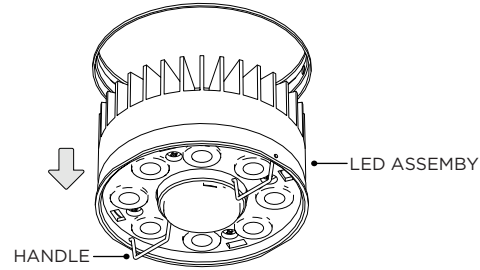

PULL DOWN ON HANDLES TO UNCLIP LED ASSEMBLY FROM CEILING

**3**

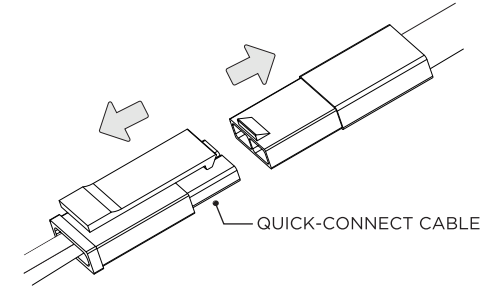

DISCONNECT QUICK-CONNECT CABLE FROM LED ASSEMBLY

**4**

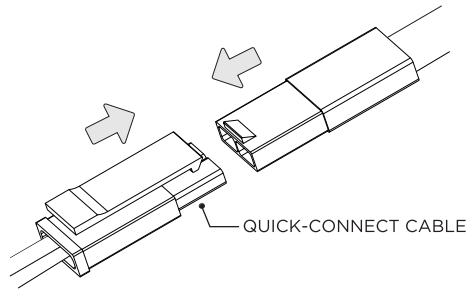

CONNECT QUICK-CONNECT CABLE TO NEW LED ASSEMBLY

**5**

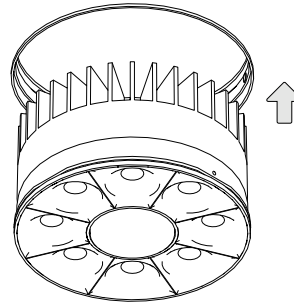

INSERT NEW LED ASSEMBLY INTO CEILING

**LED SERVICING - DZ33S**

**1**

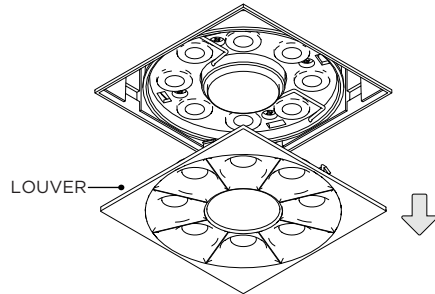

REMOVE LOUVER FROM LED ASSEMBLY

**2**

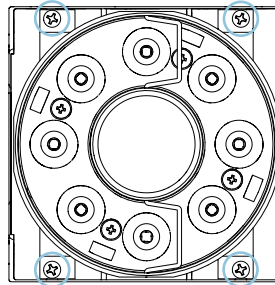

LOCATE FOUR SCREWS

**3**

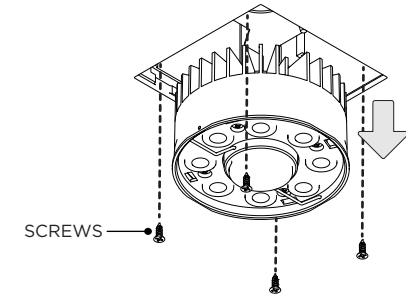

UNSCREW SCREWS TO REMOVE LED ASSEMBLY

**4**

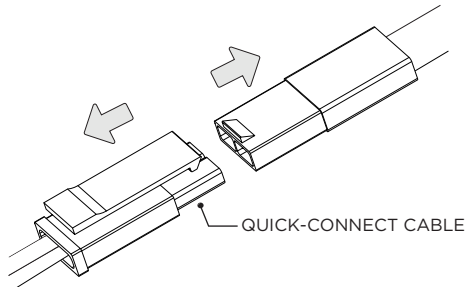

DISCONNECT QUICK-CONNECT CABLE FROM LED ASSEMBLY

**5**

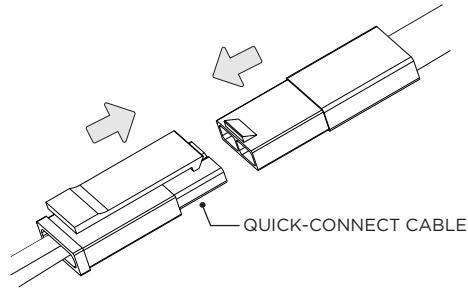

CONNECT QUICK-CONNECT CABLE TO NEW LED ASSEMBLY

**6**

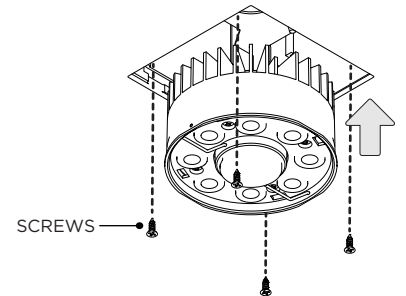

SCREW NEW LED ASSEMBLY INTO CYLINDER

**7**

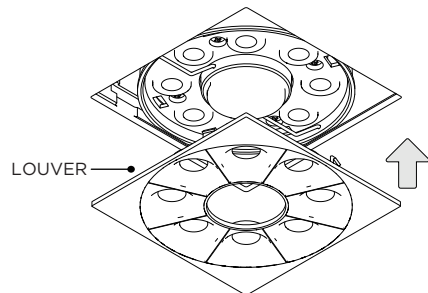

CONNECT QUICK-CONNECT CABLE TO NEW LED ASSEMBLY  
www.3GLIGHTING.com | P: 905-850-2305 TF: 888-448-0440