

## 3.3" ADJUSTABLE DOWNLIGHT CYLINDER PENDANT

STEM PENDANT MOUNT

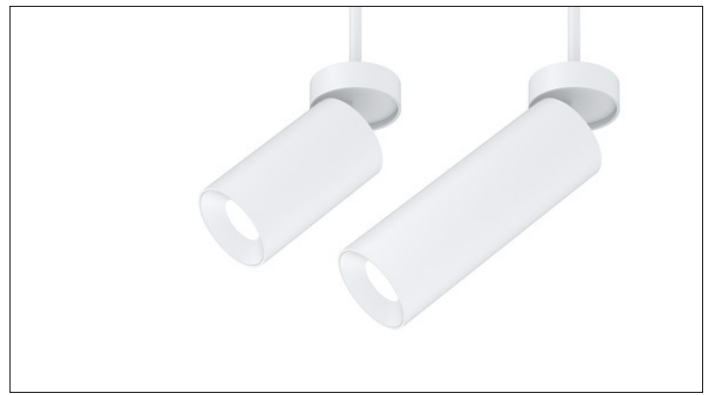

**i** THE IMAGES SHOWN ARE FOR ILLUSTRATION ONLY AND MAY NOT BE AN EXACT REPRESENTATION OF THE PRODUCT

### COMPONENTS

#### STANDARD CANOPY

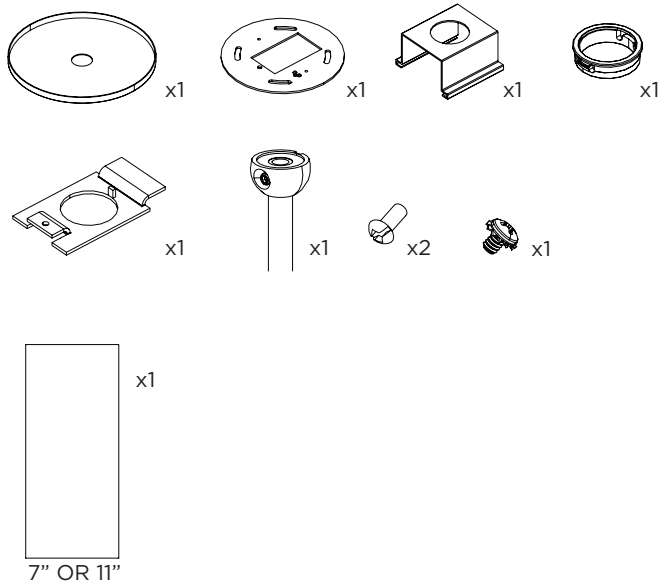

#### CONDUIT FEED CANOPY

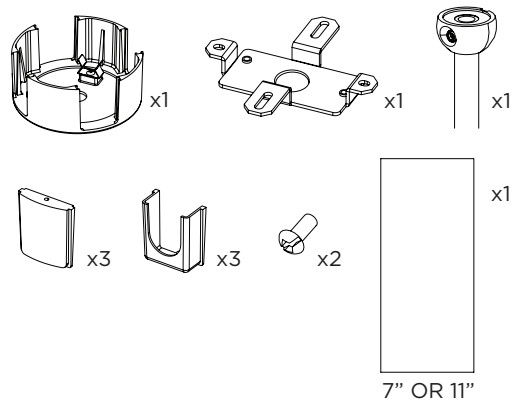

#### POWER CANOPY

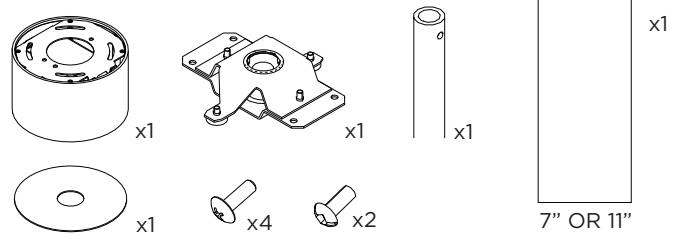

#### 4" OCTAGONAL J-BOX REQUIRED FOR INSTALLATION

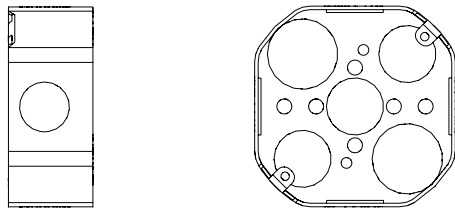

JUNCTION BOX (BY OTHERS)

#### SUITABLE FOR SLOPED CEILING

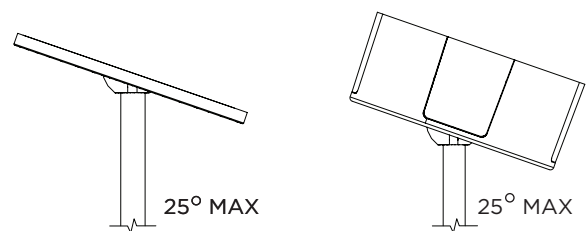

#### INSTRUCTION KEY

#### INFORMATION

- ADDITIONAL
- ATTENTION
- POWER ON
- POWER OFF

INSTALLATION SHOULD ONLY BE PERFORMED BY A CERTIFIED ELECTRICIAN  
 REFER TO LOCAL/NATIONAL CODES FOR PROPER INSTALLATION  
 FAILURE TO FOLLOW INSTALLATION INSTRUCTION MAY VOID THE WARRANTY  
 DO NOT TOUCH LEDS. LEDS MUST BE PROTECTED FROM MECHANICAL STRESS OR DEBRIS  
 TURN OFF POWER DURING INSTALLATION OR SERVICING

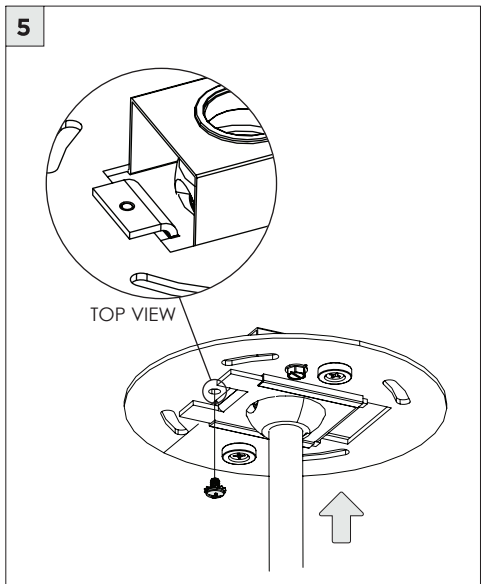
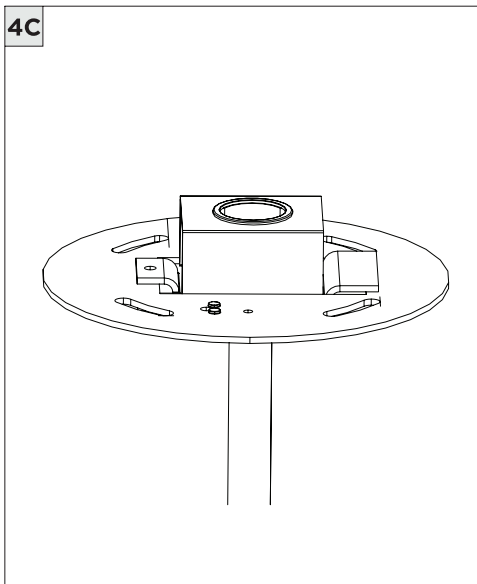
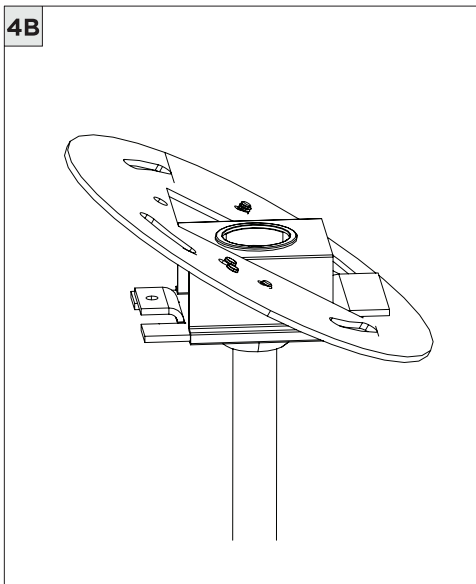
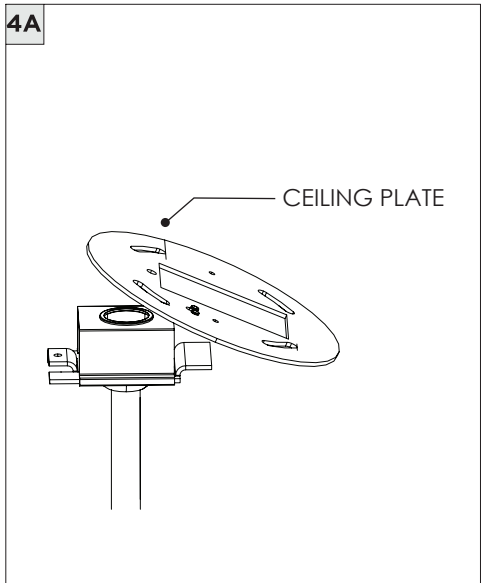
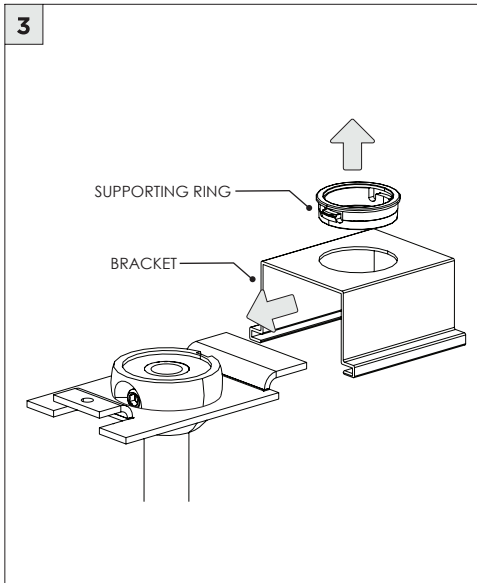
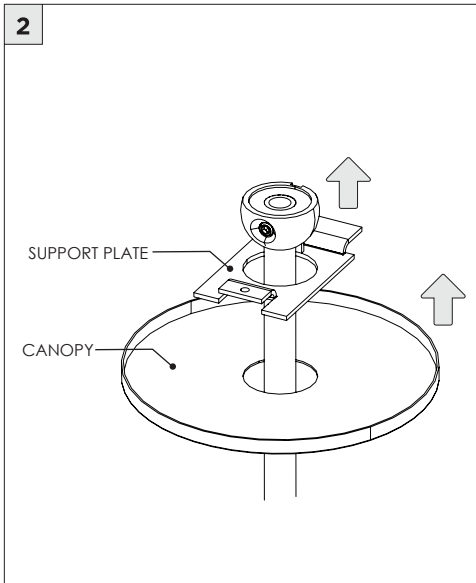
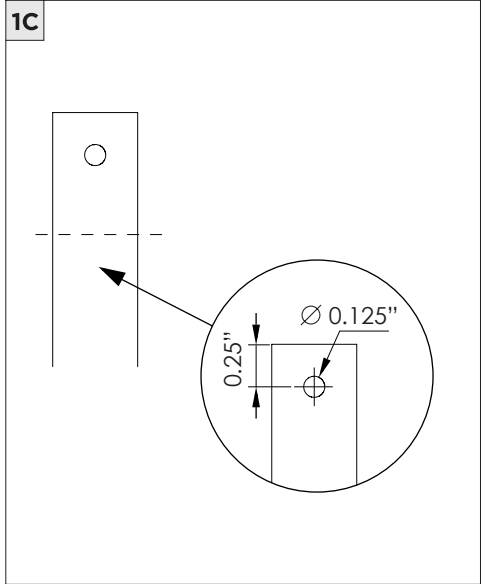
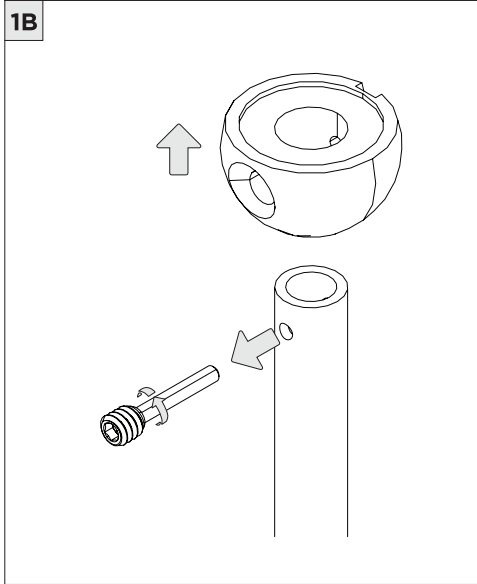
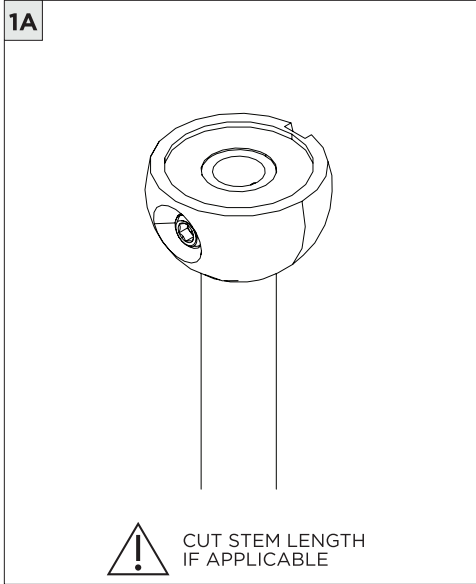

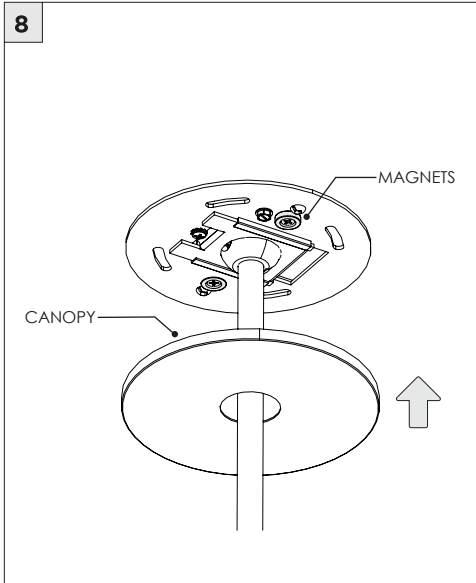
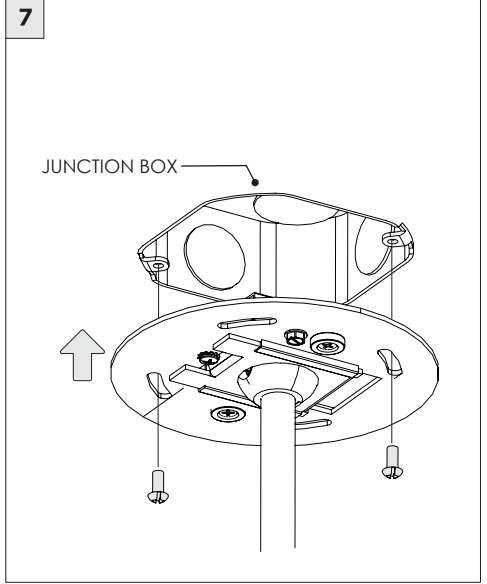
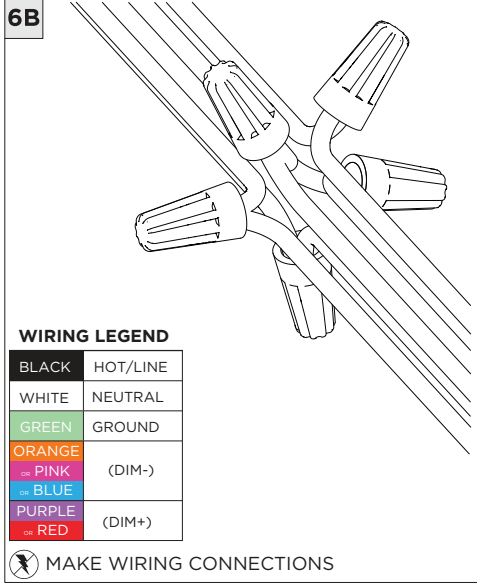
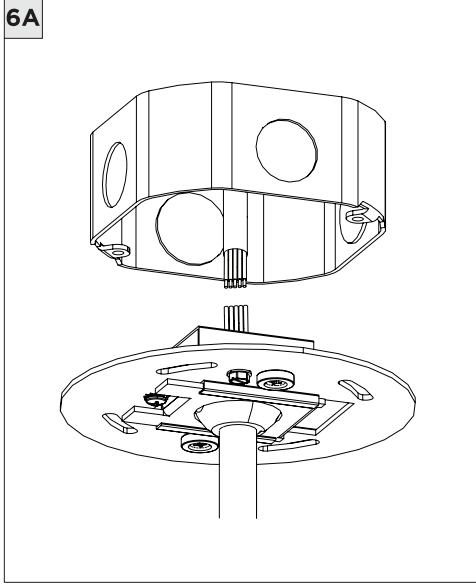

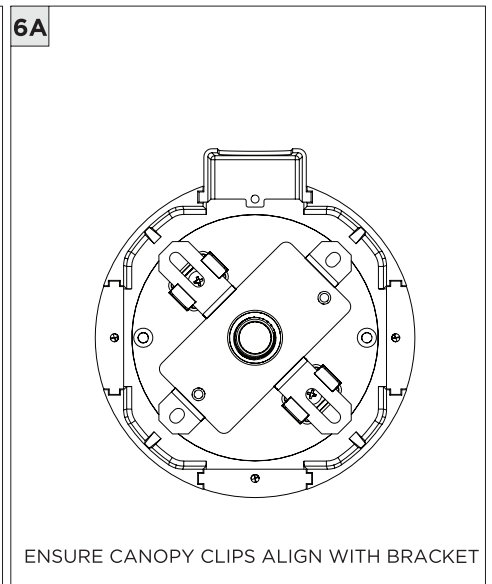
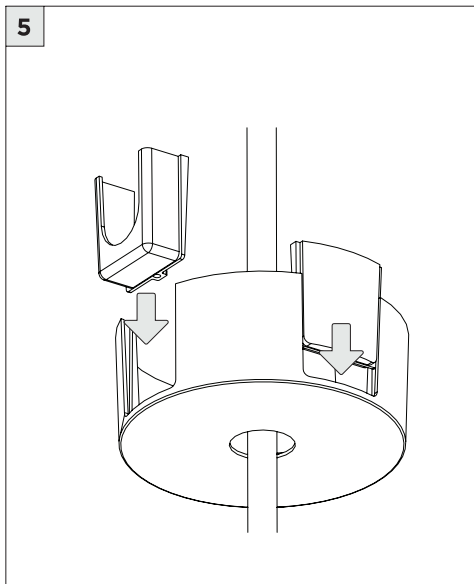
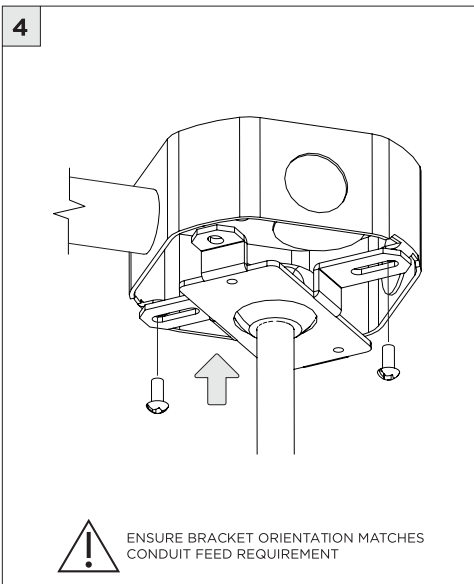
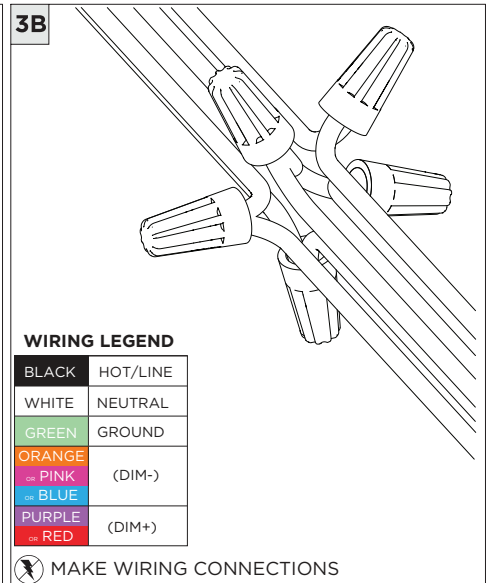
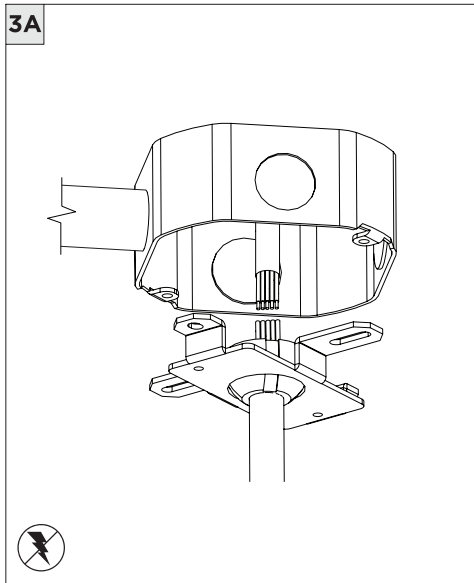
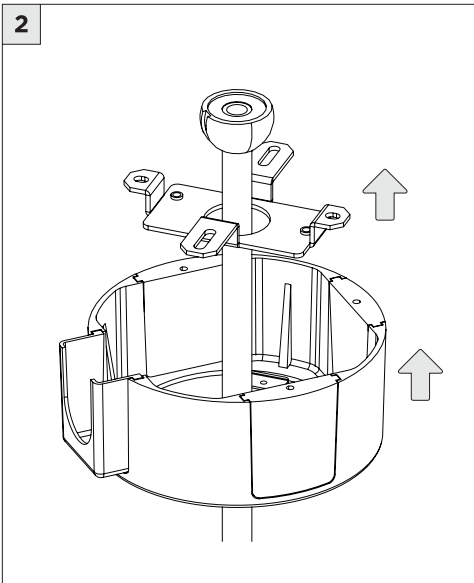
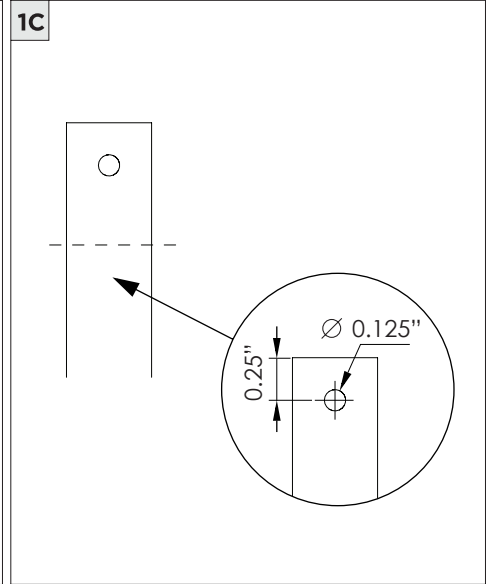
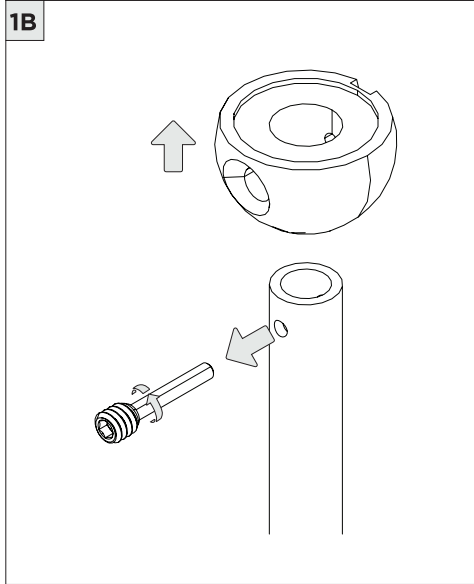
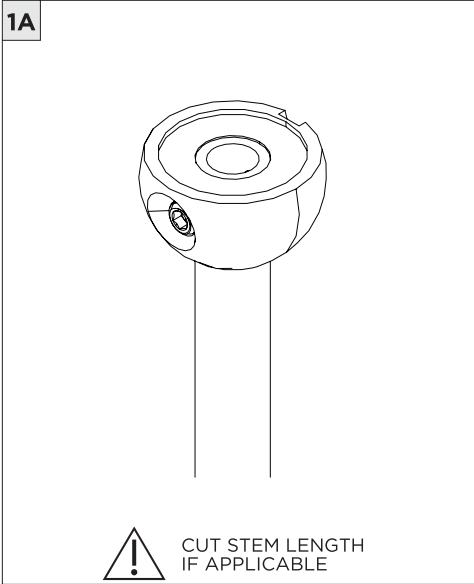

6B

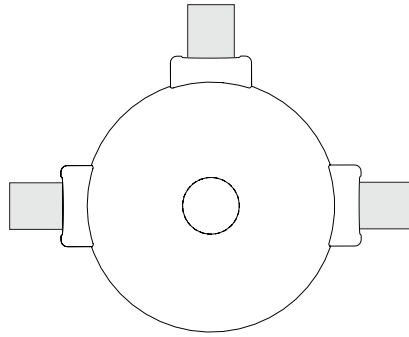
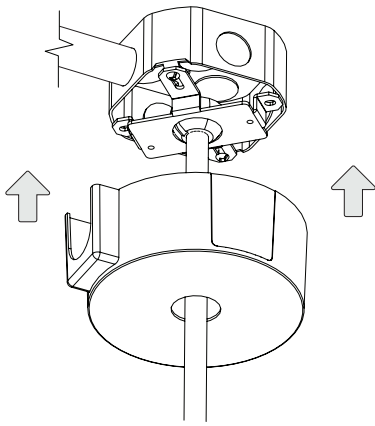

CANOPY IS SUITABLE FOR  
MAXIMUM 3 CONDUIT FEEDS

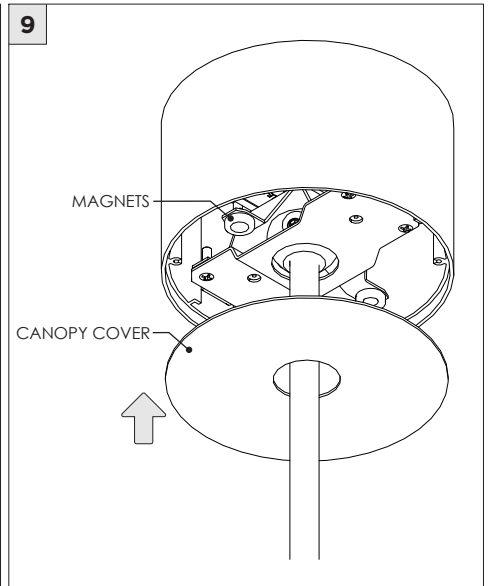
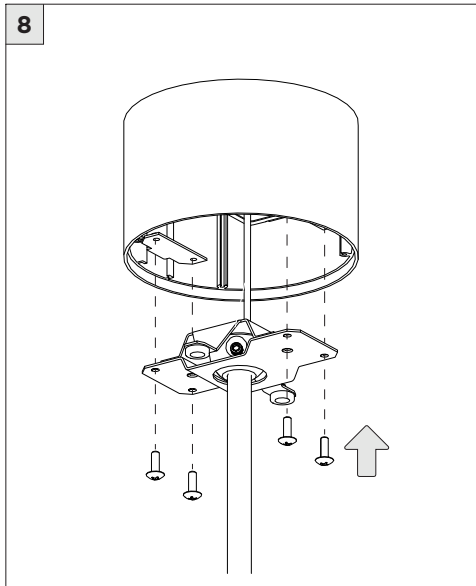
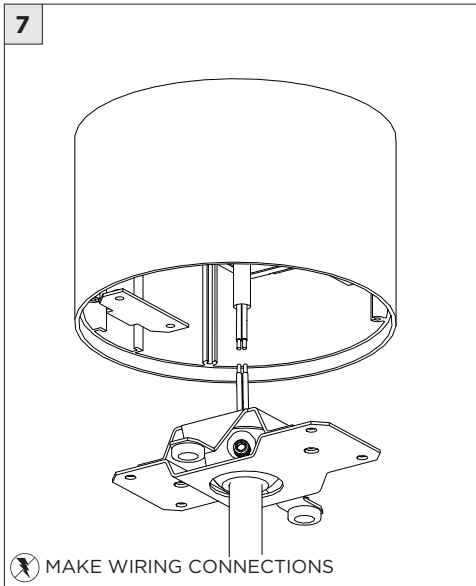
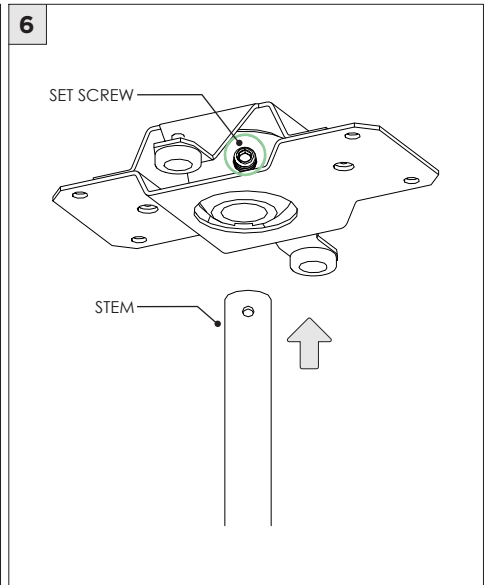
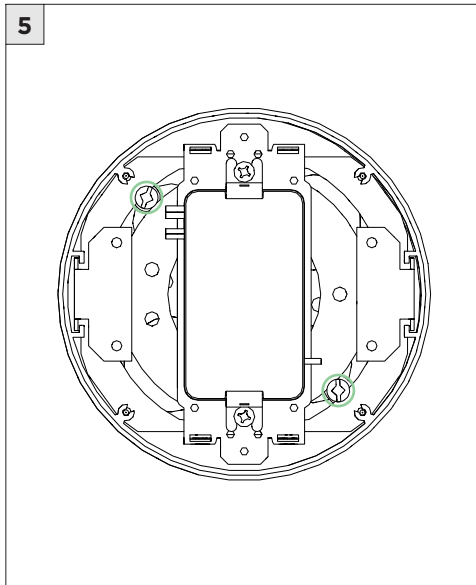
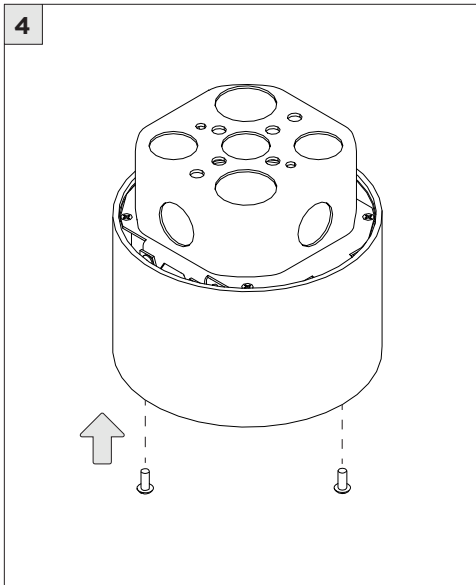
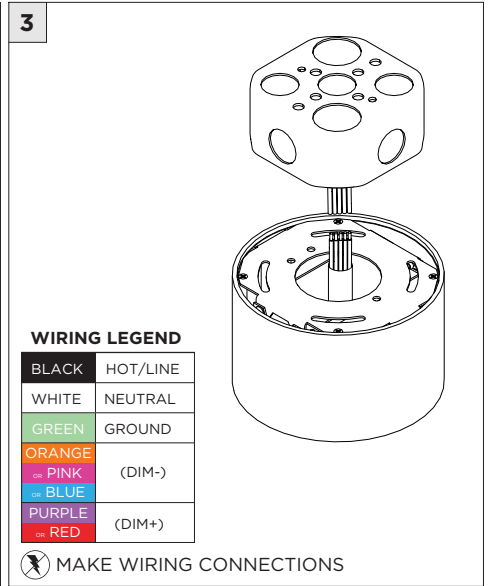
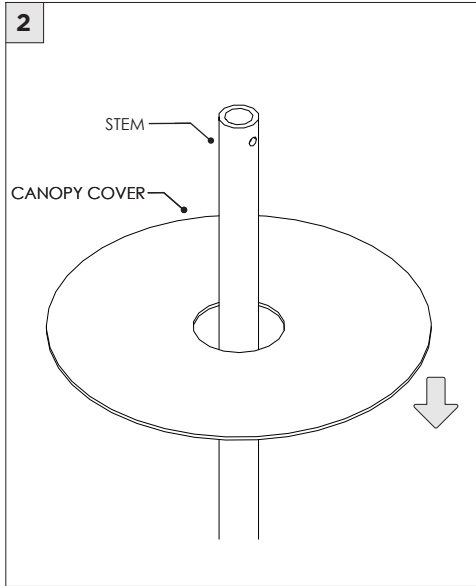
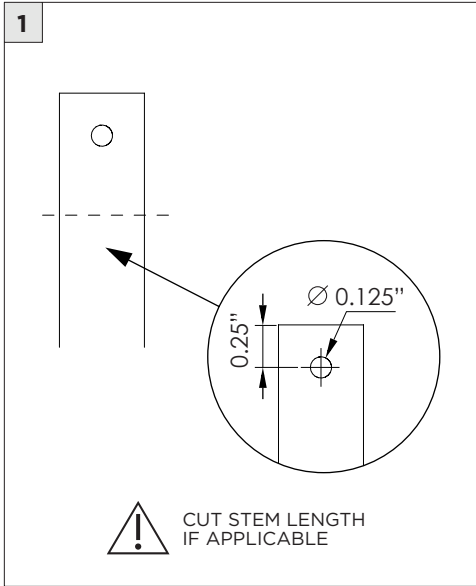

**1 CONDUIT FEED CANOPY**

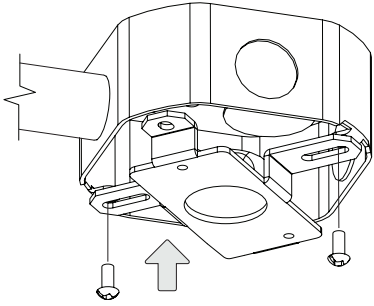

**2**

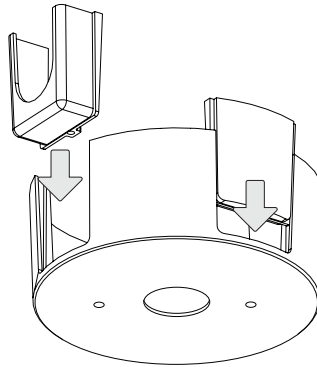

**3**

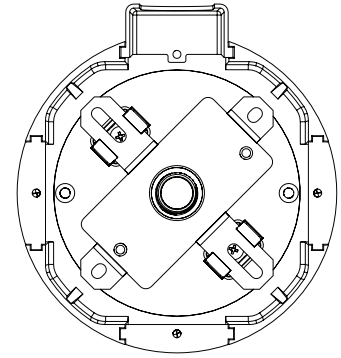

ENSURE CANOPY CLIPS ALIGN WITH BRACKET

**4**

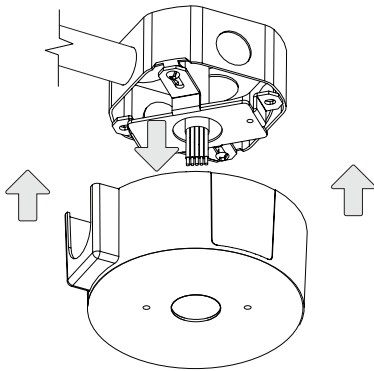

CONNECT CONDUIT CANOPY AND FEED JUNCTION BOX WIRES THROUGH HOLE

**5**

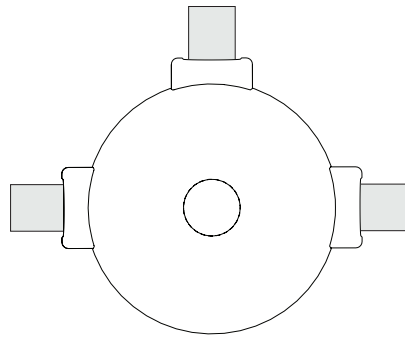

**!** CANOPY IS SUITABLE FOR MAXIMUM 3 CONDUIT FEEDS

**6 POWER CANOPY**

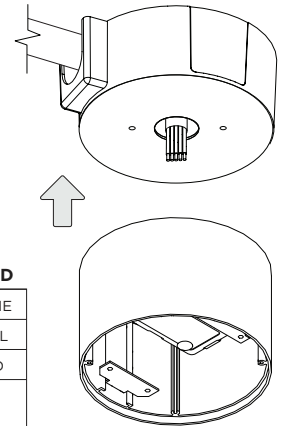

**WIRING LEGEND**

BLACK	HOT/LINE
WHITE	NEUTRAL
GREEN	GROUND
ORANGE	(DIM-)
PINK	(DIM-)
BLUE	(DIM-)
PURPLE	(DIM+)
RED	(DIM+)

**!** MAKE WIRING CONNECTIONS

**7**

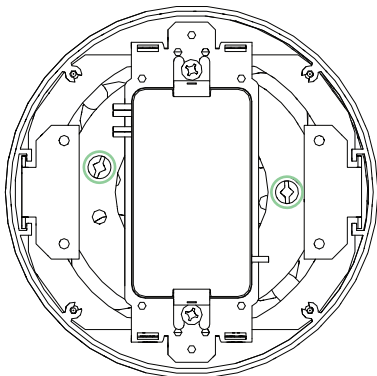

**8**

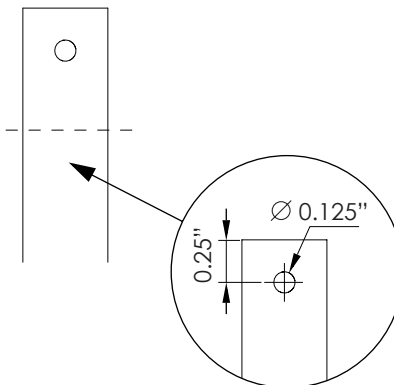

**!** CUT STEM LENGTH IF APPLICABLE

**9**

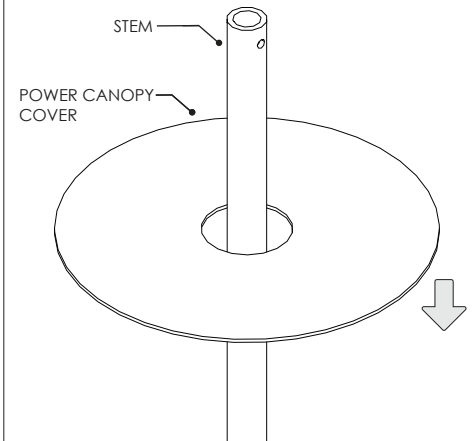

10

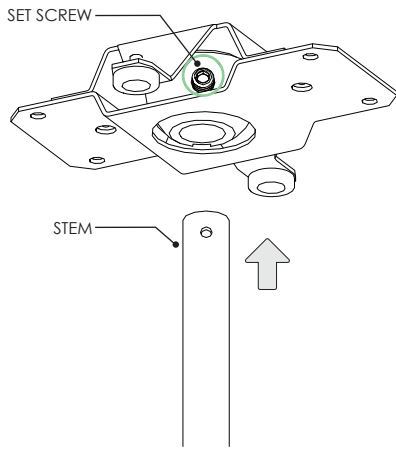

11

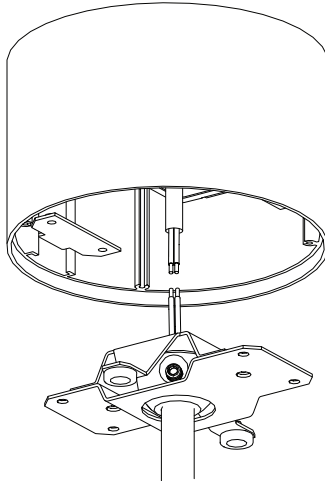

12

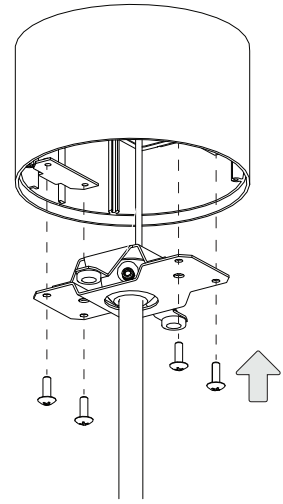

13

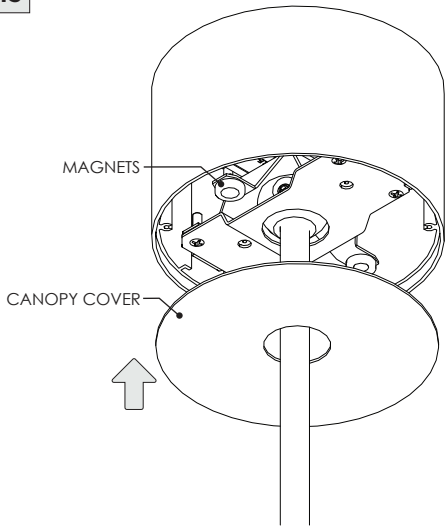

6B

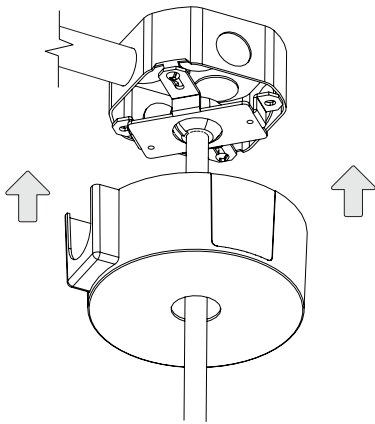

7

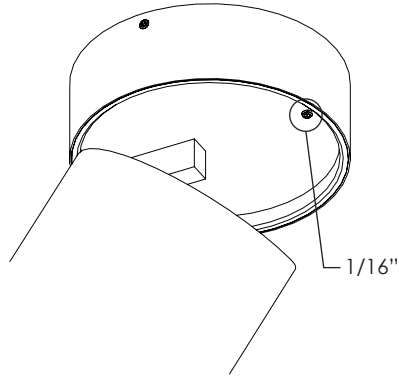

LOCK FIXTURE IN DESIRED POSITION WITH SET SCREW

8

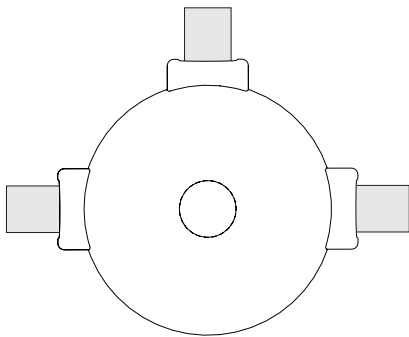
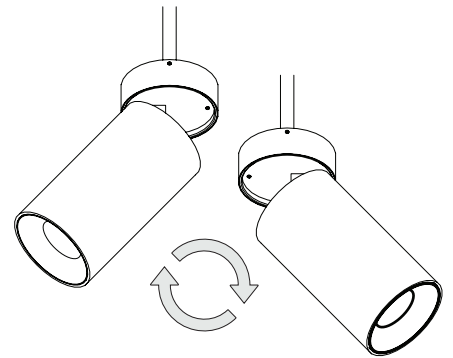

CANOPY IS SUITABLE FOR  
MAXIMUM 3 CONDUIT FEEDS

**DRIVER SERVICING**

1

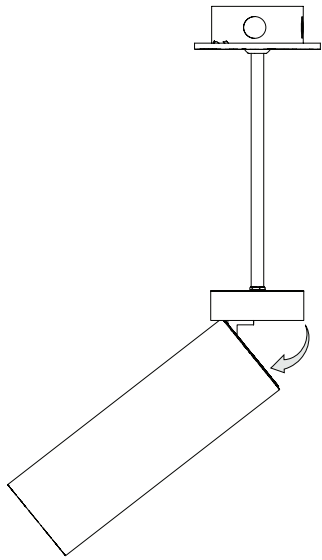

2

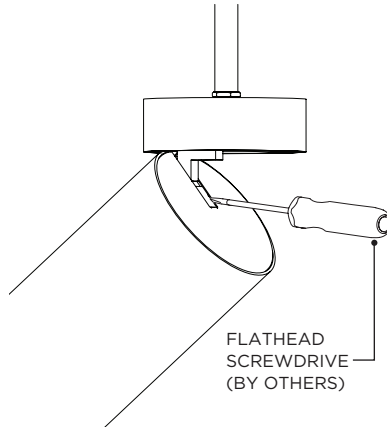

REMOVE MAGNETIC PLATE

3

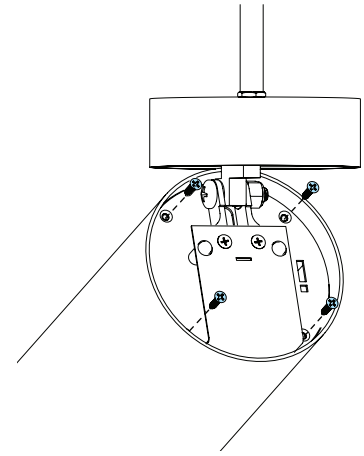

5

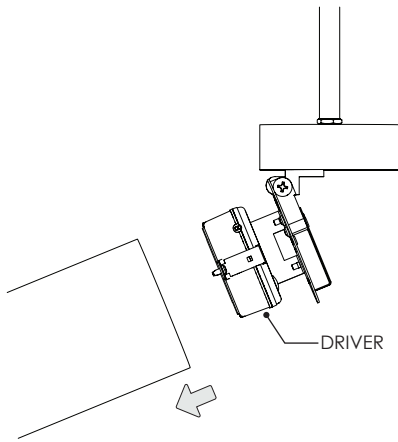

**LED SERVICING**

1

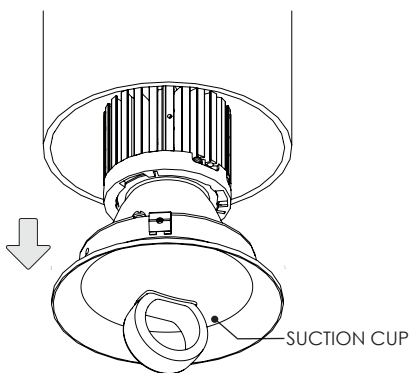

DISCONNECT LED WIRES AND REMOVE LED INSERT

2

