



**3.3" WALL WASH  
PENDANT**  
CABLE PENDANT MOUNT



**COMPONENTS**

**STANDARD CANOPY**

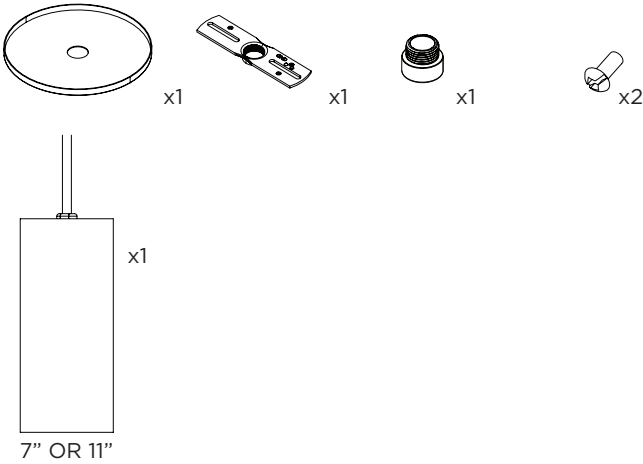

**CONDUIT FEED CANOPY**

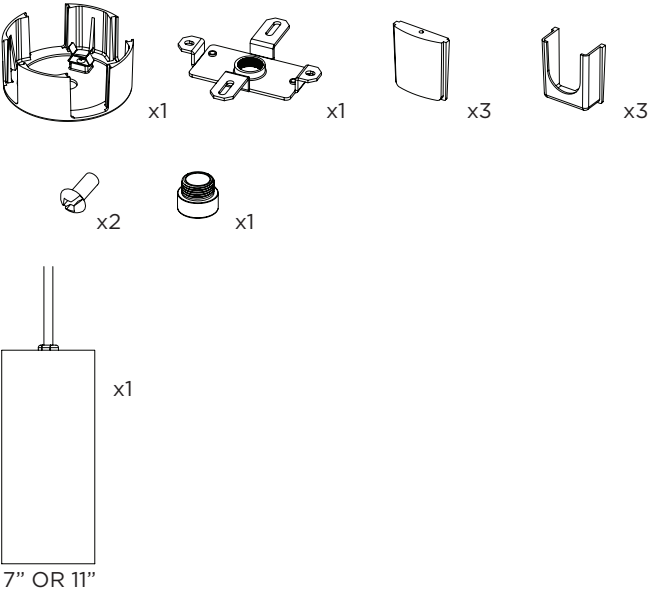

**4" OCTAGONAL J-BOX REQUIRED FOR INSTALLATION**

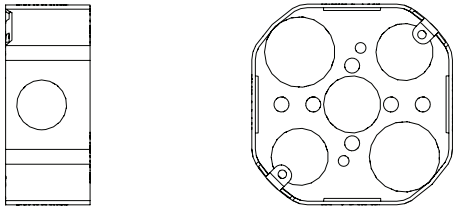

JUNCTION BOX (BY OTHERS)

**INSTRUCTION KEY**

**INFORMATION**

	ADDITIONAL	INSTALLATION SHOULD ONLY BE PERFORMED BY A CERTIFIED ELECTRICIAN
	ATTENTION	REFER TO LOCAL/NATIONAL CODES FOR PROPER INSTALLATION
	POWER ON	FAILURE TO FOLLOW INSTALLATION INSTRUCTION MAY VOID THE WARRANTY
	POWER OFF	DO NOT TOUCH LEDS. LEDS MUST BE PROTECTED FROM MECHANICAL STRESS OR DEBRIS
		TURN OFF POWER DURING INSTALLATION OR SERVICING

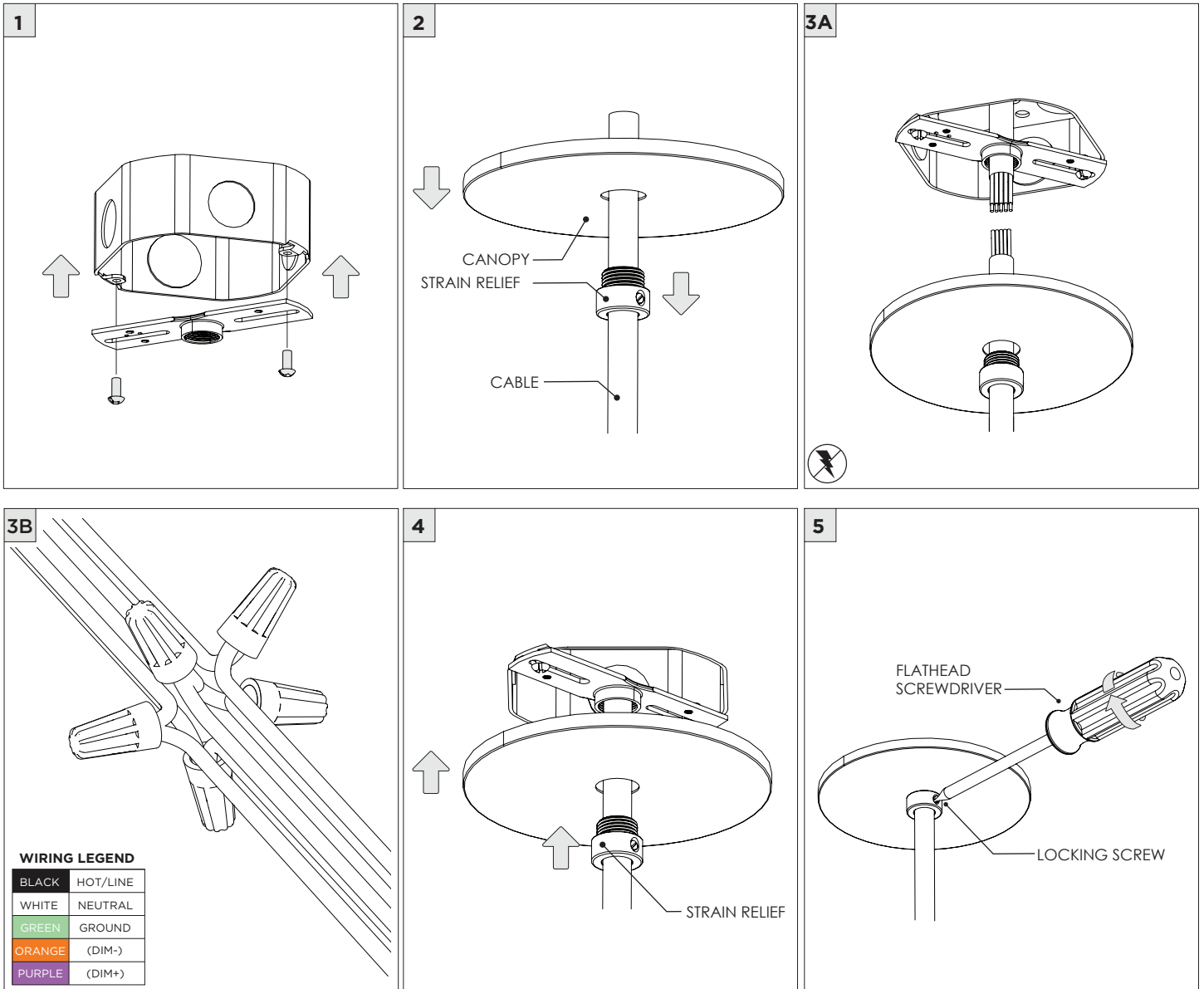

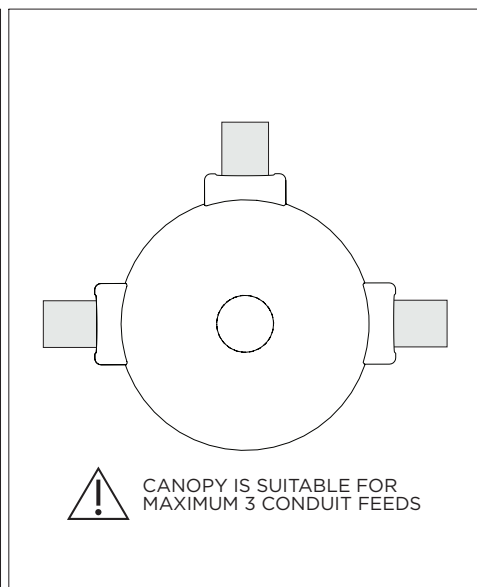
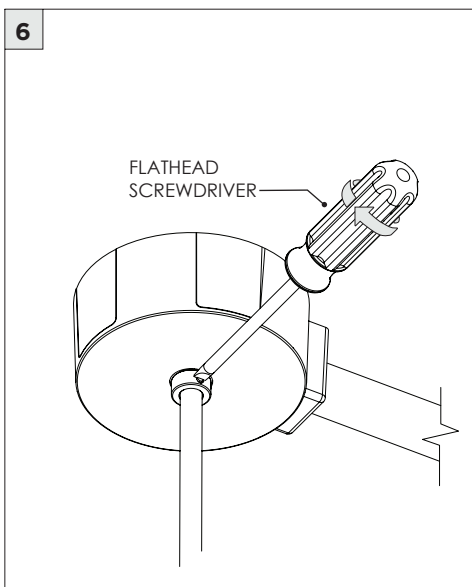
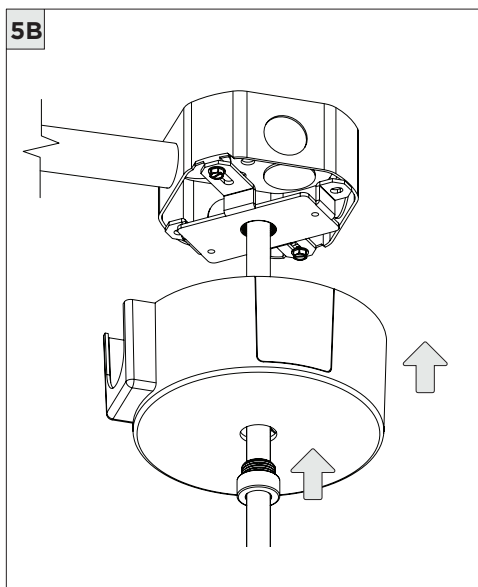
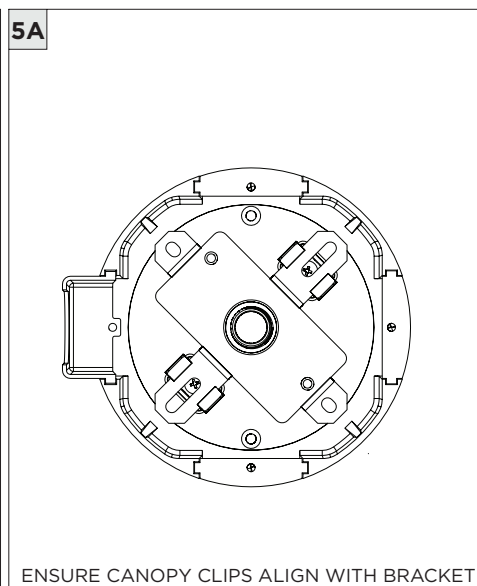
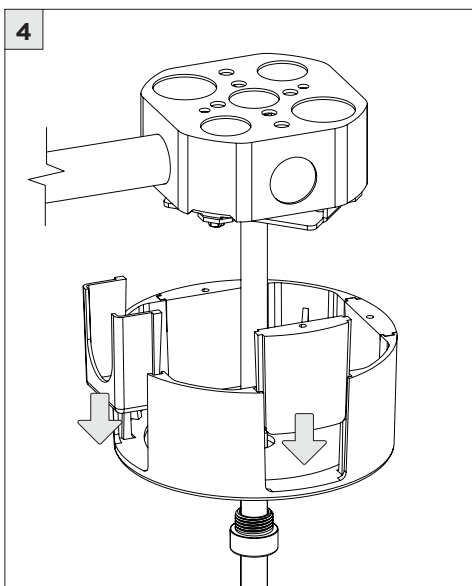
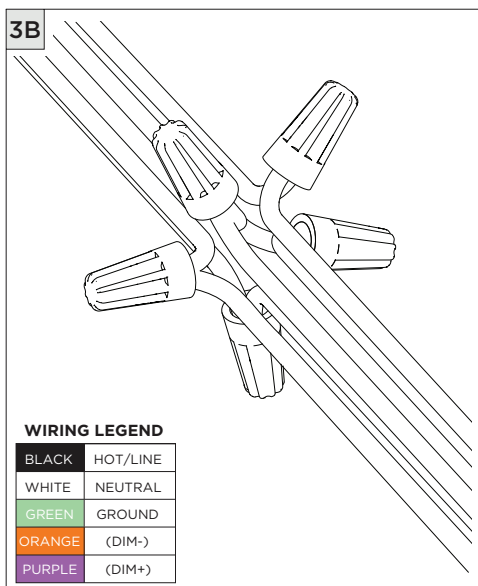
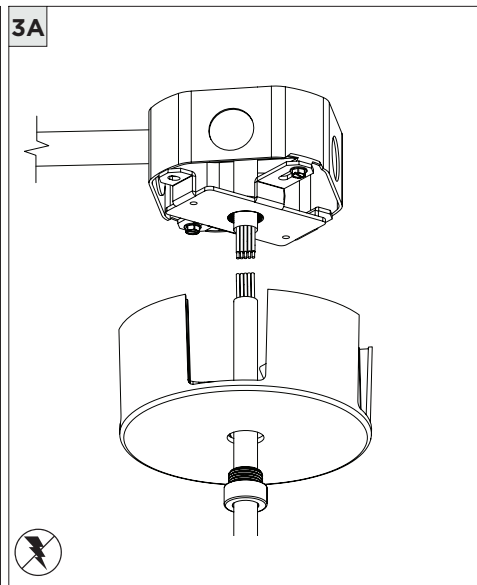
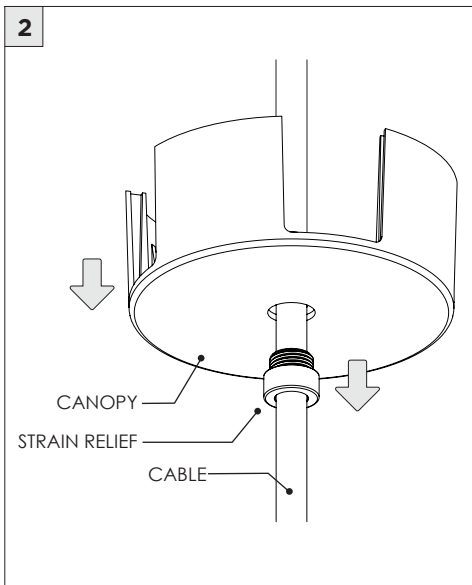
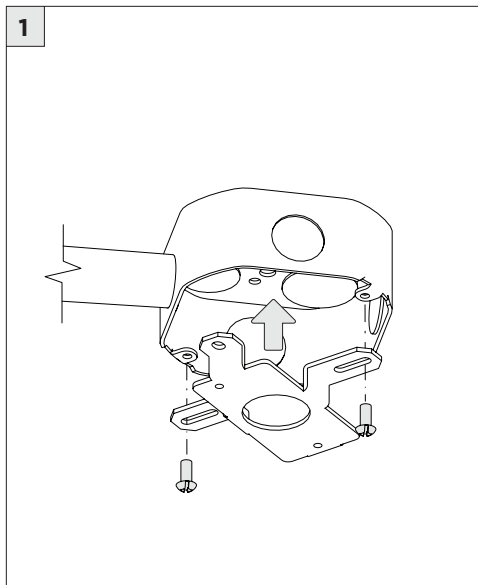

**DRIVER SERVICING**

1

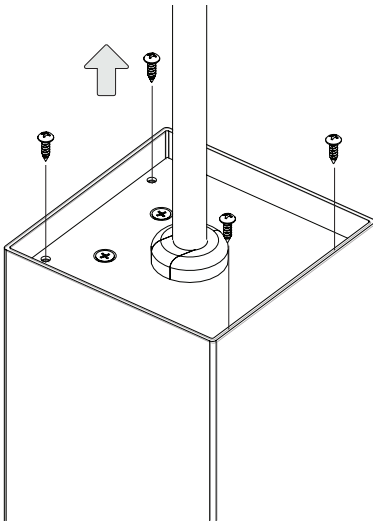

2

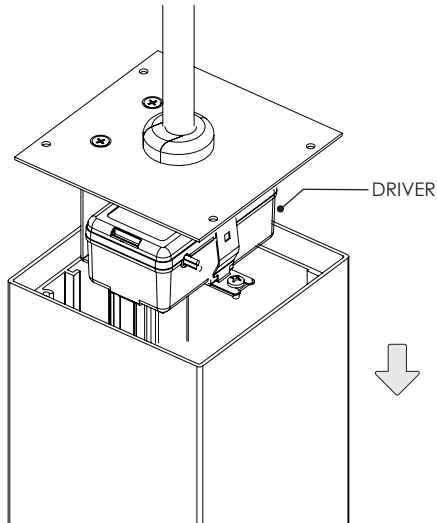

**LED SERVICING**

1

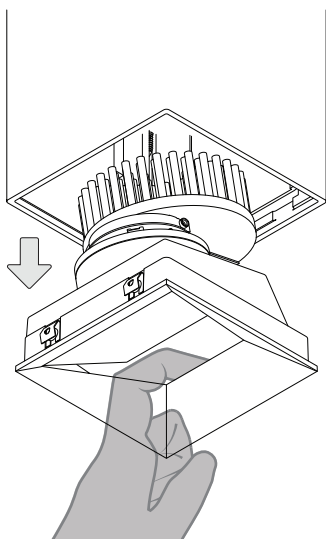

DISCONNECT LED WIRES AND REMOVE LED INSERT

2

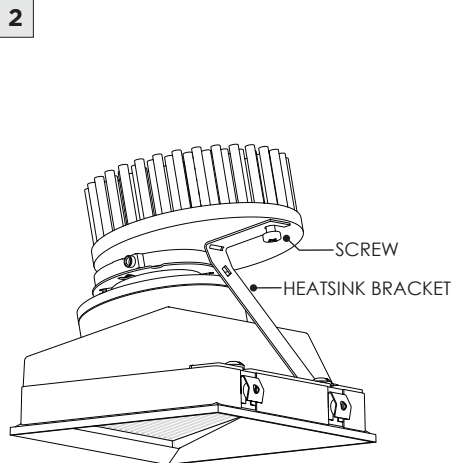

LOOSEN HEATSINK BRACKET SCREW

3

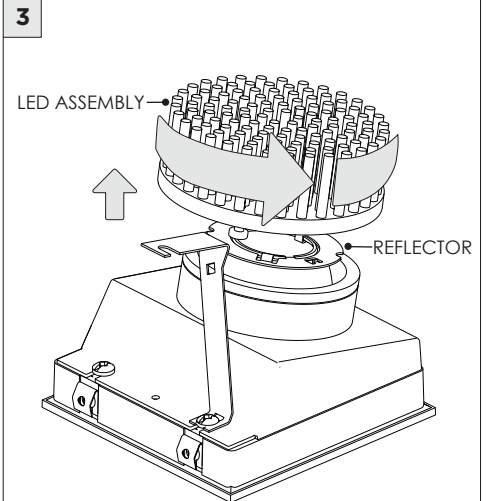

TWIST AND REMOVE LED ASSEMBLY  
FROM REFLECTOR