

3.3" WALL WASH CYLINDER

SURFACE MOUNT



COMPONENTS

STANDARD CANOPY

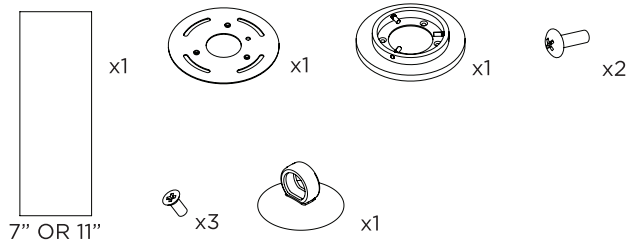

CONDUIT FEED CANOPY

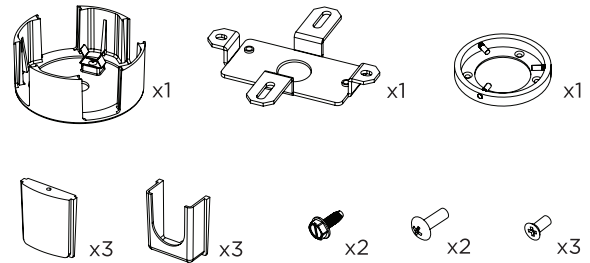

SEAMLESS CANOPY (FOR NEW CONSTRUCTION ONLY)

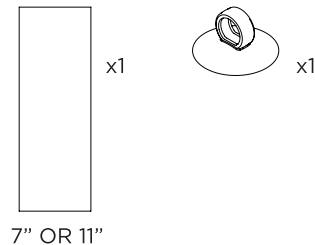
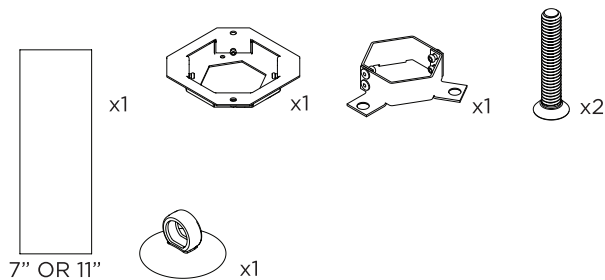

4" OCTAGONAL J-BOX REQUIRED FOR INSTALLATION

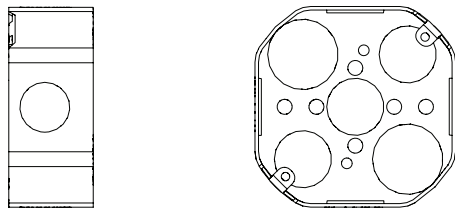

JUNCTION BOX (BY OTHERS)

INSTRUCTION KEY	INFORMATION
⚠️ ADDITIONAL	INSTALLATION SHOULD ONLY BE PERFORMED BY A CERTIFIED ELECTRICIAN
ⓘ ATTENTION	REFER TO LOCAL/NATIONAL CODES FOR PROPER INSTALLATION
⚡ POWER ON	FAILURE TO FOLLOW INSTALLATION INSTRUCTION MAY VOID THE WARRANTY
⚡ POWER OFF	DO NOT TOUCH LEDS. LEDS MUST BE PROTECTED FROM MECHANICAL STRESS OR DEBRIS
	TURN OFF POWER DURING INSTALLATION OR SERVICING

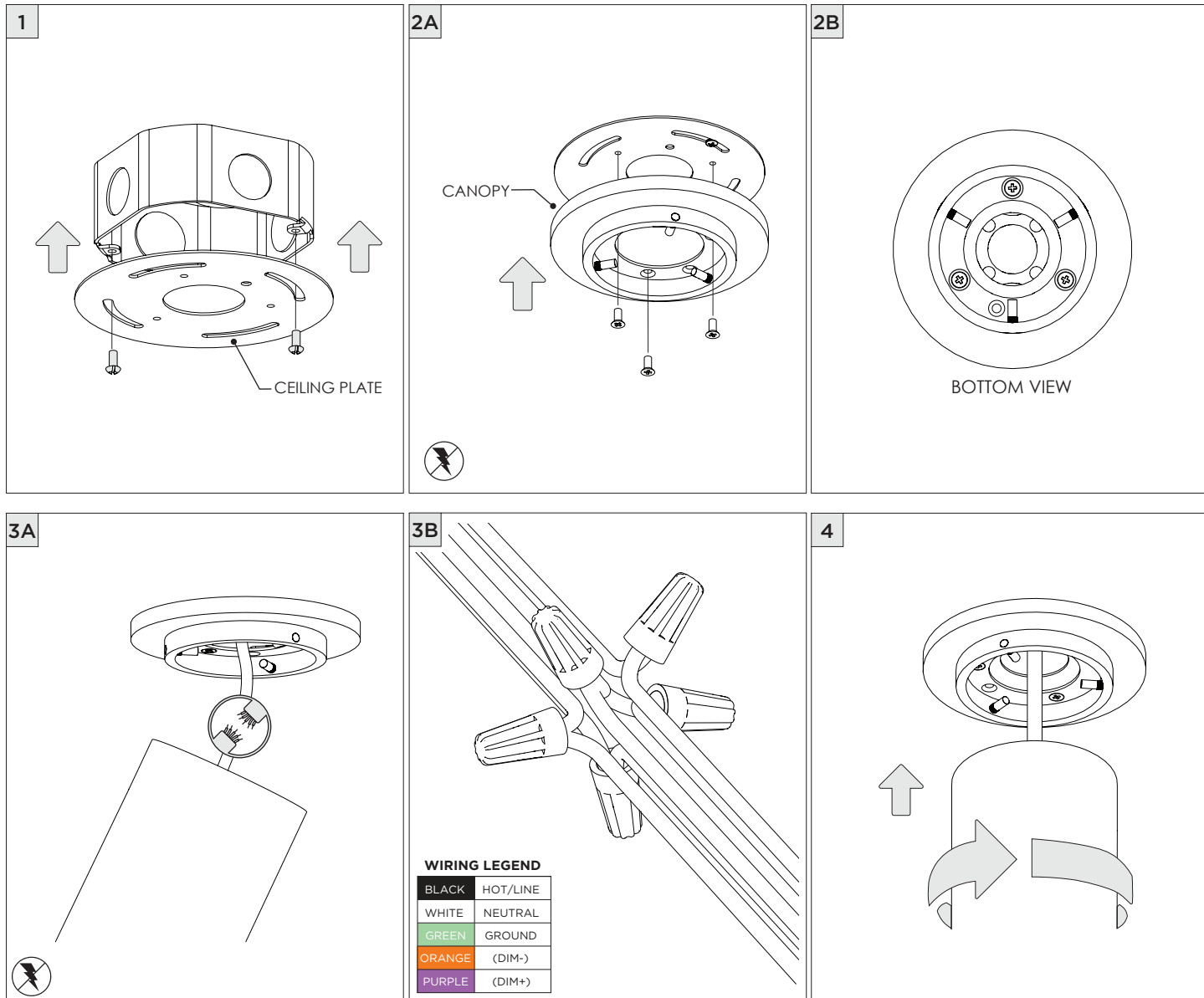

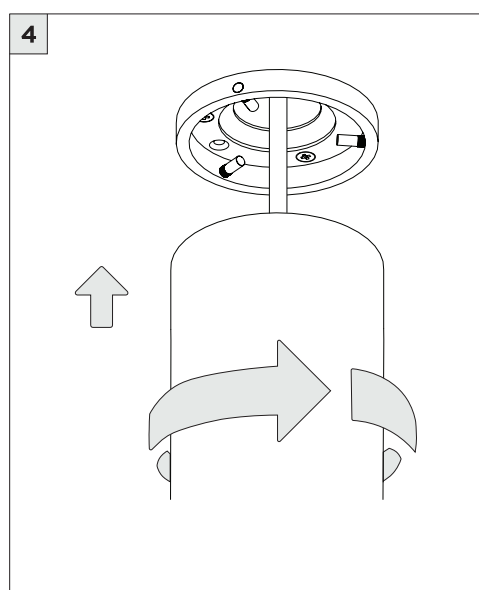
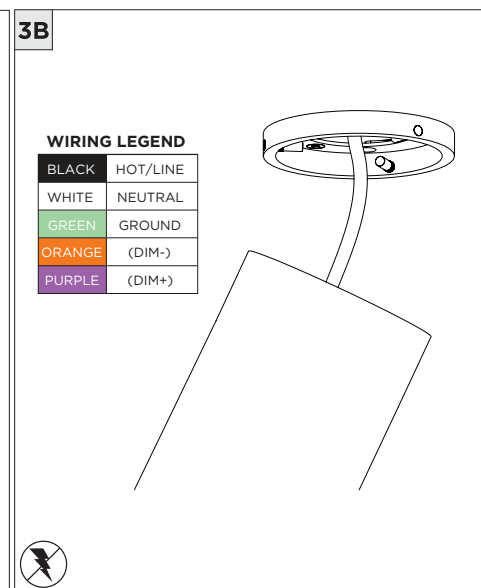
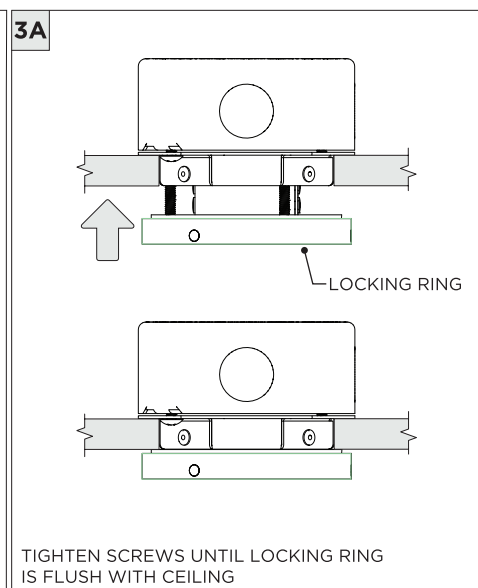
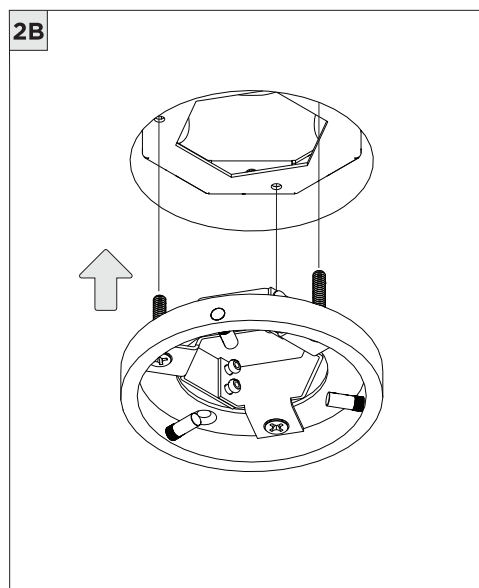
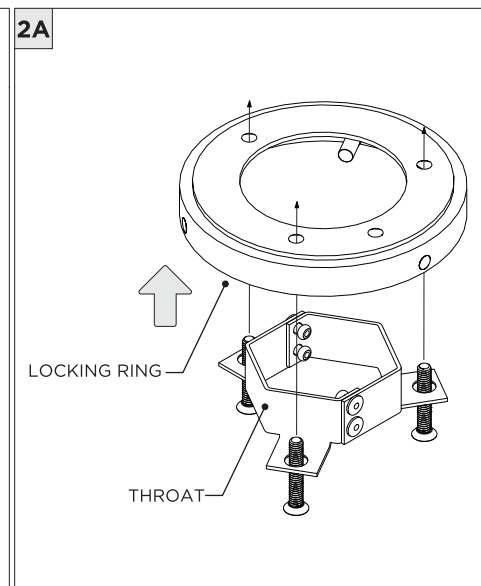
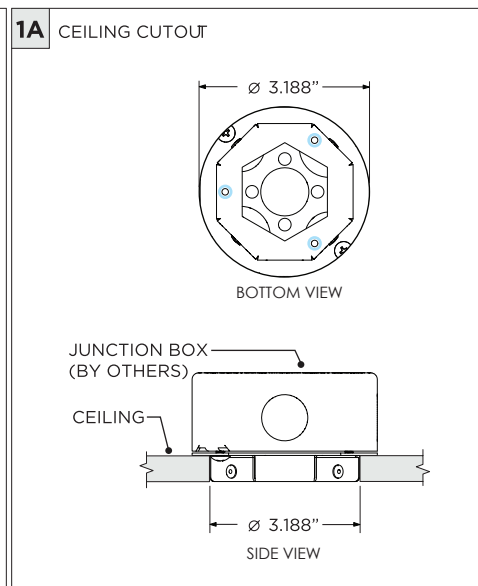
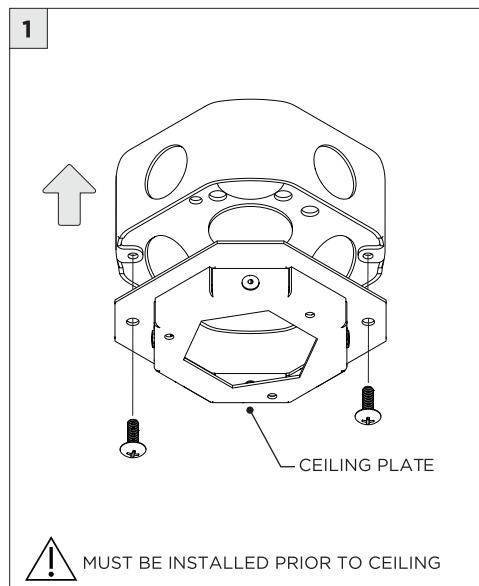

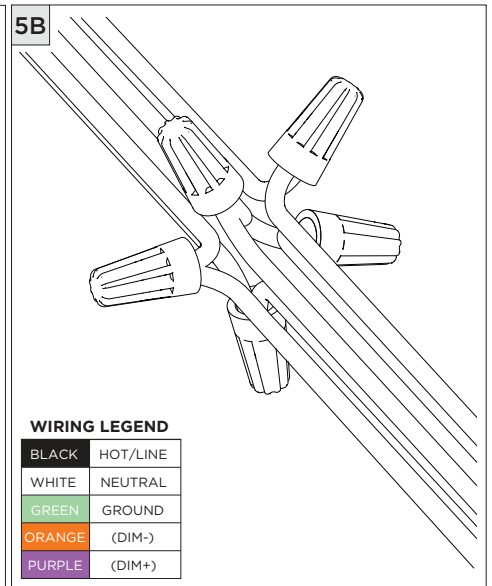
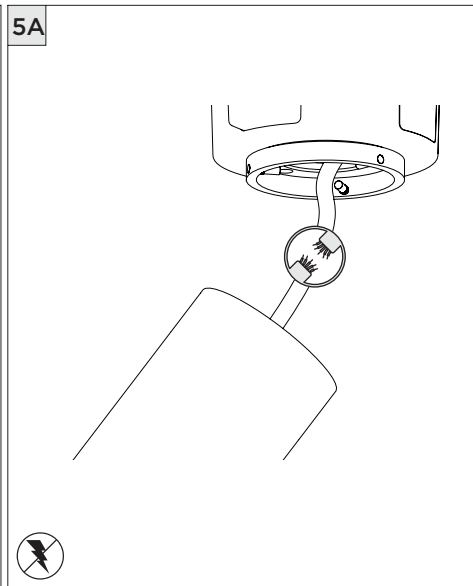
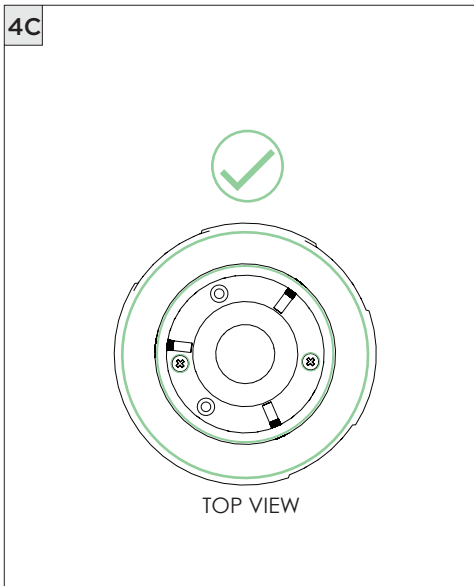
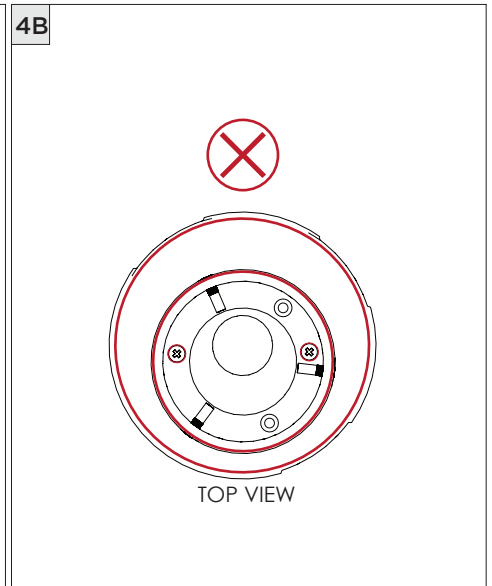
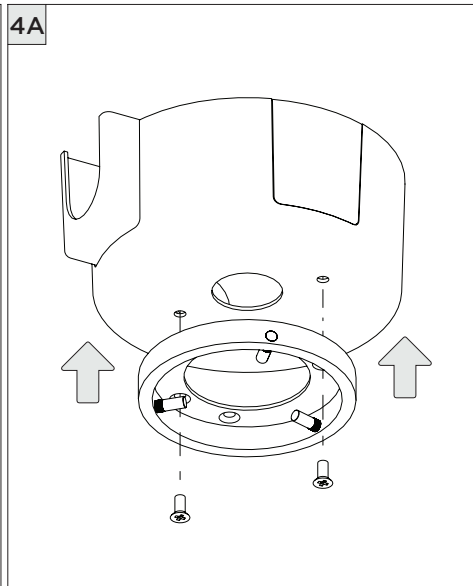
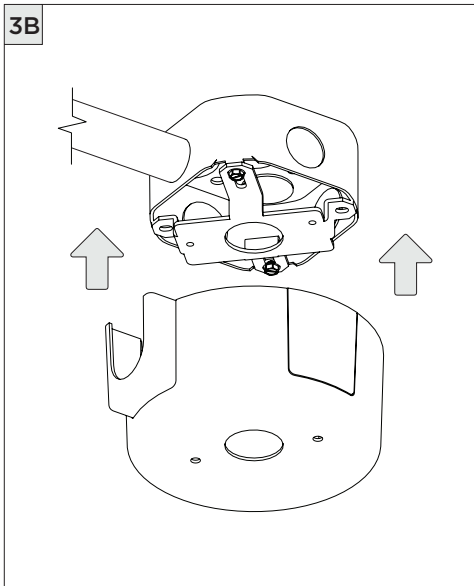
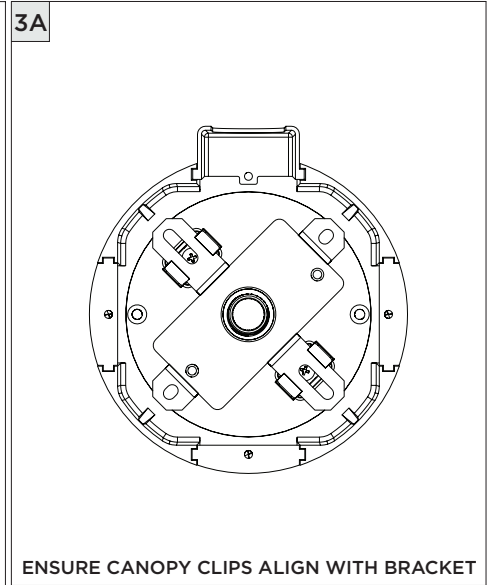
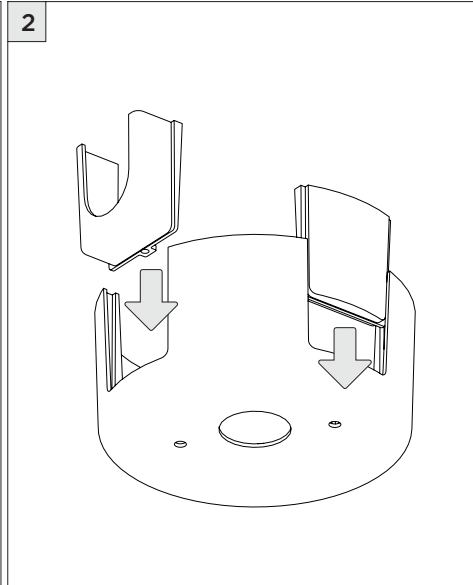
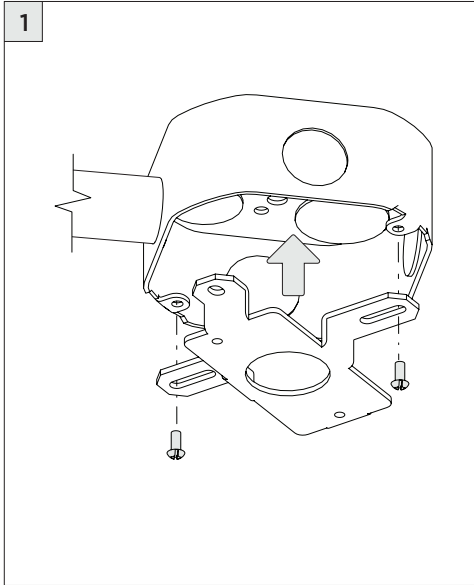

6

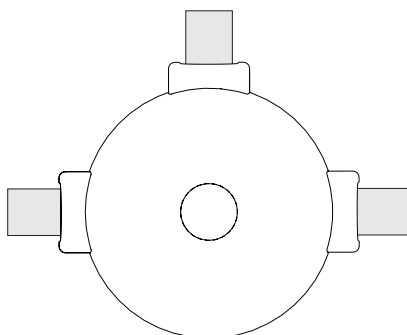
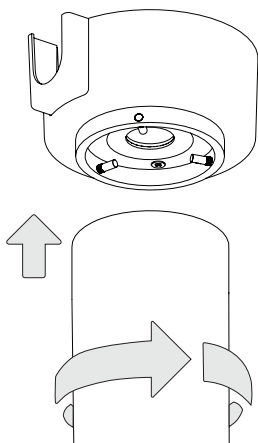

CANOPY IS SUITABLE FOR
MAXIMUM 3 CONDUIT FEEDS

DRIVER SERVICING

1

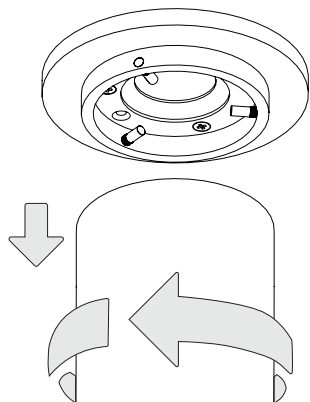

2

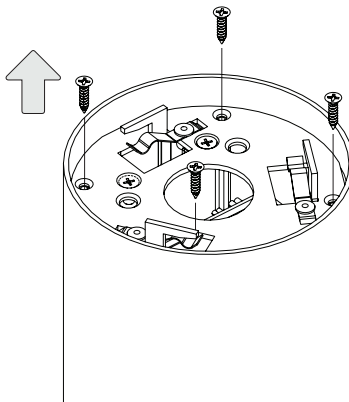

3

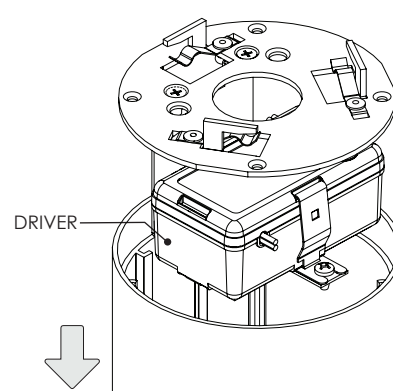

LED SERVICING

1

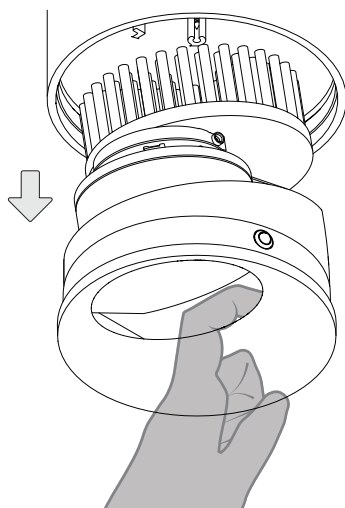

DISCONNECT LED WIRES AND REMOVE LED INSERT

2

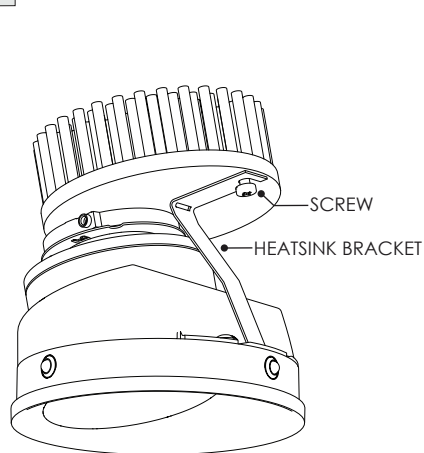

LOOSEN HEATSINK BRACKET SCREW

3

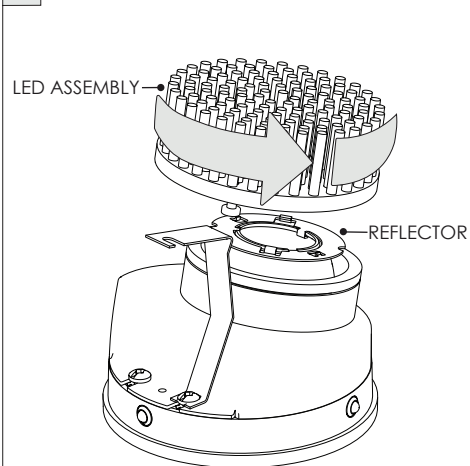

TWIST AND REMOVE LED ASSEMBLY
FROM REFLECTOR

DRIVER SERVICING

1

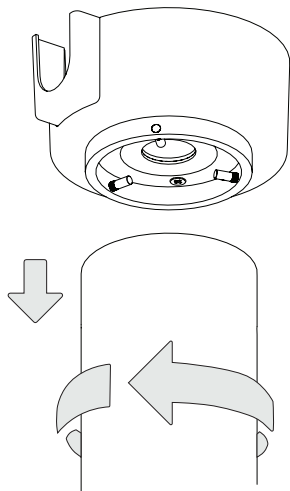

2

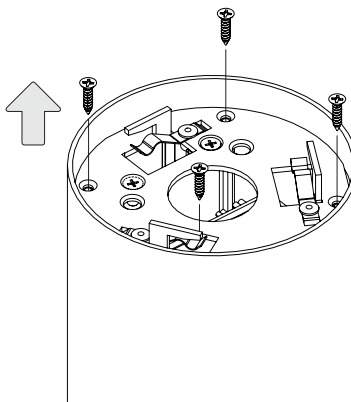

3

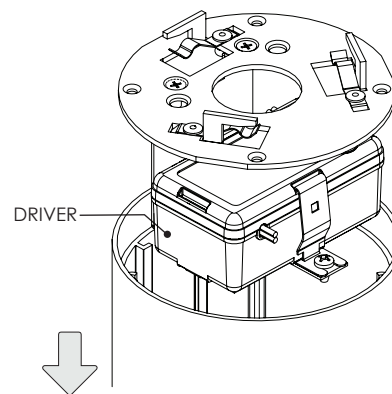

LED SERVICING

1

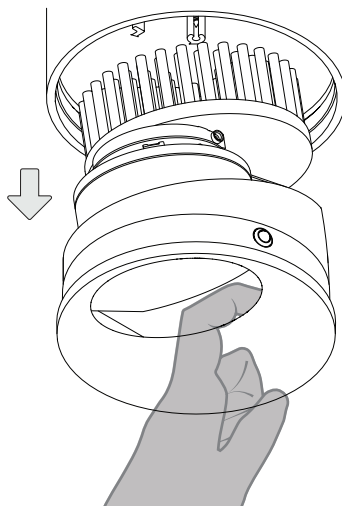

DISCONNECT LED WIRES AND REMOVE LED INSERT

2

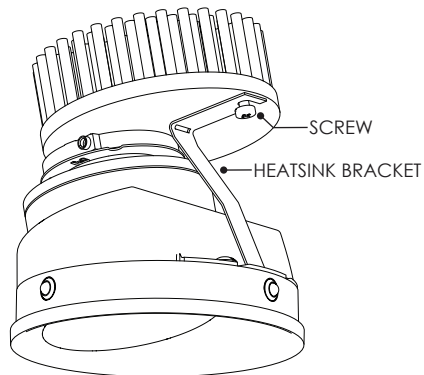

LOOSEN HEATSINK BRACKET SCREW

3

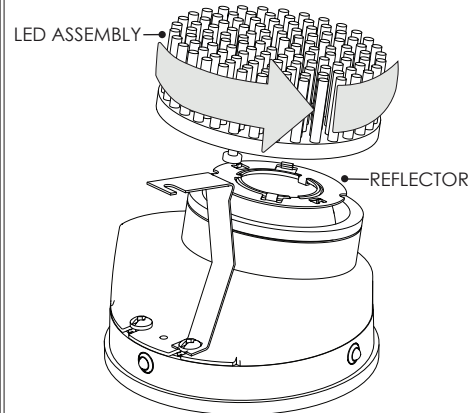

TWIST AND REMOVE LED ASSEMBLY
FROM REFLECTOR