



3Gi-58RSL, 3Gi-48RSL 5.8", and 4.8" INTEGRATED RECESSED SLOT GRID CEILING



⚠ FOR **NEW CONSTRUCTION** INSTALLATION ONLY

ℹ THE IMAGES SHOWN ARE FOR ILLUSTRATION PURPOSES ONLY AND MAY NOT BE AN EXACT REPRESENTATION OF THE PRODUCT

FIXTURE TYPES		INCLUDED COMPONENTS				
58RSL PROFILE	48RSL PROFILE					
ILLUMINATED OPTIONS		INTEGRATED MECHANICAL OPTIONS				
DL33R - 3.3" ROUND DOWNLIGHT	DL33S - 3.3" SQUARE DOWNLIGHT	DZ33R - 3.3" ROUND ZOIE	DZ33S - 3.3" SQUARE ZOIE	CM - CAMERA	SP - SPEAKER	OS - OCCUPANCY SENSOR
M7 - MADISON DUAL AXIS	4LI - 3.5" LINIA	2LI - 2" LINIA		WF - WIFI ACCESS POINT	MC - MICROPHONE	
				HV - HVAC	SD - SMOKE DETECTOR	ST - FIRE STROBE
					FS - FIRE SPRINKLER	JB - JUNCTION BOX

INSTRUCTION KEY	INFORMATION
⚠	ADDITIONAL
ℹ	ATTENTION
⚡	POWER ON
⏻	POWER OFF
	INSTALLATION SHOULD ONLY BE PERFORMED BY A CERTIFIED ELECTRICIAN REFER TO LOCAL/NATIONAL CODES FOR PROPER INSTALLATION FAILURE TO FOLLOW INSTALLATION INSTRUCTION MAY VOID THE WARRANTY DO NOT TOUCH LEDS. LEDS MUST BE PROTECTED FROM MECHANICAL STRESS OR DEBRIS TURN OFF POWER DURING INSTALLATION OR SERVICING

OVERVIEW

GRID CEILING

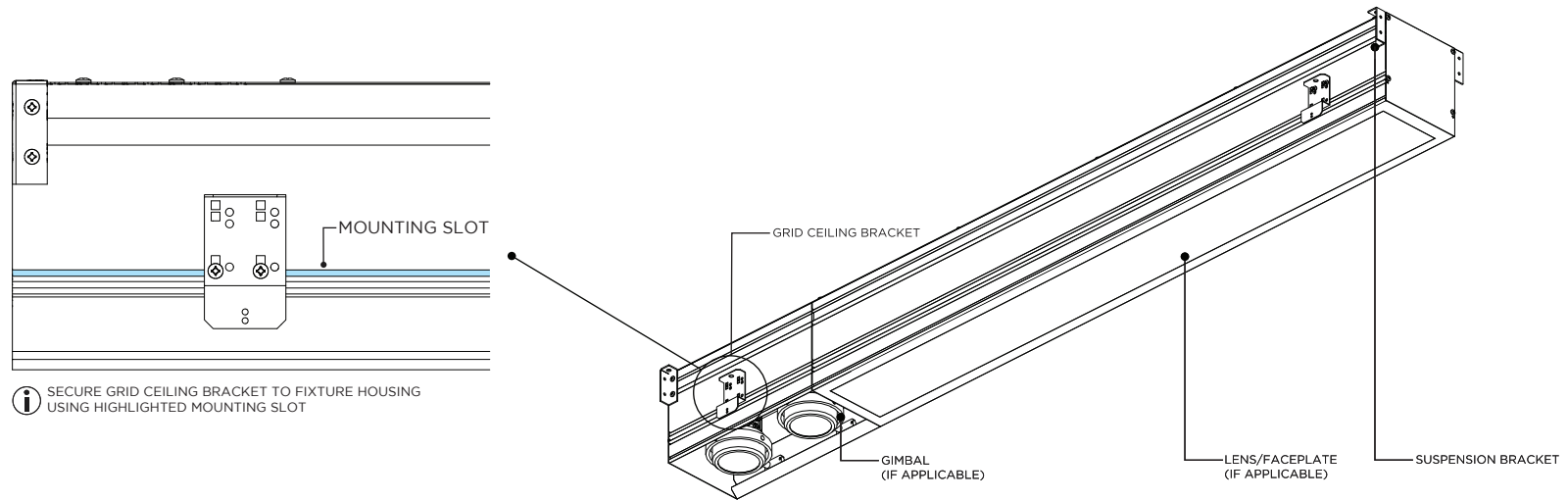

i SECURE GRID CEILING BRACKET TO FIXTURE HOUSING USING HIGHLIGHTED MOUNTING SLOT

i ALL INTEGRATED MECHANICAL OPTIONS ARE PROVIDED AS 6" SECTIONS

GRID CEILING MOUNTING BRACKET

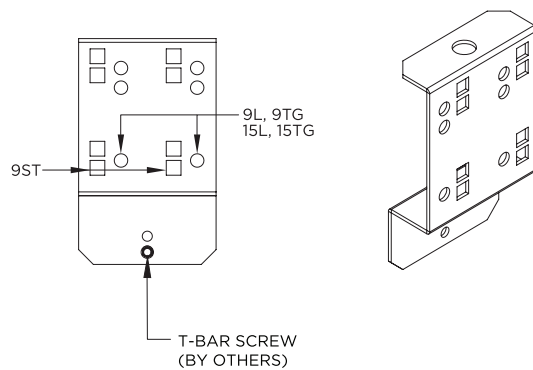

i UNIVERSAL MOUNTING BRACKET FOR ALL GRID CEILING TYPES

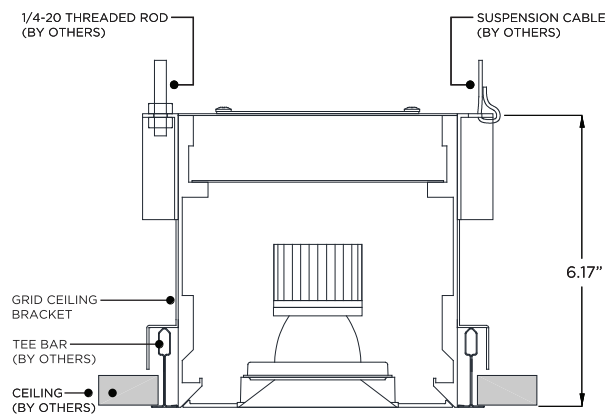

ASYMMETRIC LENS ORIENTATION

3Gi-2" LINEAR - ASYMMETRIC LENS/REFLECTOR ORIENTATION

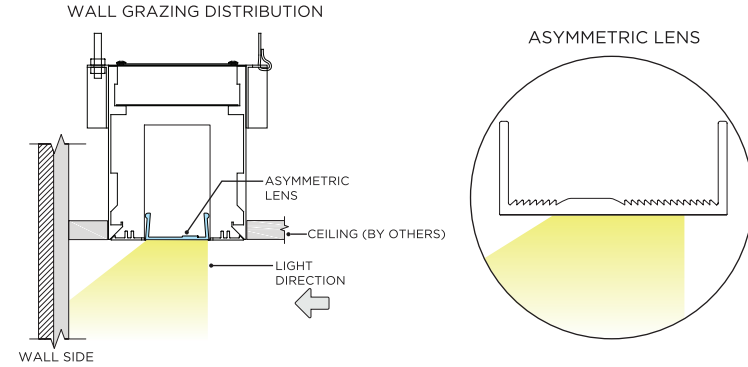
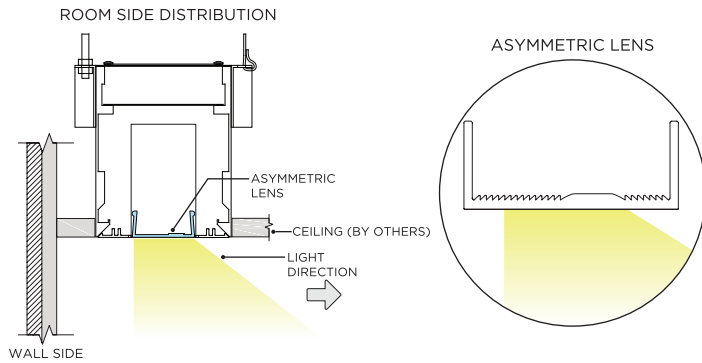

3Gi-4" LINEAR - ASYMMETRIC LENS/REFLECTOR ORIENTATION

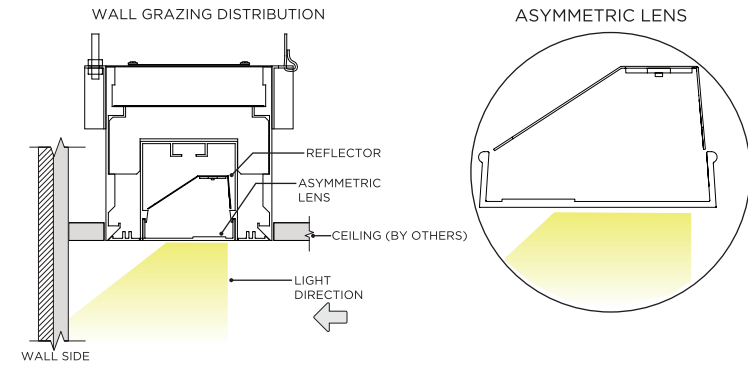
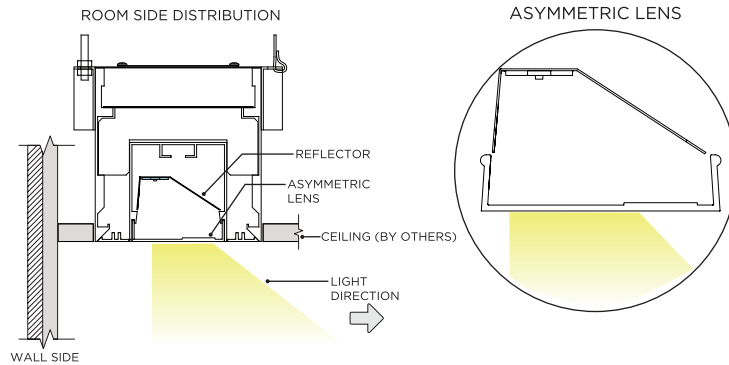

THREADED ROD LOCATION

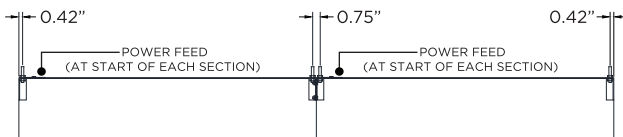

IDENTIFICATION AND PREPARATION

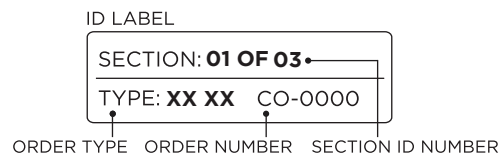

i IDENTIFY FIXTURE SECTIONS BY THE ID LABELS FOUND ON THE BOX INSIDE THE SECTIONS

ID LABEL

SECTION: 01 OF 03
TYPE: XX XX CO-0000

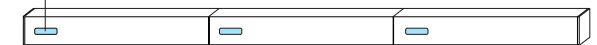

OVERVIEW

3Gi-58RSL

9L - 9/16" LAYIN

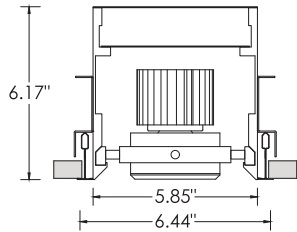

9TG - 9/16" TEGULAR

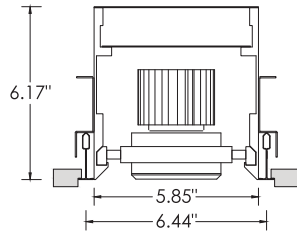

15L - 15/16" LAYIN

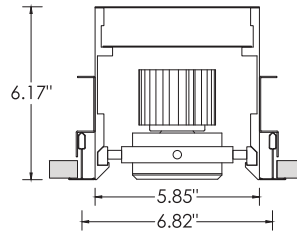

15TG - 15/16" TEGULAR

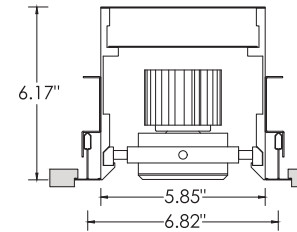

9ST - 9/16" SLOT TEE
TEGULAR

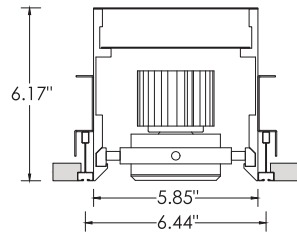

6TZ - TECHZONE

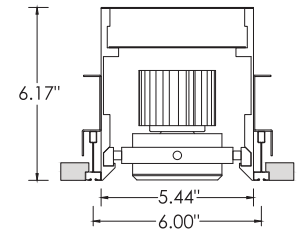

3Gi-48RSL

9L - 9/16" LAYIN

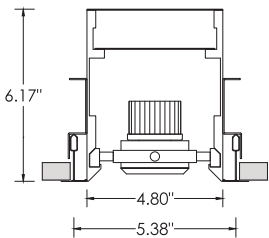

9TG - 9/16" TEGULAR

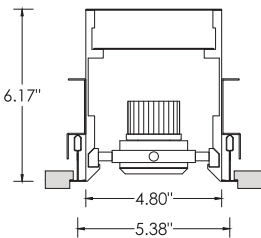

15L - 15/16" LAYIN

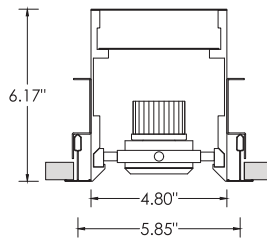

15TG - 15/16" TEGULAR

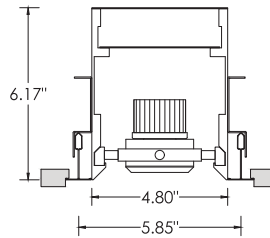

9ST - 9/16" SLOT TEE
TEGULAR

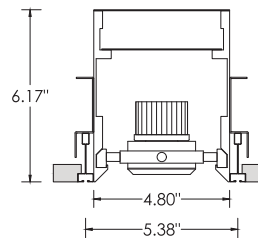

1 INTEGRATED MECHANICAL COMPONENTS



i ALL INTEGRATED MECHANICAL COMPONENTS ARE NOT INSTALLED BY 3G

2 MICROPHONE SHOWN AS EXAMPLE

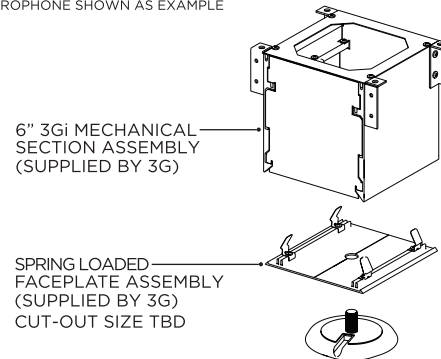

UNCLIP FACEPLATE FROM HOUSING TO ACCESS INSIDE OF HOUSING SECTION

INTEGRATED HVAC

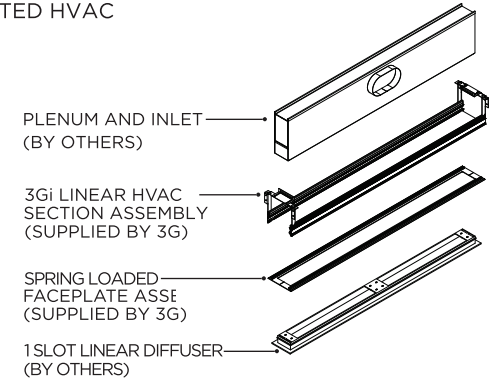

i ALL INTEGRATED HVAC COMPONENTS ARE NOT INSTALLED BY 3G

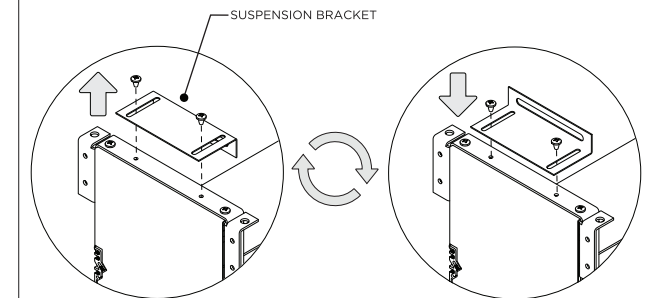

! HVAC SUSPENSION BRACKET IS SHIPPED **UPSIDE DOWN**
FLIP BRACKET ORIENTATION BEFORE HVAC INSTALLATION

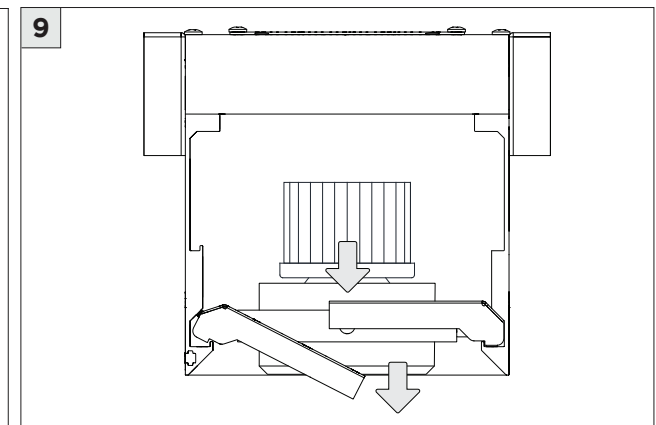
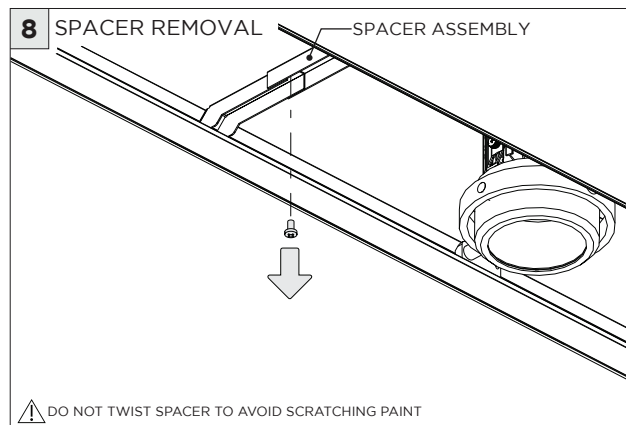
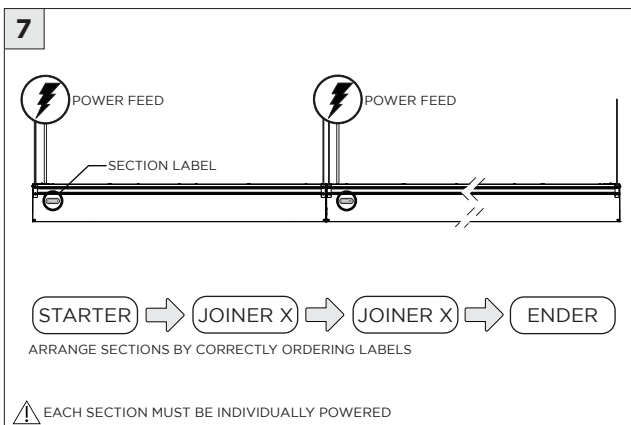
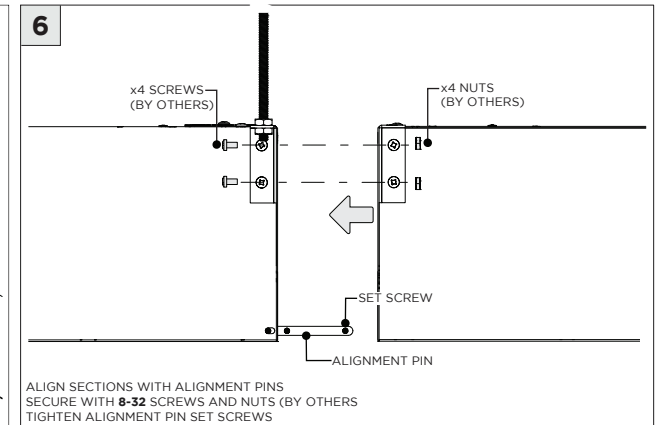
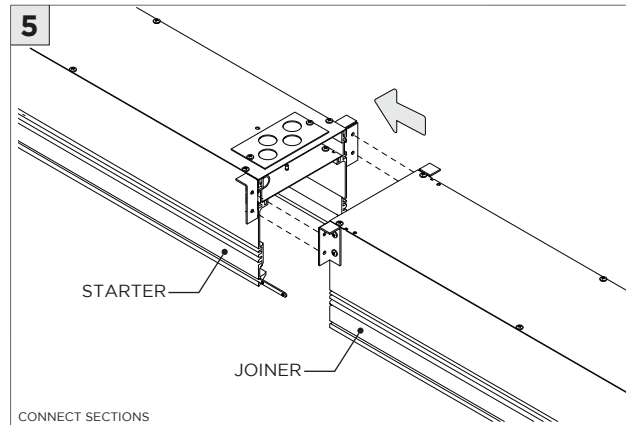
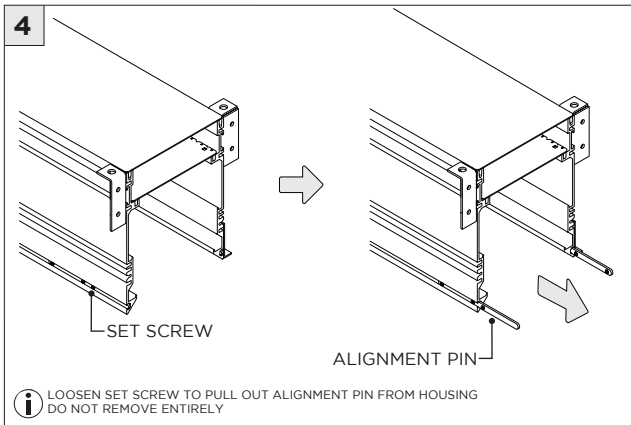
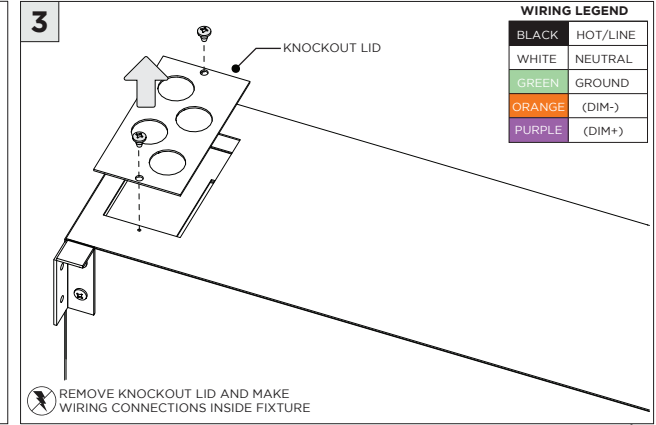
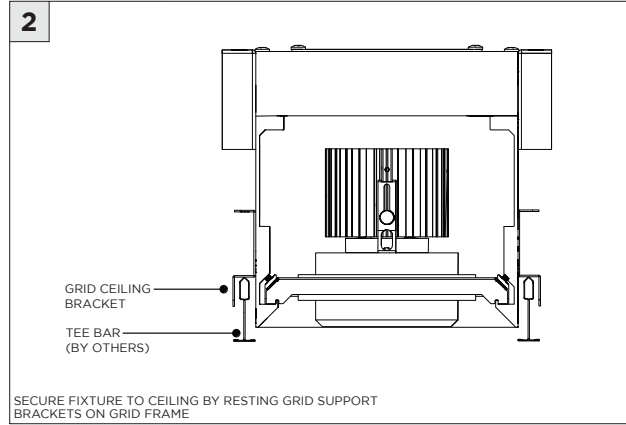
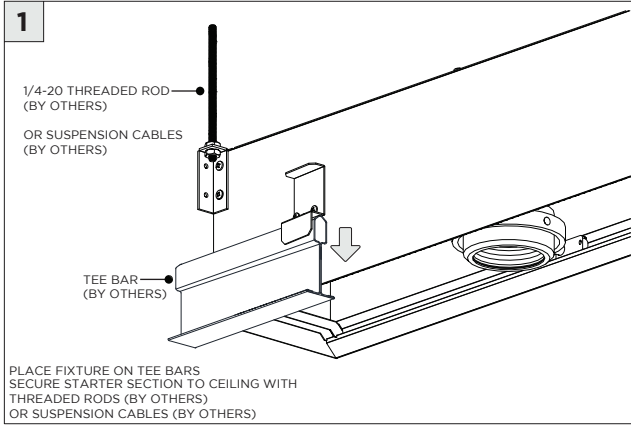

LED SERVICING - GIMBAL

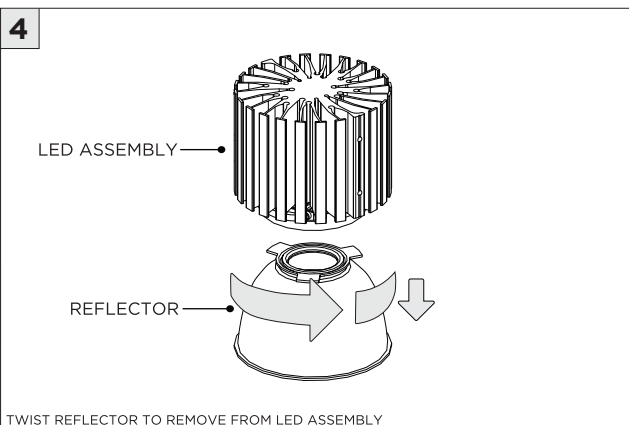
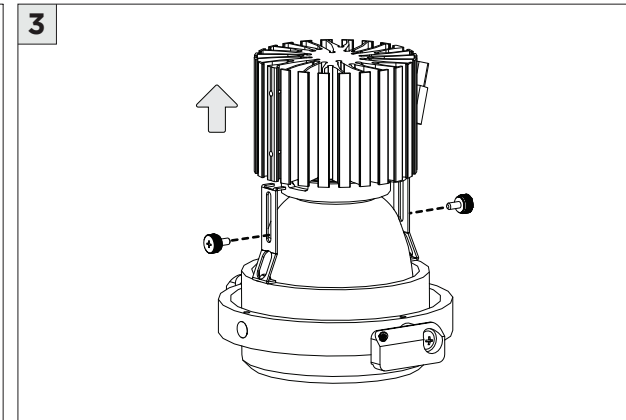
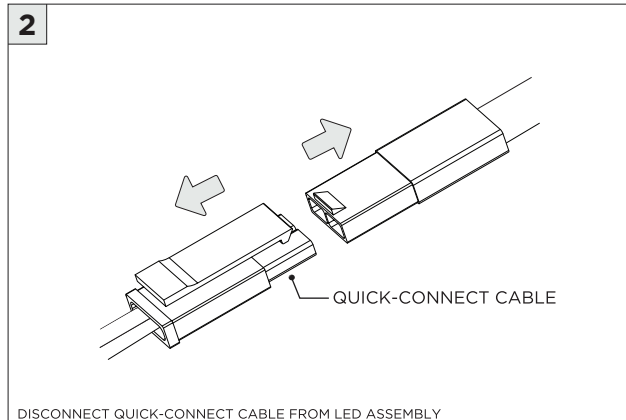
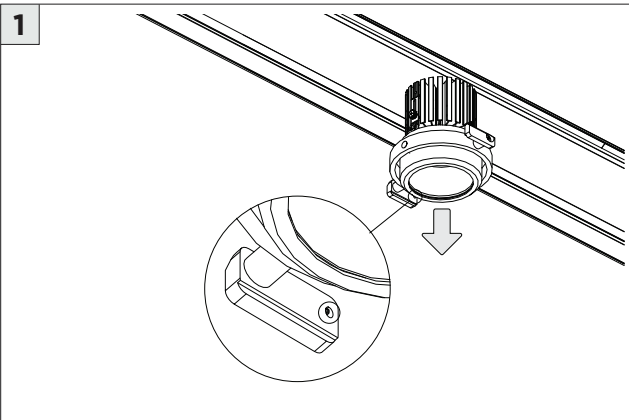

DL33RA - ADJUSTING DOWNLIGHT ANGLE

1

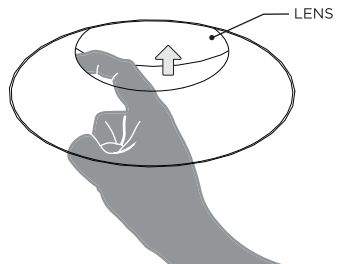

LIFT LENS AND DETATCH INSERT FROM LED ASSEMBLY

2

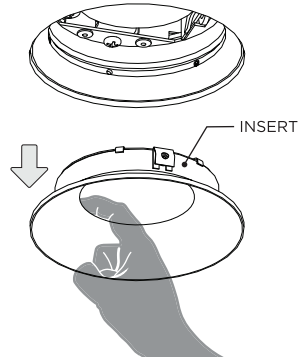

3

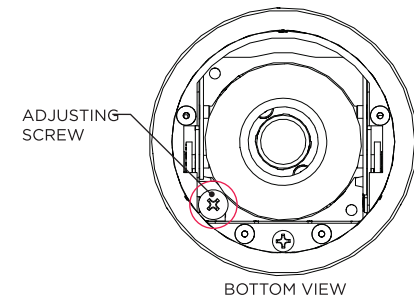

4

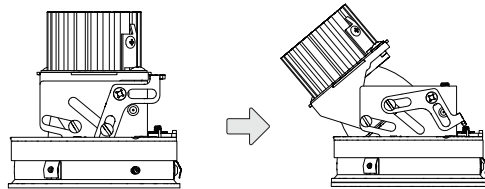

DL33SA - ADJUSTING DOWNLIGHT ANGLE

1

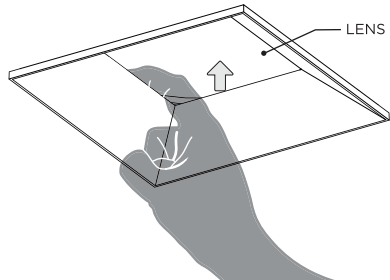

LIFT LENS AND DETATCH INSERT FROM ADAPTER RING

2

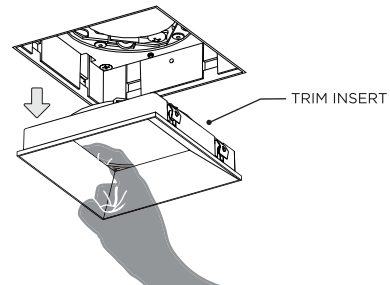

3

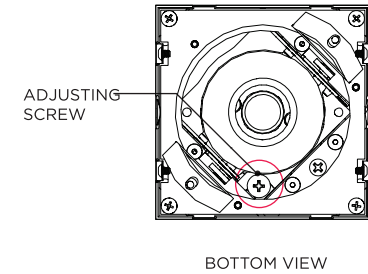

4

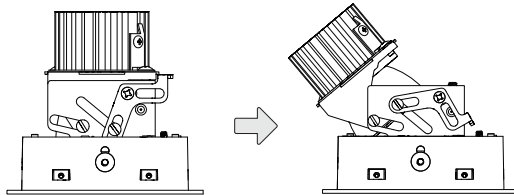

LED SERVICING - DL33R

1

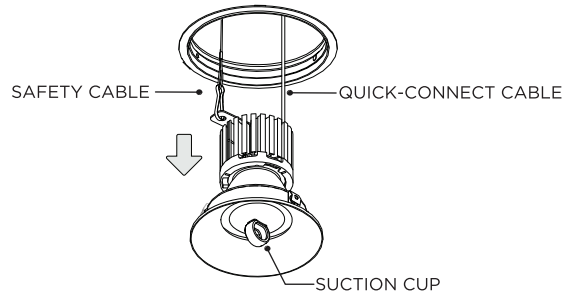

REMOVE LED ASSEMBLY FROM CEILING

2

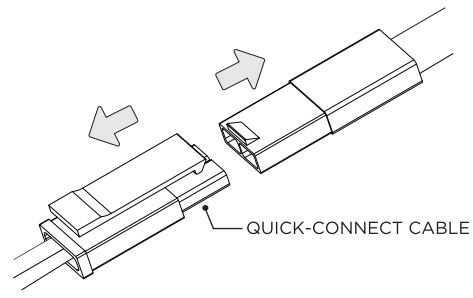

DISCONNECT SAFETY CABLE & QUICK-CONNECT CABLE FROM LED ASSEMBLY

3

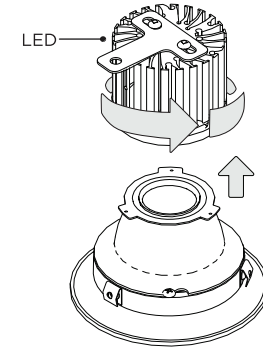

4 FOR DL45

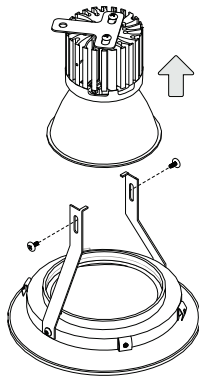

LED SERVICING - DL33RA

1

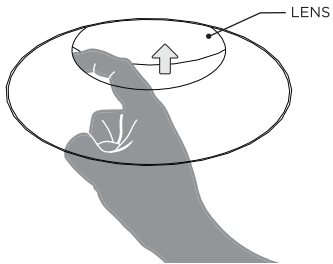

LIFT LENS AND DETATCH INSERT FROM LED ASSEMBLY

2

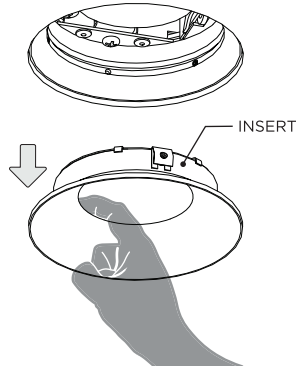

3

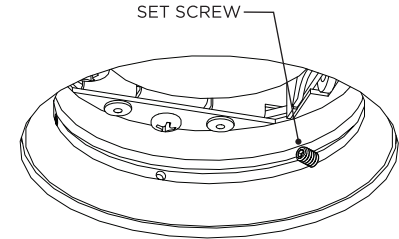

LOOSEN THREE SET SCREWS INSIDE ADAPTER RING

⚠ DO NOT FULLY REMOVE SET SCREWS
FROM ADAPTER RING

4

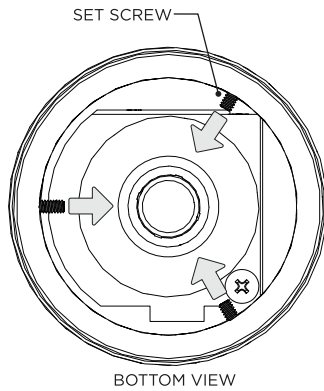

BOTTOM VIEW

5

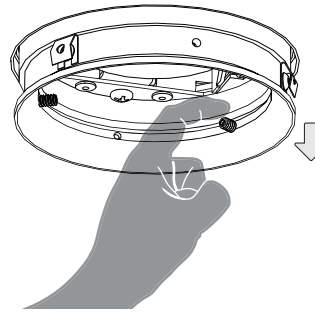

UNCLIP ADAPTER RING FROM CEILING BY PULLING DOWN ON EACH SET SCREW

6

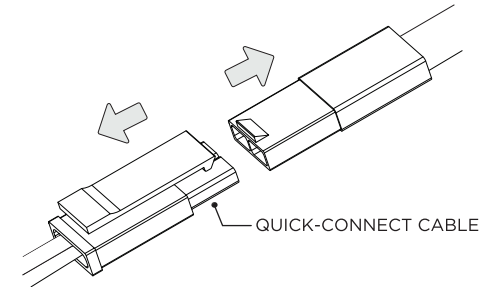

DISCONNECT QUICK-CONNECT CABLE FROM LED ASSEMBLY

7

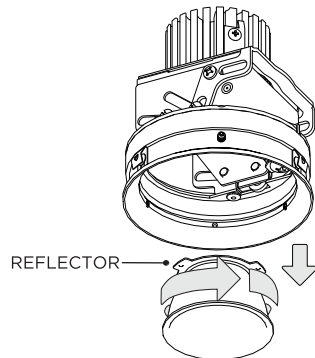

TWIST REFLECTOR TO REMOVE

8

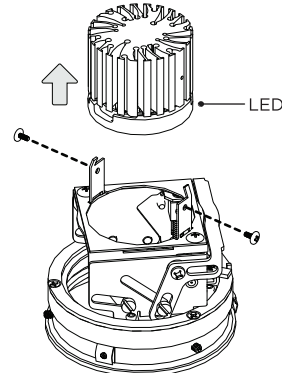

LED SERVICING - DL33S

1

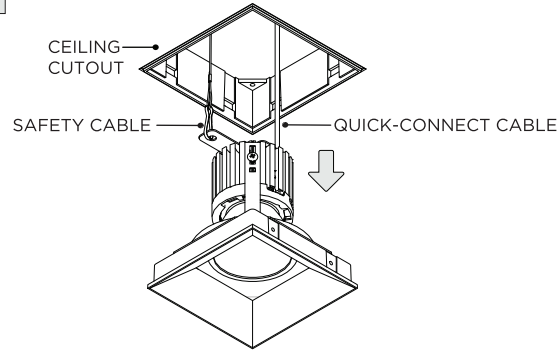

REMOVE LED ASSEMBLY FROM CEILING

2

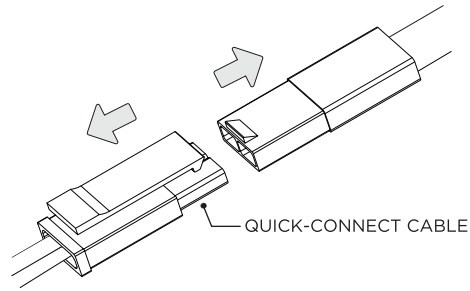

DISCONNECT SAFETY CABLE & QUICK-CONNECT CABLE FROM LED ASSEMBLY

3

FOR DL33/DL45

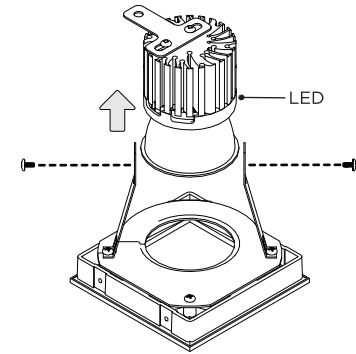

LED SERVICING - DL33SA

1

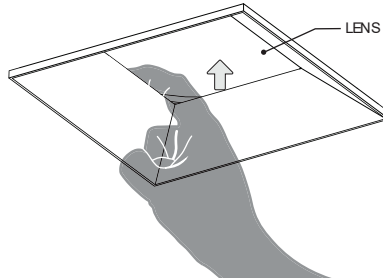

LIFT LENS AND DETACH INSERT FROM ADAPTER RING

2

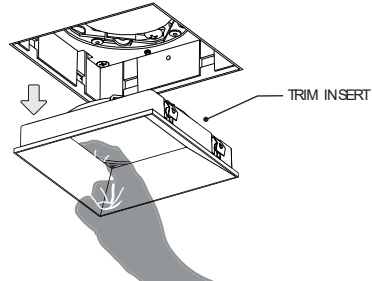

3

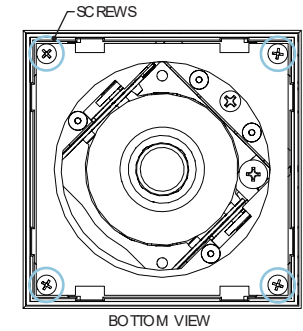

REMOVE 4 SCREWS TO DETACH LED ASSEMBLY FROM CEILING

4

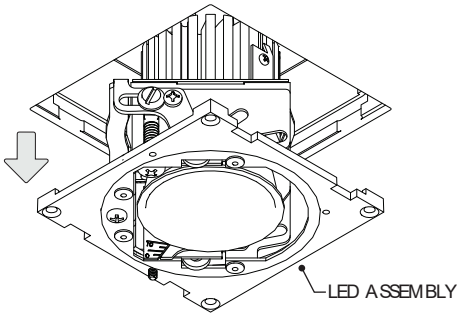

5

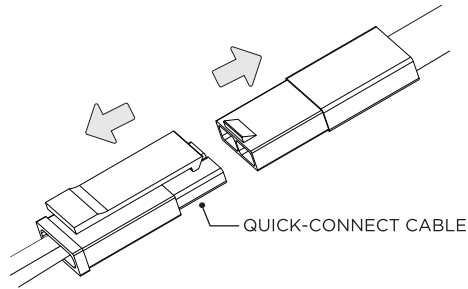

DISCONNECT QUICK-CONNECT CABLE FROM LED ASSEMBLY

6

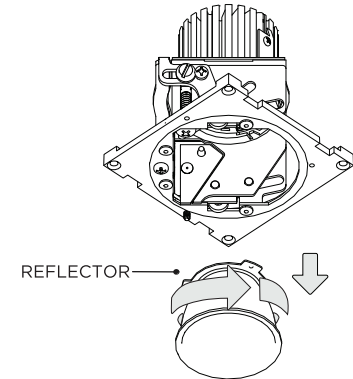

TWIST REFLECTOR TO REMOVE

7

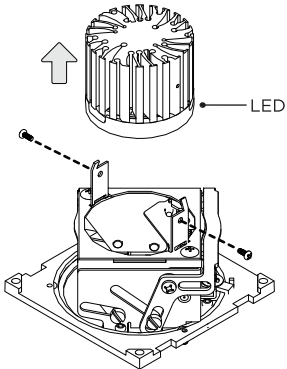

LED SERVICING - DZ33R

1

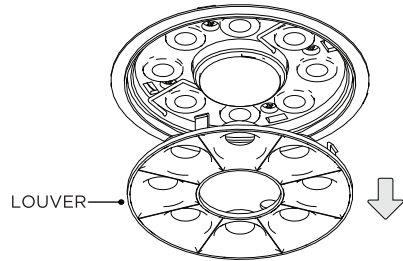

UNCLIP LOUVER FROM LED ASSEMBLY

2

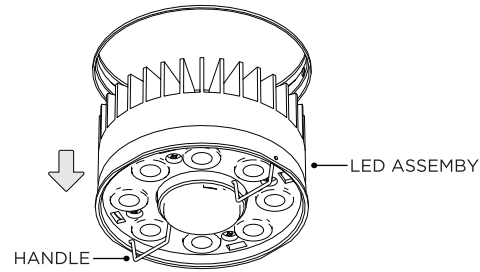

PULL DOWN ON HANDLES TO UNCLIP LED ASSEMBLY FROM CEILING

3

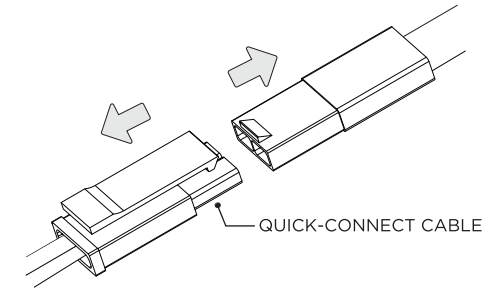

DISCONNECT QUICK-CONNECT CABLE FROM LED ASSEMBLY

4

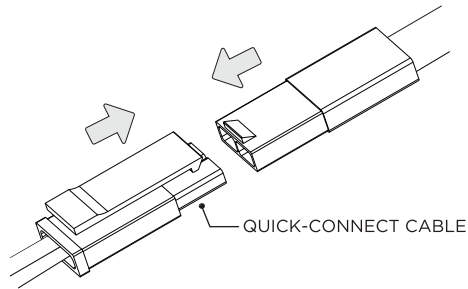

CONNECT QUICK-CONNECT CABLE TO NEW LED ASSEMBLY

5

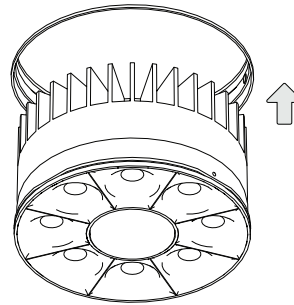

INSERT NEW LED ASSEMBLY INTO CEILING

LED SERVICING - DZ33S

1

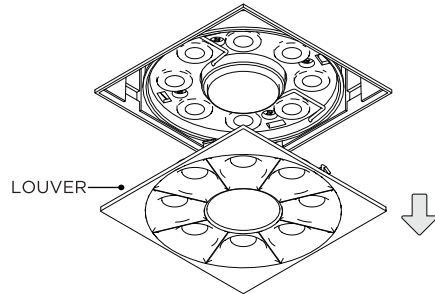

REMOVE LOUVER FROM LED ASSEMBLY

2

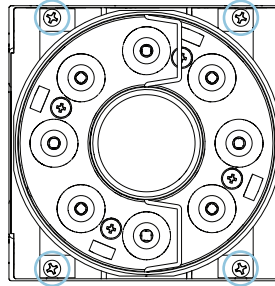

LOCATE FOUR SCREWS

3

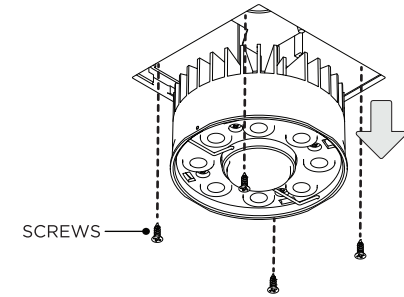

UNSCREW SCREWS TO REMOVE LED ASSEMBLY

4

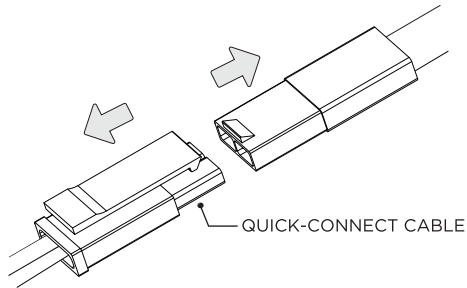

DISCONNECT QUICK-CONNECT CABLE FROM LED ASSEMBLY

5

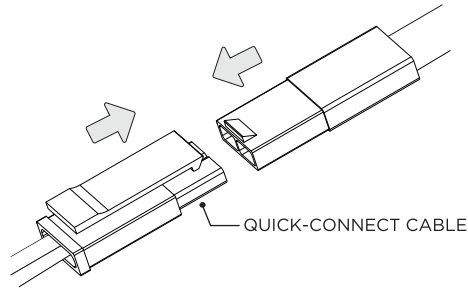

CONNECT QUICK-CONNECT CABLE TO NEW LED ASSEMBLY

6

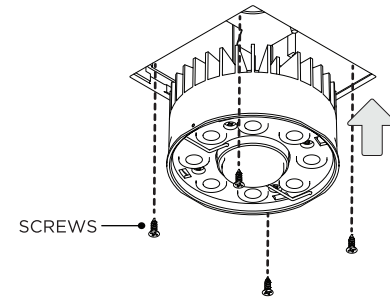

SCREW NEW LED ASSEMBLY INTO CYLINDER

7

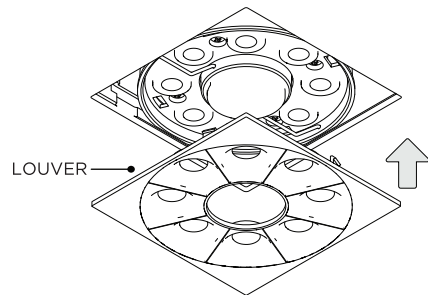

CONNECT QUICK-CONNECT CABLE TO NEW LED ASSEMBLY
www.3GLIGHTING.com | P: 905-850-2305 TF: 888-448-0440

LINEAR LED SERVICING

<p>1</p> <p>FACEPLATE SPRING CLIPS</p> <p>REMOVE FACEPLATE FROM FIXTURE HOUSING</p>	<p>2</p> <p>QUICK-CONNECT CABLE</p> <p>DISCONNECT SAFETY CABLE & QUICK-CONNECT CABLE FROM LED ASSEMBLY</p>	<p>3</p> <p>END PLATE</p> <p>REMOVE END PLATE FROM BOTH ENDS OF FACEPLATE ASSEMBLY</p>
<p>4</p> <p>LED REFLECTOR FACEPLATE</p> <p>REMOVE LED REFLECTOR FROM FACEPLATE</p>	<p>4A FOR FACEPLATES WITH MULTIPLE REFLECTORS</p> <p>QUICK-CONNECT CABLE</p> <p>DISCONNECT QUICK-CONNECT CABLE BETWEEN REFLECTORS BEFORE REMOVAL</p>	<p>5</p> <p>NEW LED REFLECTOR FACEPLATE</p> <p>NEW LED REFLECTOR</p>
<p>5A FOR FACEPLATES WITH MULTIPLE REFLECTORS</p> <p>QUICK-CONNECT CABLE</p> <p>CONNECT QUICK-CONNECT CABLE BETWEEN REFLECTORS AFTER INSTALLATION</p>	<p>6</p> <p>END PLATE</p> <p>INSTALL END PLATE ON BOTH ENDS OF FACEPLATE ASSEMBLY</p>	<p>7</p> <p>FACEPLATE SPRING CLIPS</p> <p>CONNECT SAFETY CABLE & QUICK-CONNECT CABLE TO LED ASSEMBLY REATTACH FACEPLATE TO FIXTURE HOUSING</p>

DRIVER SERVICING

1

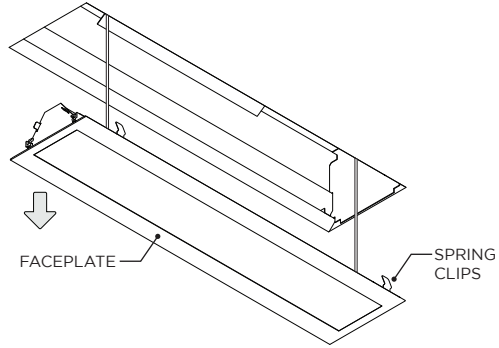

 REMOVE FACEPLATE FROM FIXTURE HOUSING

2

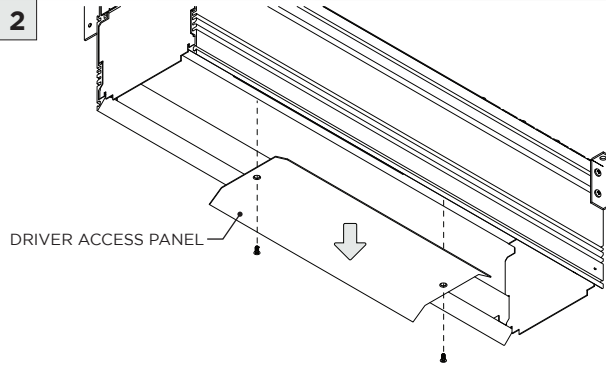

2A

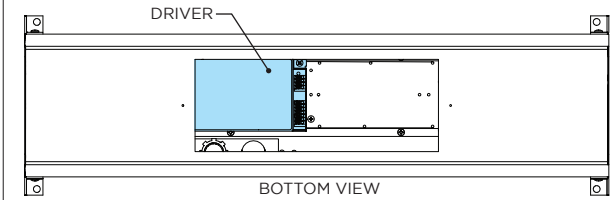

DRIVER IS LOCATED BEHIND ACCESS PANEL