



3G-4RGZ

WALL GRAZER



Narrow 3.5" aperture with one piece extruded aluminum housing
Adjustable LED profile ensures textured surfaces are evenly illuminated
Individual or continuous runs in multiple run configurations
Suitable for drywall, grid, wood, and various architectural ceilings
LED system with performance up to 118 lumens per watt
1% dimming standard with several integral driver options

PROJECT:		TYPE:	
CATALOG#:		DATE:	
		QTY:	

CAT. NO	LUMEN OUTPUT	CRI	COLOR TEMP	VOLTAGE
3G-4RGZ	D250 - 250 LM/FT ¹ D500 - 500 LM/FT D750 - 750 LM/FT D1000 - 1000 LM/FT ² DC___ - CUSTOM OUTPUT (SPECIFY LM/FT) * <small>*Specify custom lumen outputs in 50lm increments (ie: DC600, DC650, DC700) Custom output cannot exceed D1000</small>	S80 - 80+ CRI H90 - 90+ CRI	27K - 2700K 30K - 3000K 35K - 3500K 40K - 4000K	UNV - 120/277V 347 - 347V ³

DRIVER	FLANGE TYPE	OPTIONS	RUN TYPE
DIM - 0-10V (100-1%) D01 - 0-10V (100-0.1%) DALI - DALI (100-1%) ⁴ DHL2 - LUTRON HI-LUME (1% ECOSYSTEM) DMX - DMX (100-0%)	GCX - GRID CEILING * (UNIVERSAL MOUNT) WT - WHITE TRIM FLANGE XTR - TRIMLESS (MUD-IN DRYWALL) FX - FLANGELESS <small>*Grid ceiling fixtures ship with universal mounting brackets suitable for all ceiling types. See mounting section for details.</small>	CP - CHICAGO PLENUM EF - 6" END FILLER (FOR ODD LENGTHS) EMB - EMERGENCY BATTERY * (INTEGRAL) EMC - EMERGENCY CIRCUIT <small>*Minimum 4' section</small>	S - ___' (STRAIGHT) * L - ___'X ___' (L-SHAPE) U - ___'X ___'X ___' (U-SHAPE) <small>*Individual units available from 2' to 8' Continuous runs available in 1' increments "EF" (End Filler) option for odd lengths</small>

¹ D250 (250LM/FT) not available in 2' and 3' lengths (Please specify DC400 for 2' and 3' fixture length when outputs lower than 500LM/FT are required)

² D1000 (1000LM/FT) not available with H90 (93+ CRI)

³ 347 available in "DIM" 0-10V only (100-1%)

⁴ DALI-2 (Type 6) provided as standard. Please consult factory for DALI (Type 8) options

PERFORMANCE

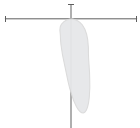
FLUSH	DELIVERED LUMENS (LM/FT)	SYSTEM WATTS (W/FT)	EFFICACY (LPW)
	250	2.0	121
	500	4.3	116
	750	6.7	113
	1000	8.9	113

DELIVERED LUMENS PER FOOT BASED ON 80+ CRI, 3500K
Lumen output and actual wattage may vary +/- 5%

LUMEN OUTPUT MULTIPLIERS

80+ CRI COLOR TEMP		90+ CRI COLOR TEMP	
2700K	N/A	2700K	0.78
3000K	0.97	3000K	0.83
3500K	1.00	3500K	1.00
4000K	1.02	4000K	1.02

HOUSING

Extruded aluminum housing with 3.5" aperture
Individual units and continuous runs available in 1' increments
with end filler option for odd lengths
6" end fillers are non illuminated section and are field cuttable
Aluminum trim flange with matte white powder coated finish
and minimal 0.400" overlap
Trimless model features a satin coat mudding flange for
seamless ceiling integration
24-gauge LED reflector with high reflectance white powder
coated finish
Standard polyester powder coated matte white finish

OPTICS

Adjustable LED profile ensures all textured wall surfaces are
evenly illuminated (field adjustable post installation)
Proprietary, high performance wall grazer optic made from
extruded acrylic

LISTING

ETL listed and conforms to UL1598 standard
Certified to CSA22.2 No.250.0.
Rated for dry or damp locations

WARRANTY

5 Year Warranty on LED and drivers
LED system rated for operation in ambient environments up to 25°C

ELECTRICAL

Standard 0-10V, constant current drivers with 100-1%
dimming range and >0.9 power factor
Standard 120/277V universal voltage with several driver options
Luminaires are pre-wired with factory installed quick
connects and branch circuit wiring
All drivers are integral and easily accessible through
luminaire aperture

EMERGENCY

Integral batteries operate minimum 4' and maximum 6' sections.
15W output (1815lm) for 90 minutes. Title 24 Certified
4' section (+/- 450lm per foot at 80+ CRI)
5' section (+/- 360lm per foot at 80+ CRI)
6' section (+/- 300lm per foot at 80+ CRI)

LED SYSTEM

Proprietary LED system with color consistency <3 SDCM
Available in 27K, 30K, 35K, and 40K
Standard 80+CRI. Optional 90+CRI
R9 value of 56 for 90+CRI
L90 >60,000 hours
5 Year Warranty

MOUNTING

New construction housing suspended via 1/4" threaded rod
or suspension cables (by others)
LED reflectors remain within each fixture section during
installation with 3G's click and lock spring system
Trim fixture designed for use in drywall, wood, and other
architectural ceiling materials
Trimless fixture designed for use in drywall, mud-in ceiling
applications
Flangeless fixture designed for use in wood ceilings
Suitable for 4" TechZone and various grid ceiling applications
(see mounting details)
Fixture weight: +/- 4 lb/ft

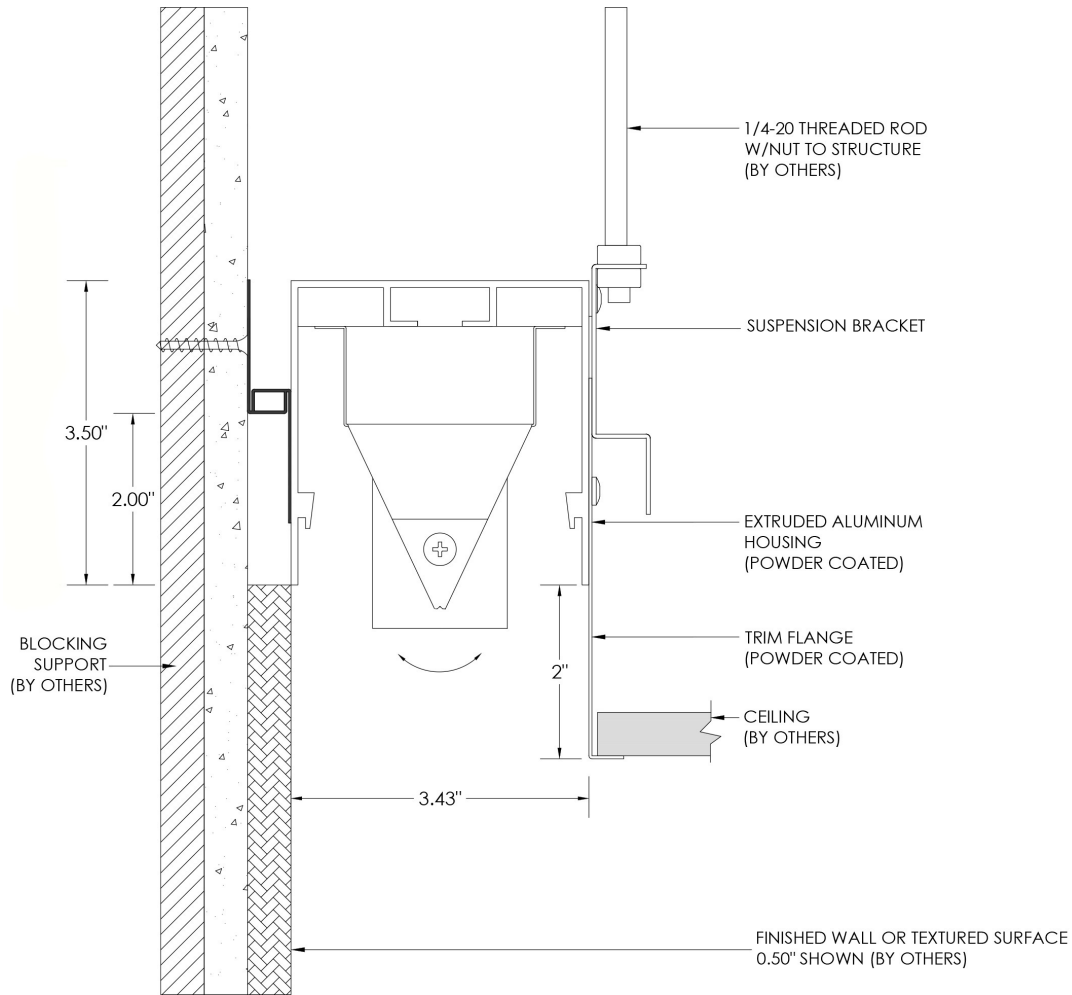

ADJUSTABILITY

ADJUSTABLE LED PROFILE
ENSURES ALL TEXTURED
WALL SURFACES ARE
EVENLY ILLUMINATED

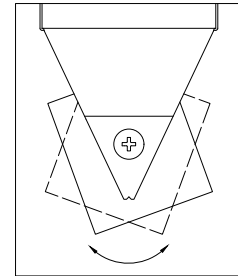

HARD CEILING MOUNTING TYPES

WT - TRIM

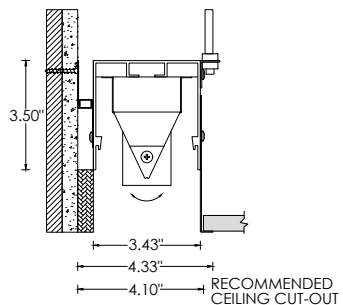

XTR - TRIMLESS

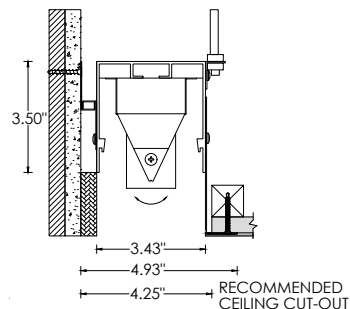

FX - FLANGELESS

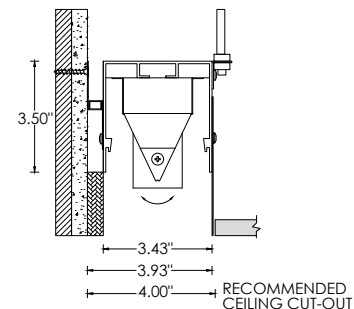

GRID CEILING MOUNTING TYPES

9L - 9/16" LAYIN

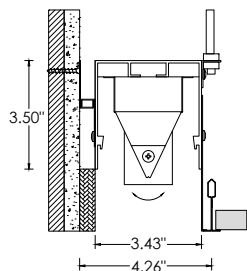

9TG - 9/16" TEGULAR

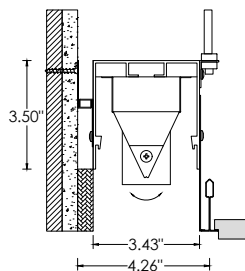

15L - 15/16" LAYIN

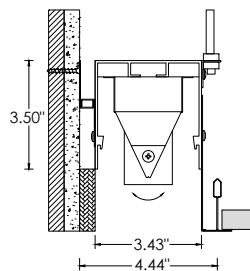

15TG - 15/16" TEGULAR

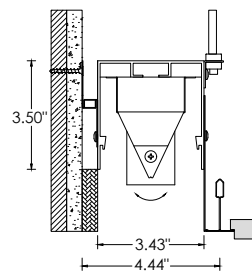

9ST - 9/16" SLOT TEE TEGULAR

