

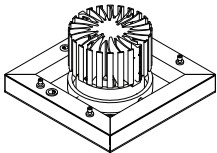

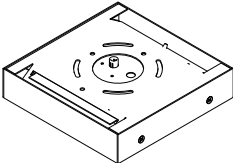





3G-PIN1
1 LIGHT MADISON INFORMA PENDANT



i THE IMAGES SHOWN ARE FOR ILLUSTRATION PURPOSES ONLY AND MAY NOT BE AN EXACT REPRESENTATION OF THE PRODUCT

INCLUDED COMPONENTS		
		
ALUMINUM FRAME x1	CEILING PLATE + CANOPY x1	AIRCRAFT CABLE x4

INSTRUCTION KEY	INFORMATION
 ADDITIONAL	INSTALLATION SHOULD ONLY BE PERFORMED BY A CERTIFIED ELECTRICIAN
 ATTENTION	REFER TO LOCAL/NATIONAL CODES FOR PROPER INSTALLATION
 POWER ON	FAILURE TO FOLLOW INSTALLATION INSTRUCTION MAY VOID THE WARRANTY
 POWER OFF	DO NOT TOUCH LEDS. LEDS MUST BE PROTECTED FROM MECHANICAL STRESS OR DEBRIS
	TURN OFF POWER DURING INSTALLATION OR SERVICING

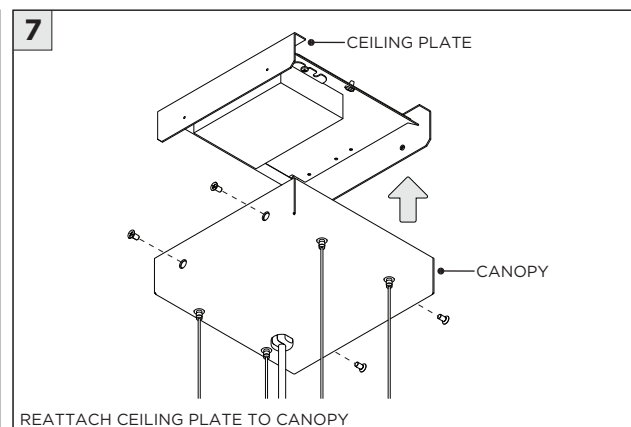
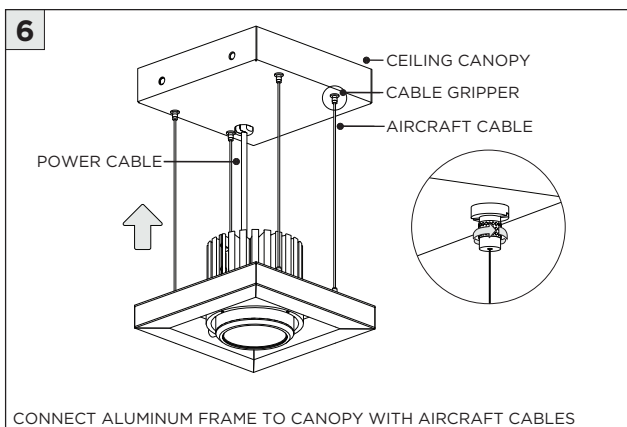
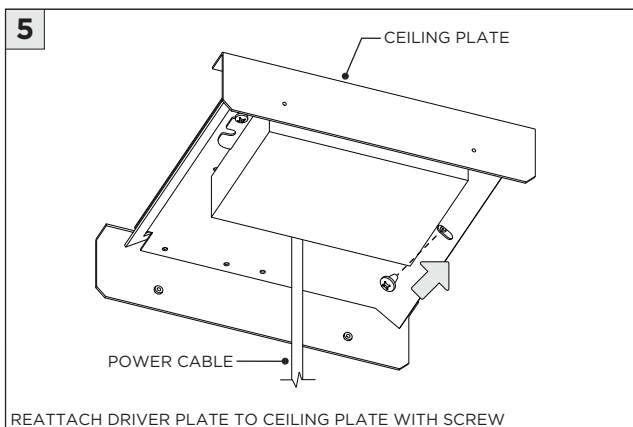
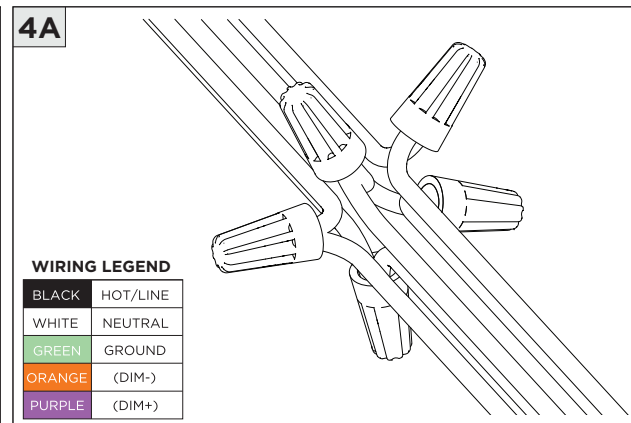
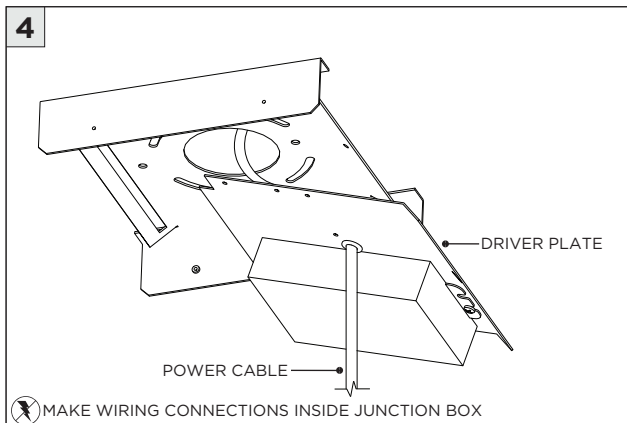
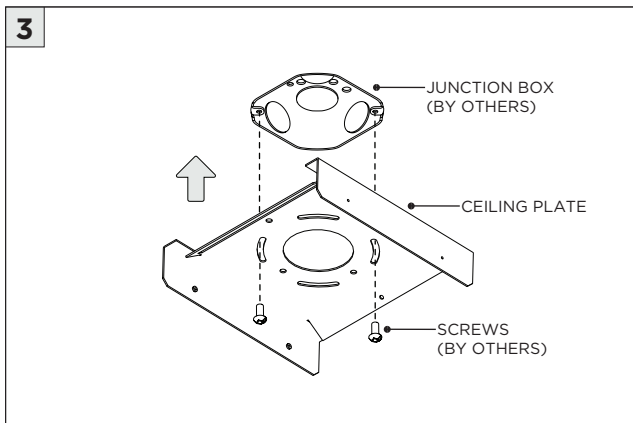
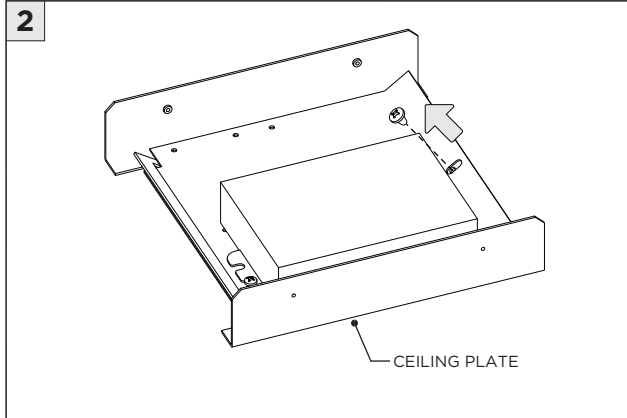
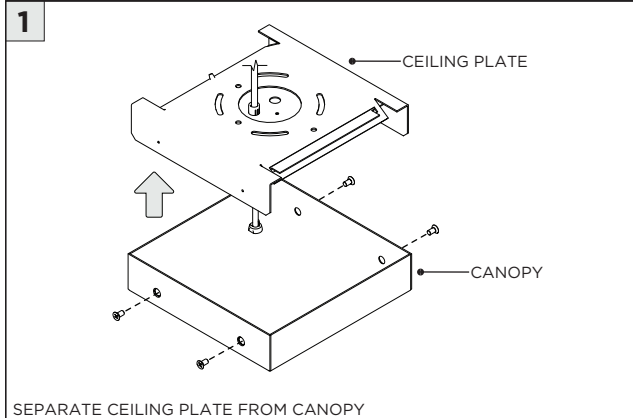

DRIVER SERVICING

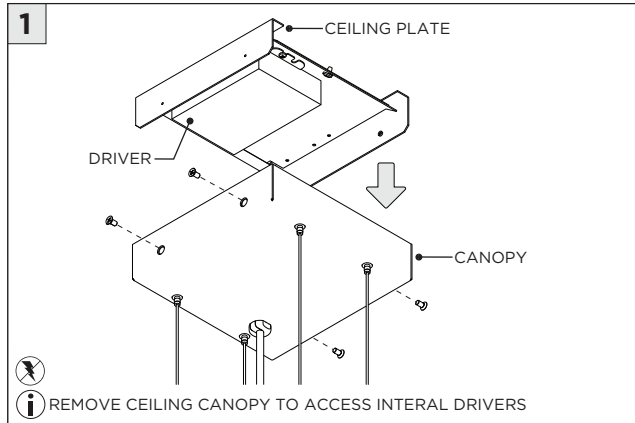

LED SERVICING

1

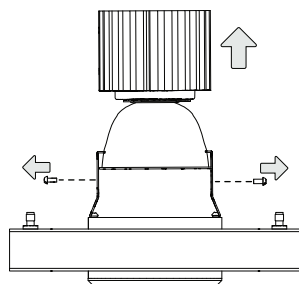

 REMOVE LED ASSEMBLY FROM GIMBAL

2

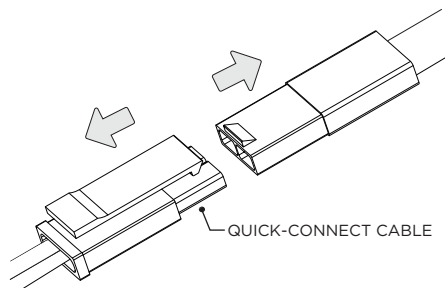

DISCONNECT QUICK-CONNECT CABLE FROM LED ASSEMBLY

3

