

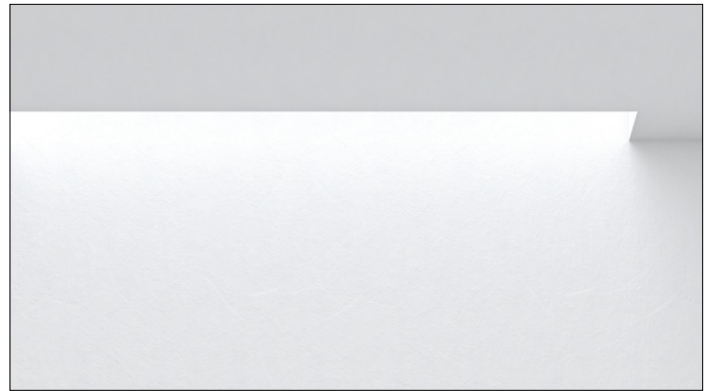

## 3G-4RPE

3.5" PERIMETER  
TUNABLE WHITE & RGBW

Narrow 3.5" aperture with one piece extruded aluminum housing  
Designed for continuous runs in 1' increments as standard  
12" fully illuminated end filler option is field cuttable for odd lengths  
LED system with performance up to 147 lumens per watt  
Lens position available in flush, 1", 2" and 3" regressed options  
Asymmetric optics available for room side performance  
1% dimming standard with several integral driver options



**3GT** **3GB**

PROJECT:		TYPE:	
CATALOG#:		DATE:	QTY:

CAT. NO	LED SOURCE	LUMEN OUTPUT	CRI	VOLTAGE
3G-4RPE	<b>TW</b> - TUNABLE WHITE (2700K-6500K) <b>RGBW</b> - INFINITE COLOR <sup>1</sup> (3500K WHITE)	<b>D250</b> - 250 LM/FT <sup>2</sup> <b>D500</b> - 500 LM/FT <b>D750</b> - 750 LM/FT <b>D1000</b> - 1000 LM/FT <sup>3</sup> <b>DC</b> - CUSTOM OUTPUT * (SPECIFY LM/FT)  <small>*Specify custom lumen outputs in 50lm increments (ie: DC600, DC650, DC700) Custom output cannot exceed D1000 Lumen outputs suitable for white LED source only</small>	<b>S80</b> - 80+ CRI <b>H90</b> - 90+ CRI <sup>1</sup>	<b>UNV</b> - 120/277V

DRIVER	FLANGE TYPE	LENS OPTION	OPTIONS
<b>D01</b> - 0-10V (100-0.1%) <b>DALI</b> - DALI (100-1%) <b>DMX</b> - DMX (100-0%) <sup>1</sup> <b>DHLT</b> - LUTRON T-SERIES (100-0.1%)	<b>GCX</b> - GRID CEILING * (UNIVERSAL MOUNT) <b>WT</b> - WHITE TRIM FLANGE <b>XTR</b> - TRIMLESS (SHEETROCK) <b>FX</b> - FLANGELESS  <small>*Grid ceiling fixtures ship with universal mounting brackets suitable for all ceiling types. See mounting section for details</small>	<b>FL</b> - FLUSH LENS <b>DASY</b> - ASYMMETRIC LENS <sup>1</sup> <b>RG1</b> - 1" REGRESSED <b>RG2</b> - 2" REGRESSED <b>RG3</b> - 3" REGRESSED	<b>EF</b> - END FILLER * <b>EMC</b> - EMERGENCY CIRCUIT <sup>4</sup> <b>CP</b> - CHICAGO PLENUM  <small>*12" fully illuminated end filler option is field cuttable for odd lengths</small>

RUN TYPE
<b>S</b> - ____' (STRAIGHT) * <b>L</b> - ____'X ____' (L-SHAPE) <b>U</b> - ____'X ____'X ____' (U-SHAPE)  <small>*Individual units available from 2' to 8' Continuous runs available in 1" increments as standard EF (End Filler) option for odd lengths (tunable white only)</small>

- <sup>1</sup> RGBW LED source available with S80 (80+ CRI) and DMX driver option only. Not available with asymmetric optic or EM options  
<sup>2</sup> D250 (250LM/FT) not available in 2' and 3' lengths. Specify DC400 for 2' and 3' fixture lengths when outputs lower than 500LM/FT are required  
<sup>3</sup> D1000 (1000LM/FT) not available for H90 (90+ CRI)  
<sup>4</sup> EMC (emergency circuit) option available for tunable white LED source only. Not available with RGBW

**3GT** - Tunable White  
**3GB** - RGBW

BASED ON 4' LENGTH WITH FLUSH LENS (TUNABLE WHITE AND 90+ CRI)

COLOR TEMP	DELIVERED LUMENS (LM/FT)	SYSTEM WATTS (W/FT)	EFFICACY (LPW)
2700K	250	2.4	120
	500	4.5	115
	750	6.9	113
	1000	9.6	112
3500K	250	2.4	103
	500	4.5	111
	750	6.9	109
	1000	9.6	104
6500K	250	2.4	161
	500	4.5	160
	750	6.9	152
	1000	9.6	145

EFFICACY (LPW) ADJUSTMENT FACTOR: 90CRI=0.88

**FL - FLUSH LENS**

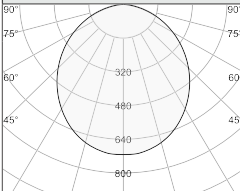

**3G-4RPE-TW-D500-H90-FL**

DELIVERED LUMENS: 500 LM/FT (2000LM)  
SYSTEM WATTS: 4.5 W/FT (15.2W)  
EFFICACY: 111 LPW  
CRI: 90+  
CCT: 3500K  
LENS OPTION: FLUSH

**RG1 - 1" REGRESSED**

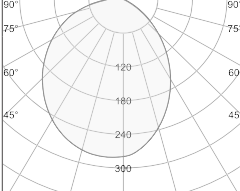

**3G-4RPE-TW-D500-H90-RG1**

DELIVERED LUMENS: 500 LM/FT (2000LM)  
SYSTEM WATTS: 4.5 W/FT (15.2W)  
EFFICACY: 109 LPW  
CRI: 90+  
CCT: 3500K  
LENS OPTION: 1" REGRESSED

**RG2 - 2" REGRESSED**

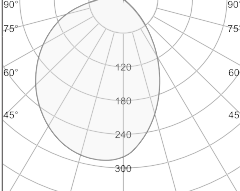

**3G-4RPE-TW-D500-H90-RG2**

DELIVERED LUMENS: 500 LM/FT (2000LM)  
SYSTEM WATTS: 4.5 W/FT (15.2W)  
EFFICACY: 107 LPW  
CRI: 90+  
CCT: 3500K  
LENS OPTION: 2" REGRESSED

**RG3 - 3" REGRESSED**

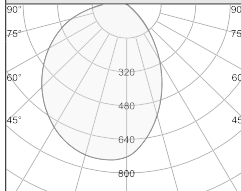

**3G-4RPE-TW-D500-H90-RG3**

DELIVERED LUMENS: 500 LM/FT (2000LM)  
SYSTEM WATTS: 4.5 W/FT (15.2W)  
EFFICACY: 105 LPW  
CRI: 90+  
CCT: 3500K  
LENS OPTION: 3" REGRESSED

**DASY - ASYMMETRIC LENS**

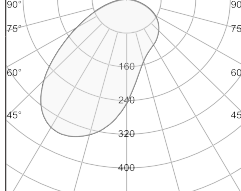

**3G-4RPE-TW-D500-H90-DASY**

DELIVERED LUMENS: 500 LM/FT (2000LM)  
SYSTEM WATTS: 3.9 W/FT (15.2W)  
EFFICACY: 128 LPW  
CRI: 90+  
CCT: 3500K  
LENS OPTION: ASYMMETRIC

BASED ON 4' LENGTH (RGBW WITH 80+ CRI AND 3500K SOURCE)

COLOR TEMP	DELIVERED LUMENS (LM/FT)	SYSTEM WATTS (W/FT)	EFFICACY (LPW)
3500K	250	2.2	119
	500	4.6	113
	750	7.8	96
	1000	11.3	89

LUMINOUS INTENSITY PER LED	RGB	INTENSITY MIN-MAX (MCD)
	RED	355 - 805
	GREEN	710 - 1400
	BLUE	140 - 355

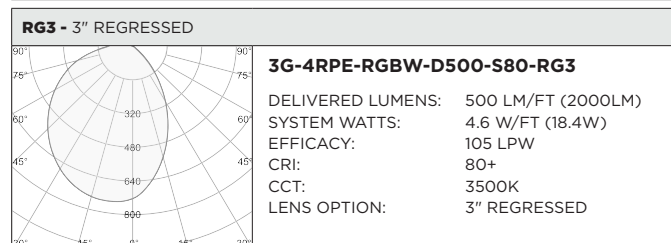
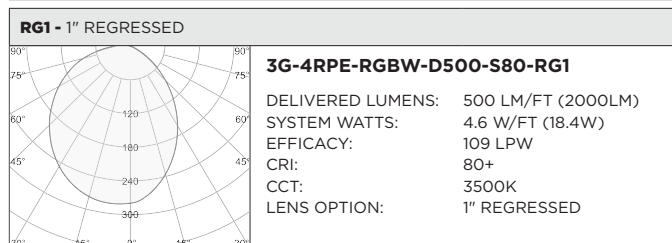
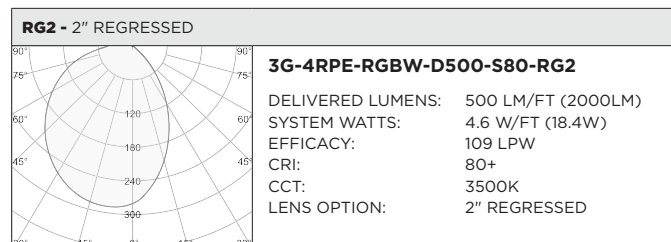
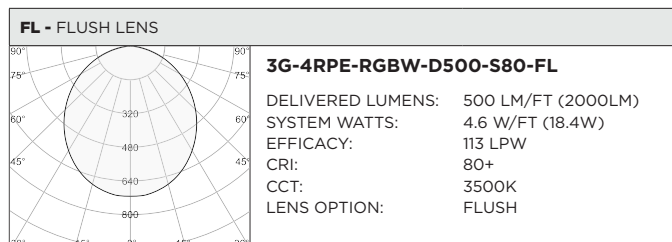

**HOUSING**

Extruded aluminum housing with narrow 3.5" aperture  
Individual units and continuous runs available in 1' increments  
12" fully illuminated end filler option is field cuttable for odd lengths  
Trim flange with matte white powder coated finish and minimal 0.400" overlap  
Trimless model features a satin coat mudding flange for seamless ceiling  
24-gauge LED reflector with high reflectance white powder coated finish  
Standard polyester powder coated matte white finish

**OPTICS**

Extruded, satin acrylic lens designed for optimal performance and glare control. Up to 8' continuous  
Lens position available in flush, 1", 2", and 3" regressed options  
High performance asymmetric optics available

**LED SYSTEM FOR TUNABLE WHITE**

Proprietary LED system with color consistency <3 SDCM  
2700K-6500K CCT range  
Standard 80+CRI. Optional 90+CRI. (R9 value of 56 for 90+CRI)  
L90 >60,000 hours  
5 Year Warranty

**LED SYSTEM FOR RGBW**

Proprietary LED system with color consistency <3 SDCM  
White LED available in 35K with 80+ CRI  
L80 >72,000 hours  
Red (335-805 mcd)  
Green (710-1400 mcd)  
Blue (140-355 mcd)  
5 Year Warranty

**ELECTRICAL**

Luminaires are pre-wired with factory installed quick connects and branch circuit wiring  
Multiple driver options available for tunable white LED system  
All drivers are integral and easily accessible through luminaire aperture

**MOUNTING**

New construction housing suspended via ¼" threaded rod or suspension cables (by others)  
Trim fixture designed for use in drywall, wood, and other architectural ceilings  
Trimless fixture designed for use in drywall, mud-in ceiling applications  
Flangeless fixture designed for use in wood ceilings  
Suitable for various grid ceiling applications (see mounting details)  
Standard mounting available in flush and regressed options up to 3".  
Consult 3G for modifications  
Fixture weight: +/- 3 lbs/ft

**LISTING**

ETL listed and conforms to UL1598 standard  
Certified to CSA22.2 NO.250.0.  
Rated for dry or damp locations

**WARRANTY**

5 year limited warranty  
LED system rated for operation in ambient environments up to 25°C

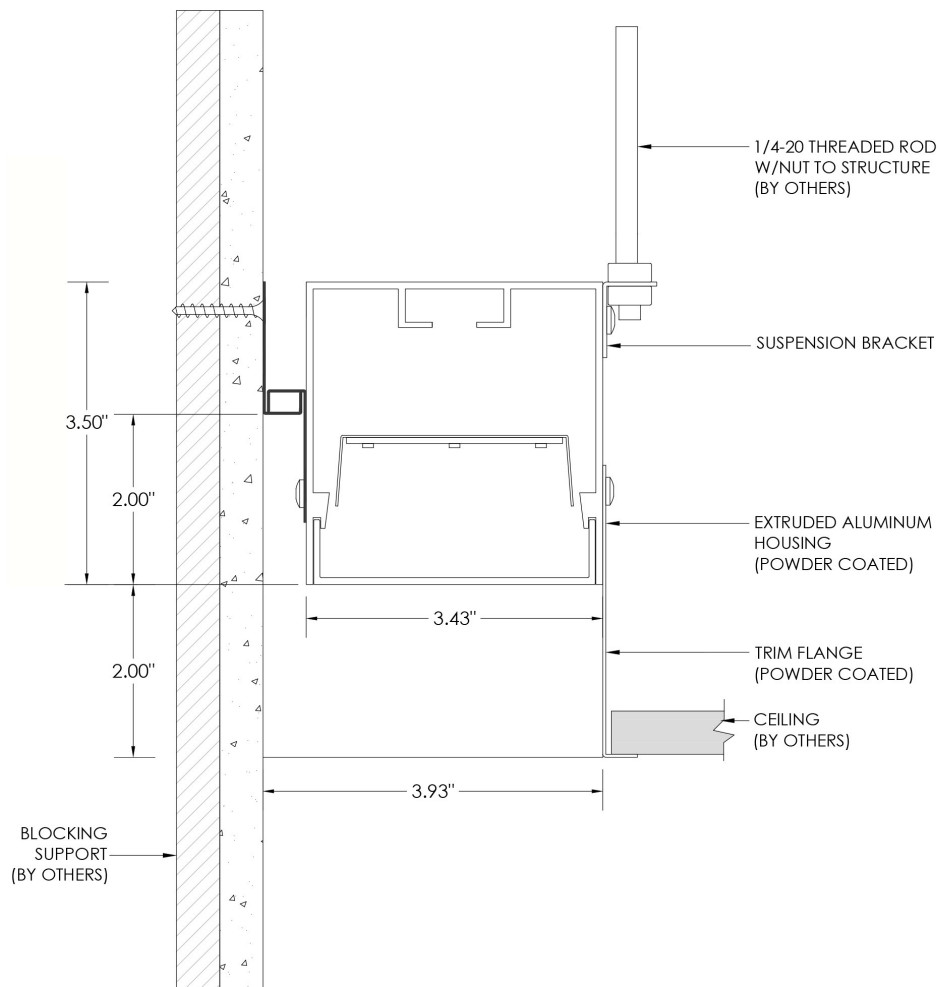

## LENS POSITION

**FL** - FLUSH  
**DASY** - ASYMMETRIC OPTIC  
(ROOM SIDE)

**RG1** - 1" REGRESSED

**RG2** - 2" REGRESSED

**RG3** - 3" REGRESSED

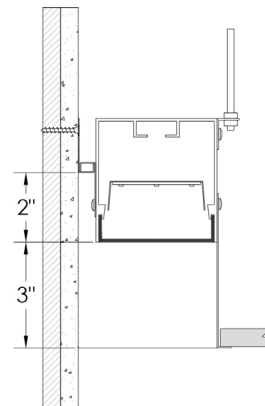
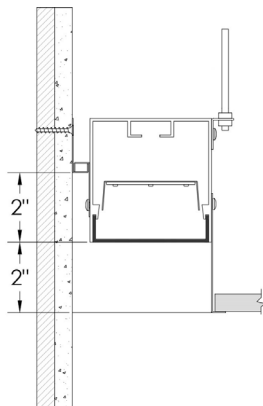
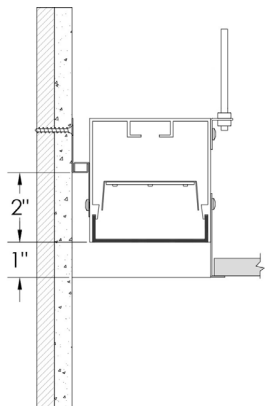
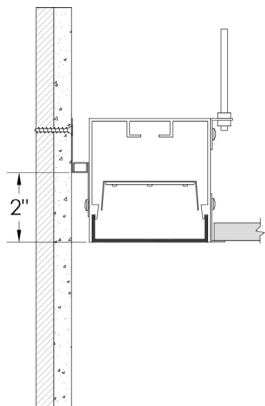

## HARD CEILING MOUNTING TYPES

### FLUSH

#### WT - TRIM

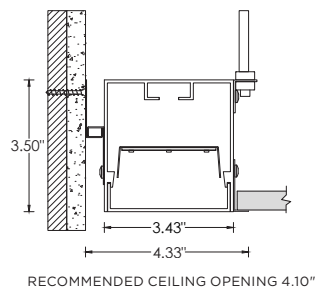

#### XTR - TRIMLESS

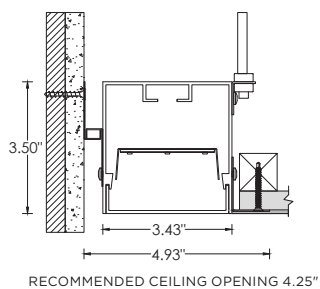

#### FX - FLANGELESS

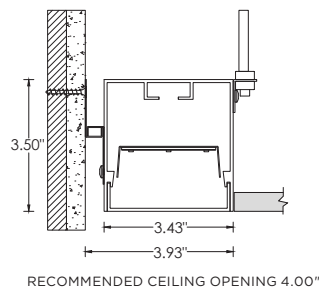

### 2" REGRESSED

#### WT - TRIM

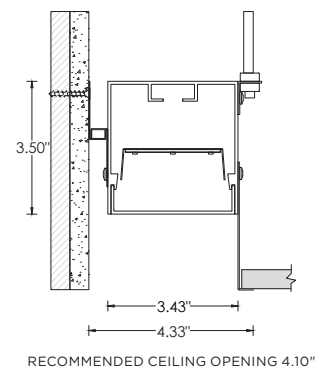

#### XTR - TRIMLESS

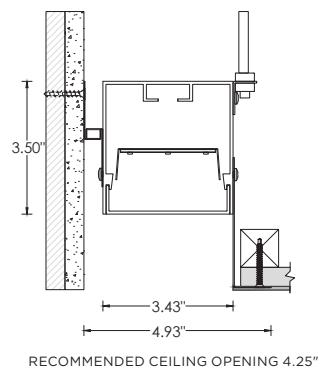

#### FX - FLANGELESS

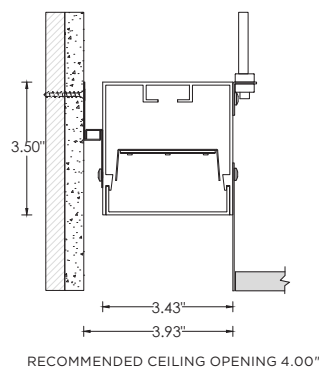

## GRID CEILING MOUNTING TYPES

### FLUSH

**9L - 9/16" LAYIN**

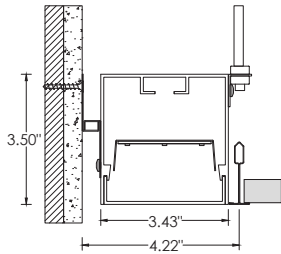

**9TG - 9/16" TEGULAR**

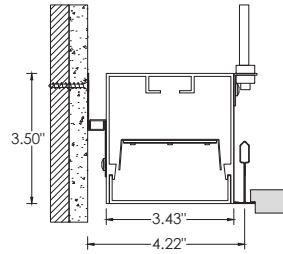

**15L - 15/16" LAYIN**

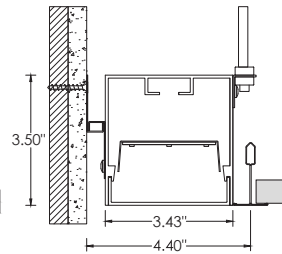

**15TG - 15/16" TEGULAR**

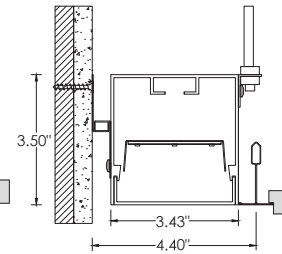

**9ST - 9/16" SLOT TEE TEGULAR**

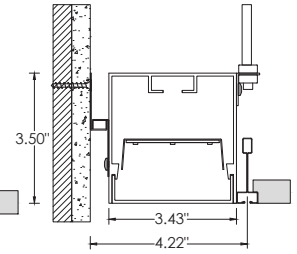

### 2" REGRESSED

**9L - 9/16" LAYIN**

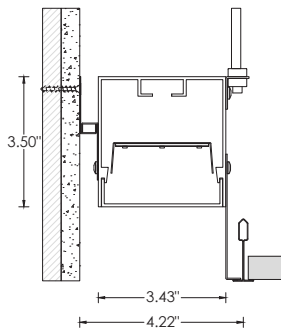

**9TG - 9/16" TEGULAR**

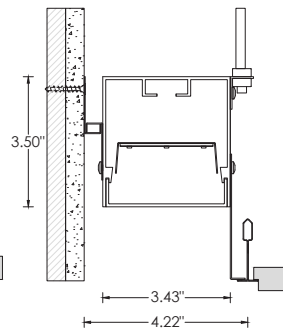

**15L - 15/16" LAYIN**

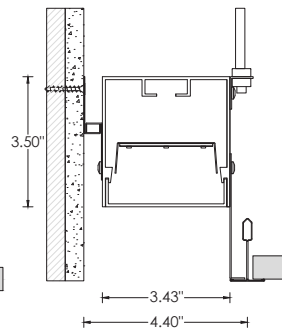

**15TG - 15/16" TEGULAR**

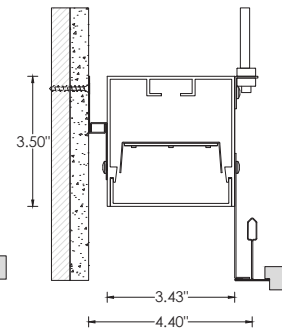

**9ST - 9/16" SLOT TEE TEGULAR**

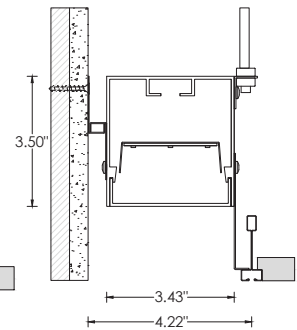

## PATTERNS

Specify pattern shape and overall dimensions as shown below  
Patterns are connected with fully illuminated 12"x12" L, T, and X-shaped sections  
Please consult factory for custom patterns and shapes not shown below



L-SHAPE	U-SHAPE
Provide dimensions of AxB Example: <b>L</b> - 6'x8'	Provide dimensions of AxBxC Example: <b>U</b> - 8'x10'x6"
