



7" OR 11"

x1

Exploded view diagram of the 1000 Series LED Light fixture components and their quantities:

- 1x Circular LED light fixture assembly
- 1x Square mounting plate with four L-shaped brackets
- 1x Mounting screw with a circular head
- 3x Rectangular LED light module
- 3x U-shaped bracket
- 2x Small cylindrical pin or screw
- 1x Large rectangular panel, labeled "7" OR 11"

[illegible]

6/13/2025

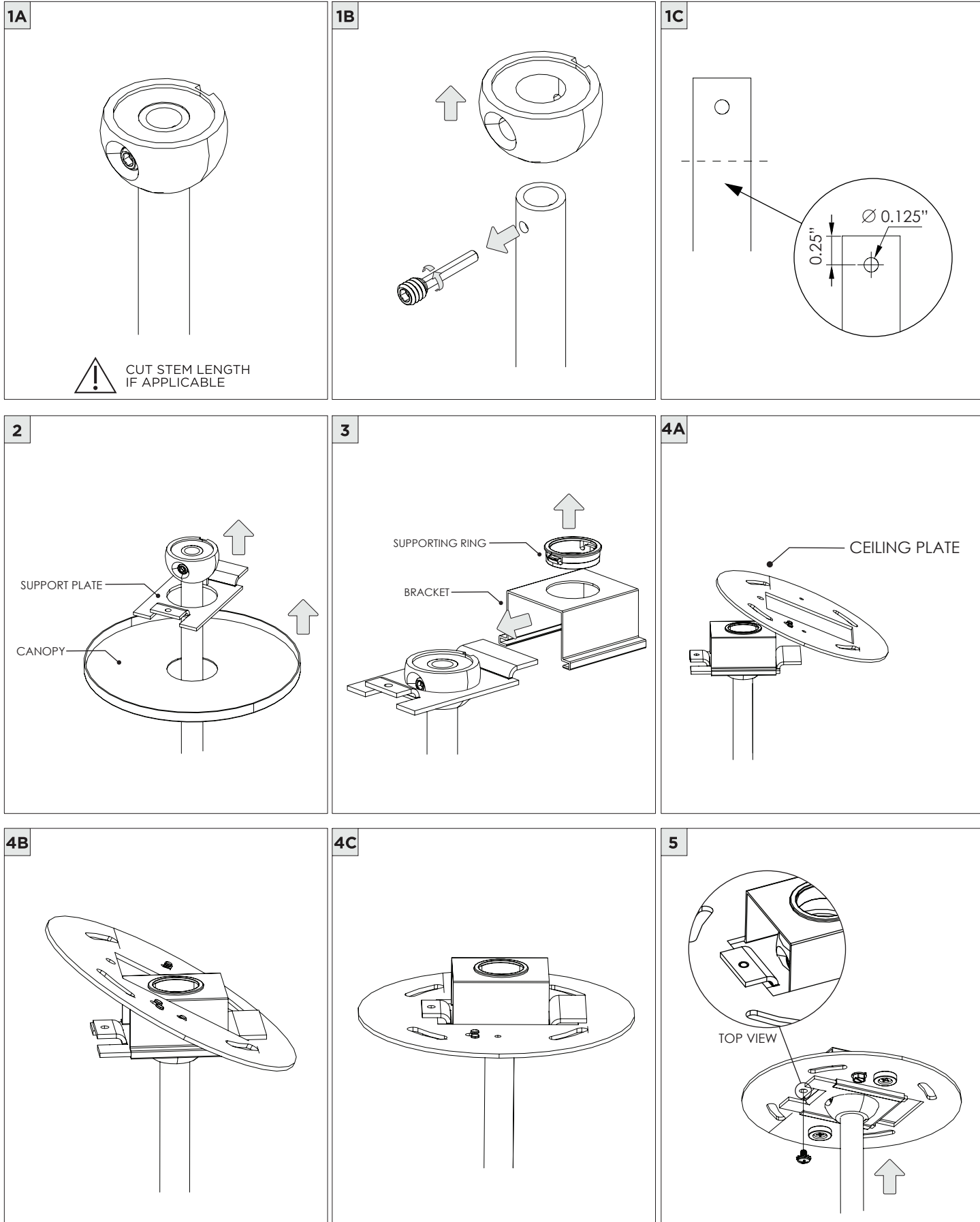

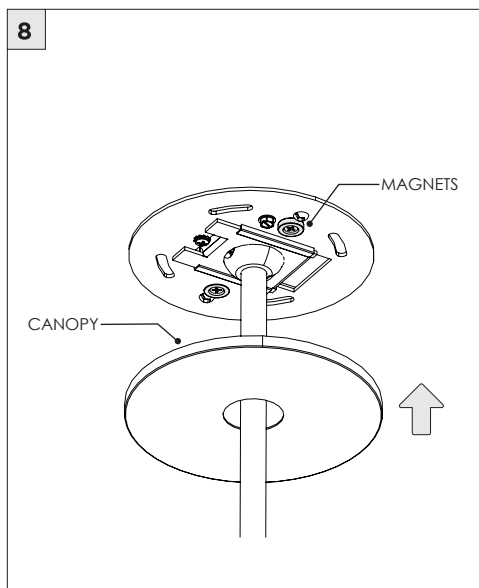
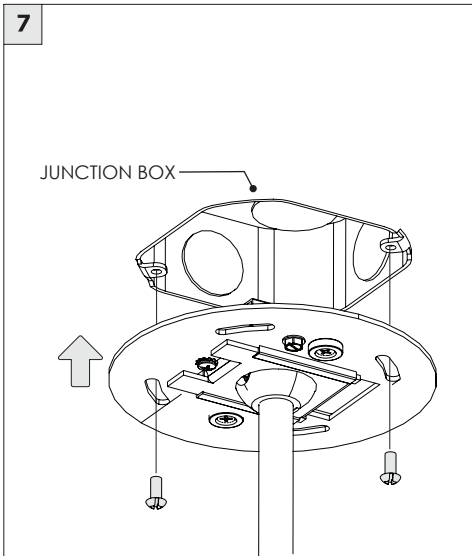
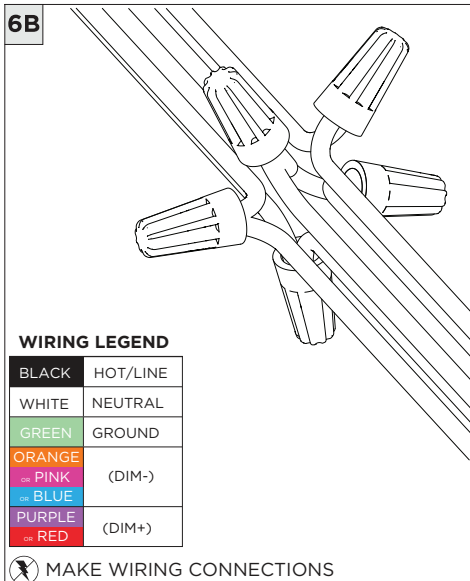
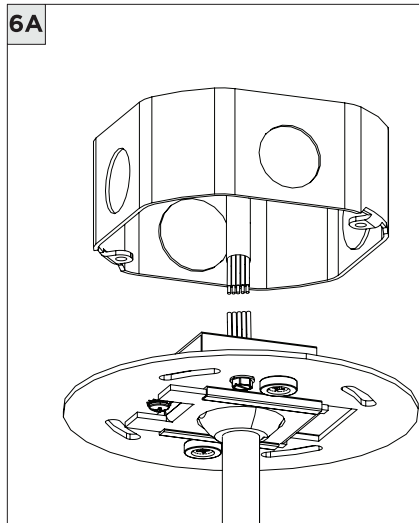

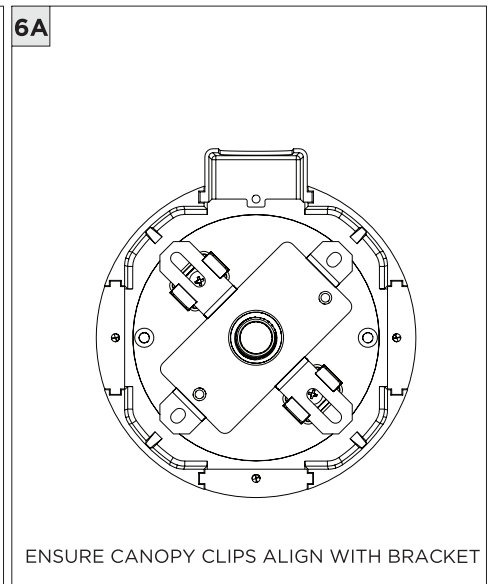
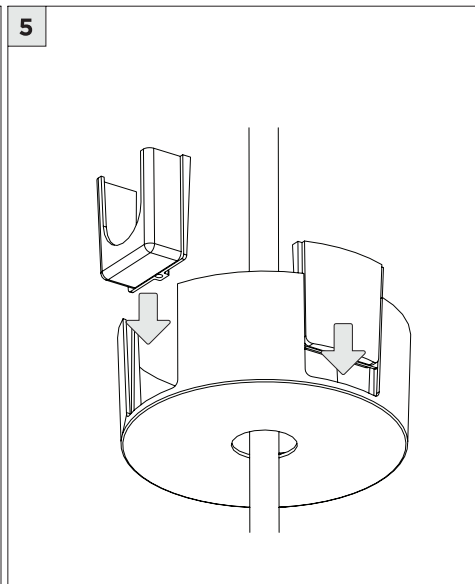
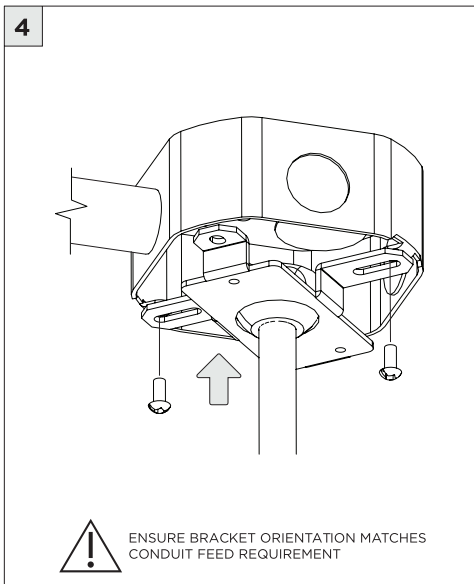
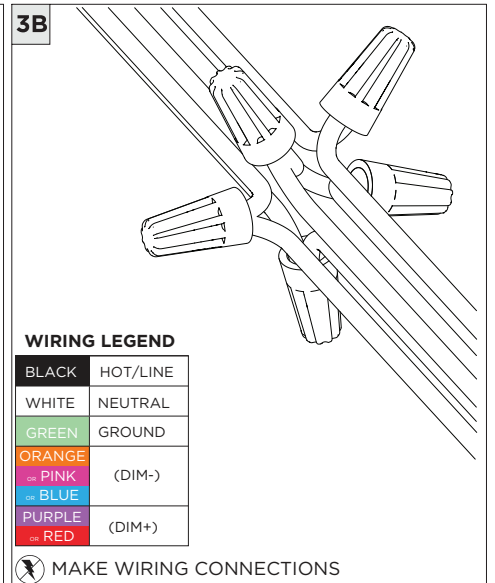
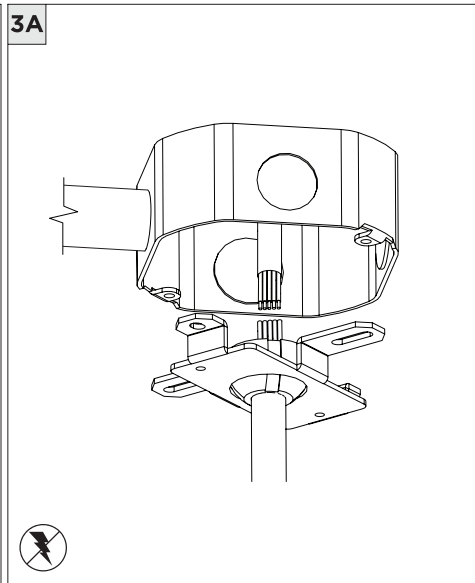
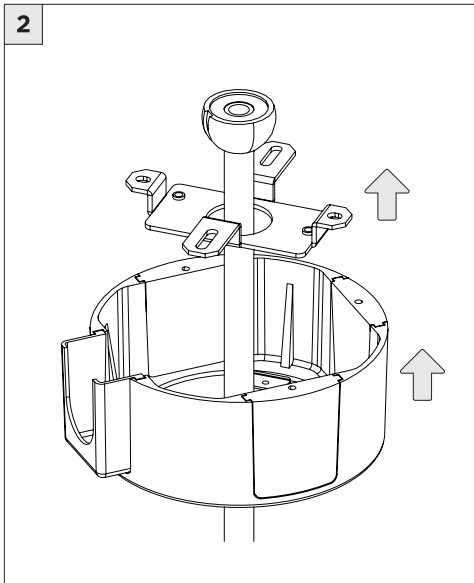
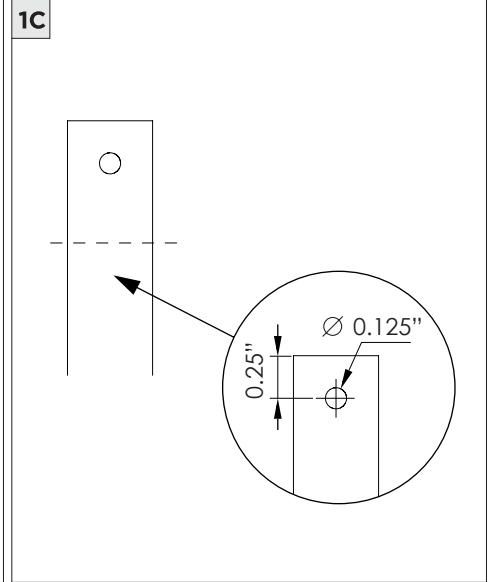
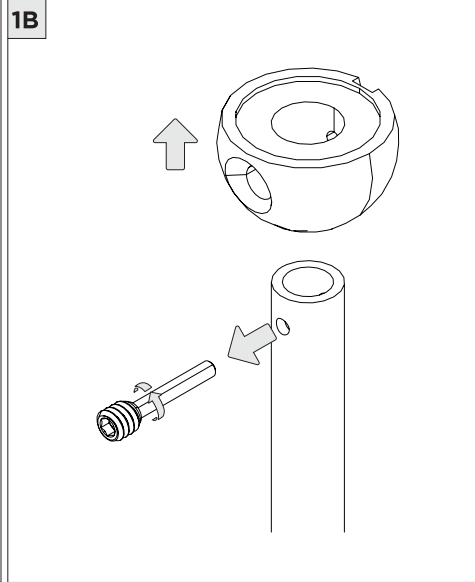
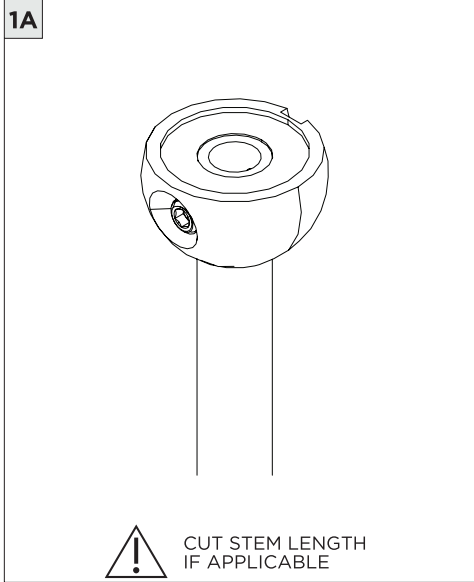

6B

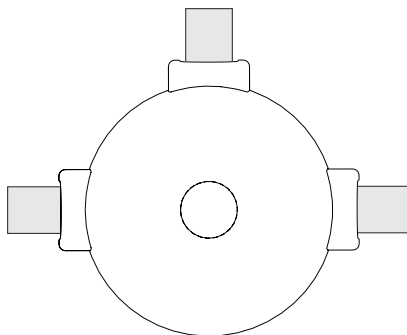
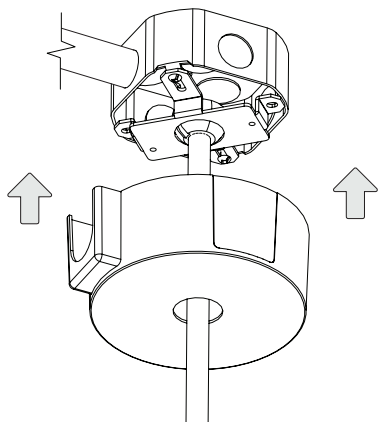

CANOPY IS SUITABLE FOR
MAXIMUM 3 CONDUIT FEEDS

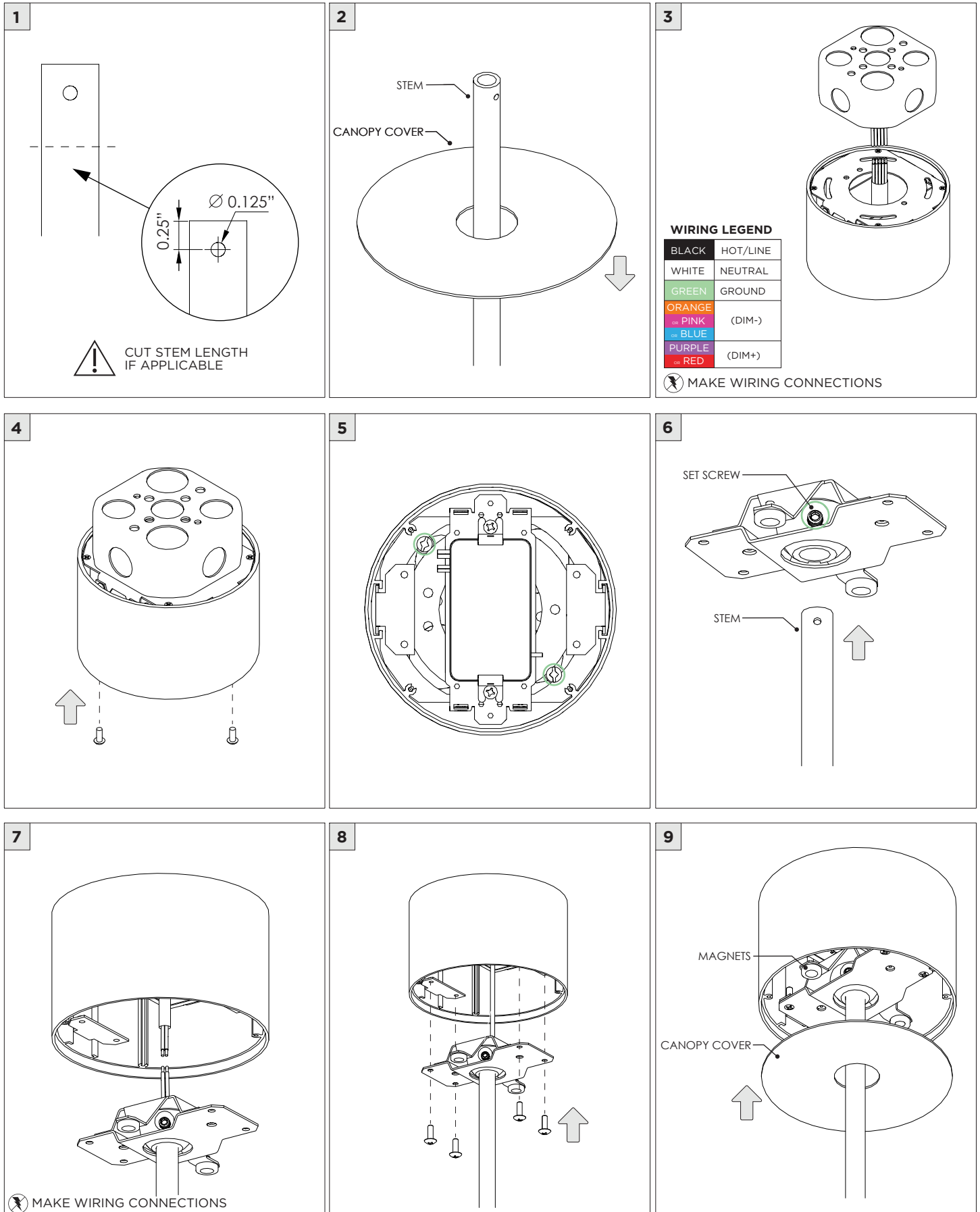

1 CONDUIT FEED CANOPY

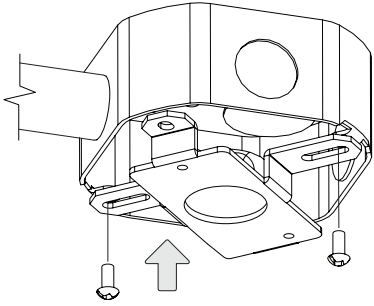

2

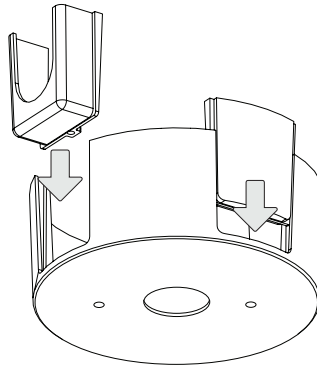

3

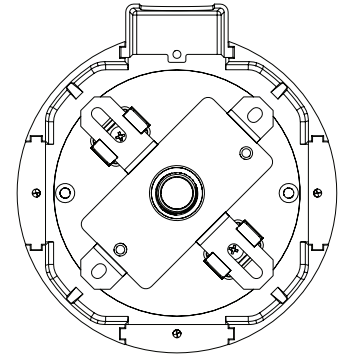

ENSURE CANOPY CLIPS ALIGN WITH BRACKET

4

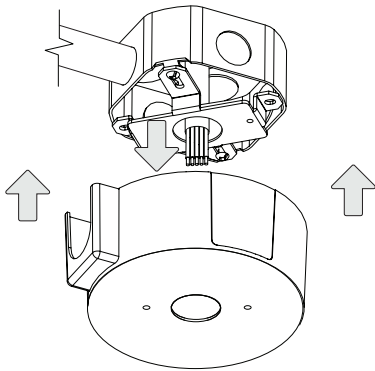

CONNECT CONDUIT CANOPY AND FEED
JUNCTION BOX WIRES THROUGH HOLE

5

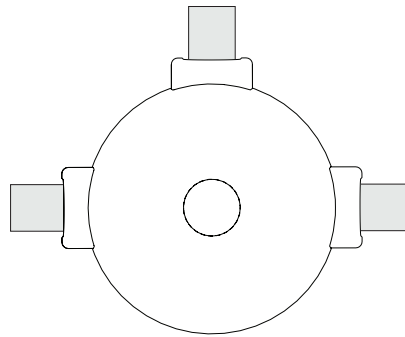

! CANOPY IS SUITABLE FOR
MAXIMUM 3 CONDUIT FEEDS

6 POWER CANOPY

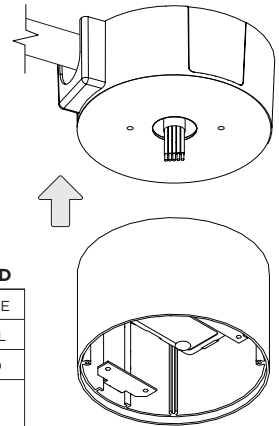

WIRING LEGEND

BLACK	HOT/LINE
WHITE	NEUTRAL
GREEN	GROUND
ORANGE	(DIM-)
PINK	(DIM-)
BLUE	(DIM-)
PURPLE	(DIM+)
RED	(DIM+)

! MAKE WIRING CONNECTIONS

7

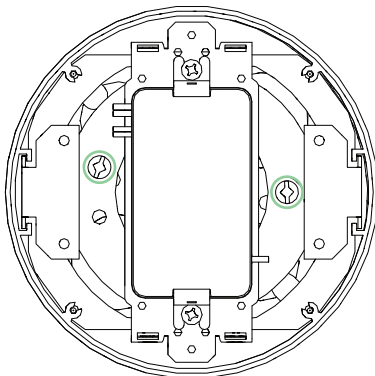

8

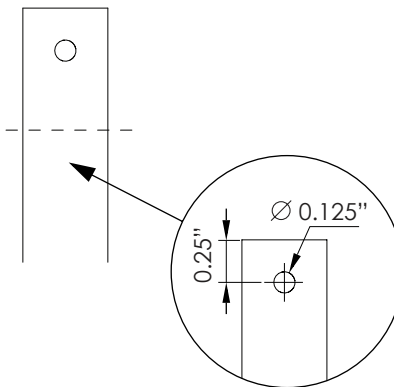

! CUT STEM LENGTH
IF APPLICABLE

9

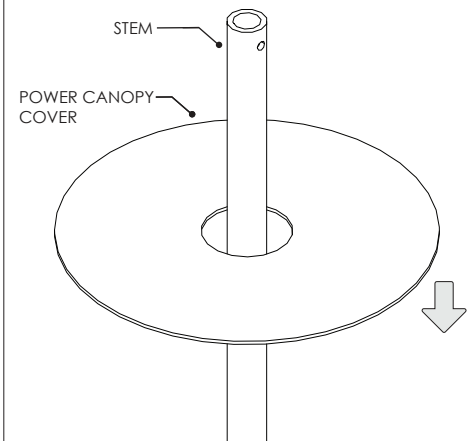

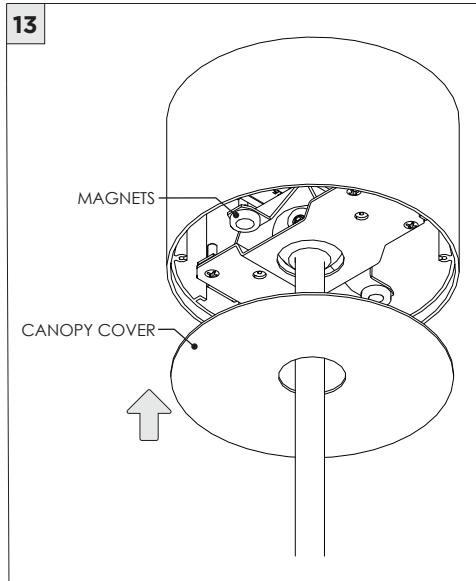
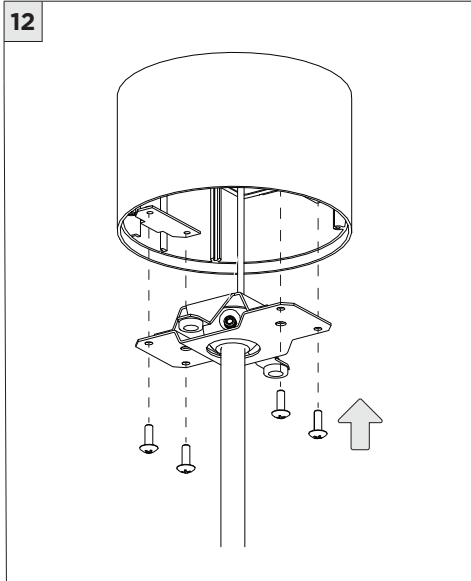
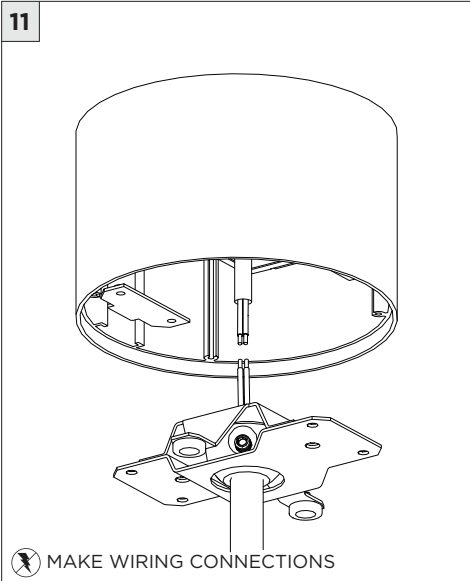
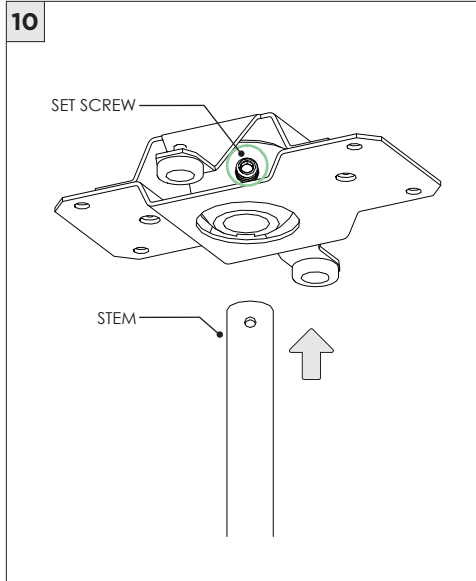

DRIVER SERVICING

1

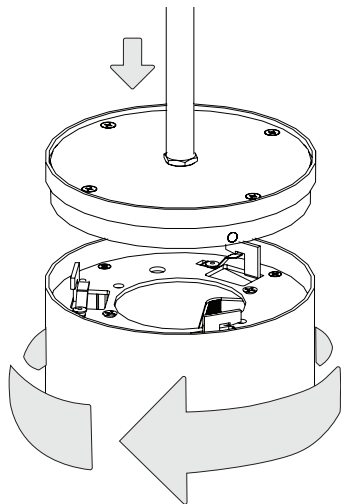

2

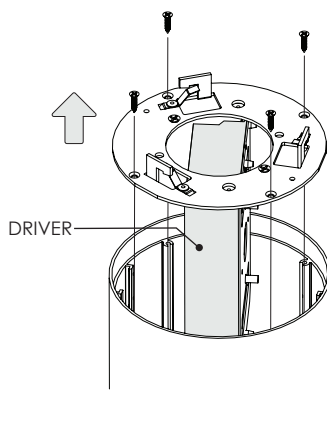

LED SERVICING

1

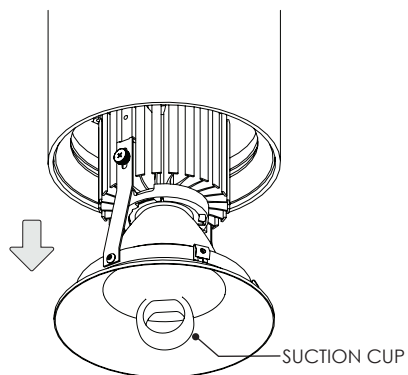

DISCONNECT LED WIRES AND REMOVE LED INSERT

2

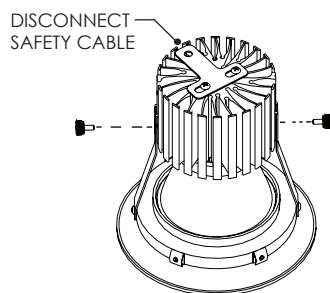

3

