



3G-1PLI-D

1.5" LINEAR PENDANT, DIRECT
TUNABLE WHITE & RGBW

Narrow 1.5" aperture with one piece extruded aluminum housing
Individual or continuous runs available in multiple run configurations
Direct distribution with multiple lumen output options
LED system with performance up to 103 lumens per watt
Extruded acrylic lens with optimal performance and glare control
Asymmetric optics available
1% dimming standard with several driver options



3GT **3GB**

ORDERING INFORMATION

PROJECT:		TYPE:	
CATALOG #:		DATE:	

CAT. NO	LED SOURCE	LUMEN OUTPUT	CRI	VOLTAGE
3G-1PLI-D	TW - TUNABLE WHITE (2700K-6500K) RGBW - INFINITE COLOUR ¹ (3500K WHITE)	D250 - LOW OUTPUT (250 LM/FT) ² D500 - MEDIUM OUTPUT (500 LM/FT) D750 - HIGH OUTPUT (750 LM/FT) D1000 - VERY HIGH OUTPUT (1000 LM/FT) ³ DC___ - CUSTOM OUTPUT (SPECIFY LM/FT)* *Specify custom lumen outputs in 50lm increments (ie: DC600, DC650, DC700) Custom output cannot exceed DC1000 Lumen outputs suitable for white LED source only	S80 - 83+ CRI H90 - 93+ CRI ¹	UNV - 120/277V

DRIVER	LENS OPTION	FINISH	CABLE LENGTH
DO1 - 0-10V (100-0.1%) DALI - DALI (eidoLED, 100-1%) DMX - DMX (eidoLED, 100-0%) ¹ DHLT - LUTRON T SERIES (100-1%) (2 CHANNEL TUNABLE WHITE)	FL - FLUSH DASY - ASYMMETRIC OPTIC ¹	WH - WHITE (STANDARD) SV - SILVER BK - BLACK All mounting canopies provided in white as standard	60" - 60" (STANDARD) 120" - 120"

OPTIONS	LENGTH (FEET)
EMC - EMERGENCY CIRCUIT ⁴	S - ___' (STRAIGHT RUN)* L - ___'X ___' (L-SHAPE) U - ___'X ___' X ___' (U-SHAPE) R - ___'X ___' (RECTANGLE/SQUARE) T - ___'X ___' (T-SHAPE) X - ___'X ___' (X-SHAPE) CUS - ___ (CUSTOM LAYOUT - PROVIDE DRAWING) *Individual units available from 2' to 8' Continuous runs available in 1' increments

- ¹ RGBW LED source available with S80 (83+CRI) and DMX driver option only. Not available with asymmetric optic or EM options
² D250 (250LM/FT) not available in 2' and 3' lengths. Specify DC400 for 2' and 3' fixture lengths when outputs lower than 500LM/FT are required
³ D1000 (1000LM/FT) not available for H90 (93+ CRI)
⁴ EMC (emergency circuit) options available for tunable white LED source only. Not available with RGBW

3GT - Tunable White
3GB - RGBW

JANUARY 4, 2024



PERFORMANCE CHART BASED ON 4' LENGTH WITH FLUSH LENS (TUNABLE WHITE AND 83+ CRI)

COLOR TEMP	DELIVERED LUMENS (LM/FT)	SYSTEM WATTS (W/FT)	EFFICACY (LPW)
2700K	250	3.0	84
	500	6.1	81
	750	9.4	80
	1000	12.5	79
3500K	250	3.0	90
	500	6.1	88
	750	9.4	85
	1000	12.5	83
6500K	250	3.0	102
	500	6.1	103
	750	9.4	98
	1000	12.5	92
EFFICACY (LPW) ADJUSTMENT FACTOR	CRI	Multiplier	
	93+	0.88	

PHOTOMETRY BASED ON 4' LENGTH (83+ CRI AND 3500K SOURCE)

FL - FLUSH

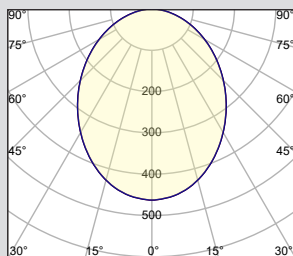

3G-1PLI-D-TW-L500-S80-FL

DELIVERED LUMENS: 500LM/FT (2000LM)
SYSTEM WATTS: 6.1W/FT (24.4W)
EFFICACY: 88LPW
CRI: 83+
CCT: 3500K
LENS OPTION: FLUSH

DASY - ASYMMETRIC OPTIC

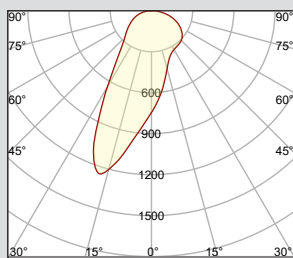

3G-1PLI-D-TW-L500-S80-DASY

DELIVERED LUMENS: 500LM/FT (2000LM)
SYSTEM WATTS: 6.1W/FT (24.4W)
EFFICACY: 84LPW
CRI: 83+
CCT: 3500K
LENS OPTION: ASYMMETRIC

PERFORMANCE CHART BASED ON 4' LENGTH (RGBW WITH 83+ CRI AND 3500K SOURCE)

COLOR TEMP	DELIVERED LUMENS (LM/FT)	SYSTEM WATTS (W/FT)	EFFICACY (LPW)
3500K	250	2.6	95
	500	5.4	93
	750	8.9	85
	1000	13.0	77
LUMINOUS INTENSITY PER LED	RGB	INTENSITY Min - Max (mcd)	
	RED	355 - 805	
	GREEN	710 - 1400	
	BLUE	140 - 355	

PHOTOMETRY BASED ON 4' LENGTH (83+ CRI AND 3500K SOURCE)

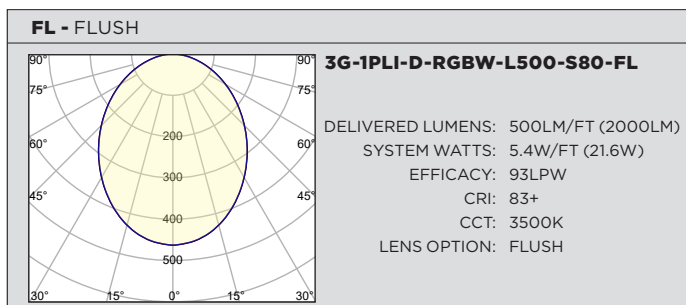

TECHNICAL**HOUSING**

Extruded aluminum housing with narrow 1.5" aperture
Machined aluminum end caps add 1/4" to each end of luminaire
Individual units and continuous runs available in 1' increments
24-gauge LED reflector with high reflectance white powder coated finish
Standard polyester powder coated matte white finish.
Optional finishes available

OPTICS

Extruded, satin acrylic lens designed for optimal performance and glare control. Up to 8' continuous
High performance asymmetric optics available

ELECTRICAL

Luminaires are pre-wired with factory installed quick connects and branch circuit wiring
Multiple driver options available for tunable white LED system
DMX driver option for RGBW system with RDM control and 100-0% dimming range
All drivers are integral and easily accessible through luminaire aperture

LED SYSTEM FOR TUNABLE WHITE (TW)

Proprietary LED system with color consistency <3 SDCM
2700K-6500K CCT range
Standard 83+CRI. Optional 93+CRI. (R9 value of 56 for 93+CRI)
L90 >60,000 hours
5 Year Warranty

LED SYSTEM FOR RGBW

Proprietary LED system with color consistency <3 SDCM
White LED available in 35K with 83+ CRI
L80 >72,000 hours
Red (335-805 mcd)
Green (710-1400 mcd)
Blue (140-355 mcd)
5 Year Warranty

MOUNTING

Toolless installation with 3G's proprietary mounting system
Internal, toolless joiner system (latch and hook) easily connects multiple sections together
LED reflectors remain within each fixture section during installation with 3G's click and lock spring system
Adjustable aircraft cable suspension with locking fasteners (60" length standard)
White cable and white mounting canopies provided as standard
Suitable for various architectural ceilings (see mounting details)
Fixture weight: +/- 2.5 lb/ft

LISTING

ETL listed and tested to cUL standards. Suitable for dry and damp locations

WARRANTY

5 Year Warranty on LED and drivers
Manufacturer 1 Year Warranty for defects in material and workmanship under normal use
Ambient temperature at fixture should not exceed 25°C

DRAWINGS AND DIMENSIONS

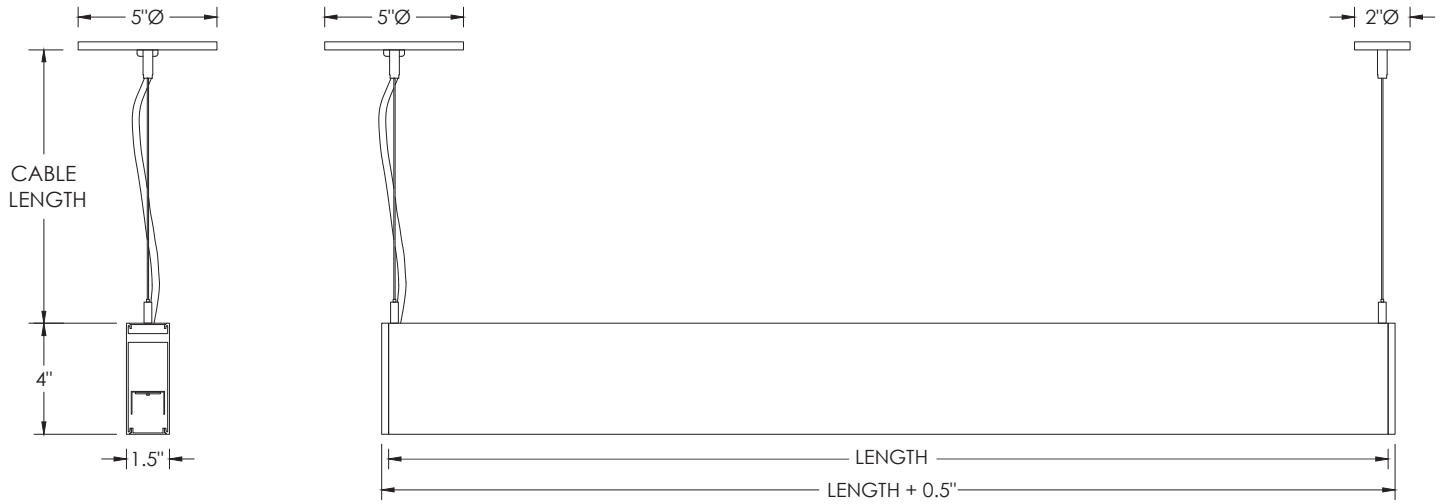

LENS OPTION

FL - FLUSH **ASY** - ASYMMETRIC

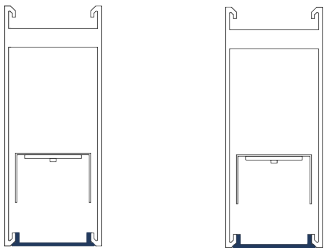

PATTERNS

Specify pattern shape and overall dimensions as shown below. Available in 1' increments only
Patterns are connected with fully illuminated 12"x12" L, T, and X-shaped sections

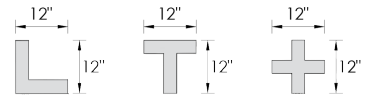

L-SHAPE	U-SHAPE	RECTANGLE/SQUARE	T-SHAPE	X-SHAPE
Provide dimensions of AxB Example: L - 6'x8'	Provide dimensions of AxBxC Example: U - 8'x10'x6'	Provide dimensions of AxB Example: R - 10'x8'	Provide dimensions of AxB Example: T - 14'x6'	Provide dimensions of AxB Example: X - 14'x14'

TYPICAL SECTION MOUNTING (AVAILABLE IN 1' INCREMENTS AS STANDARD)

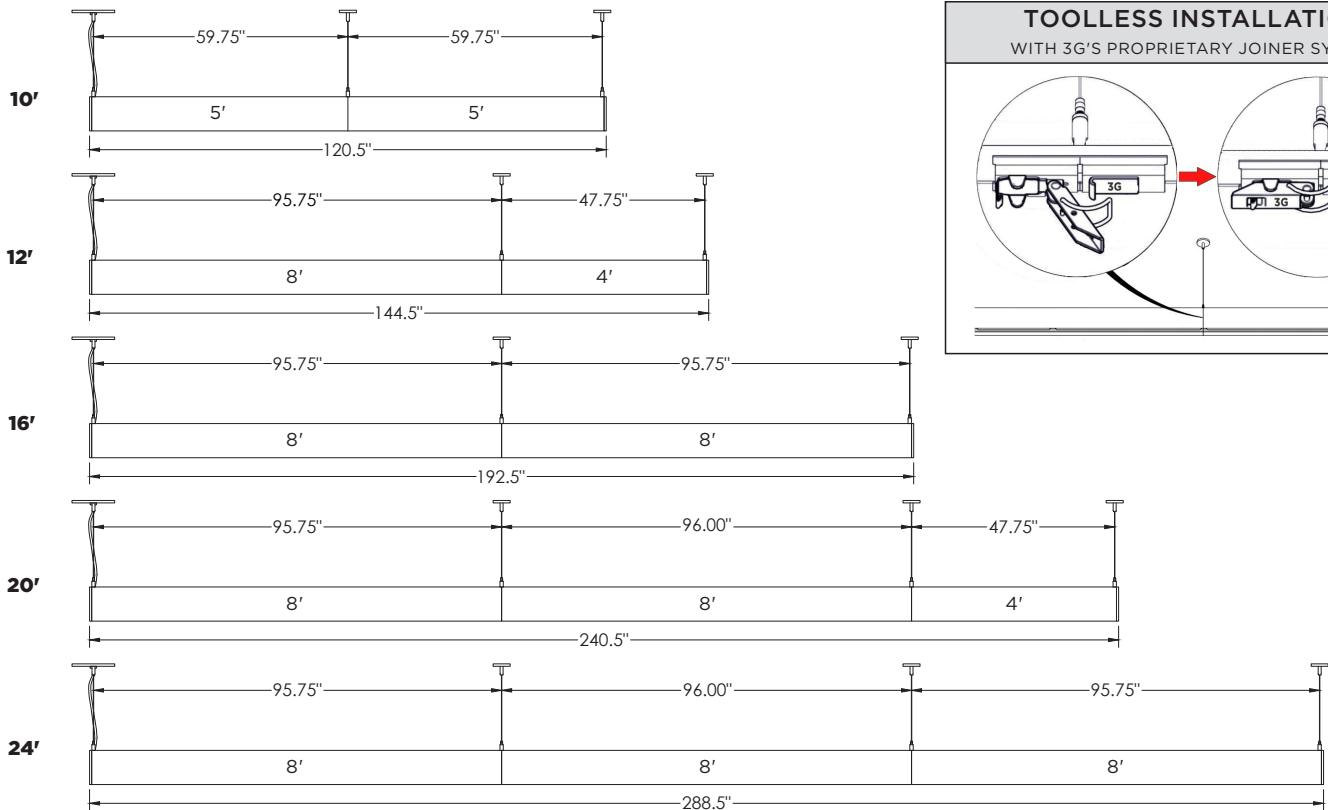

TOOLLESS INSTALLATION WITH 3G'S PROPRIETARY JOINER SYSTEM

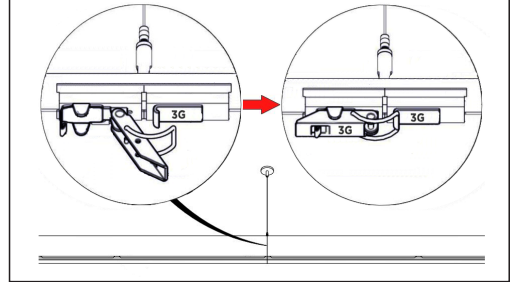

MOUNTING DETAILS

