

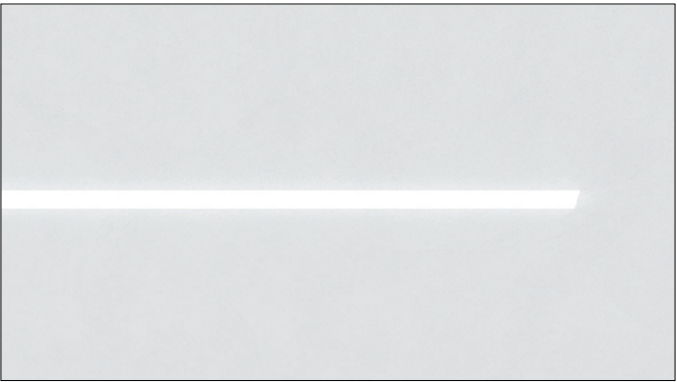

3G-1RLI
1.5" RECESSED LINIA
GRID CEILING



FOR NEW CONSTRUCTION INSTALLATION ONLY

FIXTURE TYPES	INCLUDED COMPONENTS
<p>1RLI PROFILE</p>	<p>Standalone Fixtures (2' to 8')</p> <p>INDIVIDUAL LENS</p>
<p>Continuous Runs (9' to 16')</p> <p>STARTER ENDER LENS</p>	<p>Continuous Runs (17' and longer)</p> <p>STARTER JOINER ENDER LENS</p>

INSTRUCTION KEY	INFORMATION
ADDITIONAL	INSTALLATION SHOULD ONLY BE PERFORMED BY A CERTIFIED ELECTRICIAN
ATTENTION	REFER TO LOCAL/NATIONAL CODES FOR PROPER INSTALLATION
POWER ON	FAILURE TO FOLLOW INSTALLATION INSTRUCTION MAY VOID THE WARRANTY
POWER OFF	DO NOT TOUCH LEDS. LEDS MUST BE PROTECTED FROM MECHANICAL STRESS OR DEBRIS
	TURN OFF POWER DURING INSTALLATION OR SERVICING

OVERVIEW

3G-1RLI - GRID CEILING -GCX

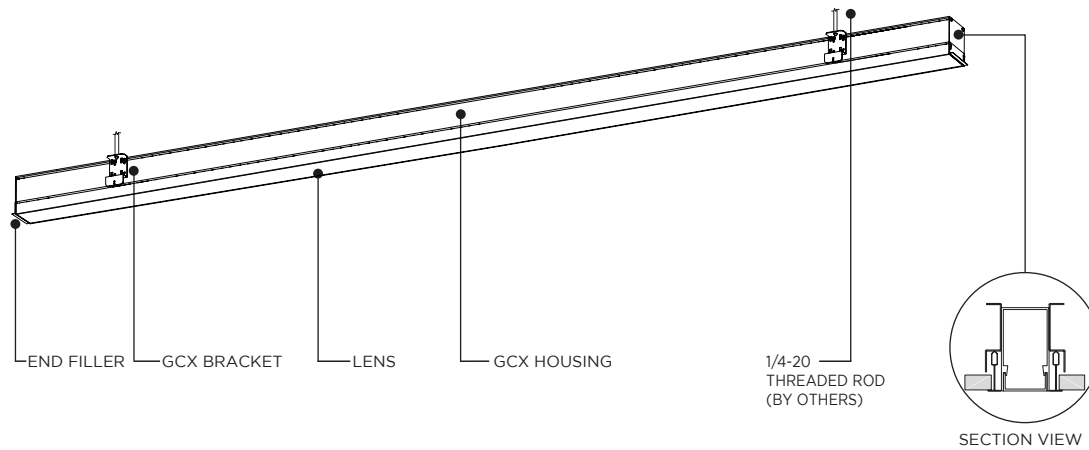

GRID CEILING FLANGE - GCX

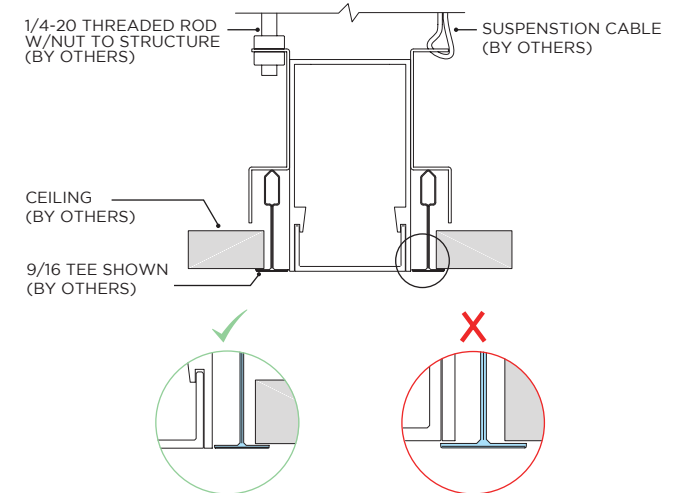

i FIXTURE EDGE MUST SIT ALONG SIDE TEE

3G-1RLI MOUNTING BRACKET

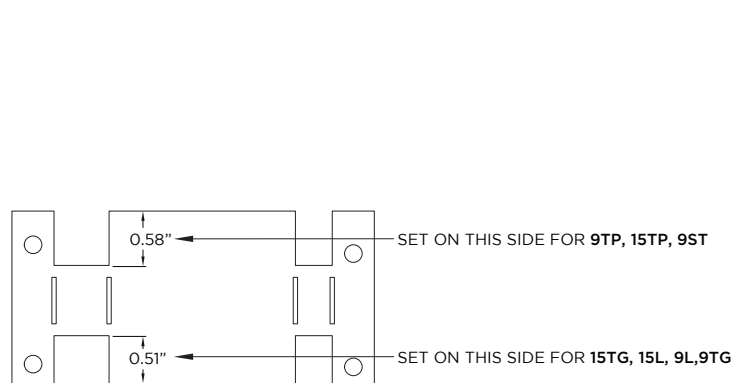

FOLD FOR 15" TEE BAR

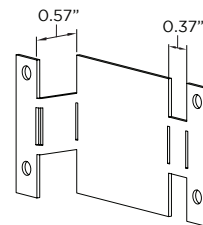

FOLD FOR 9" TEE BAR

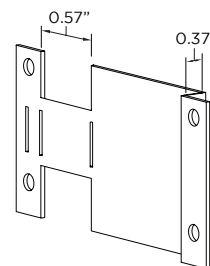

i UNIVERSAL MOUNTING BRACKET FOR ALL GRID CEILING TYPES

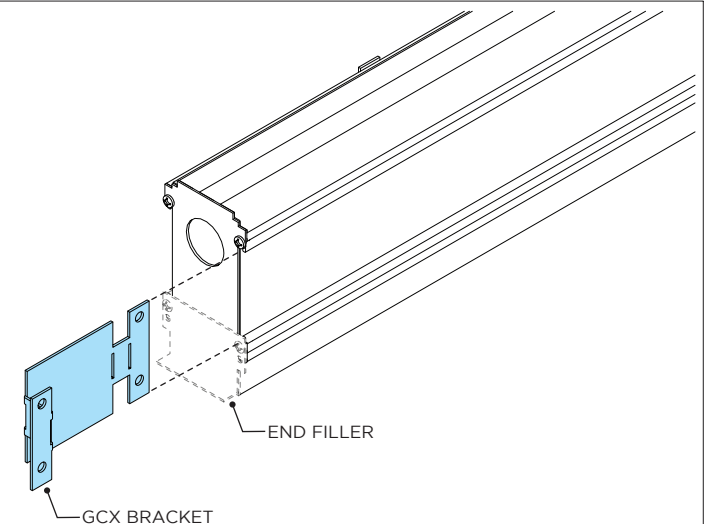

SLIDE GCX BRACKETS INTO HOUSING EXTRUSION

i FOR START/END SECTIONS, REMOVE END FILLER BEFORE GCX BRACKET INSTALLATION

ASYMMETRIC LENS ORIENTATION

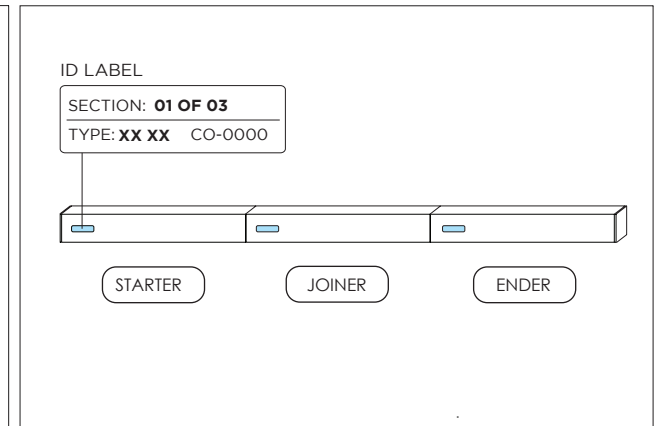
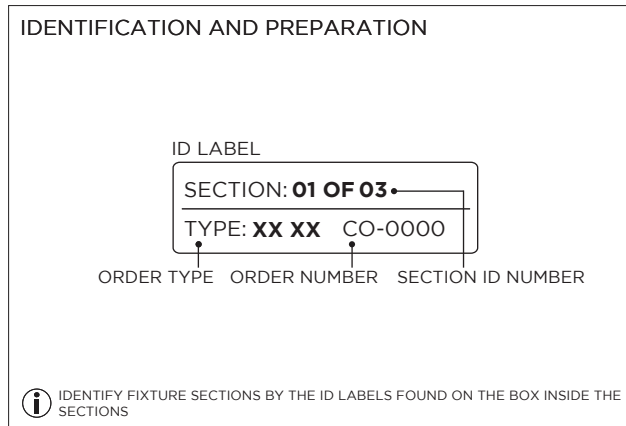
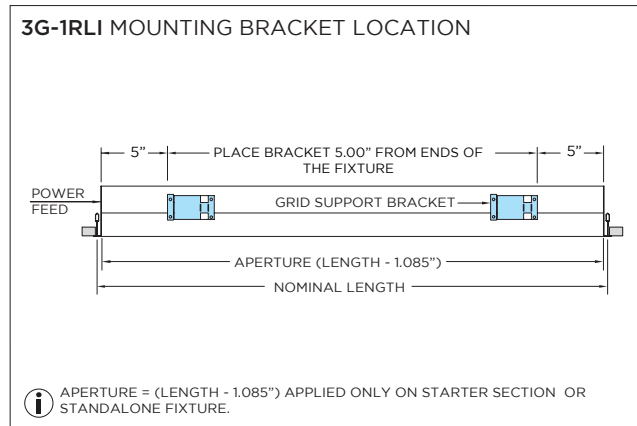
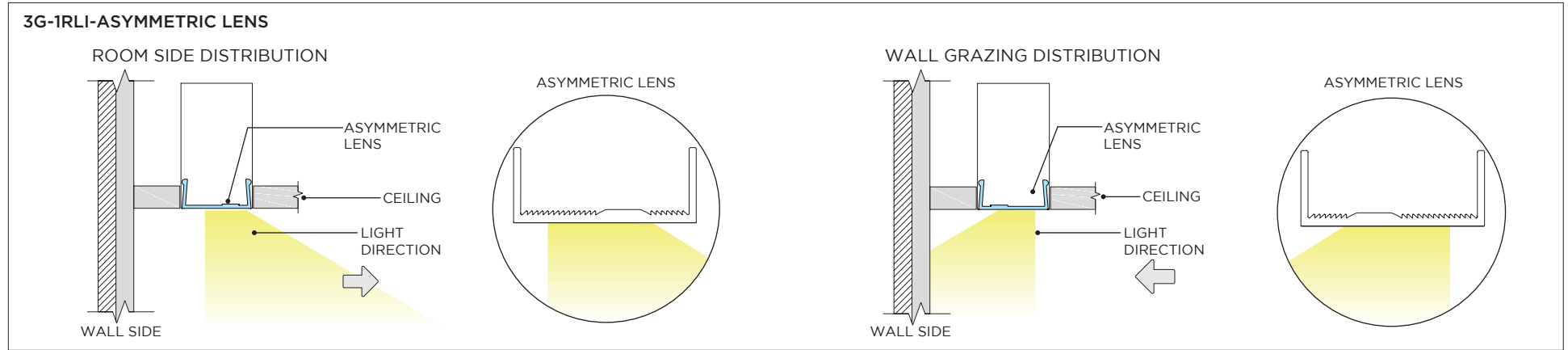

MOUNTING TYPES & T-BAR WIDTH

3G-1RLI-GCX

9L - 9/16" LAYIN

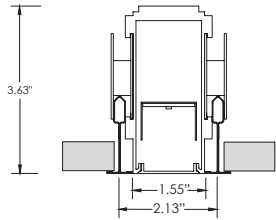

9TG - 9/16" TEGULAR

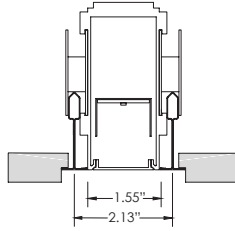

9TP - 9/16" TEGULAR

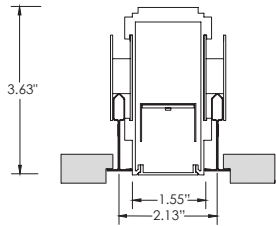

15L - 15/16" LAYIN

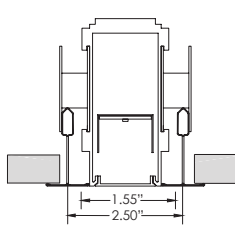

15TG - 15/16" TEGULAR

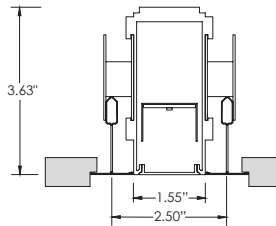

15TP - 15/16" TEGULAR

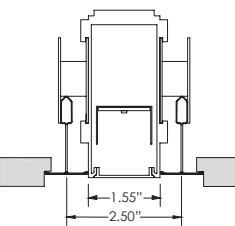

9ST - 9/16" SLOT TEE TEGULAR

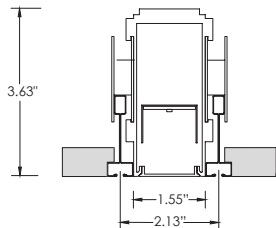

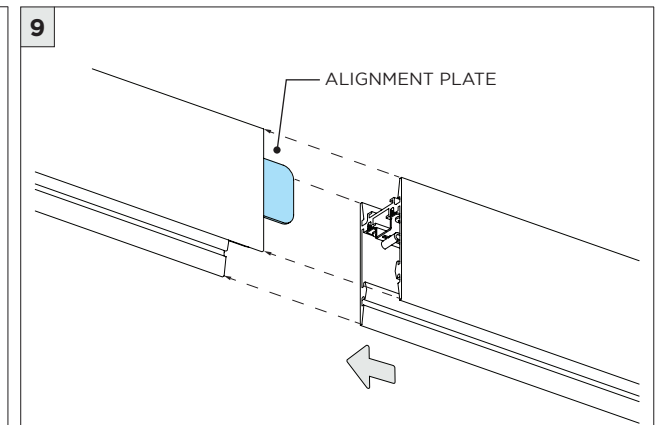
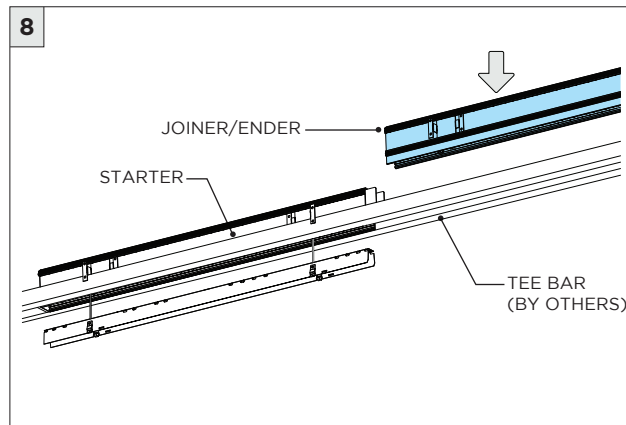
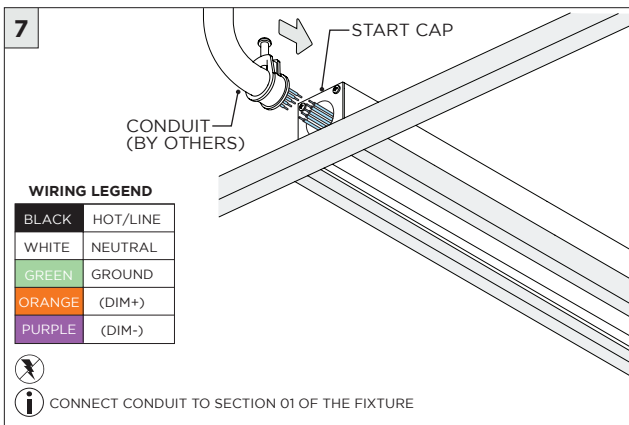
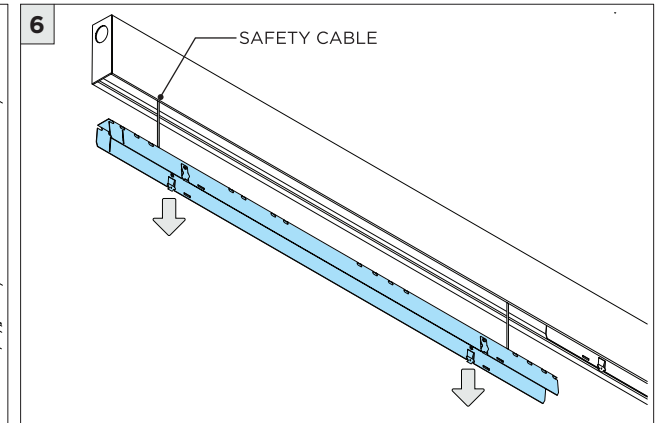
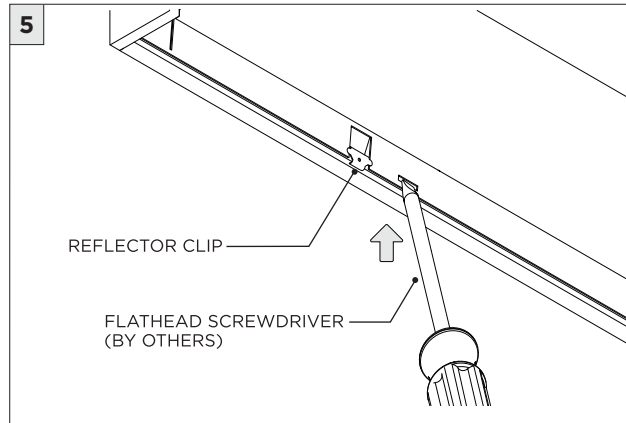
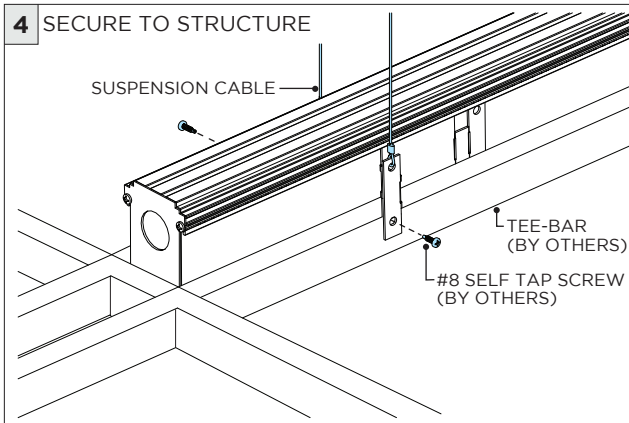
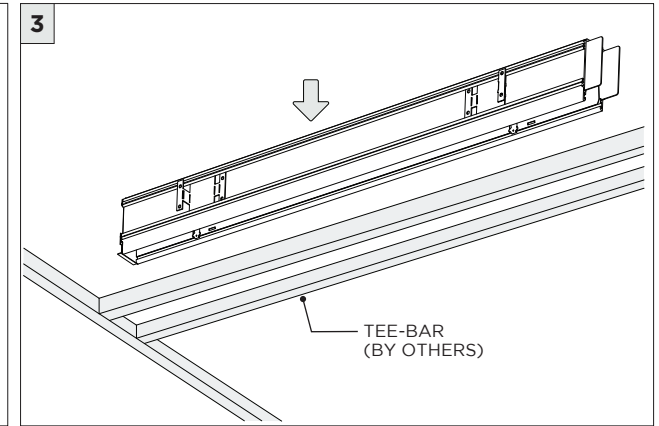
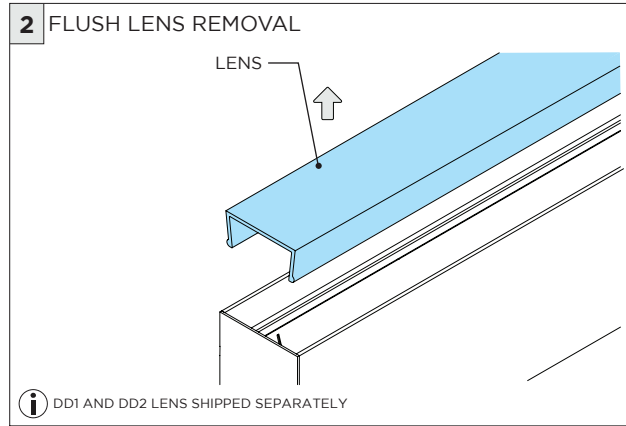
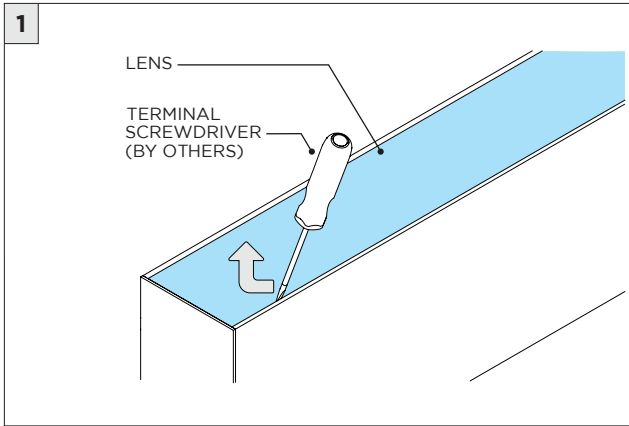

10

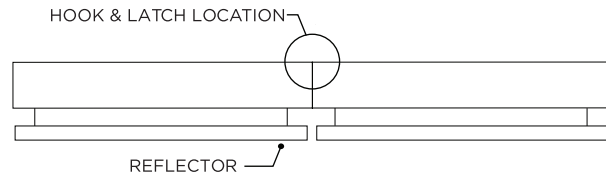

i REMOVE BOTH REFLECTORS TO ACCESS HOOK AND LATCH MECHANISM

11

⚠ MECHANISM IS NOT INTENDED TO
PULL SECTIONS TOGETHER

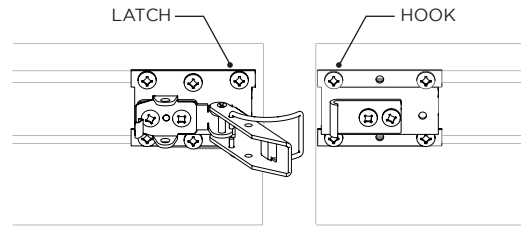

i LEVEL FIXTURES BEFORE ENGAGING
HOOK & LATCH MECHANISM

12

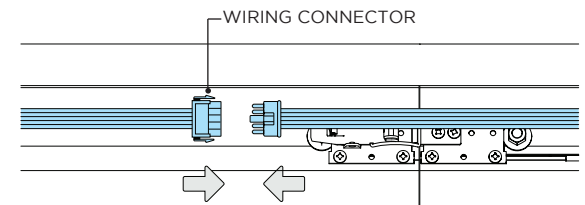

⊗

13

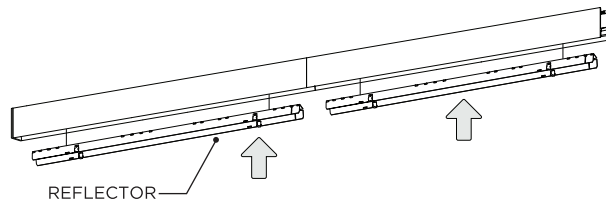

14

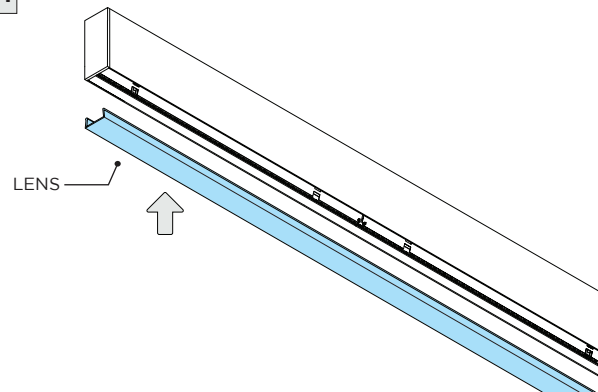

DRIVER SERVICING

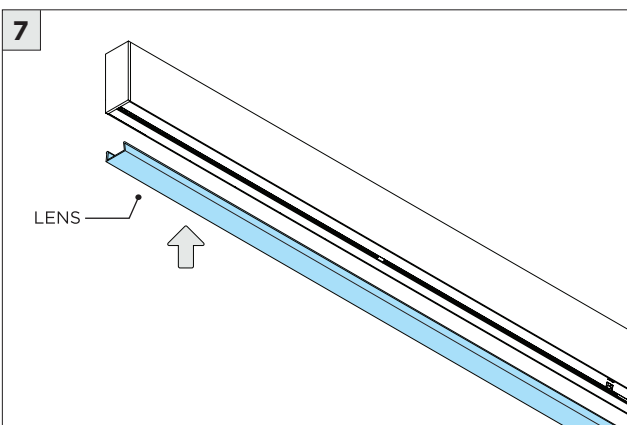
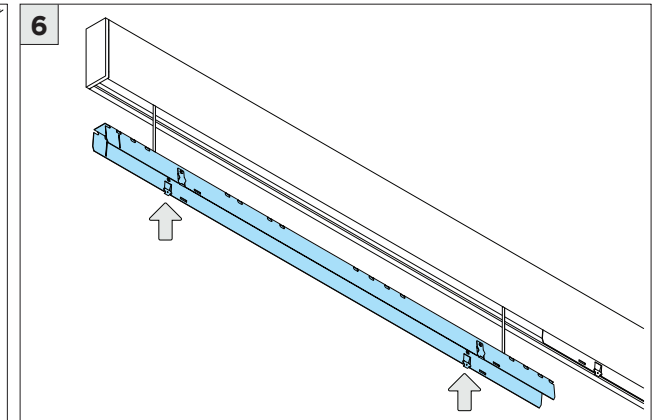
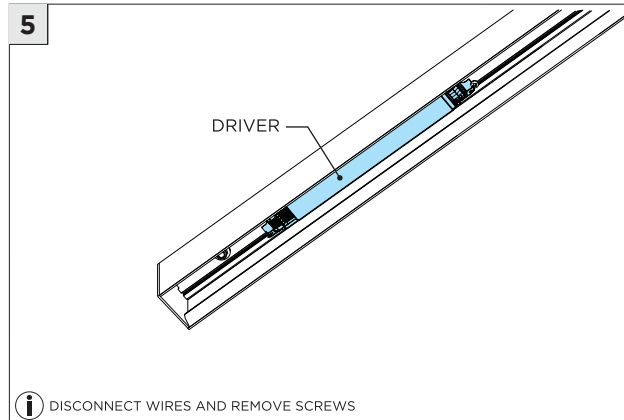
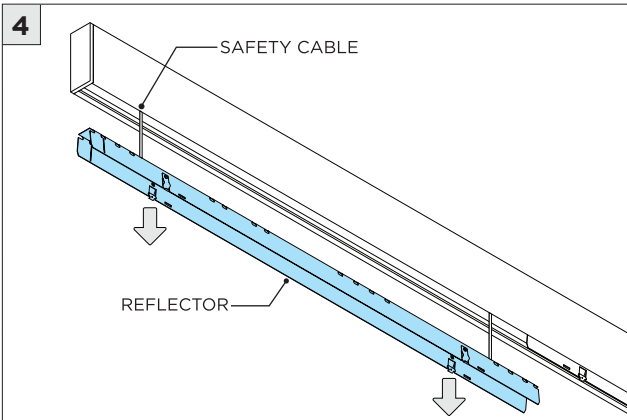
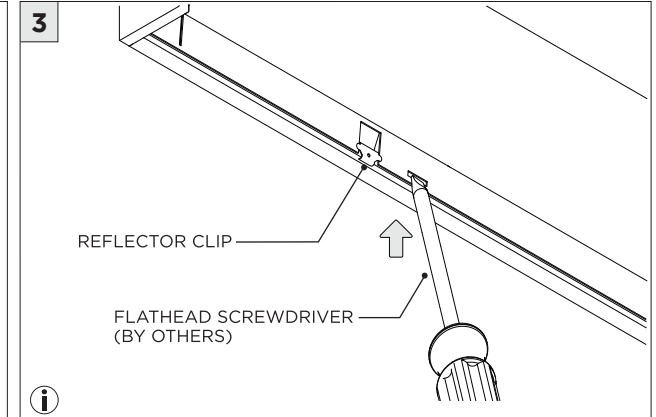
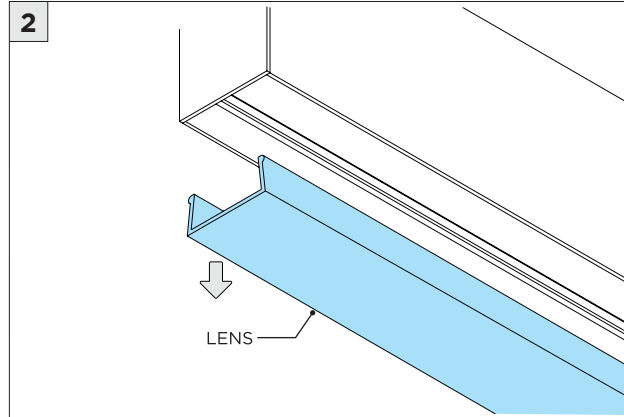
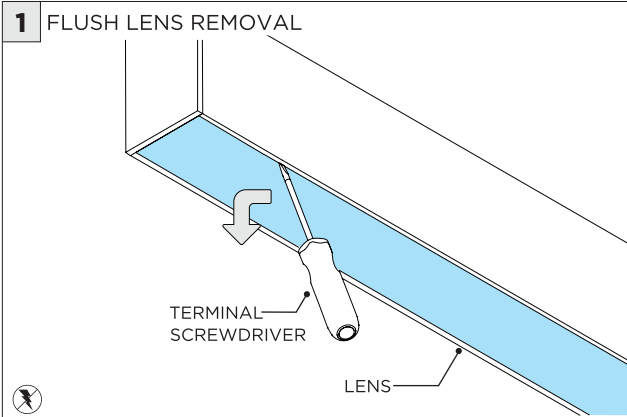

LED SERVICING - DIRECT

