

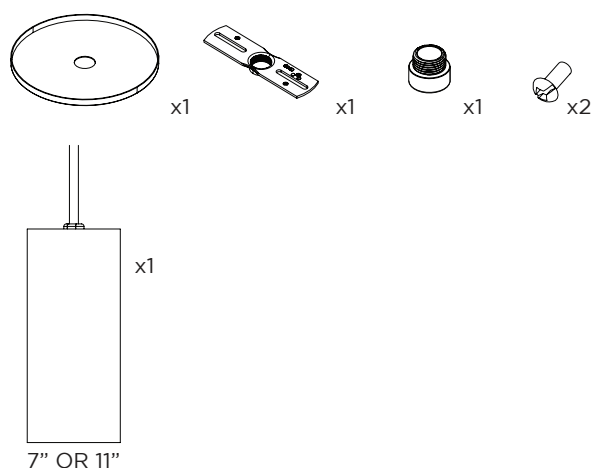

THE IMAGES SHOWN ARE FOR ILLUSTRATION ONLY AND MAY NOT BE AN EXACT REPRESENTATION OF THE PRODUCT

### COMPONENTS

#### STANDARD CANOPY



#### CONDUIT FEED CANOPY

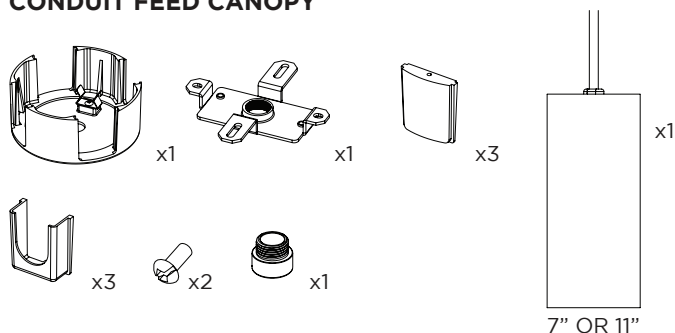

#### POWER CANOPY

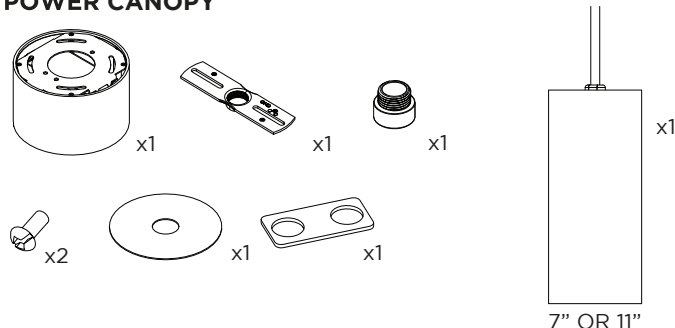

#### 4" OCTAGONAL J-BOX REQUIRED FOR INSTALLATION

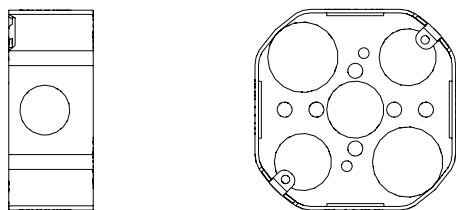

JUNCTION BOX (BY OTHERS)

INSTRUCTION KEY	INFORMATION
⚠	ADDITIONAL
i	ATTENTION
⚡	POWER ON
⚡	POWER OFF
	<p>INSTALLATION SHOULD ONLY BE PERFORMED BY A CERTIFIED ELECTRICIAN</p> <p>REFER TO LOCAL/NATIONAL CODES FOR PROPER INSTALLATION</p> <p>FAILURE TO FOLLOW INSTALLATION INSTRUCTION MAY VOID THE WARRANTY</p> <p>DO NOT TOUCH LEDS. LEDS MUST BE PROTECTED FROM MECHANICAL STRESS OR DEBRIS</p> <p>TURN OFF POWER DURING INSTALLATION OR SERVICING</p>

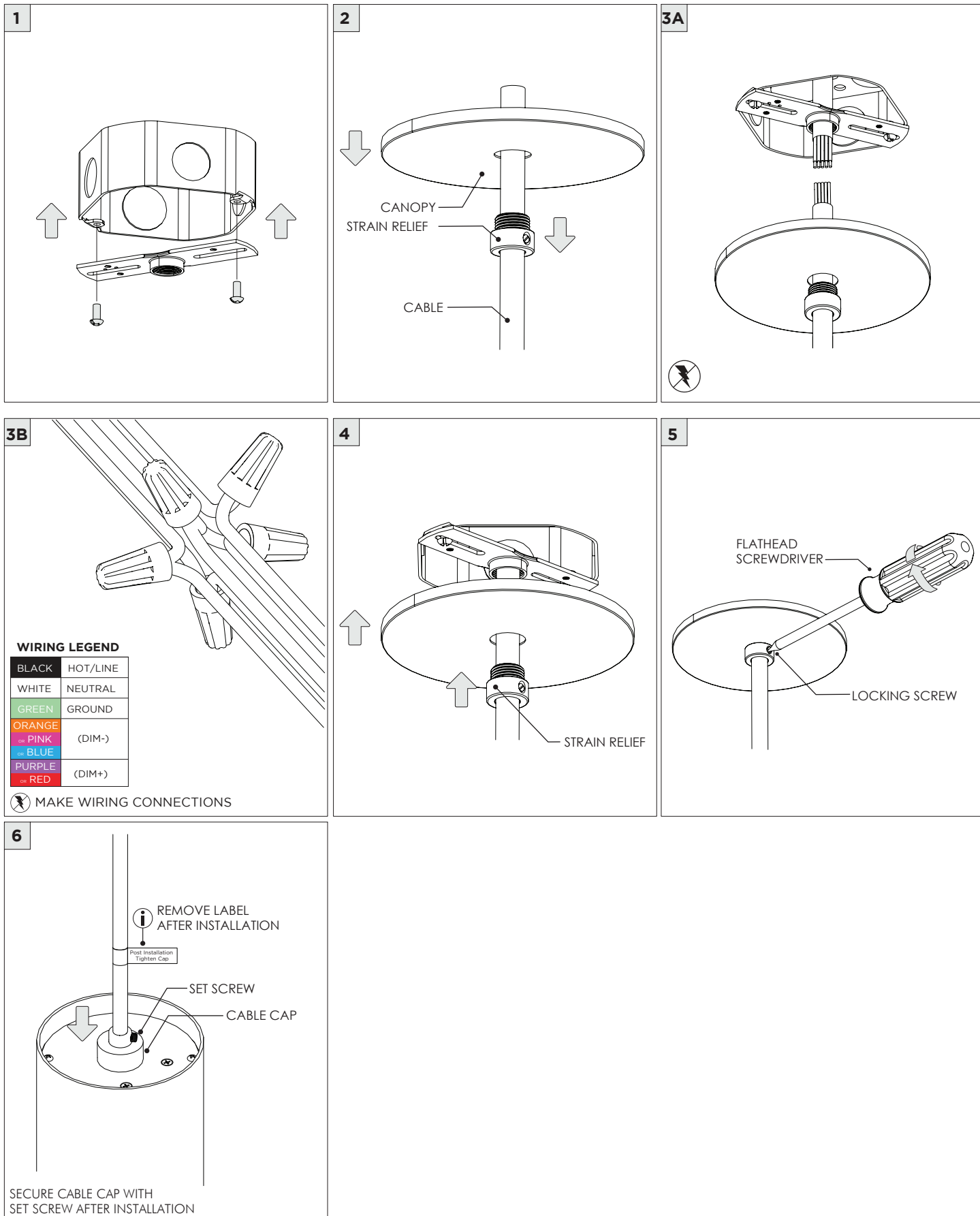

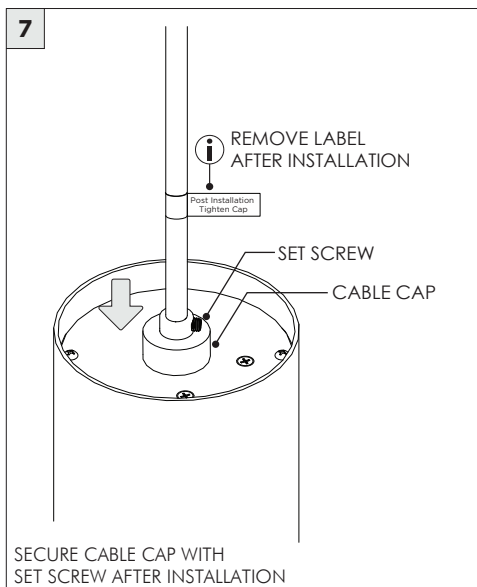
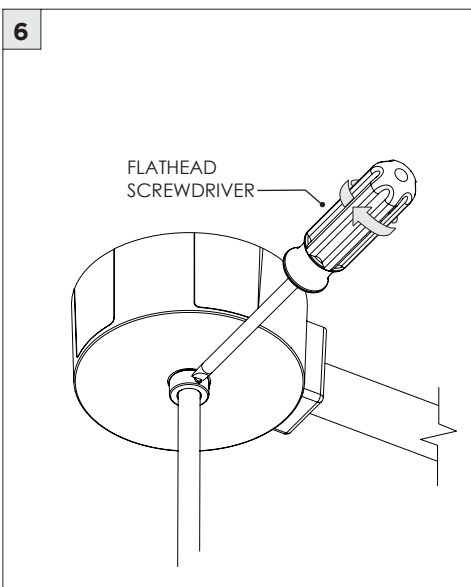
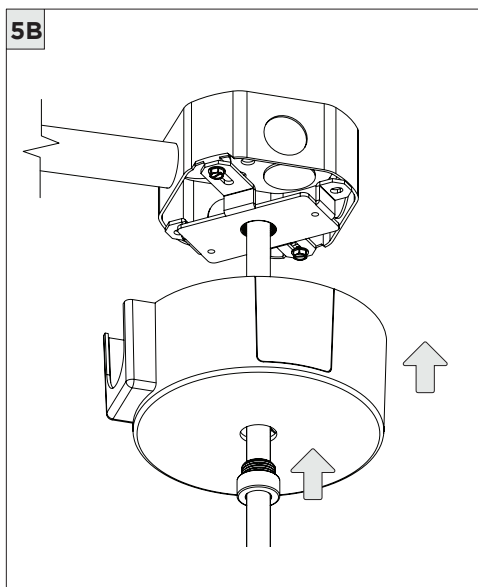
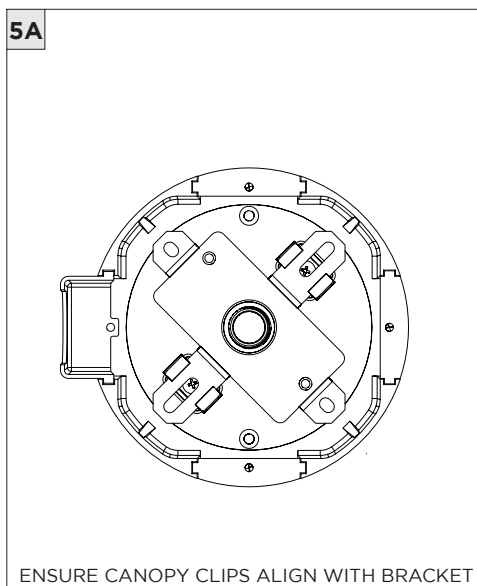
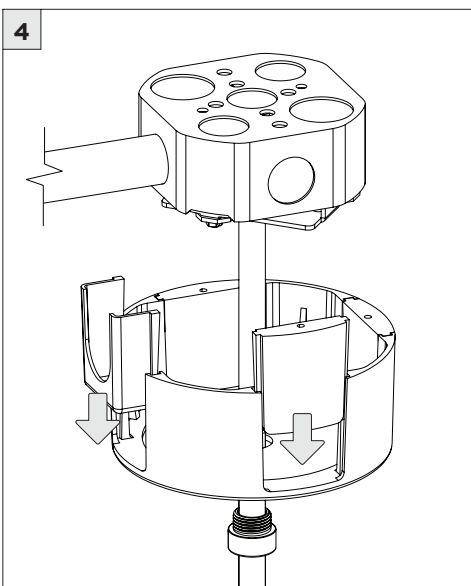
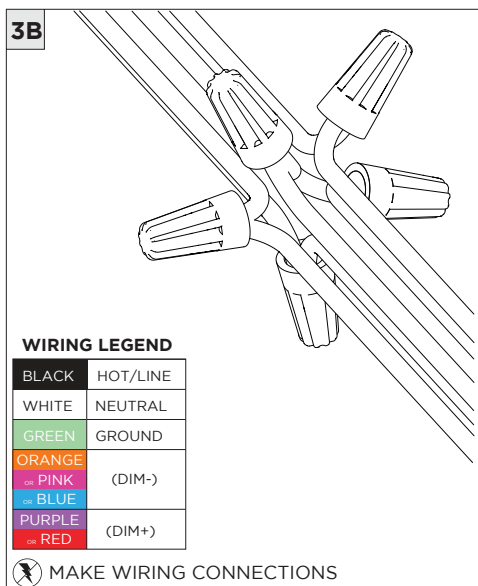
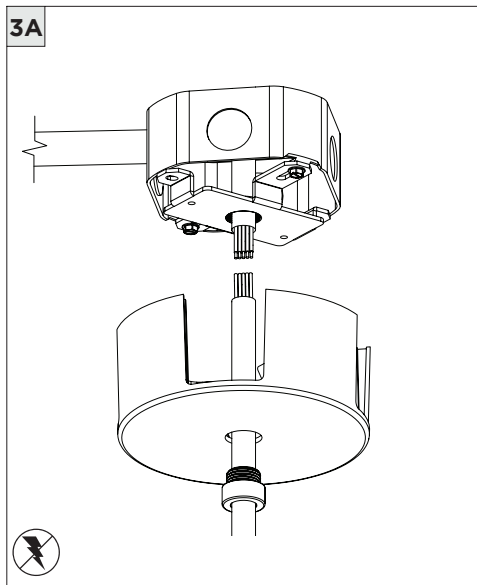
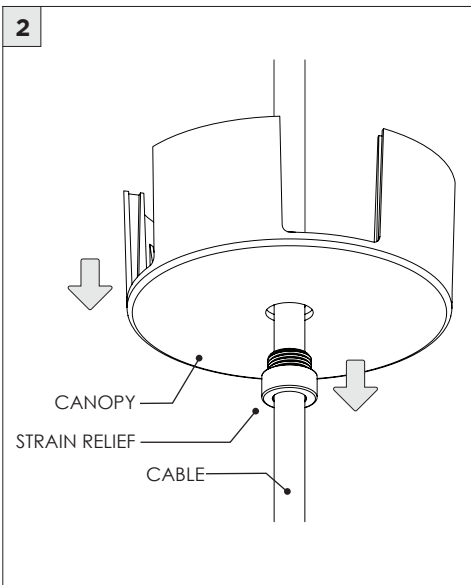
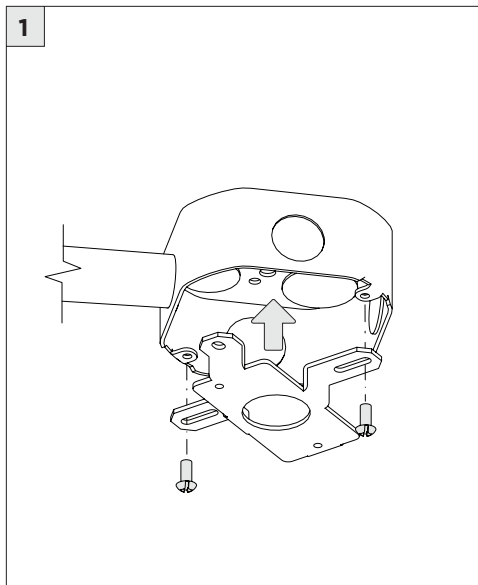

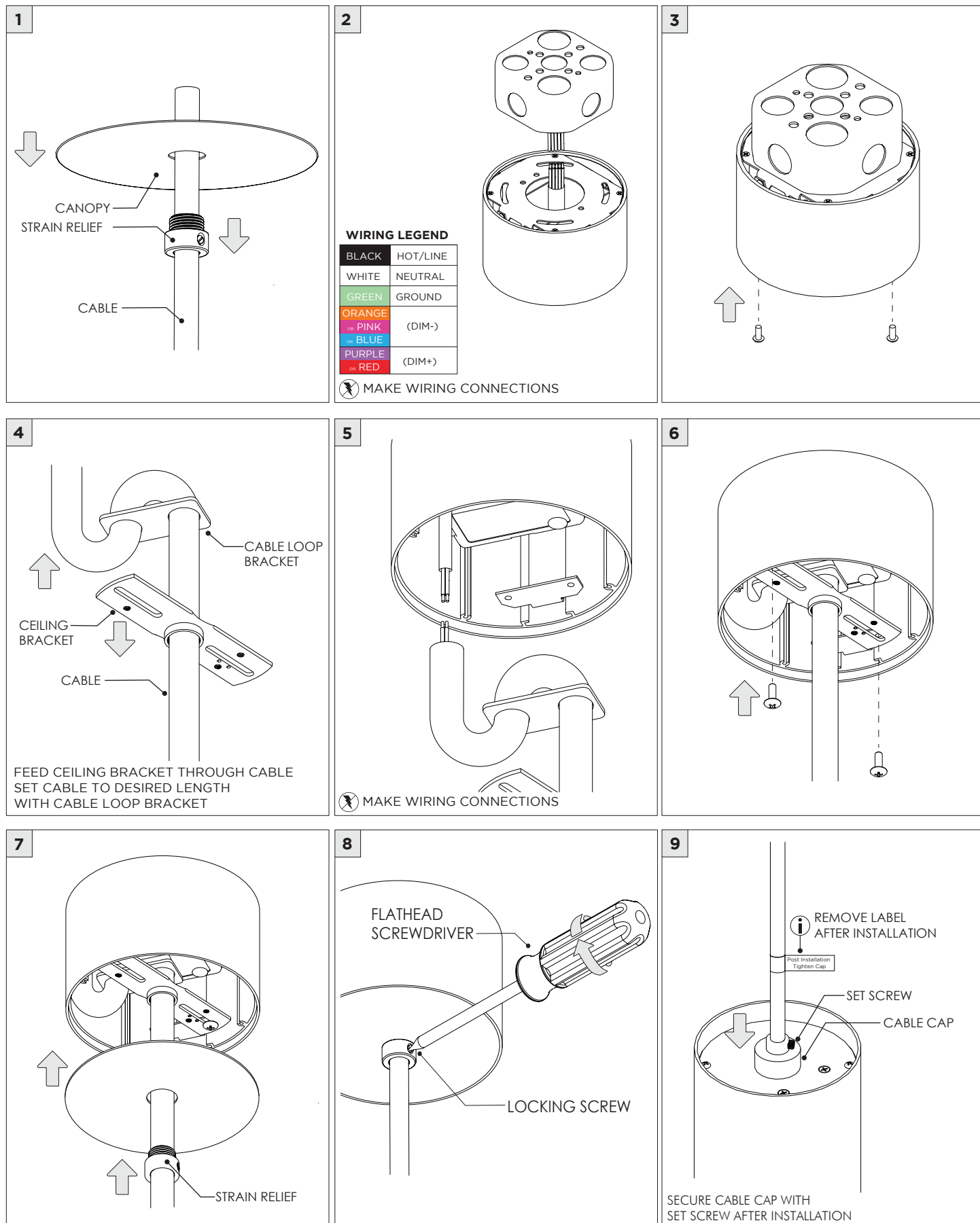

**1 CONDUIT FEED CANOPY**

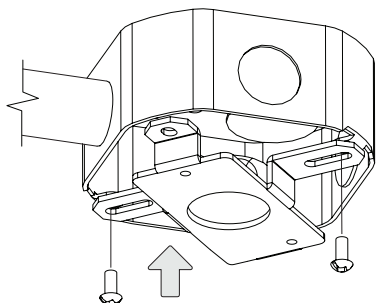

**2**

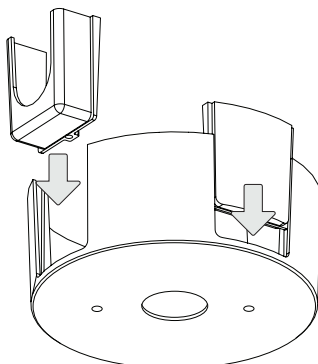

**3**

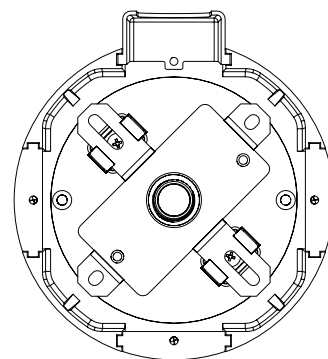

ENSURE CANOPY CLIPS ALIGN WITH BRACKET

**4**

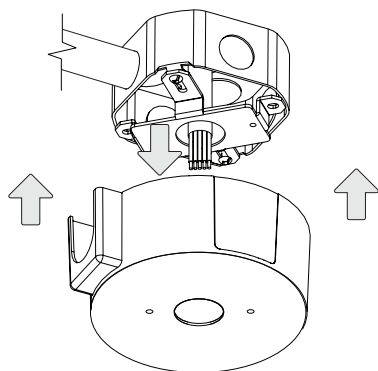

CONNECT CONDUIT CANOPY AND FEED  
JUNCTION BOX WIRES THROUGH HOLE

**5**

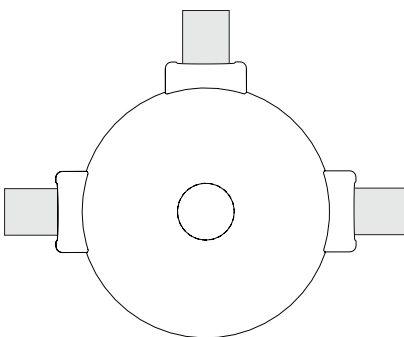

**!** CANOPY IS SUITABLE FOR  
MAXIMUM 3 CONDUIT FEEDS

**6 POWER CANOPY**

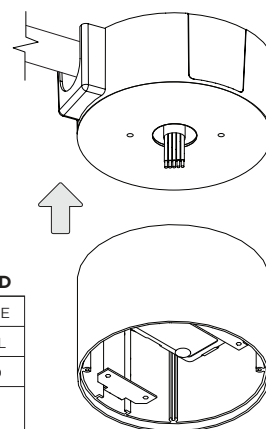

**WIRING LEGEND**

BLACK	HOT/LINE
WHITE	NEUTRAL
GREEN	GROUND
ORANGE	(DIM-)
PINK	(DIM-)
BLUE	(DIM-)
PURPLE	(DIM+)
RED	(DIM+)

**⚡** MAKE WIRING CONNECTIONS

**7**

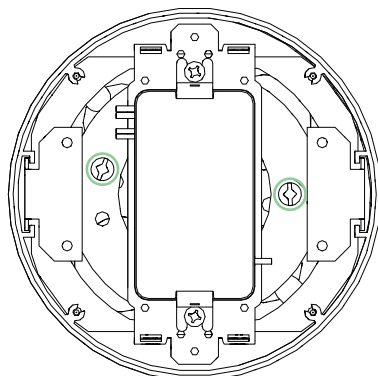

**8**

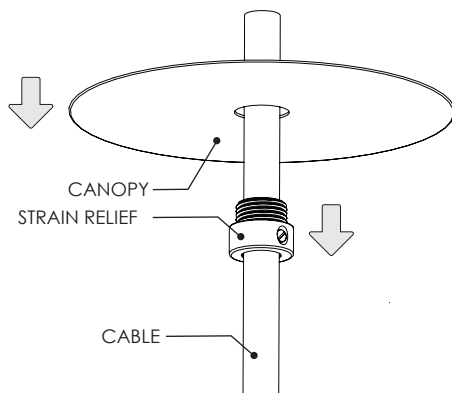

**9**

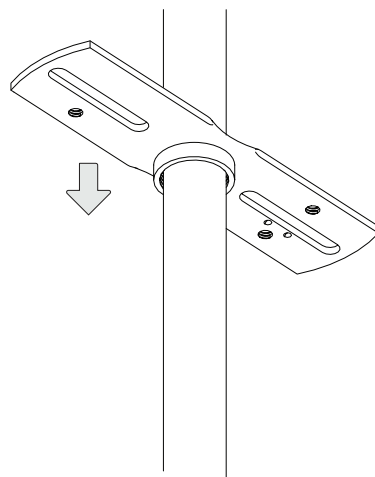

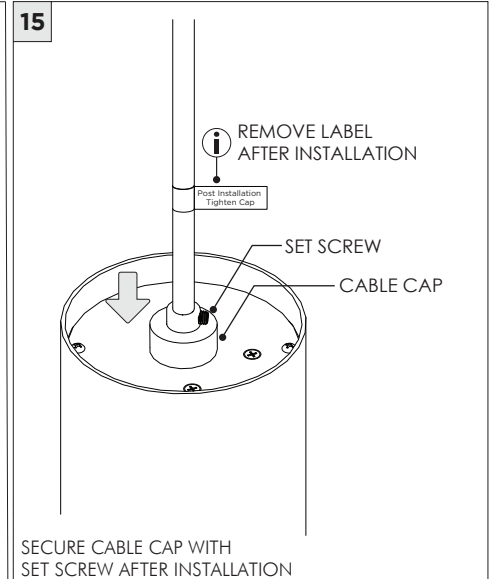
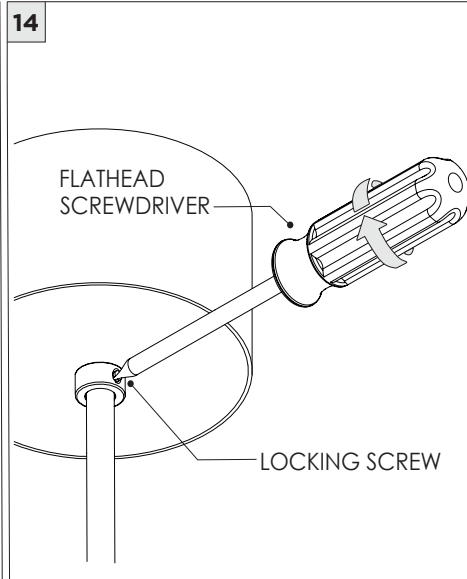
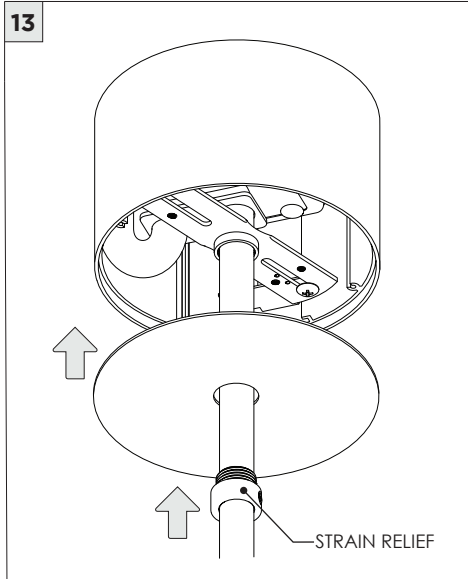
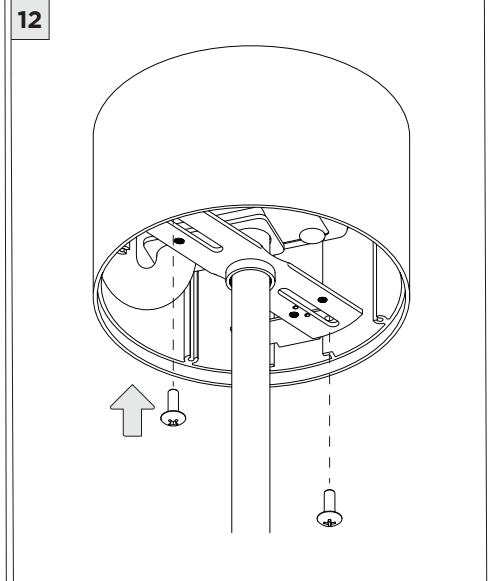
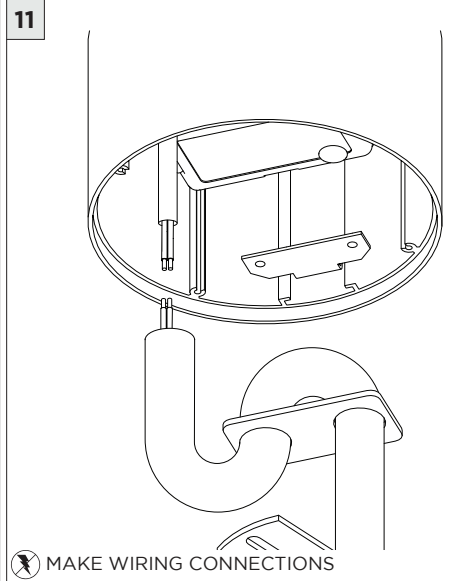
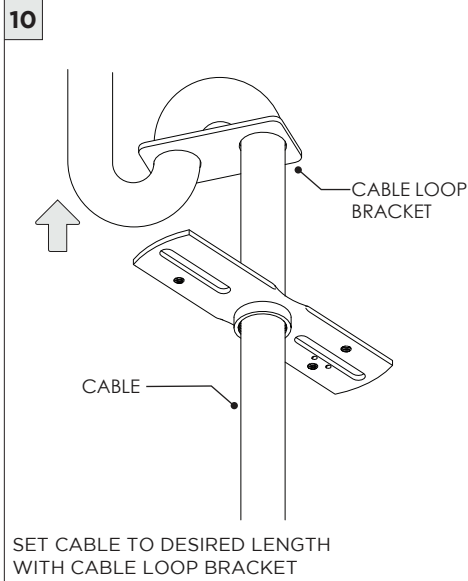

## DRIVER SERVICING

1

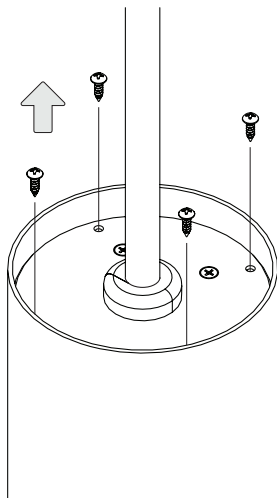

2

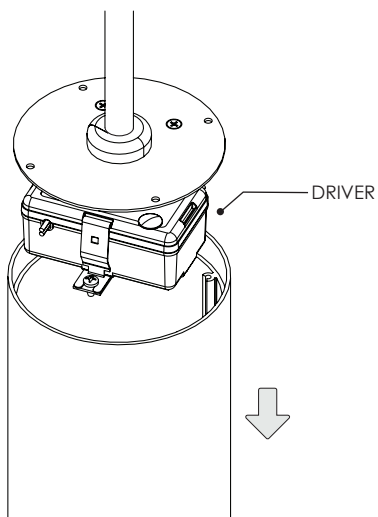

## LED SERVICING

1

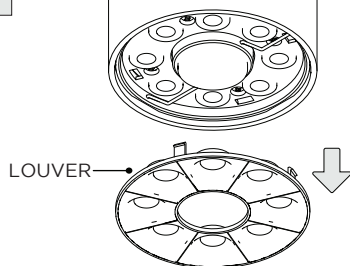

UNCLIP LOUVER FROM LED ASSEMBLY

2

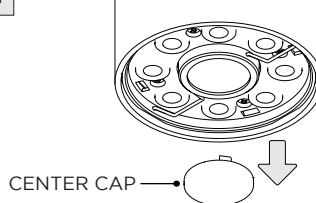

UNCLIP CENTER CAP FROM LED ASSEMBLY

3

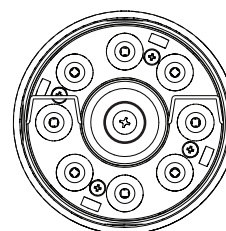

LOCATE CENTER SCREW

4

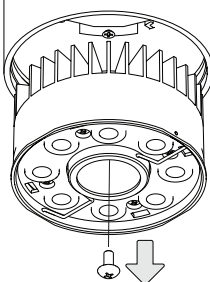

UNSCREW CENTER SCREW TO REMOVE LED ASSEMBLY

5

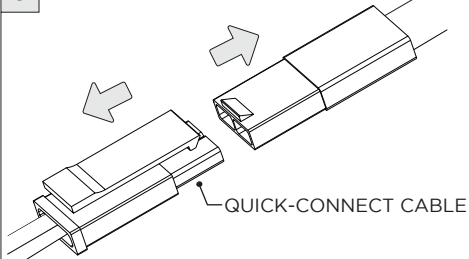

DISCONNECT QUICK-CONNECT CABLE FROM LED ASSEMBLY

6

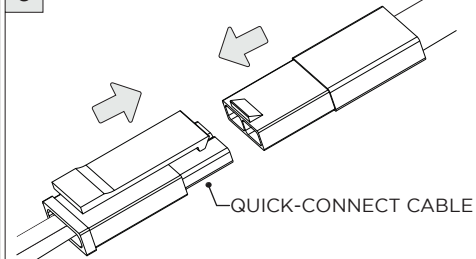

CONNECT QUICK-CONNECT CABLE TO NEW LED ASSEMBLY

7

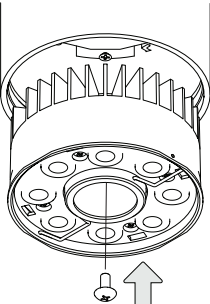

SCREW NEW LED ASSEMBLY INTO CYLINDER

8

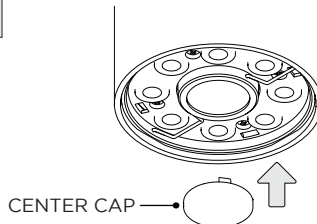

CENTER CAP

9

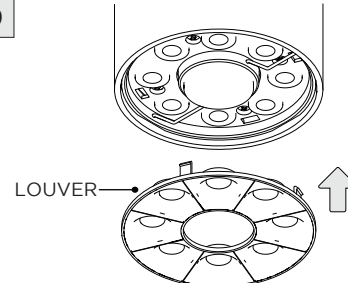

LOUVER

**DRIVER SERVICING**

**1**

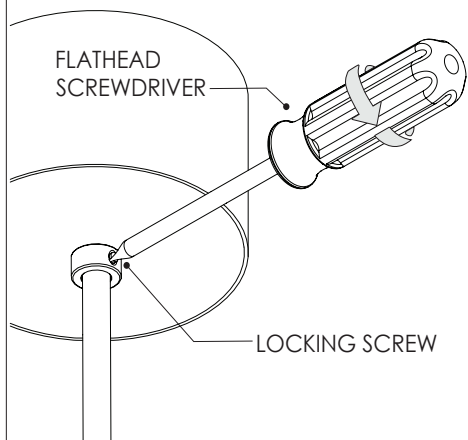

**2**

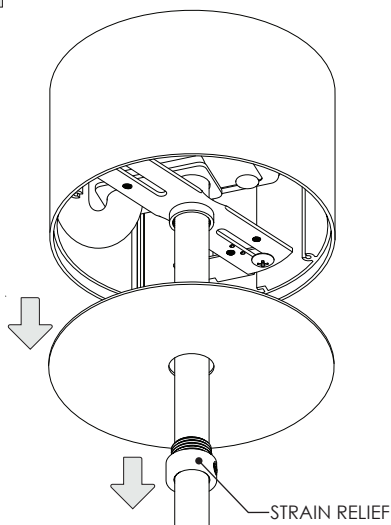

**3**

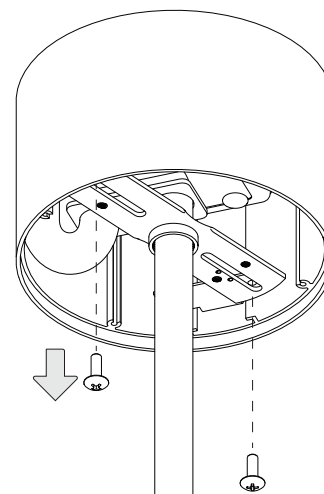

**4**

