

3G LIGHTING

3G-SDZ33RA

3" ADJUSTABLE ZOIE CYLINDER
3", 7" AND 11" HEIGHT

3" diameter adjustable Zoie cylinder with 0-90° tilt and 360° rotation
Companion to 3G-DZ33R Round Zoie Downlight
Regressed LED source provides maximum visual comfort, UGR <10
High gloss black or white louvers with proprietary optics and no glare
Extruded aluminum housing with powder coated finish
Lumen range up to 2000lm (80+ and 90+ CRI options)
100-1% dimming range standard with integral driver options



PROJECT:		TYPE:	
CATALOG#:		DATE:	QTY:

CAT. NO	FIXTURE HEIGHT	LUMEN OUTPUT (DELIVERED LUMENS)	CRI	COLOR TEMP
3G-SDZ33RA	3H - 3" HEIGHT * 7H - 7" HEIGHT * 11H - 11" HEIGHT <small>*3H & 7H up to 1750lm (80+CRI) *3H & 7H up to 1500lm (90+CRI)</small>	10 - 1000 LUMENS 15 - 1500 LUMENS 17 - 1750 LUMENS 20 - 2000 LUMENS <small>Lumen outputs are delivered lumens based on 80+ CRI, 3000K source. See performance chart for all options</small>	S80 - 80+ CRI H90 - 90+ CRI	27K - 2700K ¹ 30K - 3000K 35K - 3500K 40K - 4000K ¹

BEAM ANGLE	VOLTAGE	DRIVER	HOUSING FINISH	LOUVER FINISH
20D - 20° 40D - 40° 60D - 60°	UNV - 120/277V 120 - 120V 347 - 347V ²	DIM - 0-10V (100-1%) LE - PHASE DIM (TRIAC/ELV, 100-1%) ³ D01 - 0-10V (100-0.1%) DALI - DALI (100-1%) ⁴ DHL2 - LUTRON HI-LUME (1% ECOSYSTEM) DMX - DMX (100-0%)	BK - BLACK WH - WHITE SV - SILVER CSF - CUSTOM-3G	BLV - BLACK WLV - WHITE

OPTIONS
CF - CONDUIT FEED CANOPY FXC - SEAMLESS CANOPY OPTION * EMR - EMERGENCY BATTERY (REMOTE) ⁵ <small>*Seamless canopy mount (FXC) must be installed prior to ceiling installation.</small>

- ¹ 2700K only available in 90CRI and 4000K only available in 80CRI
² 347 available in "DIM" 0-10V only (100-1%). Not available with 3" height and 7" height
³ Phase dimming options available in 120V only
⁴ DALI-2 (Type 6) provided as standard
⁵ Emergency battery installed remotely by others. Not accessible through the inside of the fixture

PERFORMANCE

LUMEN OUTPUT	DELIVERED LUMENS	SYSTEM WATTS	EFFICACY (LPW)
1000	1000	8.4	122.4
1500	1500	13.2	117.4
1750	1750	15.4	116.8
2000	2000	18.4	111.7

BASED ON 80+ CRI, 3000K WITH 20D OPTIC
Lumen output and actual wattage may vary +/- 5%

MULTIPLIERS

COLOR TEMP	80+ CRI
2700K	N/A
3000K	1.00
3500K	0.97
4000K	1.16

COLOR TEMP	90+ CRI
2700K	0.77
3000K	0.86
3500K	0.86
4000K	N/A

BEAM ANGLE	
20D	1.00
40D	0.97
60D	0.94

HOUSING

Extruded aluminum housing with powder coated finish
Twist and lock construction with no visible hardware
Adjustable housing with 0-90° tilt and 360° rotation features
proprietary swivel mechanism

OPTICS

3" aperture with regressed LED source for maximum visual comfort
High gloss black or white louvers with proprietary optics and no glare
Polycarbonate multi-faceted reflectors
Available in 20°, 40° and 60°
UGR <10

ELECTRICAL

Standard 0-10V, constant current drivers with 100-1% dimming
range and >0.9 power factor
Standard 120/277V universal voltage with several driver options
3" model supplied with driver suitable for mounting within
junction box (by others)
7" and 11" models have integral drivers that are easily accessible
within luminaire

LED SYSTEM

Osram LED source
Color consistency <2 SDCM
80+ and 90+ CRI
Available in 27K, 30K, 35K, and 40K
L90 >60,000 hours

MOUNTING

All hardware included for mounting to 4" octagonal junction box
Twist and lock mechanism
Seamless canopy option designed to mount to 4" octagonal
junction box for new construction only
Conduit feed cut-out canopy option designed to mount to 4"
octagonal junction box

EMERGENCY

Remote emergency battery installed by others (not accessible
through fixture aperture)
7W output for 90 minutes (+/- 700lm at 80+ CRI)
CA Title 24 Certified
Maximum remote mounting distance: 50ft (12AWG) or 25ft (14AWG)
Caution: Emergency Battery utilizes more than one power source
and servicing should be performed by qualified personnel

LISTING

ETL listed and conforms to UL1598 standard
Certified to CSA22.2 NO.250.0.
Rated for indoor locations

WARRANTY

5 year limited warranty
LED system rated for operation in ambient environments up to 25°C

RECESSED 4" OCTAGONAL JUNCTION BOX BY OTHERS
STANDARD CANOPY MOUNT

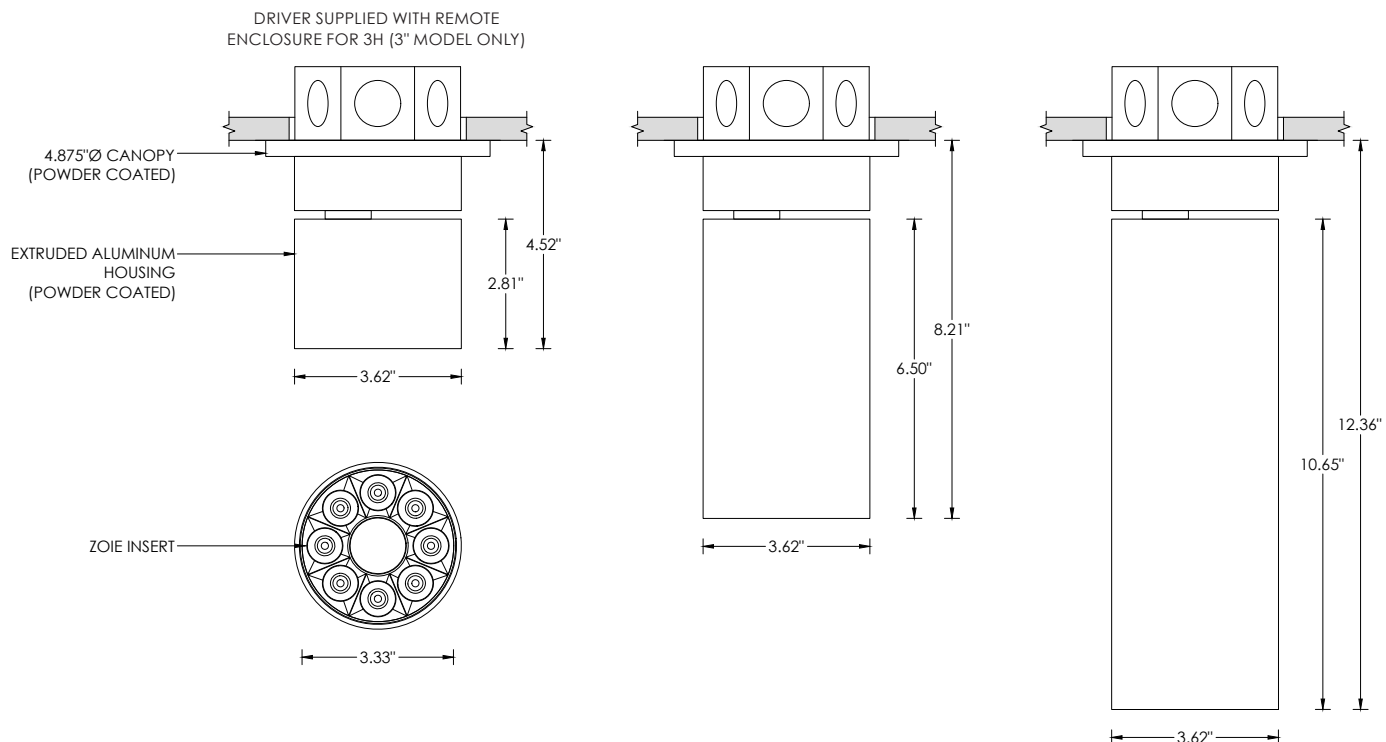

RECESSED 4" OCTAGONAL JUNCTION BOX BY OTHERS
SEAMLESS CANOPY MOUNT (FXC OPTION) FOR NEW CONSTRUCTION ONLY

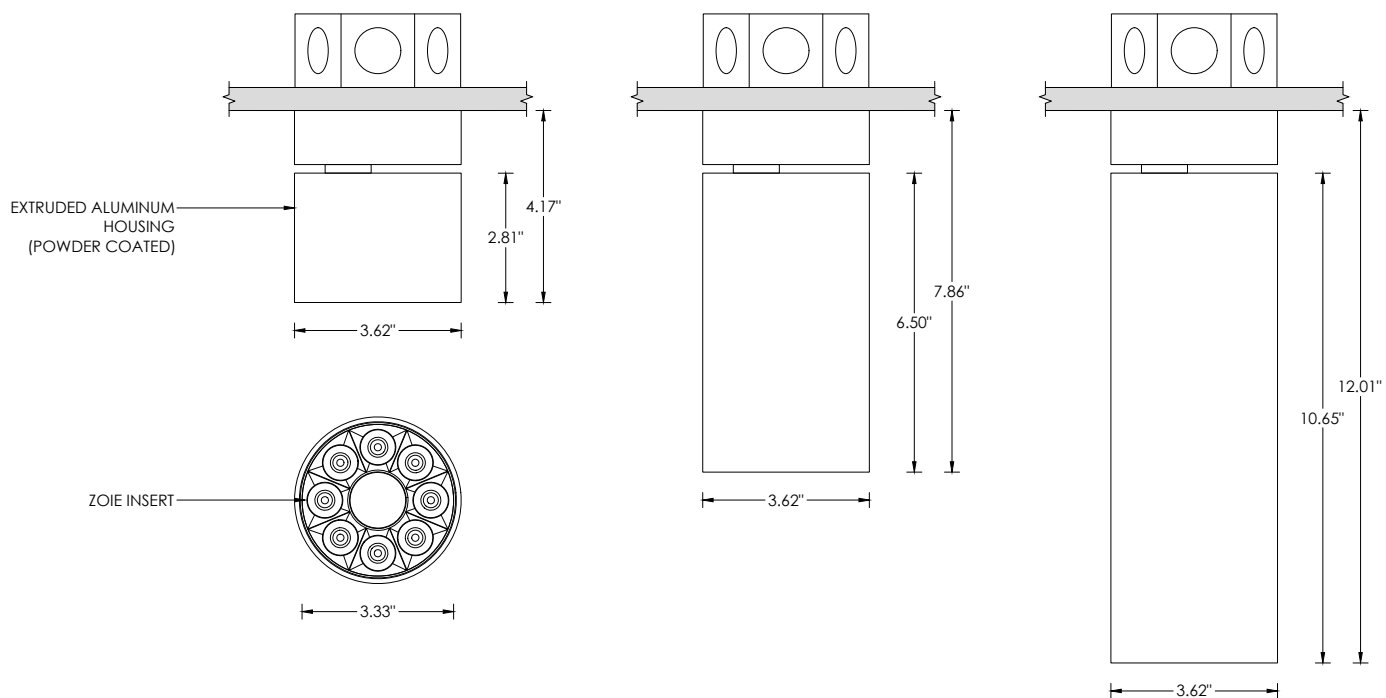

SURFACE 4" OCTAGONAL X 1.5" DEEP JUNCTION BOX BY OTHERS
CONDUIT FEED CANOPY MOUNT (CFX OPTION)

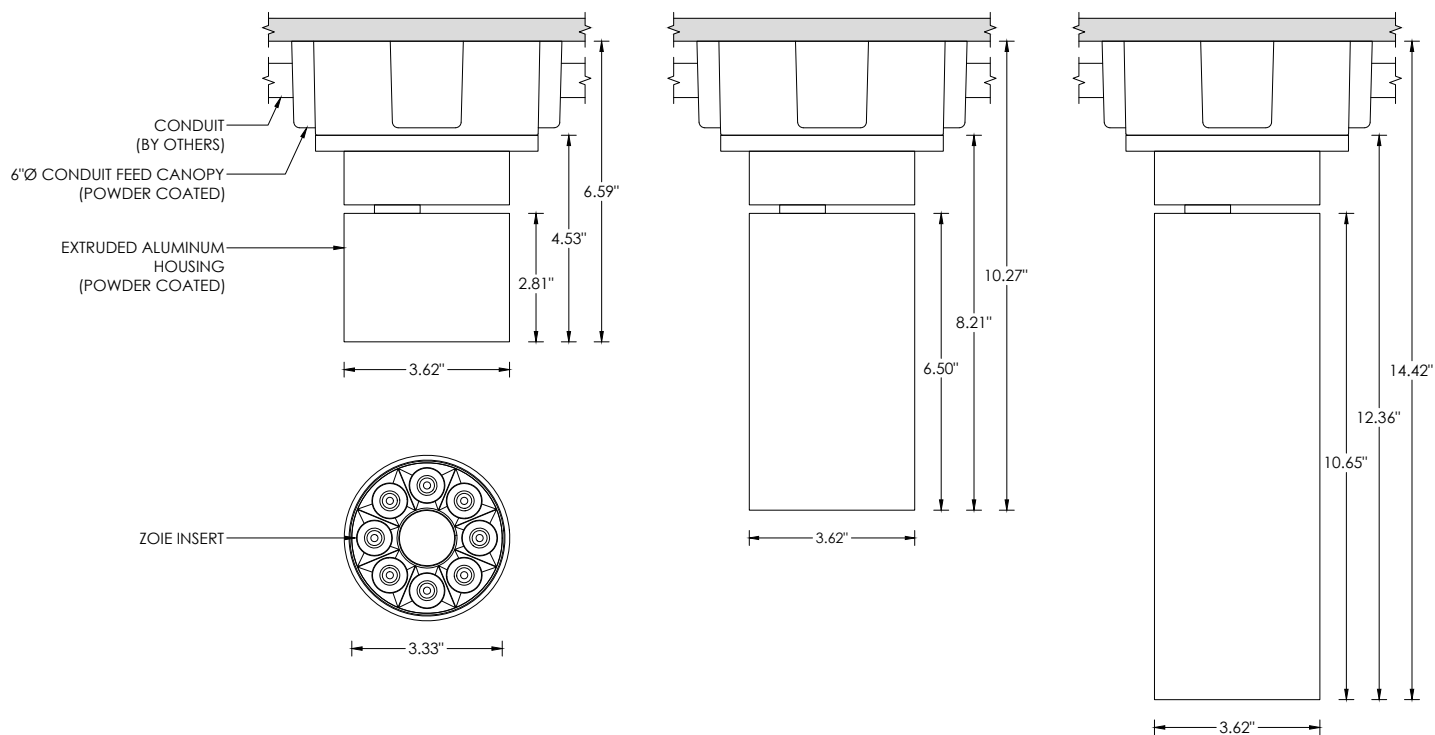

CONDUIT FEED CANOPY MOUNTING OPTIONS

