

# 3G LIGHTING

## 3G-WDL45RF-DI

4" WALL CYLINDER  
DIRECT/INDIRECT  
14" HEIGHT

4" high performance wall mounted downlight cylinder  
Standard 95+ CRI LED system with up to 126 LPW  
Delivered lumen range up to 3427lm at 95+ CRI  
Direct/Indirect distribution  
Extruded aluminum housing with powder coated finish  
Regressed LED source for enhanced glare control  
Companion to 3G-DL45R series downlight family

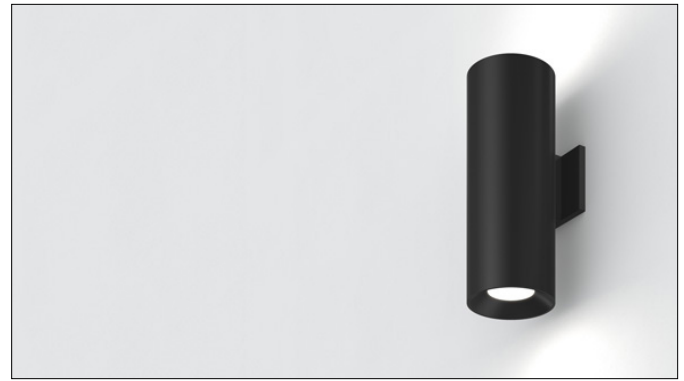

### DIRECT/INDIRECT - 14"



### OPTICS

#### DIRECT/INDIRECT

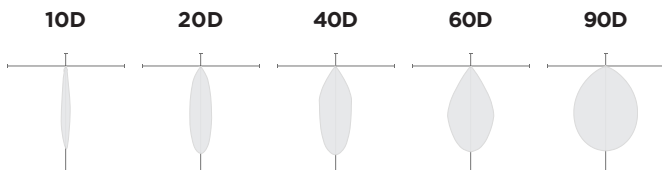

### PERFORMANCE

#### DIRECT/INDIRECT

LUMEN OUTPUT	DELIVERED LUMENS	SYSTEM WATTS	EFFICACY (LPW)
1000	1000	9.1	110
1250	1250	11.3	110
1500	1500	14.0	108

BASED ON 95+ CRI, 3500K, 20D OPTIC WITH SOFTENING LENS  
Lumen output and actual wattage may vary +/- 5%

### DIMENSIONS

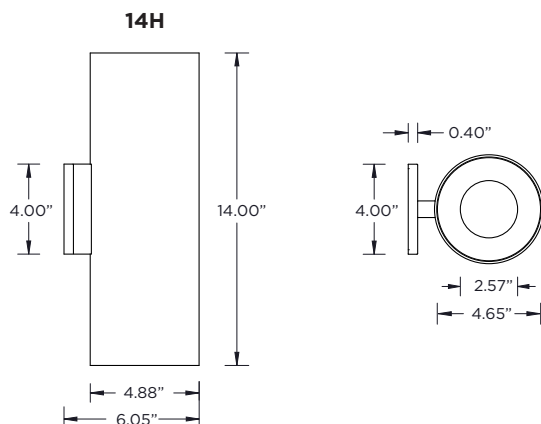

<b>PROJECT:</b>		<b>TYPE:</b>	
<b>CATALOG#:</b>		<b>DATE:</b>	<b>QTY:</b>

CAT. NO	LUMEN OUTPUT (DIRECT)	LUMEN OUTPUT (INDIRECT)	CRI
<b>3G-WDL45RF-DI</b>	<b>D10</b> - 1000 LUMENS <b>D12</b> - 1250 LUMENS <b>D15</b> - 1500 LUMENS  All lumen outputs are delivered lumens at 95+ CRI	<b>L10</b> - 1000 LUMENS <b>L12</b> - 1250 LUMENS <b>L15</b> - 1500 LUMENS  All lumen outputs are delivered lumens at 95+ CRI	<b>H95</b> - 95+ CRI
COLOR TEMP	BEAM ANGLE (DIRECT)	BEAM ANGLE (INDIRECT)	VOLTAGE
<b>27K</b> - 2700K <b>30K</b> - 3000K <b>35K</b> - 3500K <b>40K</b> - 4000K	<b>10D</b> - 10° <b>20D</b> - 20° <b>40D</b> - 40° <b>60D</b> - 60° <b>90D</b> - 90°  90D optic supplied with lens Not available with other lens options	<b>10D</b> - 10° <b>20D</b> - 20° <b>40D</b> - 40° <b>60D</b> - 60° <b>90D</b> - 90°  90D optic supplied with lens Not available with other lens options	<b>UNV</b> - 120/277V <b>120</b> - 120V
DRIVER	HOUSING FINISH	INSERT FINISH	OPTIONS
<b>DIM</b> - 0-10V (100-1%) <b>LE</b> - PHASE DIM <sup>1</sup> (TRIAC/ELV, 100-1%) <b>D01</b> - 0-10V (100-0.1%) <b>DALI</b> - DALI-2 (TYPE 6)(100-1%)	<b>WH</b> - WHITE <b>BK</b> - BLACK <b>SV</b> - SILVER <b>CF</b> - CUSTOM COLOR	<b>WI</b> - WHITE <b>BI</b> - BLACK <b>SI</b> - SILVER <b>CI</b> - CUSTOM COLOR	<b>SF</b> - SOFTENING LENS * (SUPPLIED STANDARD) <b>LS</b> - LINEAR SPREAD LENS <b>SB</b> - SANDBLASTED LENS  <small>*Softening lens not provided with 90D optic  Maximum 1 optical accessory</small>
CIRCUITING			
<b>1C</b> - SINGLE CIRCUIT <b>2C</b> - DUAL CIRCUIT (SEPARATE DIRECT & INDIRECT)			

<sup>1</sup> Phase dimming options available in 120V only

## DIRECT/INDIRECT

LUMEN OUTPUT	DELIVERED LUMENS	SYSTEM WATTS	EFFICACY (LPW)
1000	1000	9.1	110
1250	1250	11.3	110
1500	1500	14.0	108

BASED ON 95+ CRI, 3500K, 20D OPTIC WITH SOFTENING LENS  
Lumen output and actual wattage may vary +/- 5%

## MULTIPLIERS

BEAM ANGLE		COLOR TEMP	
10D	1.07	2700K	0.98
20D	1.12	3000K	1.00
40D	1.00	3500K	1.00
60D	1.04	4000K	1.02
90D	0.96		

## HOUSING

Extruded aluminum housing with powder coated finish

## BEVELED INSERT

4" aperture with regressed LED source for enhanced glare control  
Cast aluminum insert with matte powder coated finish

## OPTICS

Proprietary anodized, aluminum reflectors  
Available in 10°, 20°, 40°, 60° and 90°  
Reflectors are field replaceable (10° reflector not interchangeable)  
Softening lens supplied standard

## LISTING

ETL listed and conforms to UL1598 standard  
Certified to CSA22.2 NO.250.0.  
Rated for indoor dry or damp locations

## WARRANTY

5 year limited warranty  
LED system rated for operation in ambient environments up to 25°C

## ELECTRICAL

Standard 0-10V, constant current drivers with 100-1% dimming range and >0.9 power factor  
Standard 120/277V universal voltage with several driver options  
Integral drivers are easily accessible through fixture aperture

## LED SYSTEM

Standard 95+ CRI  
Color consistency <2 SDCM  
Available in 27K, 30K, 35K, and 40K  
L90 > 50,000 hours

## MOUNTING

Square machined aluminum canopy with powder coated finish  
Bracket and hardware mount to standard 4" octagonal junction box  
Fixture weight: +/- 5.50 lbs