

3G LIGHTING

3G-48RDSL-R

4.8" RECESSED DOWNLIGHT SLOT
3" ROUND DOWNLIGHTS

4.8" Recessed Downlight Slot designed for continuous runs
Machined aluminum faceplate with round, trimless downlight integration
3" round adjustable or 3" round fixed downlight option
Standard 95+ CRI LED system with performance up to 144 LPW
Delivered lumen range up to 3000lm at 95+ CRI
10° to 90° beam angle options suitable for various applications
Companion to 3G-DL33R downlight and cylinder families



WT - TRIM

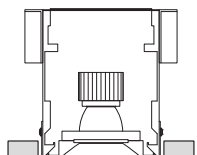

XTR - TRIMLESS

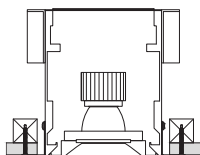

FX - FLANGELESS

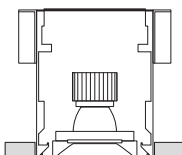

GCX - GRID CEILING

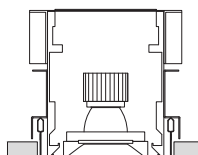

OPTICS

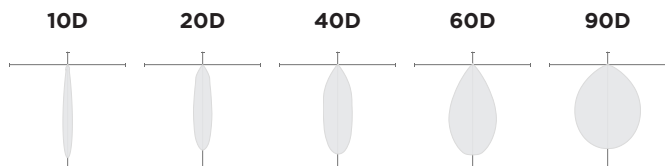

PERFORMANCE

LUMEN OUTPUT	DELIVERED LUMENS	SYSTEM WATTS	EFFICACY (LPW)
1000	1000	8.6	116
1500	1500	13.5	111
2000	2000	18.3	109
2500	2500	25.8	97
3000	3000	31.2	96

BASED ON FIXED DOWNLIGHT OPTION
WITH 95+ CRI, 35K, 40D OPTIC AND SOFTENING LENS
Lumen output and actual wattage may vary +/- 5%

PATTERNS

Specify pattern shape and overall dimensions as shown below. Patterns are connected with 12"x12" mitered corner sections (Downlights not available). Please consult factory for custom patterns and shapes not shown below.

L-SHAPE	U-SHAPE	RECTANGLE/SQUARE
<p>Provide dimensions of AxB Example: L - 6'x8'</p>	<p>Provide dimensions of AxBxC Example: U - 8'x10'x6"</p>	<p>Provide dimensions of AxB Example: R - 10'x8'</p>

PROJECT:		TYPE:	
CATALOG#:		DATE:	QTY:

CAT. NO	DOWNLIGHT TYPE	LUMEN OUTPUT (DELIVERED)	CRI
3G-48RDSL-R	33RF - 3" ROUND FIXED 33RA - 3" ROUND ADJUSTABLE 33RA (adjustable) option available up to 1500lm	10 - 1000 LUMENS 15 - 1500 LUMENS 20 - 2000 LUMENS 25 - 2500 LUMENS 30 - 3000 LUMENS All lumen outputs are delivered lumens at 95+ CRI	H95 - 95+ CRI

COLOR TEMP	BEAM ANGLE	VOLTAGE	DRIVER
27K - 2700K 30K - 3000K 35K - 3500K 40K - 4000K	10D - 10° ¹ 20D - 20° ¹ 40D - 40° 60D - 60° 90D - 90° * <small>*90D optic supplied with lens Not available with other lens options Not available with 33RA (adjustable)</small>	UNV - 120/277V 120 - 120V 347 - 347V ²	DIM - 0-10V (100-1%) LE - PHASE DIM ³ <small>(TRIAC/ELV, 100-1%)</small> D01 - 0-10V (100-0.1%) DALI - DALI (100-1%) ⁴ DHL2 - LUTRON HI-LUME <small>(1% ECOSYSTEM)</small> DMX - DMX (100-0%)

FLANGE TYPE	HOUSING AND FACEPLATE	DOWNLIGHT INSERT	OPTIONS
WT - WHITE TRIM (STANDARD) BT - BLACK TRIM XTR - TRIMLESS (MUD-IN DRYWALL) FX - FLANGELESS GCX - GRID CEILING * <small>(UNIVERSAL MOUNT)</small> <small>*Universal mounting brackets used for grid ceiling types only. See mounting details</small>	BK - BLACK (STANDARD) WH - WHITE	BI - BLACK WI - WHITE SI - SILVER	SF - SOFTENING LENS * <small>(SUPPLIED STANDARD)</small> LS - LINEAR SPREAD LENS SB - SANDBLASTED LENS 2C - 2 CIRCUIT 3C - 3 CIRCUIT CP - CHICAGO PLENUM EMR - EMERGENCY BATTERY ⁵ <small>(REMOTE)</small> <small>*Softening lens not provided with 90D optic Maximum 1 optical accessory</small>

RUN TYPE	DOWNLIGHT SPACING
S - ____' (STRAIGHT) L - ____'X ____' (L-SHAPE) U - ____'X ____'X ____' (U-SHAPE) R - ____'X ____' (RECTANGLE/SQUARE) <small>U-Shape and R-Rectangle/Square not available with grid ceiling applications Continuous runs available in 6" increments</small>	12 - 12" ON CENTER 18 - 18" ON CENTER 24 - 24" ON CENTER 36 - 36" ON CENTER 48 - 48" ON CENTER CUS(xx) - CUSTOM SPACING * <small>*Specify number of downlights (XX)</small>

- ¹ 10D and 20D reflector available up to 2000lm
² 347 available in "DIM" 0-10V only (100-1%)
³ Phase dimming options available in 120V only
⁴ DALI-2 (Type 6) provided as standard
⁵ Supplied with enclosure with Emergency Battery and driver. Installed remotely by others. Not accessible through fixture aperture

PERFORMANCE

3" ROUND FIXED DOWNLIGHT

LUMEN OUTPUT	DELIVERED LUMENS	SYSTEM WATTS	EFFICACY (LPW)
1000	1000	8.6	116
1500	1500	13.5	111
2000	2000	18.3	109
2500	2500	25.8	97
3000	3000	31.2	96

BASED ON 95+ CRI, 3500K, 40D OPTIC WITH SOFTENING LENS
Lumen output and actual wattage may vary +/- 5%

3" ROUND ADJUSTABLE DOWNLIGHT

LUMEN OUTPUT	DELIVERED LUMENS	SYSTEM WATTS	EFFICACY (LPW)
1000	1000	9.3	109
1500	1500	14.0	107

BASED ON 95+ CRI, 3500K, 40D OPTIC WITH SOFTENING LENS
Lumen output and actual wattage may vary +/- 5%

MULTIPLIERS

BEAM ANGLE	
10D	0.92
20D	1.24
40D	1.00
60D	0.97
90D	0.91

COLOR TEMP	
2700K	0.98
3000K	1.00
3500K	1.00
4000K	1.02

BEAM ANGLE	
10D	0.80
20D	1.27
40D	1.00
60D	0.88

COLOR TEMP	
2700K	0.98
3000K	1.00
3500K	1.00
4000K	1.02

HOUSING

Housing constructed in extruded aluminum and cold rolled steel
Designed for continuous runs in various configurations
Maximum ceiling thickness of 1.75". Consult factory for modifications
Machined aluminum faceplates with trimless downlight integration
Standard matte black powder coated housing and faceplate finish
Trim flange with power coated finish and 0.400" overlap
Trimless model features a perforated galvanized mudding flange

DOWNLIGHT INSERT

Cast aluminum beveled insert with matte powder coated finish
3" aperture with regressed LED source for enhanced glare control

ADJUSTABILITY

Adjustable downlight option with 40 degree tilt along length of channel and 25 degree tilt across the width
Proprietary hot aiming mechanism with sliding center beam optimization and 360° rotation

OPTICS

Proprietary anodized, aluminum reflectors
Beam angle available in 10°, 20°, 40°, 60° and 90°
Reflectors are field replaceable (10° reflector not interchangeable)
Softening lens supplied standard

LED SYSTEM

Standard 95+ CRI
Color consistency <2 SDCM
Available in 27K, 30K, 35K, and 40K
L90 > 50,000 hours

ELECTRICAL

Standard 0-10V, constant current drivers
100-1% dimming range and > 0.9 power factor
Standard 120/277V universal voltage with several driver options
120V Forward Phase/Reverse Phase driver option (100-1%)
Integral drivers are easily accessible through channel aperture

EMERGENCY

Title 24 Certified. 7W output for 90 minutes
800lm at 95+ CRI (fixed DL) and 765lm at 95+ CRI (adjustable DL)
Remote emergency battery (not accessible through fixture aperture)
Maximum remote mounting distance:
3000lm or below - 50ft (12AWG) or 25ft (14AWG)
Caution: Emergency Battery utilizes more than one power source and servicing should be performed by qualified personnel

MOUNTING

New construction housing suspended via 1/4" threaded rod or suspension cables (by others)
Trim fixture designed for use in drywall, wood, and other architectural ceiling materials
Trimless fixture designed for use in drywall, mud-in ceiling applications
Flangeless fixture designed for use in wood ceilings
Suitable for various grid ceiling applications (see mounting details)

LISTING

ETL listed and conforms to UL1598 standard
Certified to CSA22.2 No.250.0.
JA8 certified
Rated for dry or damp locations

WARRANTY

5 Year Warranty on LED and drivers
LED system rated for operation in ambient environments up to 25°C

HARD CEILING

WT - TRIM

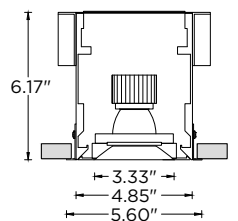

RECOMMENDED CEILING
CUT-OUT 5.20"

XTR - TRIMLESS

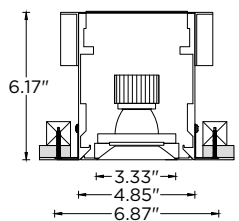

RECOMMENDED CEILING
CUT-OUT 5.20"

FX - FLANGELESS

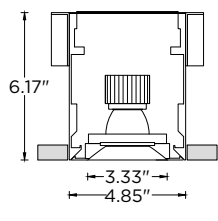

RECOMMENDED CEILING
CUT-OUT 4.90"

TRIM



TRIMLESS (MUD-IN DRYWALL)

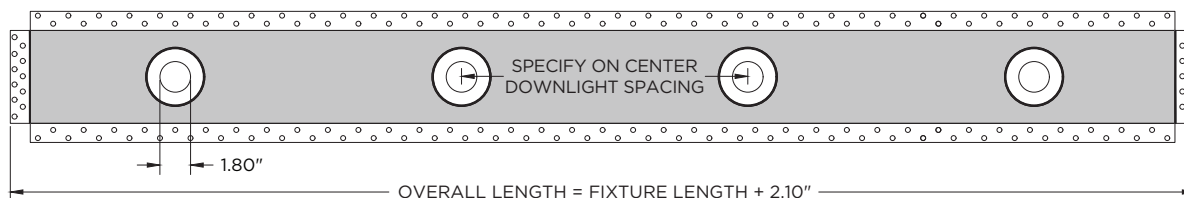

FLANGELESS

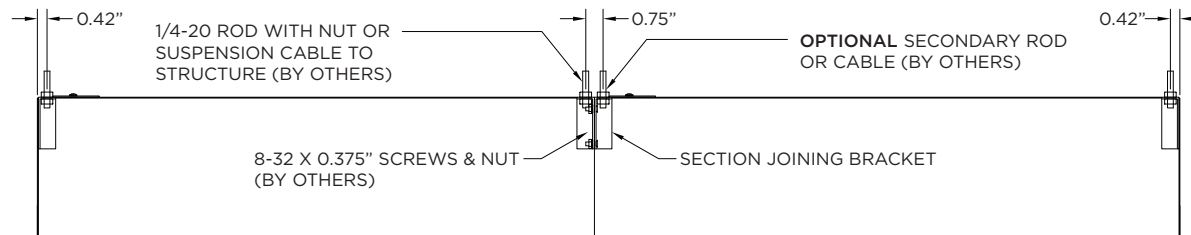
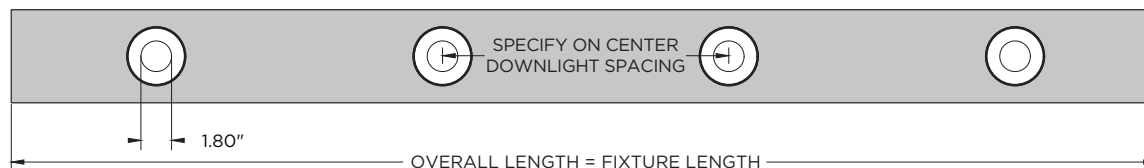

GRID CEILING

9L - 9/16" LAYIN

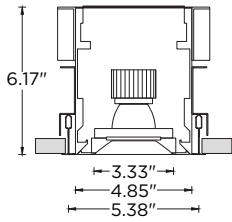

9TG - 9/16" TEGULAR

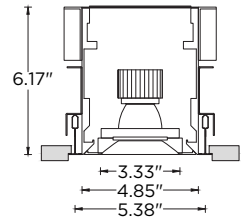

15L - 15/16" LAYIN

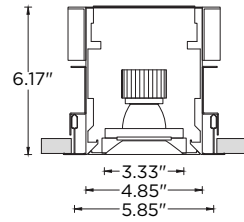

15TG - 15/16" TEGULAR

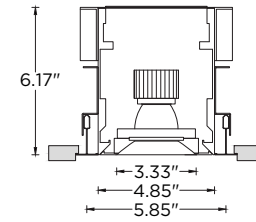

9ST - 9/16" SLOT TEE TEGULAR

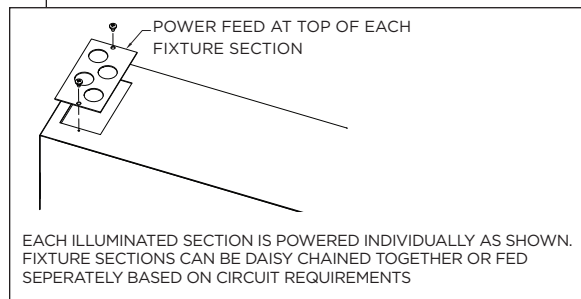
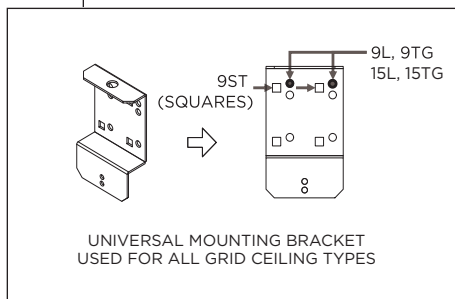
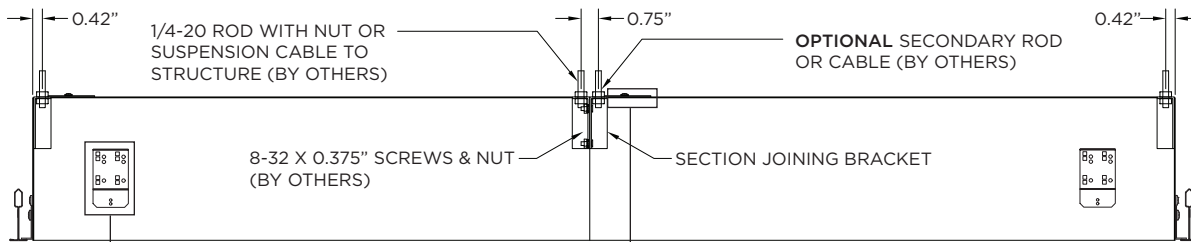
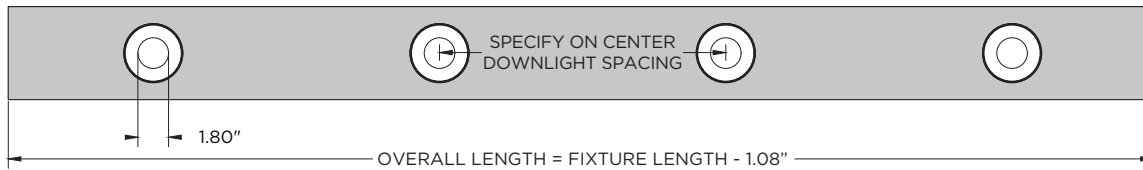
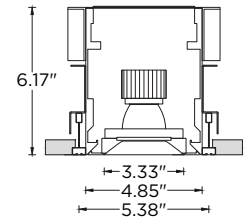

DOWNLIGHT ADJUSTABILITY

WIDTH

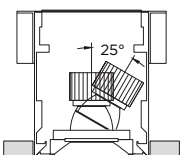

LENGTH

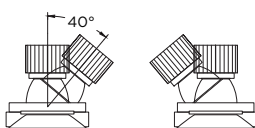

ROTATION

