

2" DOWNLIGHT CYLINDER - PENDANT

CABLE PENDANT MOUNT



i THE IMAGES SHOWN ARE FOR ILLUSTRATION ONLY AND MAY NOT BE AN EXACT REPRESENTATION OF THE PRODUCT

COMPONENTS

STANDARD CANOPY

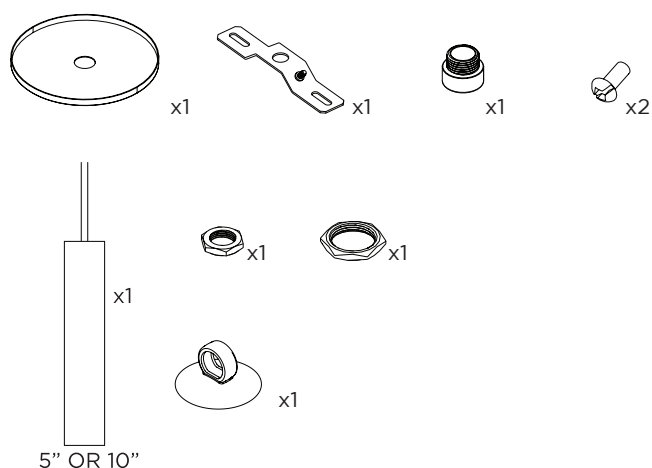

CONDUIT FEED CANOPY

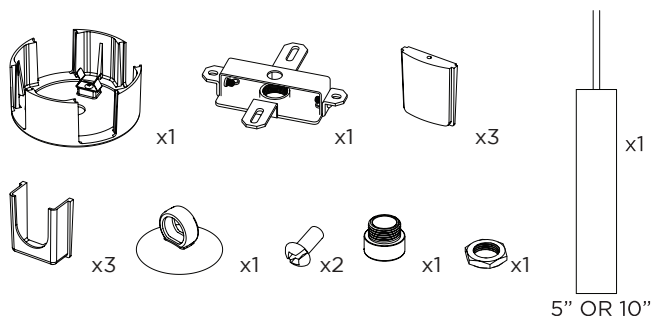

POWER CANOPY

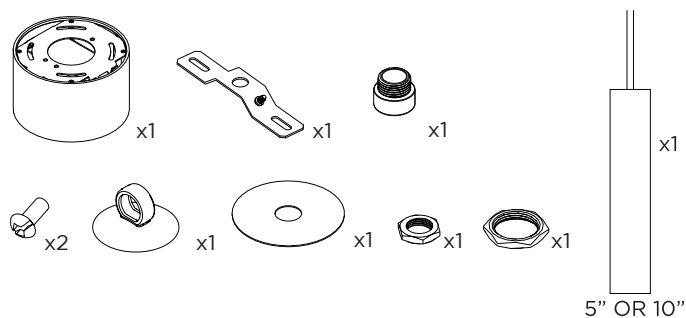

4" OCTAGONAL J-BOX REQUIRED FOR INSTALLATION

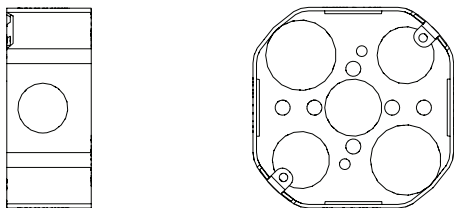

JUNCTION BOX (BY OTHERS)

INSTRUCTION KEY	INFORMATION
ADDITIONAL	INSTALLATION SHOULD ONLY BE PERFORMED BY A CERTIFIED ELECTRICIAN
ATTENTION	REFER TO LOCAL/NATIONAL CODES FOR PROPER INSTALLATION
POWER ON	FAILURE TO FOLLOW INSTALLATION INSTRUCTION MAY VOID THE WARRANTY
POWER OFF	DO NOT TOUCH LEDS. LEDS MUST BE PROTECTED FROM MECHANICAL STRESS OR DEBRIS
	TURN OFF POWER DURING INSTALLATION OR SERVICING

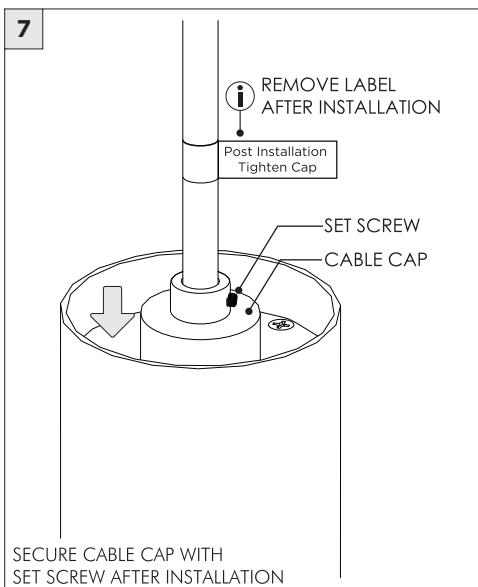
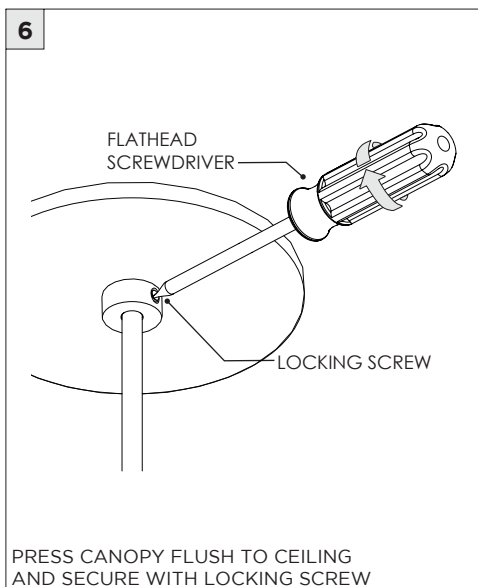
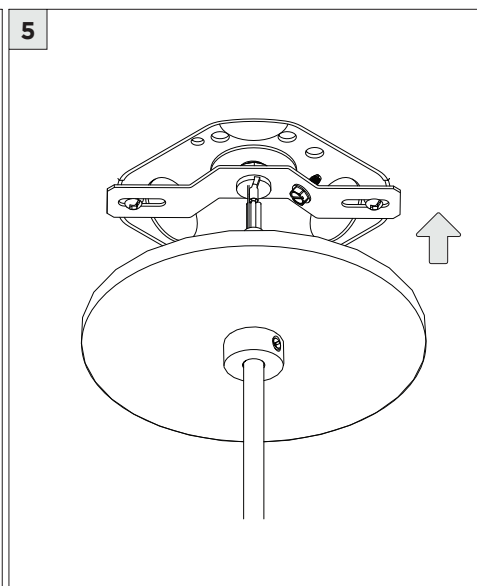
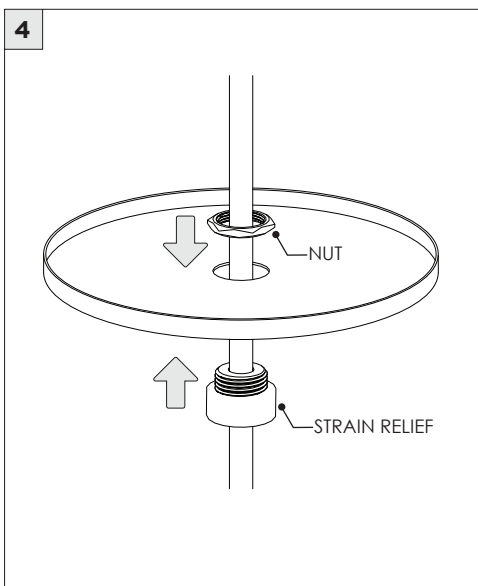
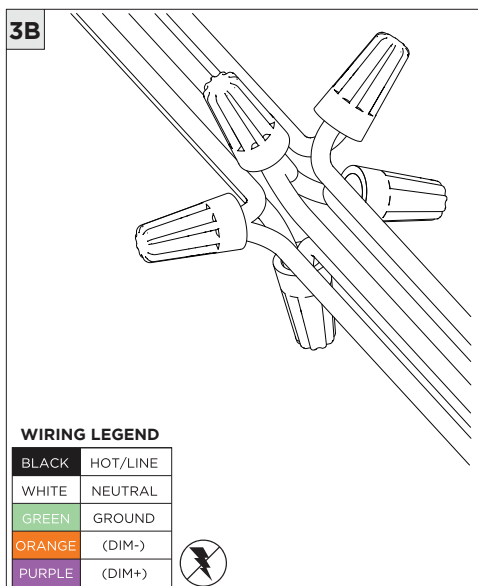
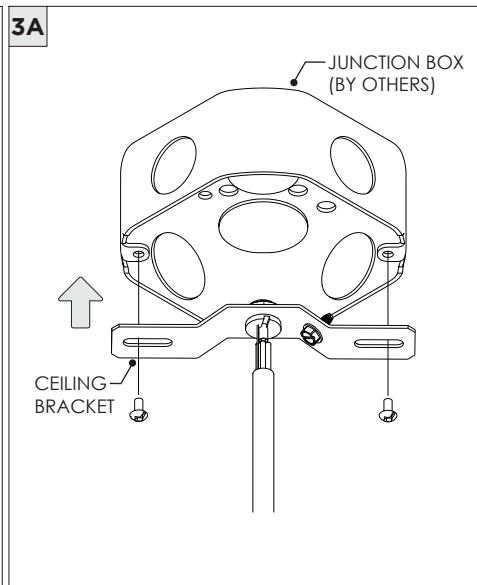
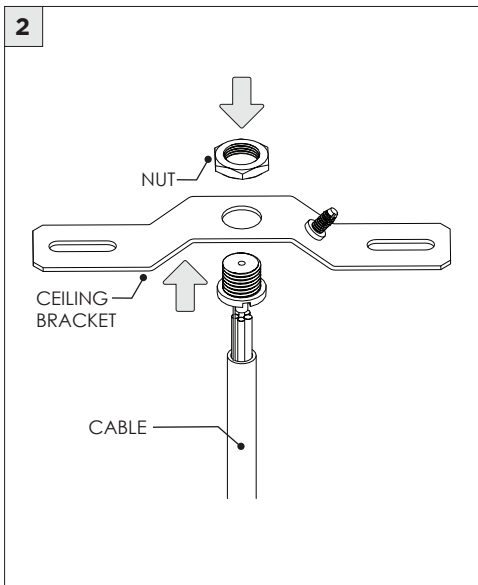
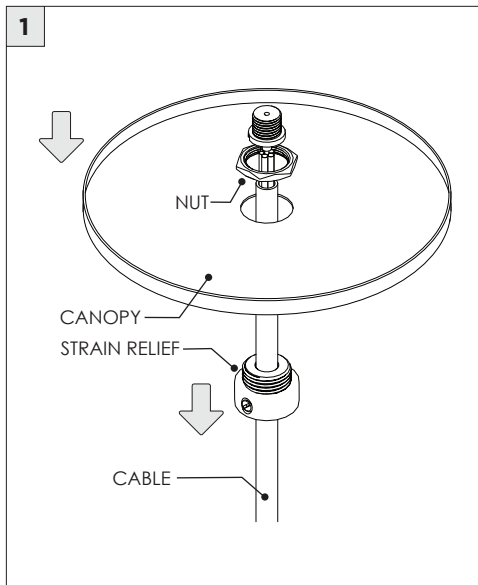

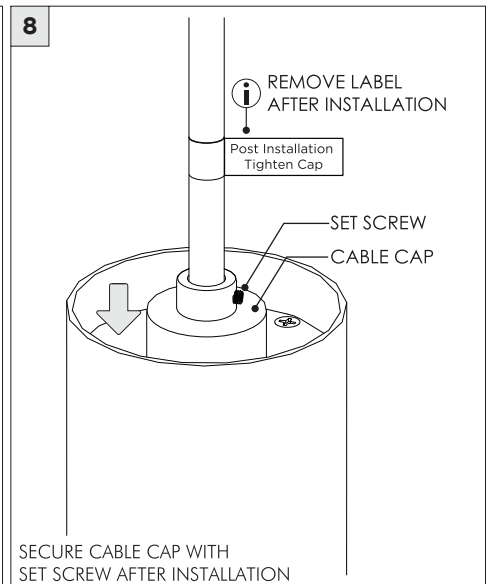
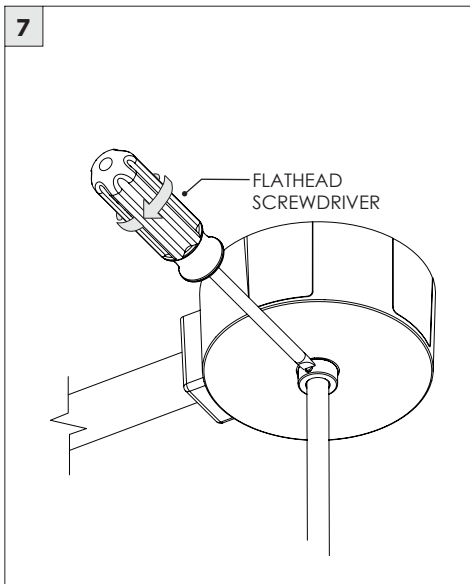
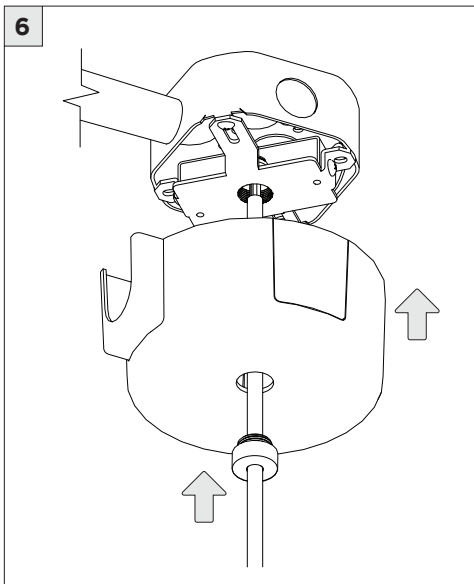
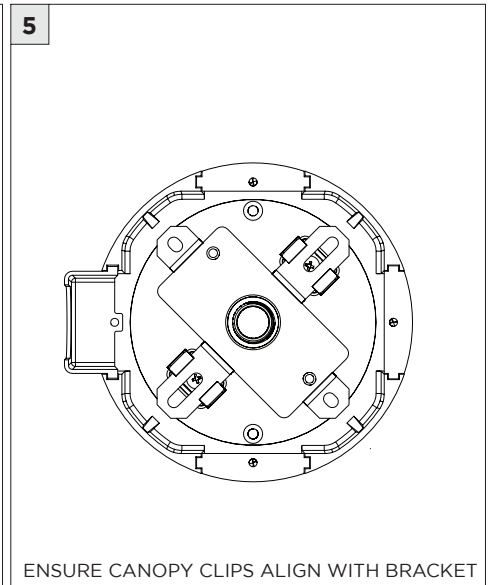
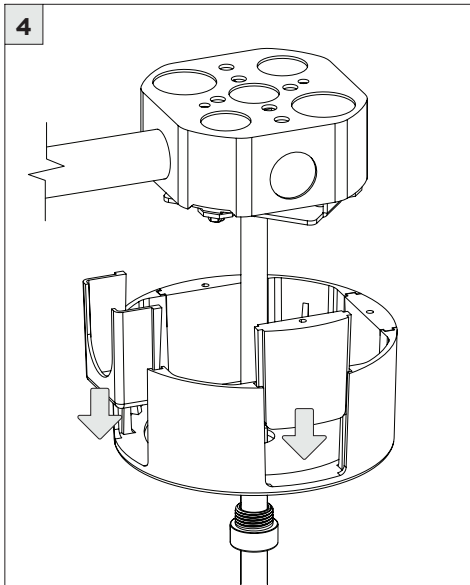
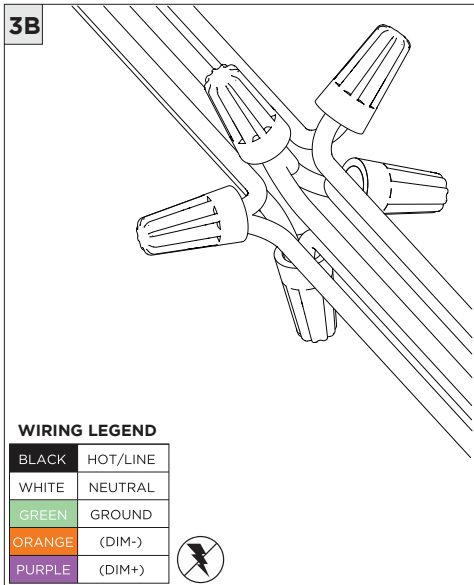
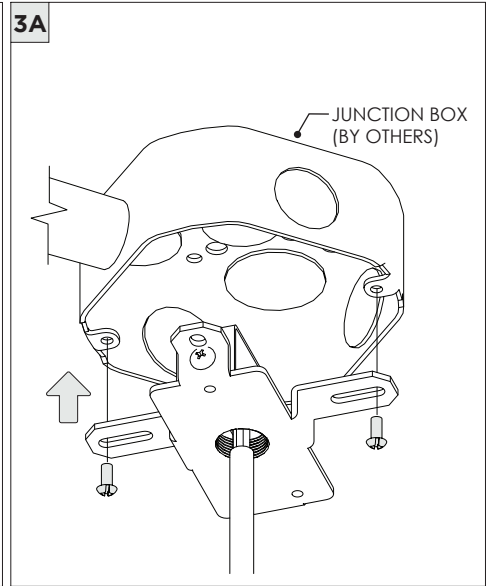
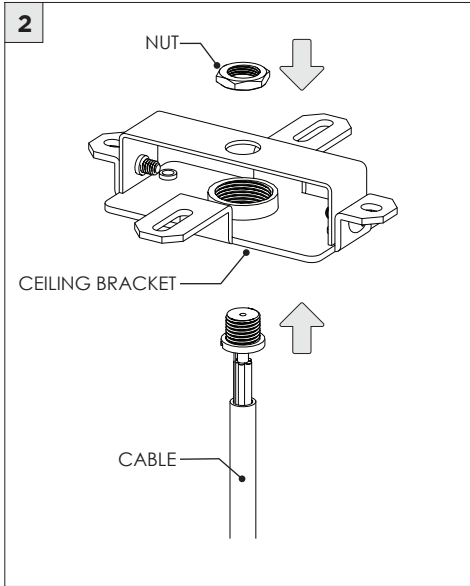
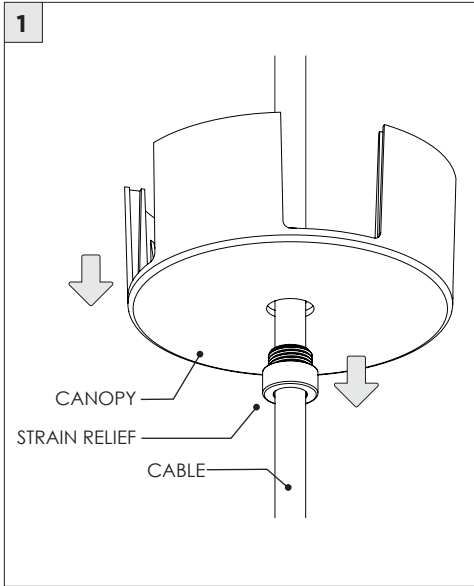

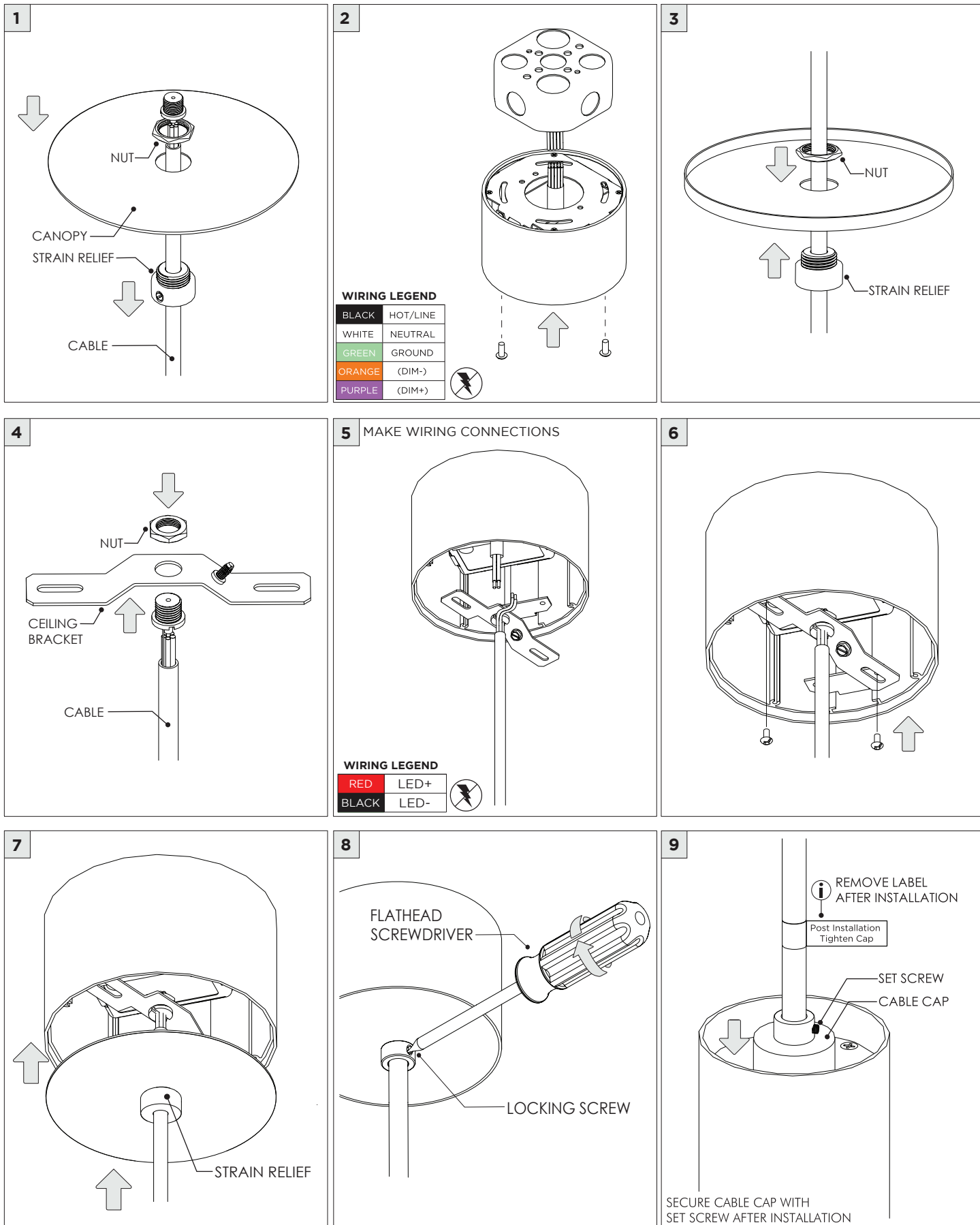

1 CONDUIT FEED CANOPY

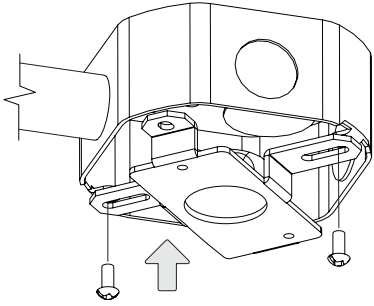

2

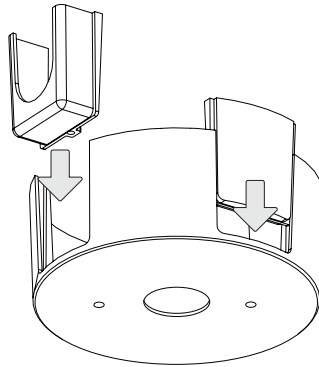

3

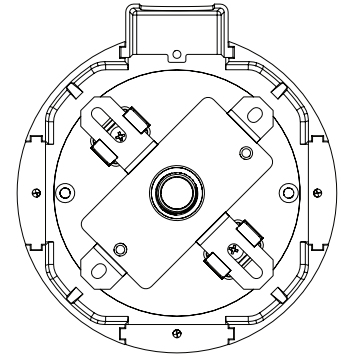

ENSURE CANOPY CLIPS ALIGN WITH BRACKET

4

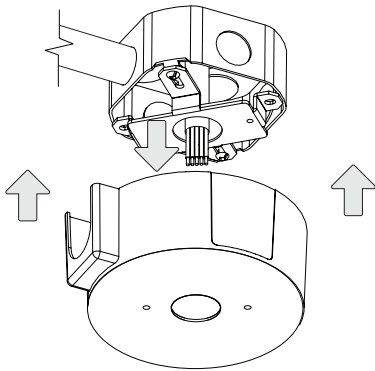

CONNECT CONDUIT CANOPY AND FEED
JUNCTION BOX WIRES THROUGH HOLE

5

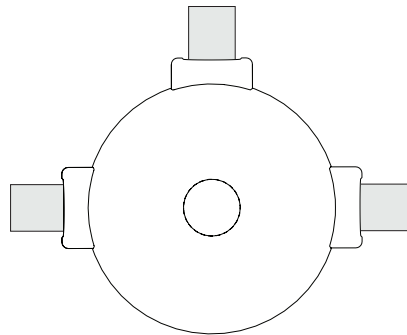

! CANOPY IS SUITABLE FOR
MAXIMUM 3 CONDUIT FEEDS

6 POWER CANOPY

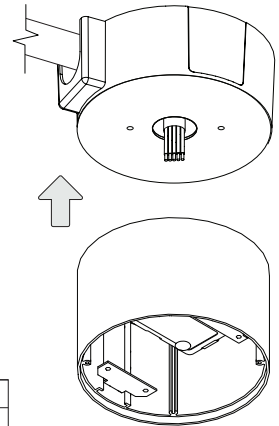

WIRING LEGEND

BLACK	HOT/LINE
WHITE	NEUTRAL
GREEN	GROUND
ORANGE	(DIM-)
PURPLE	(DIM+)



7

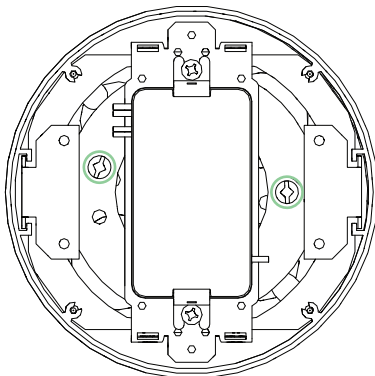

8

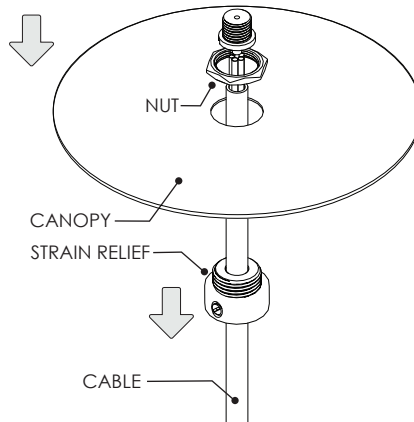

9

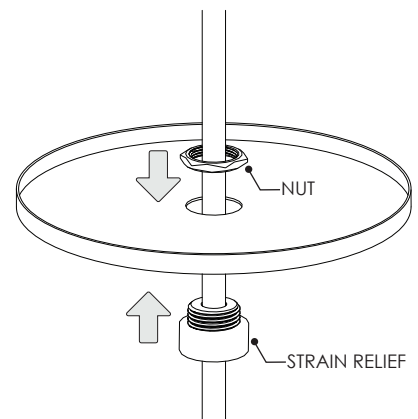

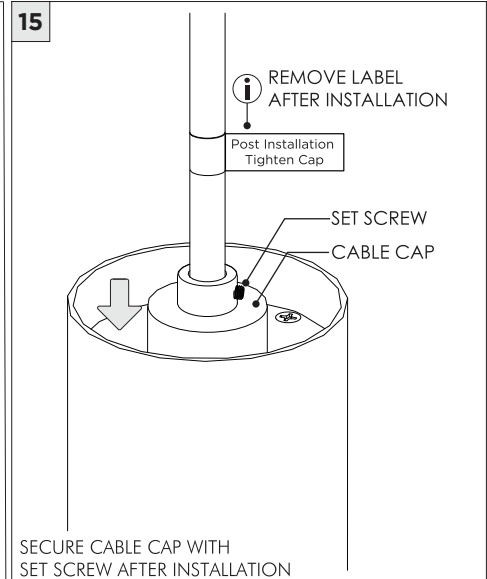
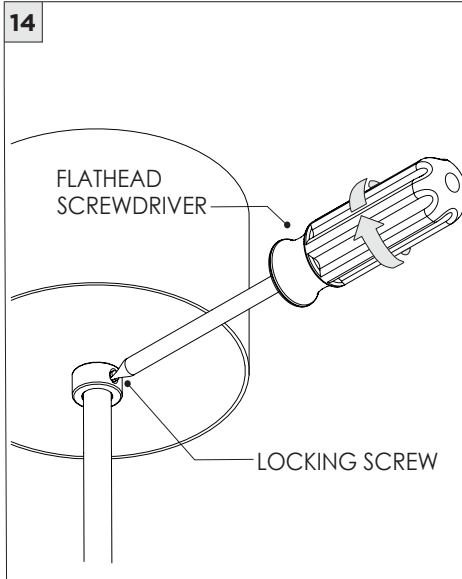
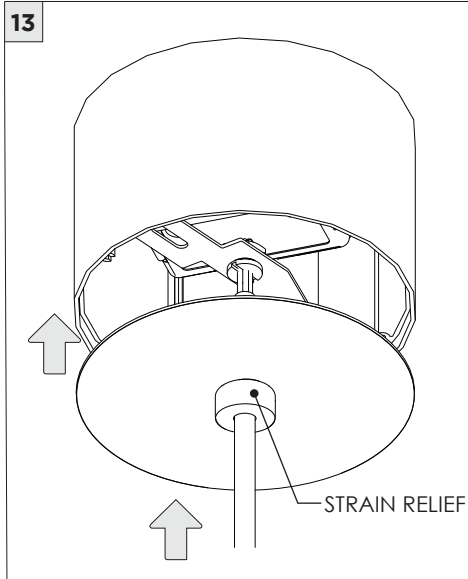
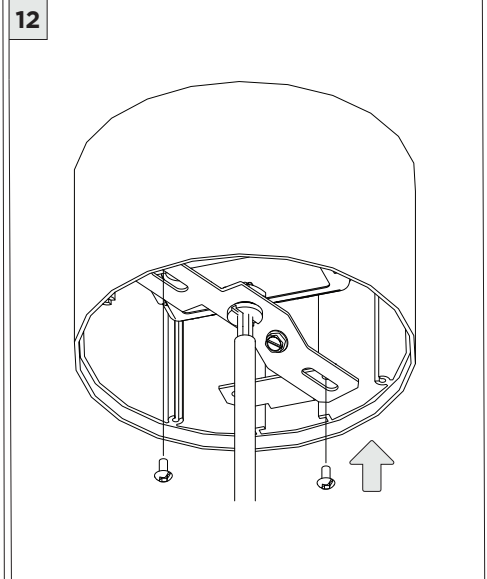
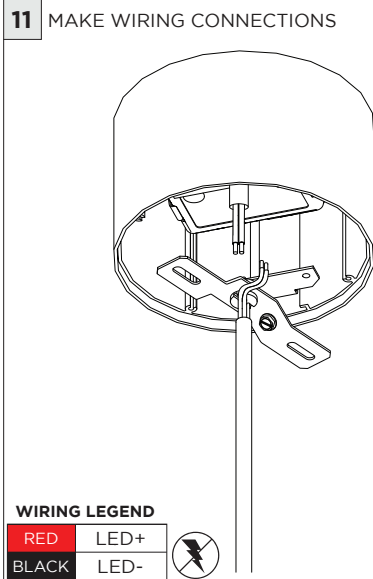
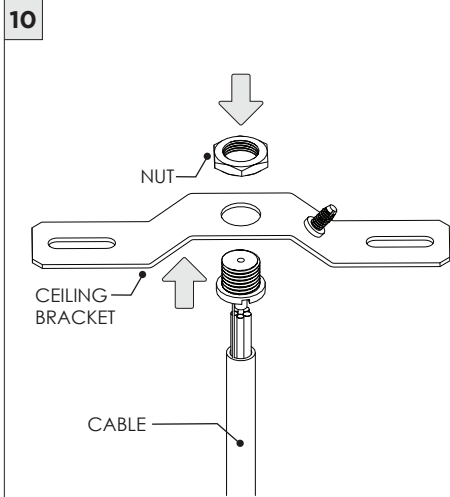

DRIVER SERVICING

1

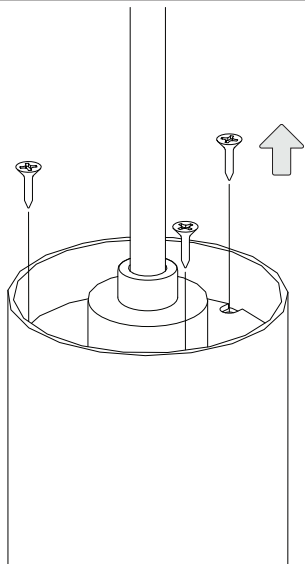

2

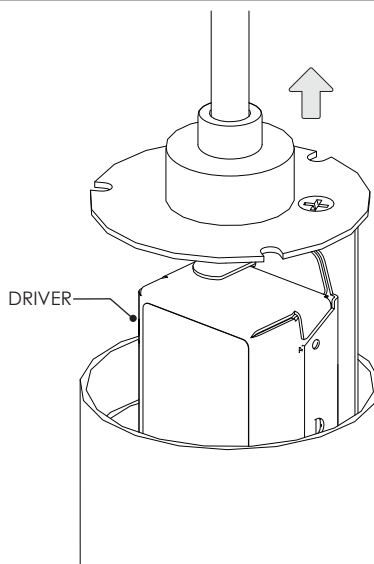

LED SERVICING

1

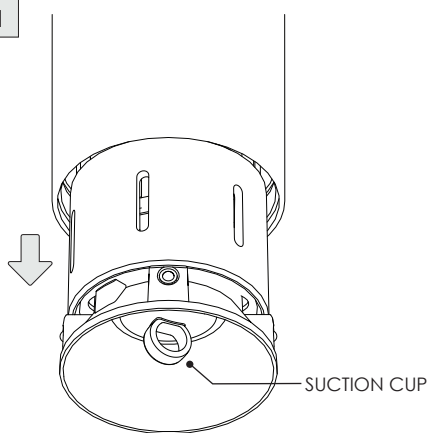

2

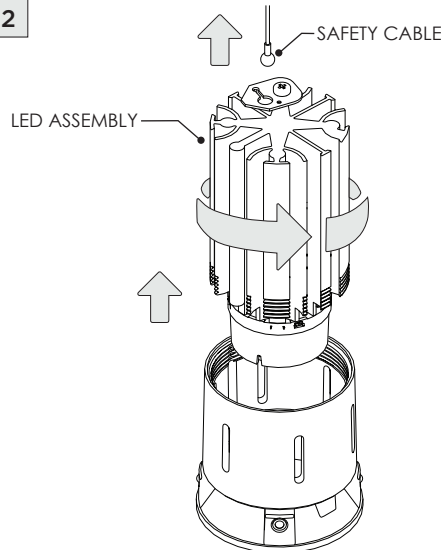

DISCONNECT LED ASSEMBLY & SAFETY CABLE

3

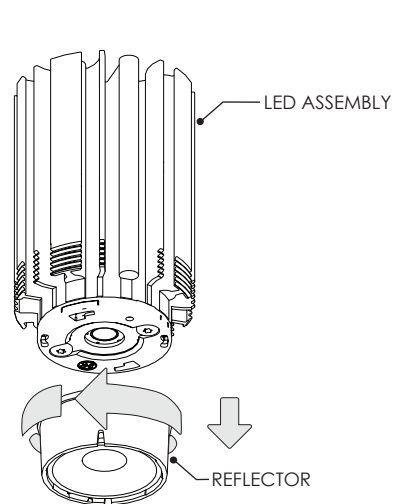

REMOVE REFLECTOR AND REPLACE LED ASSEMBLY