

2" DOWNLIGHT CYLINDER

SURFACE MOUNT



COMPONENTS

STANDARD CANOPY

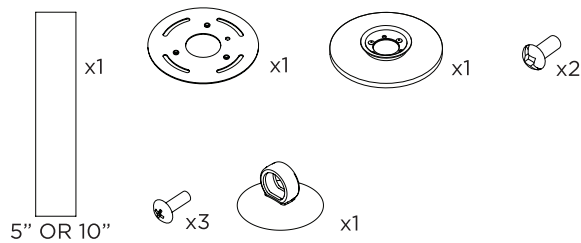

SEAMLESS CANOPY (FOR NEW CONSTRUCTION ONLY)

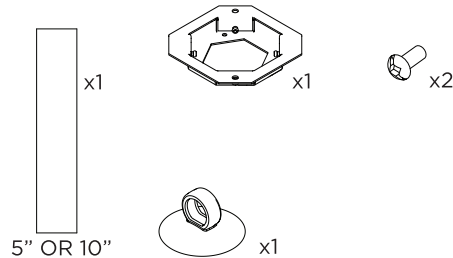

CONDUIT FEED CANOPY

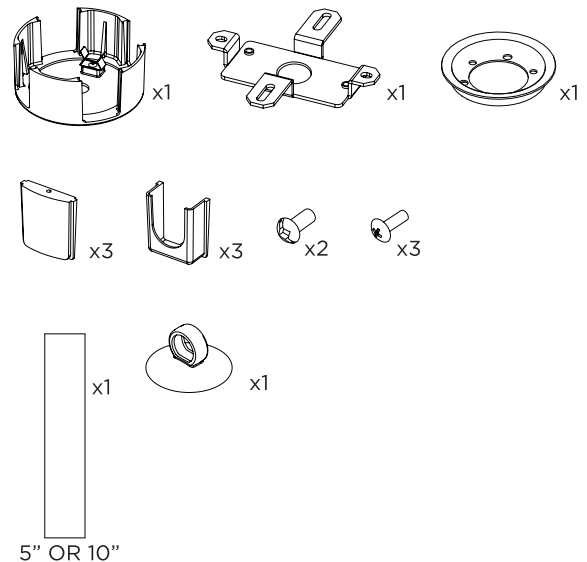

4" OCTAGONAL J-BOX REQUIRED FOR INSTALLATION

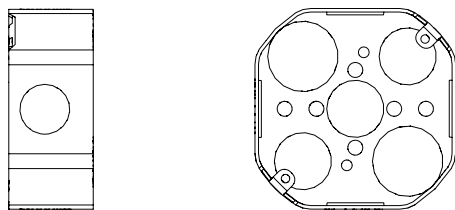

JUNCTION BOX (BY OTHERS)

INSTRUCTION KEY	INFORMATION
⚠ ADDITIONAL	INSTALLATION SHOULD ONLY BE PERFORMED BY A CERTIFIED ELECTRICIAN
ⓘ ATTENTION	REFER TO LOCAL/NATIONAL CODES FOR PROPER INSTALLATION
⚡ POWER ON	FAILURE TO FOLLOW INSTALLATION INSTRUCTION MAY VOID THE WARRANTY
⏻ POWER OFF	DO NOT TOUCH LEDS. LEDS MUST BE PROTECTED FROM MECHANICAL STRESS OR DEBRIS
	TURN OFF POWER DURING INSTALLATION OR SERVICING

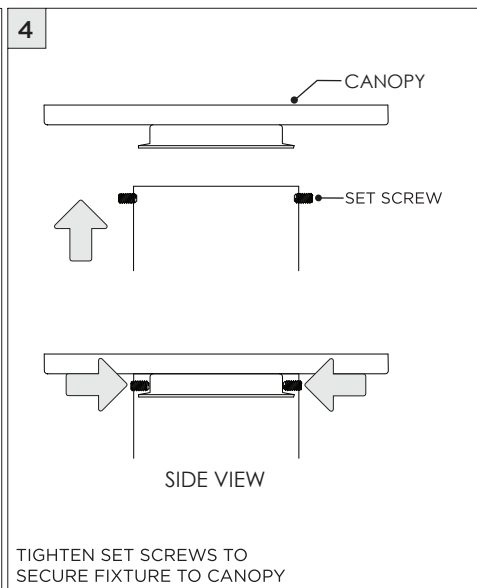
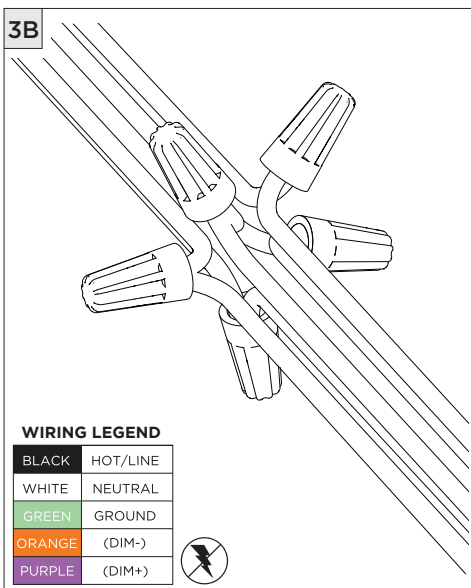
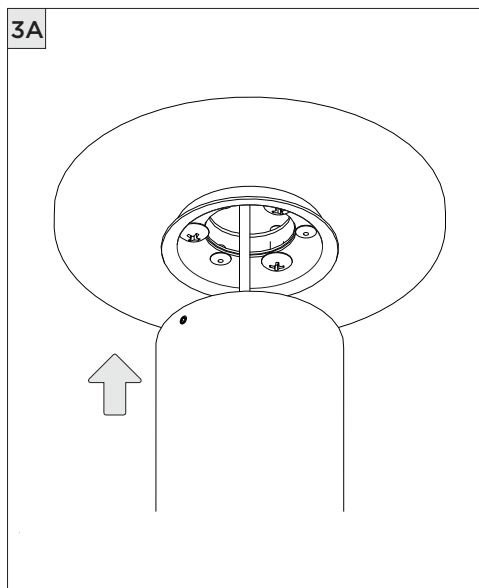
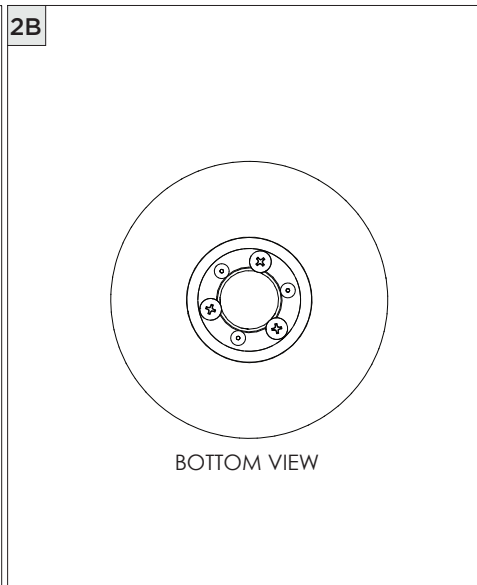
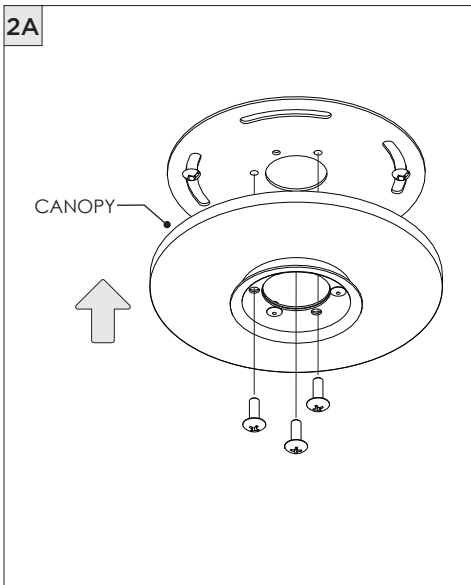
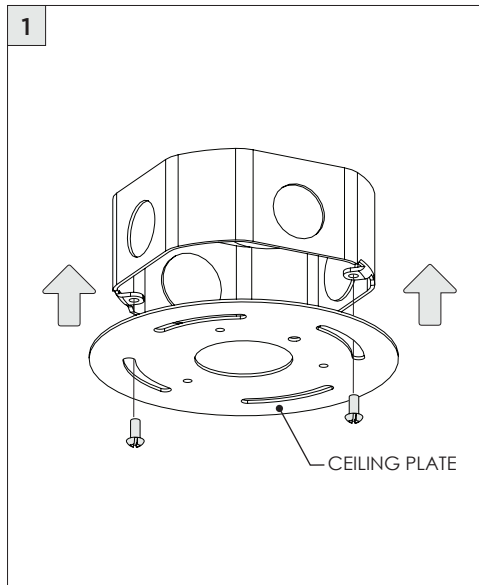

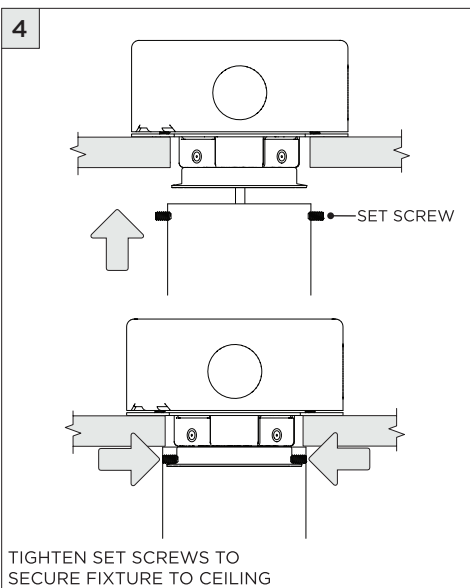
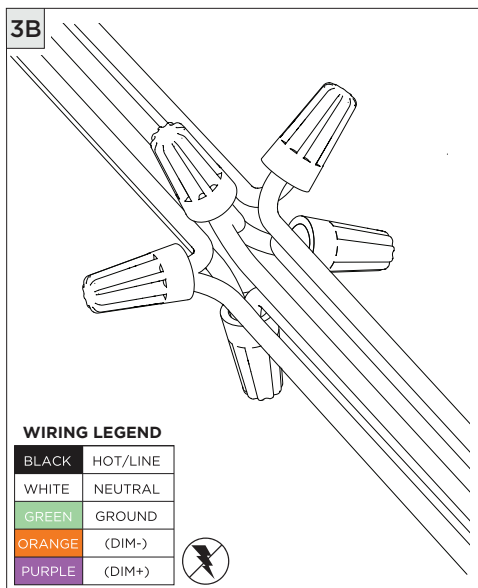
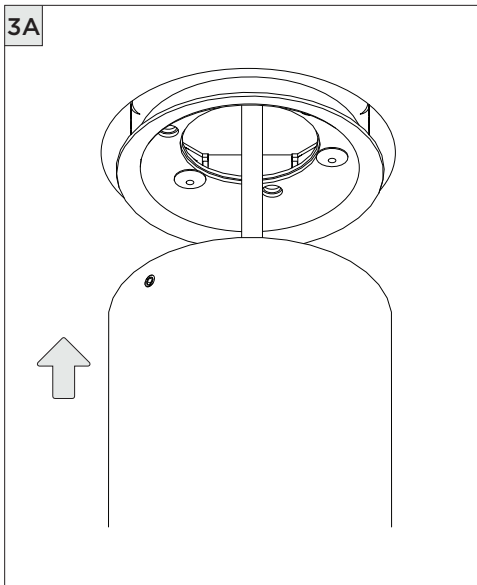
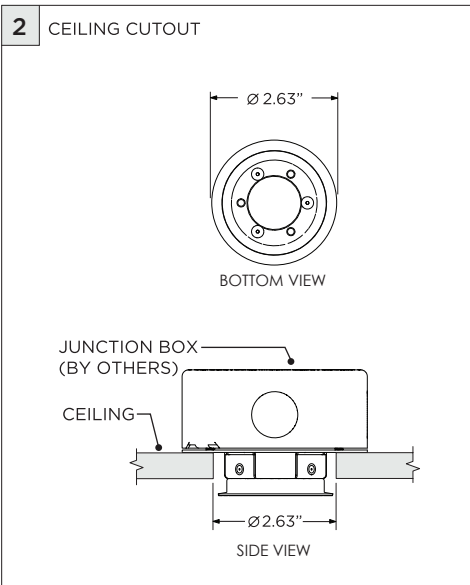
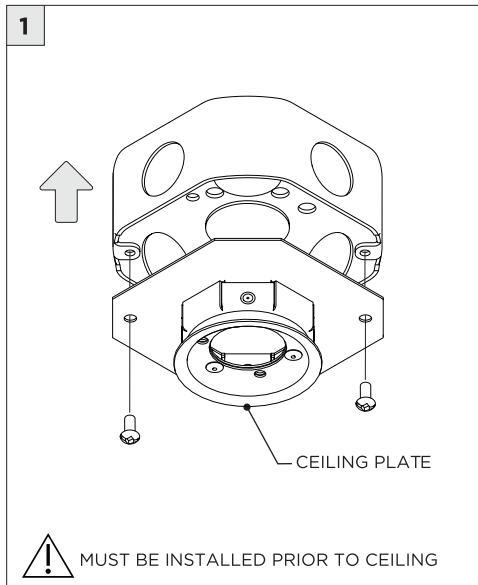

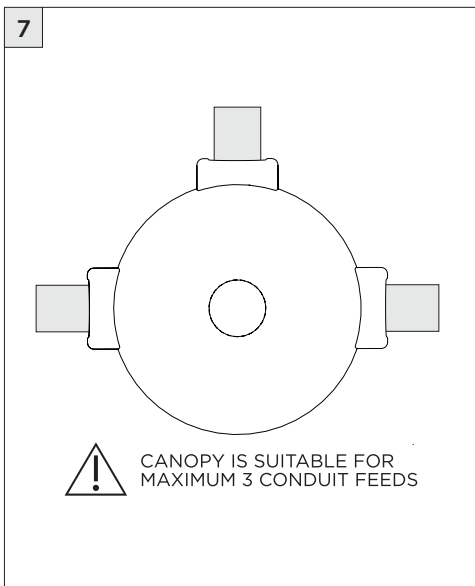
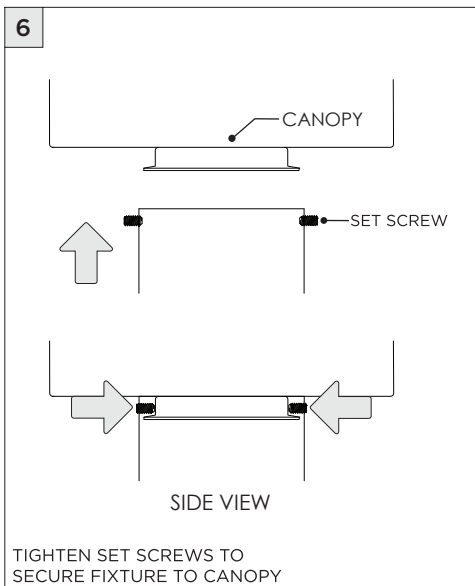
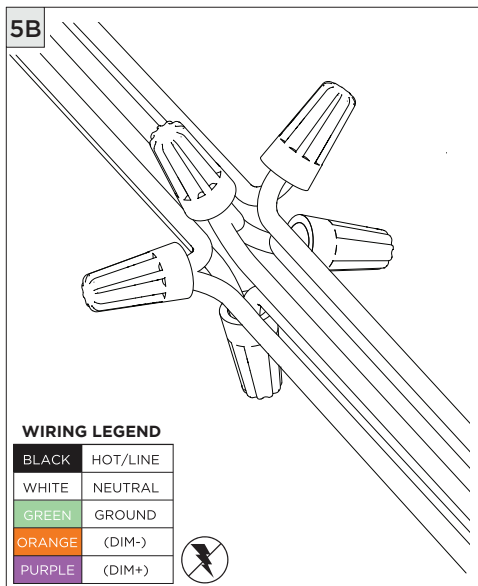
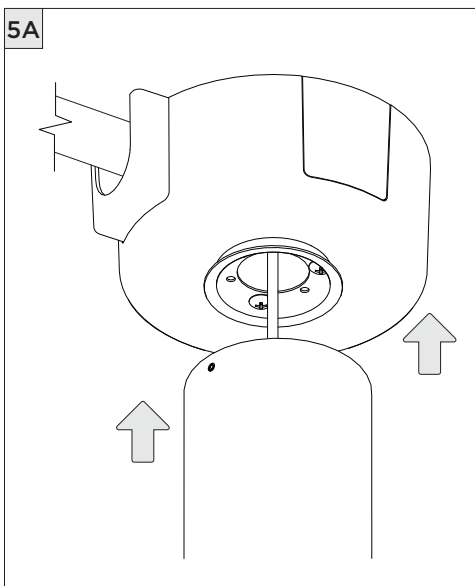
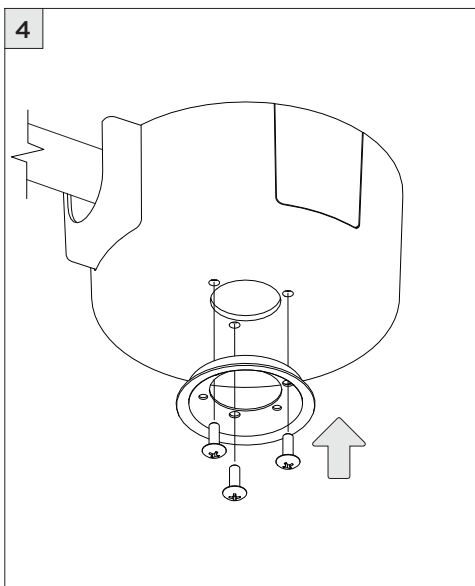
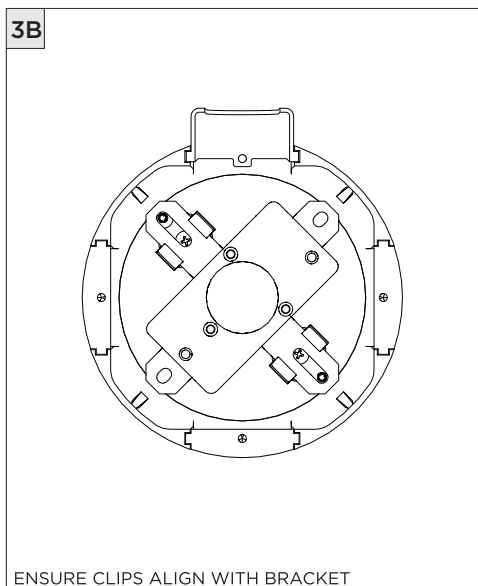
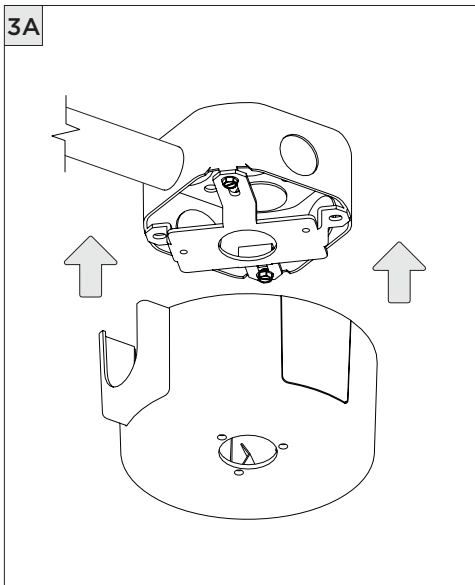
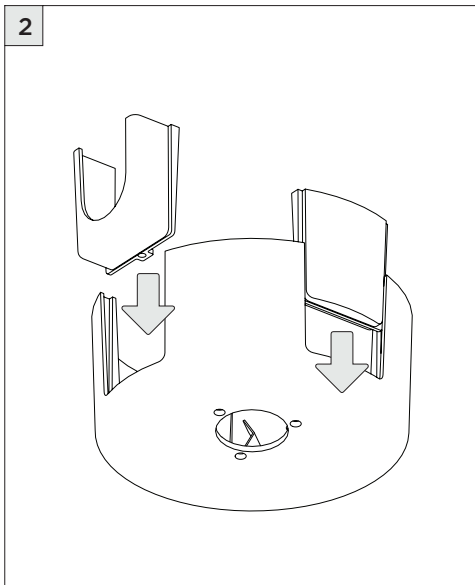
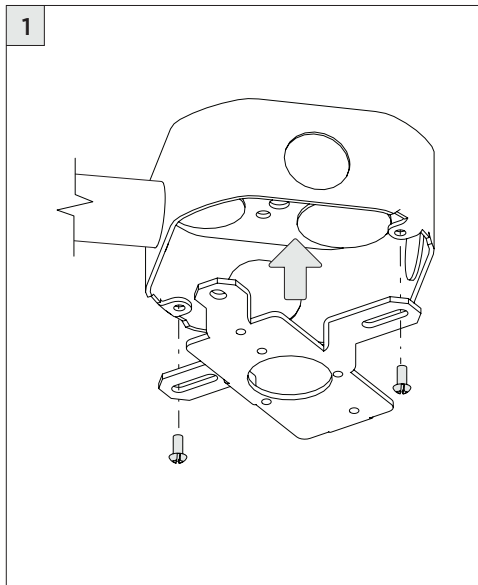

INTEGRATED DRIVER SERVICING - 10" ONLY

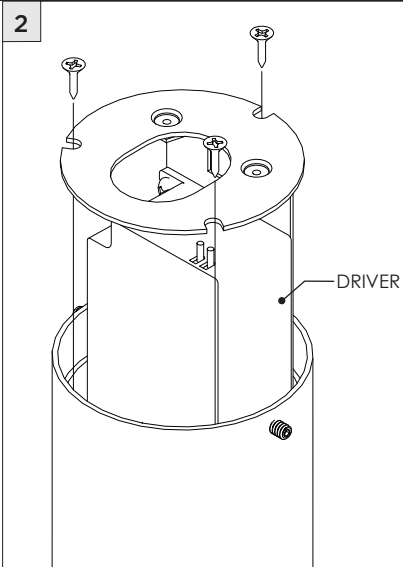
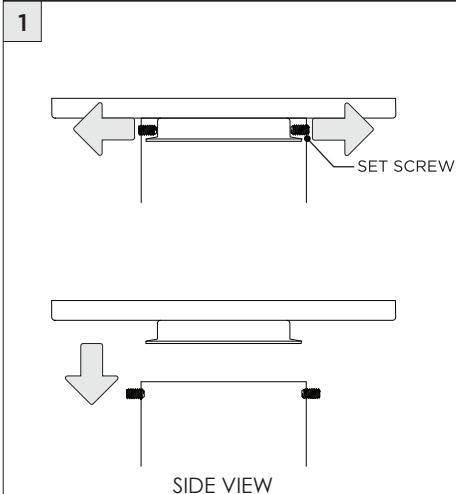

LED SERVICING

